

NO. OF COPIES RECEIVED	
DISTRIBUTION	
SANTA FE	
FILE	
U.S.G.S.	
LAND OFFICE	
OPERATOR	

NEW MEXICO RECEIVED COMMISSION

30-005-60347

Form C-101
Revised 1-1-65

MAY 13 1975

O. C. C.
ARTESIA, OFFICE

5A. Indicate Type of Lease
STATE FEE

5. State Oil & Gas Lease No.
K-4985

7. Unit Agreement Name

8. Farm or Lease Name
Horse Camp State

9. Well No.
1

10. Field and Pool, or Wildcat
Undesignated

12. County
Chaves

19. Proposed Depth
1900'

19A. Formation
Queen

20. Rotary or C.T.
Cable Tool

21. Elevations (Show whether DF, RT, etc.)
3746.9 GR

21A. Kind & Status Plug. Bond
Statewide

21B. Drilling Contractor
Cortez Drilling Co.

22. Approx. Date Work will start
May 15, 1975

APPLICATION FOR PERMIT TO DRILL, DEEPEN, OR PLUG BACK

1a. Type of Work
DRILL DEEPEN PLUG BACK

b. Type of Well
OIL WELL GAS WELL OTHER SINGLE ZONE MULTIPLE ZONE

2. Name of Operator
Franklin, Aston & Fair, Inc.

3. Address of Operator
P.O. Box 1090 Roswell, New Mexico 88201

4. Location of Well
UNIT LETTER M LOCATED 660 FEET FROM THE South LINE
AND 660 FEET FROM THE West East LINE OF SEC. 11 TWP. 14S RGE. 29E NMPM

19. Proposed Depth
1900'

19A. Formation
Queen

20. Rotary or C.T.
Cable Tool

21. Elevations (Show whether DF, RT, etc.)
3746.9 GR

21A. Kind & Status Plug. Bond
Statewide

21B. Drilling Contractor
Cortez Drilling Co.

22. Approx. Date Work will start
May 15, 1975

23. PROPOSED CASING AND CEMENT PROGRAM

SIZE OF HOLE	SIZE OF CASING	WEIGHT PER FOOT	SETTING DEPTH	SACKS OF CEMENT	EST. TOP
15"	12-3/4"	36#	35'	3 yards	ready mix
10 1/4"	8-5/8"	24#	850'	175 sacks	circ. surf.
8"	5-1/2"	15.5#	1900'	250 "	

This well will spud about May 15, 1975. 12-3/4", 36# casing will be set at about 35' and cemented to surface. A 10 1/4" hole will be drilled to about 850' and if water is encountered at 820' as in the McClellan Bell well in Section 12-T14S-R29E, 8-5/8", 24# casing will be set and cement circulated to surface for water shut off. An 8" hole will be drilled to about 1900' to test the Queen formation. If production is indicated 5 1/2" casing will be run for completion.

APPROVAL VALID
FOR 90 DAYS UNLESS
DRILLING COMMENCED,
EXPIRES 8-16-75

IN ABOVE SPACE DESCRIBE PROPOSED PROGRAM; IF PROPOSAL IS TO DEEPEN OR PLUG BACK, GIVE DATA ON PRESENT PRODUCTIVE ZONE AND PROPOSED NEW PRODUCTIVE ZONE. GIVE BLOWOUT PREVENTER PROGRAM, IF ANY.

I hereby certify that the information above is true and complete to the best of my knowledge and belief.

Signed Grant M. Smith Title Geologist Date 5-12-75

APPROVED BY W. A. Gressett TITLE SUPERVISOR, DISTRICT II DATE MAY 16 1975

CONDITIONS OF APPROVAL, IF ANY:

all shallow water must be adequately protected

NEW MEXICO OIL CONSERVATION COMMISSION
WELL LOCATION AND ACREAGE DEDICATION PLAT

Form C-102
Supersedes C-128
Effective 1-1-65

All distances must be from the outer boundaries of the Section

Franklin, Aston & Fair, Incorporated			Lease Horse Camp State		Well No. 1
M	11	14 South	29 East	Chaves	
660 feet from the South line and			660 feet from the West line		
3746.9	Queen	Foot <i>Wildcat</i> Undesignated		Dedicated Acreage: 40 Acres	

- Outline the acreage dedicated to the subject well by colored pencil or hachure marks on the plat below.
- If more than one lease is dedicated to the well, outline each and identify the ownership thereof (both as to working interest and royalty).
- If more than one lease of different ownership is dedicated to the well, have the interests of all owners been consolidated by communitization, unitization, force-pooling, etc?

Yes No If answer is "yes," type of consolidation _____

If answer is "no," list the owners and tract descriptions which have actually been consolidated. (Use reverse side of this form if necessary.) _____

No allowable will be assigned to the well until all interests have been consolidated (by communitization, unitization, forced-pooling, or otherwise) or until a non-standard unit, eliminating such interests, has been approved by the Commission.

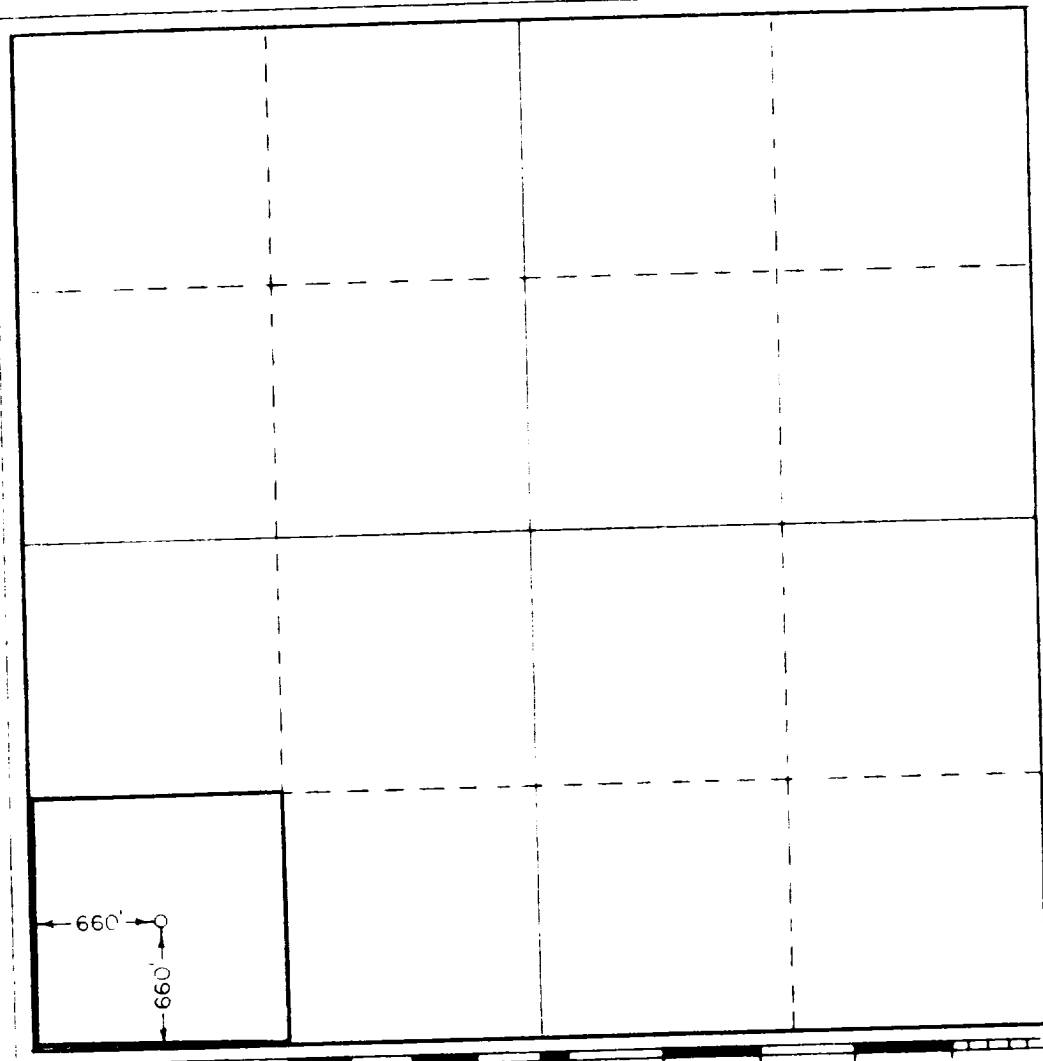

CERTIFICATION

I hereby certify that the information contained herein is true and complete to the best of my knowledge and belief.

Grant M. Smith
Name

Grant M. Smith

Geologist

Franklin, Aston & Fair, Inc.

5-12-75

I hereby certify that the well location shown on this plat was plotted from field notes of actual surveys made by me or under my supervision, and that the same is true and correct to the best of my knowledge and belief.

