

NO. OF COPIES RECEIVED		
DISTRIBUTION		
SANTA FE	1	
FILE	1	✓
U.S.G.S.	2	
LAND OFFICE	1	
OPERATOR	1	

NEW MEXICO OIL CONSERVATION COMMISSION

RECEIVED

30-005-61191

Form C-101
Revised 1-1-65

OCT 21 1981

O. C. D.
ARTESIA, OFFICE

5A. Indicate Type of Lease
STATE FEE

5. State Oil & Gas Lease No.
LC-0157

APPLICATION FOR PERMIT TO DRILL, DEEPEN, OR PLUG BACK

1a. Type of Work DRILL <input checked="" type="checkbox"/> DEEPEN <input type="checkbox"/> PLUG BACK <input type="checkbox"/>		7. Unit Agreement Name
b. Type of Well OIL WELL <input type="checkbox"/> GAS WELL <input checked="" type="checkbox"/> OTHER <input type="checkbox"/>		8. Farm or Lease Name Marley Amoco State
2. Name of Operator PETROLEUM DEVELOPMENT CORPORATION ✓		9. Well No. #1
3. Address of Operator 9720-B Candelaria, N.E., Albuquerque, N.M., 87112		10. Field and Pool, or Wildcat Wildcat ✓
4. Location of Well UNIT LETTER <u>1</u> LOCATED <u>1,980</u> FEET FROM THE <u>South</u> LINE AND <u>660'</u> FEET FROM THE <u>West</u> LINE OF SEC. <u>36</u> TWP. <u>7S</u> RGE. <u>26E</u> NMPM		12. County Chaves
19. Proposed Depth 5,000'		19A. Formation Abo
20. Rotary or C.T. Rotary		
21. Elevations (Show whether DF, RT, etc.) 3,911.63 GI	21A. Kind & Status Plug. Bond Blanket-Active	21B. Drilling Contractor Kenai Drilling Company
22. Approx. Date Work will start November 25, 1981		

PROPOSED CASING AND CEMENT PROGRAM

SIZE OF HOLE	SIZE OF CASING	WEIGHT PER FOOT	SETTING DEPTH	SACKS OF CEMENT	EST. TOP
12 1/4"	8 5/8"	24#	1,100'	650	Surface
7 7/8"	4 1/2"	10.5#	5,000'	300	2,000'

1. Drill 12 1/4" hole to 1,100'; set 8 5/8" casing; bring cement to surface.
2. Drill 7 7/8" hole to 5,000' to test the Abo formation. Run 4 1/2" 10.5# casing if warranted.
3. Utilize a double ram BOP below 1,000'.
4. Drill with water using mud as hole conditions dictate.
Gas is not dedicated.

*Posted ID-1
API + NL Book
11-6-81*

APPROVAL VALID FOR 180 DAYS
PERMIT EXPIRES 5-2-82
UNLESS DRILLING UNDERWAY

IN ABOVE SPACE DESCRIBE PROPOSED PROGRAM: IF PROPOSAL IS TO DEEPEN OR PLUG BACK, GIVE DATA ON PRESENT PRODUCTIVE ZONE AND PROPOSED NEW PRODUCTIVE ZONE. GIVE BLOWOUT PREVENTER PROGRAM, IF ANY.

I hereby certify that the information above is true and complete to the best of my knowledge and belief.

Signed Jim C. Johnson Title Field Manager Date 10/19/81
Jim C. Johnson, Jr.
(This space for State Use)

APPROVED BY W.A. Gessett TITLE SUPERVISOR, DISTRICT II DATE NOV 08 1981

CONDITIONS OF APPROVAL, IF ANY:

NEW MEXICO OIL CONSERVATION COMMISSION
WELL LOCATION AND ACREAGE DEDICATION PLAT

All distances must be from the outer boundaries of the Section.

Company PETROLEUM DEVELOPMENT CORPORATION		State Marley Amoco State		Well No. #1
---	--	------------------------------------	--	-----------------------

Unit Letter L	Section 36	Township 7-S	Range 26-E	County Chaves
-------------------------	----------------------	------------------------	----------------------	-------------------------

Actual Portage Location of Well:
1980 feet from the **SOUTH** line and **660** feet from the **WEST** line

Ground Level Elev. 3911.63'	Producing Formation Abo	Pool Wildcat	Dedicated Acreage: 160 Acres
---------------------------------------	-----------------------------------	------------------------	--

1. Outline the acreage dedicated to the subject well by colored pencil or hachure marks on the plat below.
2. If more than one lease is dedicated to the well, outline each and identify the ownership thereof (both as to working interest and royalty).
3. If more than one lease of different ownership is dedicated to the well, have the interests of all owners been consolidated by communitization, unitization, force-pooling, etc?

Yes No If answer is "yes," type of consolidation _____

If answer is "no," list the owners and tract descriptions which have actually been consolidated. (Use reverse side of this form if necessary.) _____

No allowable will be assigned to the well until all interests have been consolidated (by communitization, unitization, forced-pooling, or otherwise) or until a non-standard unit, eliminating such interests, has been approved by the Commission.

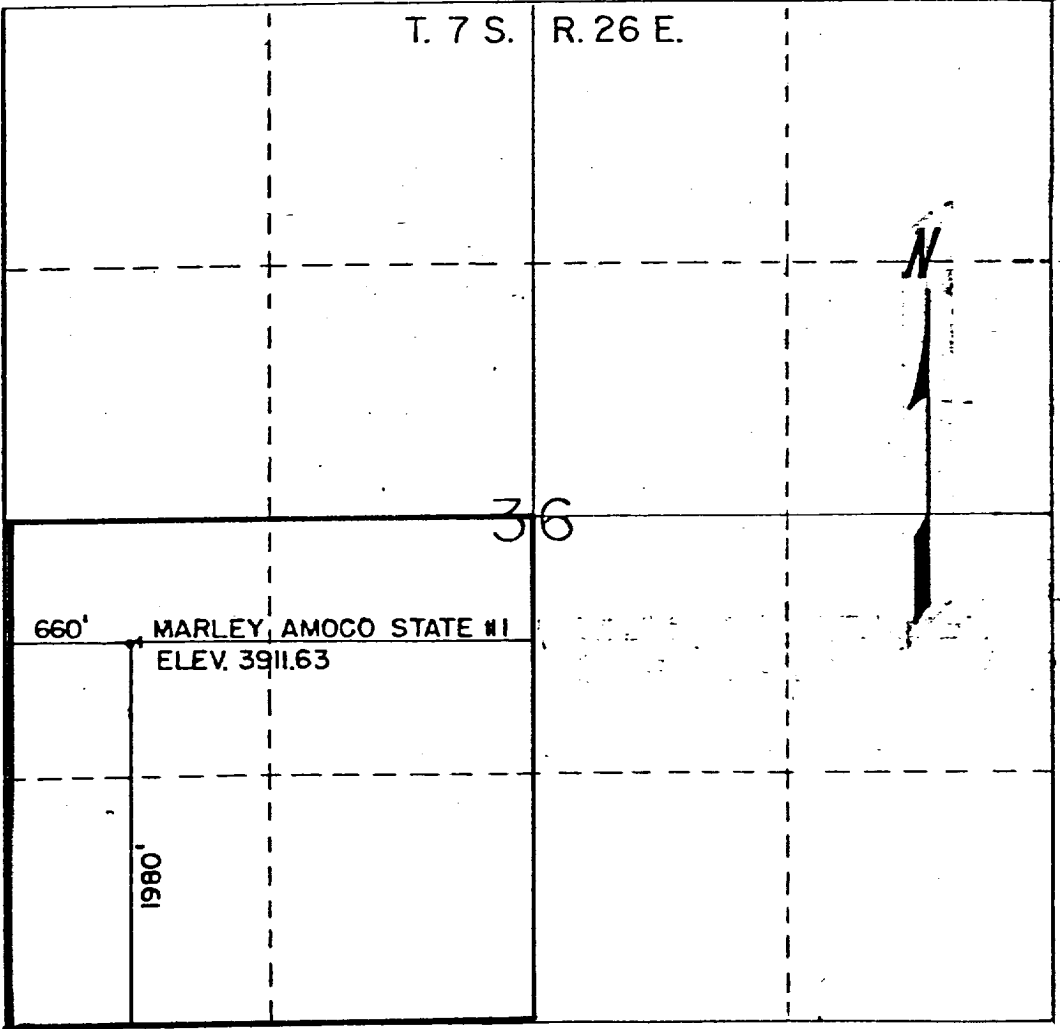

CERTIFICATION

I hereby certify that the information contained herein is true and complete to the best of my knowledge and belief.

Name <i>Jim C. Johnson</i>
Position Field Manager
Company PETROLEUM DEVELOPMENT CORP.
Date October 19, 1981

I hereby certify that the well location shown on this plat was plotted from field notes of actual surveys made by me or under my supervision and that the same is true to the best of my knowledge and belief.

Date Surveyed **277**
 Registered Professional Engineer
 and Land Surveyor
Thomas P. S. Mann, P.E. & L.S.
 N.M. License No. 277
 Certificate No.

