

NO. OF COPIES RECEIVED	
DISTRIBUTION	
SANTA FE	1
FILE	1
U.S.G.S.	2
LAND OFFICE	1
OPERATOR	1

NEW MEXICO OIL CONSERVATION COMMISSION

RECEIVED
 DEC 29 1981
 O. C. D.
 ARTESIA, OFFICE

80-005-61324
 Form C-101
 Revised 1-1-65

5. Indicate Type of Lease
 STATE FEE
 5. State Oil & Gas Lease No.
 L-5031

APPLICATION FOR PERMIT TO DRILL, DEEPEN, OR PLUG BACK

1a. Type of Work
 b. Type of Well DRILL DEEPEN PLUG BACK
 OIL WELL GAS WELL OTHER SINGLE ZONE MULTIPLE ZONE

2. Name of Operator
 Clements Energy, Inc

3. Address of Operator
 P O Box 7924, Midland, Texas 79703

4. Location of Well
 UNIT LETTER F LOCATED 1650' FEET FROM THE North LINE
 AND 1650' FEET FROM THE West LINE OF SEC. 30 TWP. 14S RGE. 28E NMPM

7. Unit Agreement Name
 8. Farm or Lease Name
 NM 30 State Com

9. Well No.
 #1

10. Field and Pool, or Wildcat
 Morrow-Buffalo Valley

12. County
 Chaves

19. Proposed Depth 8400'
 19A. Formation Morrow
 20. Rotary or C.T. Rotary

21. Elevations (show whether DT, RT, etc.) GL 3551.26
 21A. Kind & Status Plug. Bond Blanket-Active
 21B. Drilling Contractor Cactus Drilling
 22. Approx. Date Work will start 1-1-82

PROPOSED CASING AND CEMENT PROGRAM

SIZE OF HOLE	SIZE OF CASING	WEIGHT PER FOOT	SETTING DEPTH	SACKS OF CEMENT	EST. TOP
17 1/2"	13 3/8"	48#	350'	400 sx	circ to surf
12 1/4"	8 5/8"	24#	1650'	600 sx	circ to surf
7 7/8"	5 1/2"	15.5#	8400'	600 sx	2000'

Spacing 320 acres.

BOP Schedule: 0 - 350' None
 350' - 1650' 3000# WP double Schafer Hydraulic w/remote controls
 1650' - 8400' 5000# WP double Schafer Hydraulic w/remote controls

Gas is not dedicated.

APPROVAL VALID FOR 180 DAYS
 PERMIT EXPIRES 7-4-82
 UNLESS DRILLING UNDERWAY

IN ABOVE SPACE DESCRIBE PROPOSED PROGRAM; IF PROPOSAL IS TO DEEPEN OR PLUG BACK, GIVE DATA ON PRESENT PRODUCTIVE ZONE AND PROPOSED NEW PRODUCTIVE ZONE. GIVE BLOWOUT PREVENTER PROGRAM, IF ANY.

I hereby certify that the information above is true and complete to the best of my knowledge and belief.

Signed Tommy Zachry Title Engineer Date 12-23-81

(This space for State Use)
 Tommy Zachry

APPROVED BY Mike Williams TITLE OIL AND GAS INSPECTOR DATE JAN 4 1982

CONDITIONS OF APPROVAL, IF ANY:

NEW MEXICO OIL CONSERVATION COMMISSION
WELL LOCATION AND ACREAGE DEDICATION PLAT

Form C-112
Supersedes C-128
Effective 1-1-65

All distances must be from the outer boundaries of the Section.

Operator Clements Energy, Inc.		Lease New Mexico State #30 ³⁰		Well No. 1
Unit Letter F	Section 30	Township 14S	Range 28E	County Chaves County
Actual Footage Location of Well: 1650 feet from the North line and 1650 feet from the West line				
Ground Level Elev. 3551.26	Producing Formation Morrow	Pool Buffalo Valley	Dedicated Acreage: 328.92320 Acres	

1. Outline the acreage dedicated to the subject well by colored pencil or hachure marks on the plat below.
2. If more than one lease is dedicated to the well, outline each and identify the ownership thereof (both as to working interest and royalty).
3. If more than one lease of different ownership is dedicated to the well, have the interests of all owners been consolidated by communitization, unitization, force-pooling, etc?

Yes No If answer is "yes," type of consolidation Communitization

If answer is "no," list the owners and tract descriptions which have actually been consolidated. (Use reverse side of this form if necessary.) _____

No allowable will be assigned to the well until all interests have been consolidated (by communitization, unitization, forced-pooling, or otherwise) or until a non-standard unit, eliminating such interests, has been approved by the Commission.

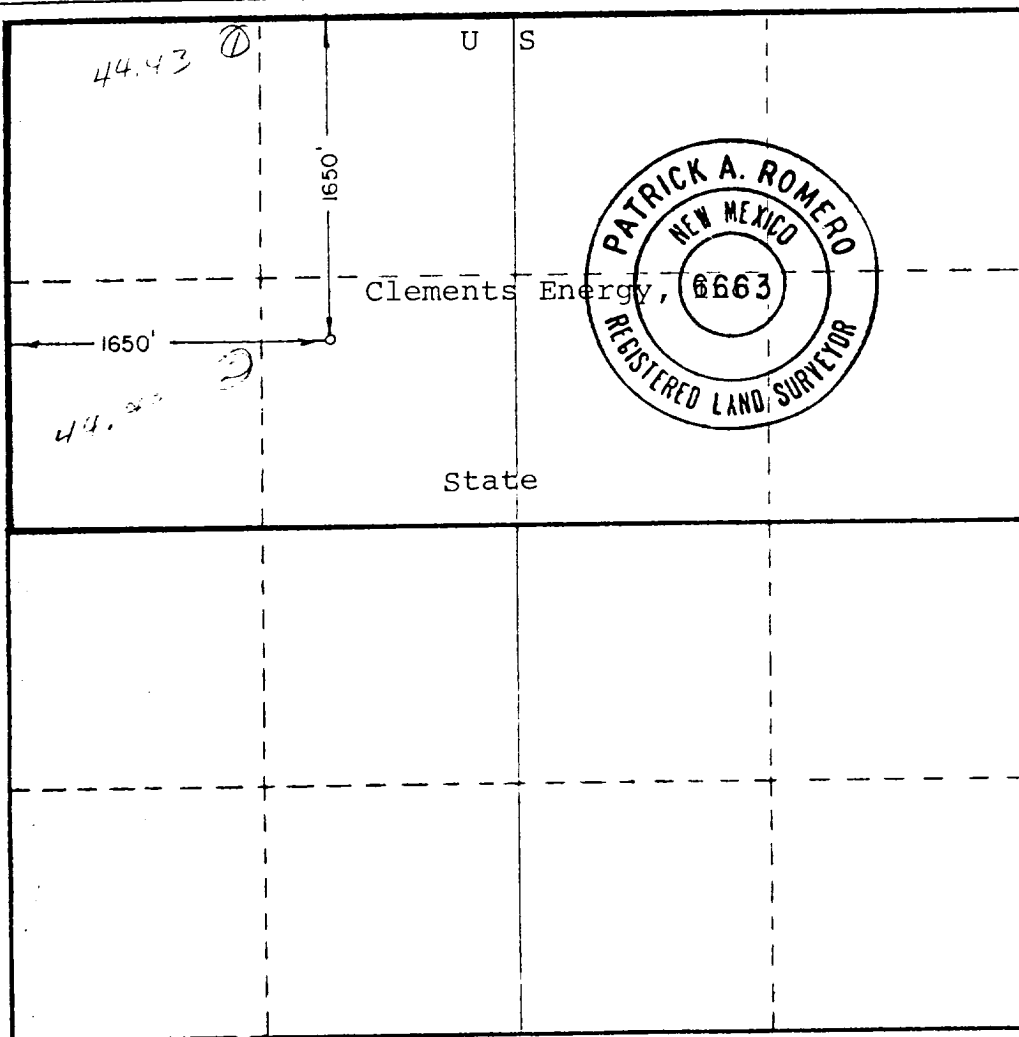

CERTIFICATION

I hereby certify that the information contained herein is true and complete to the best of my knowledge and belief.

Tommy Zachry
Name

Position **Tommy Zachry**
Agent

Company
Clements Energy, Inc.

Date
12-23-81

I hereby certify that the well location shown on this plat was plotted from field notes of actual surveys made by me or under my supervision, and that the same is true and correct to the best of my knowledge and belief.

12/18/81

Date Surveyed

Registered Professional Engineer
and/or Land Surveyor

Patrick A. Romero

Certificate No **JOHN W. WEST 676**
PATRICK A. ROMERO 6663
Ronald J. Eidson 3239

