

Form 9-331a (Feb. 1951)

15	.
ec.	22

(SUBMIT IN TRIPLICATE)

UNITED STATES DEPARTMENT OF THE INTERIOR GEOLOGICAL SURVEY

Land Office Las Cruces Lease No. 029419-4a Unit Lynch #11

RECEIVED NOV 6 1961 GEOLOGICAL SURVEY OFFICE

SUNDRY NOTICES AND REPORTS ON WELLS

<input checked="" type="checkbox"/> NOTICE OF INTENTION TO DRILL	SUBSEQUENT REPORT OF WATER SHUT-OFF
NOTICE OF INTENTION TO CHANGE PLANS	SUBSEQUENT REPORT OF SHOOTING OR ACIDIZING
NOTICE OF INTENTION TO TEST WATER SHUT-OFF	SUBSEQUENT REPORT OF ALTERING CASING
NOTICE OF INTENTION TO RE-DRILL OR REPAIR WELL	SUBSEQUENT REPORT OF RE-DRILLING OR REPAIR
NOTICE OF INTENTION TO SHOOT OR ACIDIZE	SUBSEQUENT REPORT OF ABANDONMENT
NOTICE OF INTENTION TO PULL OR ALTER CASING	SUPPLEMENTARY WELL HISTORY
NOTICE OF INTENTION TO ABANDON WELL	

(INDICATE ABOVE BY CHECK MARK NATURE OF REPORT, NOTICE, OR OTHER DATA)

Hobbs, New Mexico - November 1, 1961

Lynch #11 Well No. 15 is located 660 ft. from N line and 1080 ft. from E line of sec. 22

NE/4 NE/4 Sec. 22 17-S 31-E N.M.P.M. (Meridian) Grayburg Jackson Eddy New Mexico (Field) (County or Subdivision) (State or Territory) RECEIVED NOV 6 1961

The elevation of the derrick floor above sea level is _____ ft.

DETAILS OF WORK

(State names of and expected depths to objective sands; show sizes, weights, and lengths of proposed casings; indicate mudding jobs, cementing points, and all other important proposed work)

Propose to drill with rotary tools using gas from surface to total depth of approx. 3'10" in the San Andres Formation. Casing program as follows:

Size Hole	Size Casing	Casing Point	Cement(Sacks)
11"	3-5/8"	725'	100
7-7/8"	4-1/2"	3810'	385

The Pump & Plug process will be used in cementing both strings of casing. The well will be perforated and treated with approx. 1550 bbls. of lease oil, and approx. 60,000# 20/40 sand.

I understand that this plan of work must receive approval in writing by the Geological Survey before operations may be commenced.

Company Skelly Oil Company Address Box 28 Hobbs, New Mexico By [Signature] Title 1st. Supt.

NEW MEXICO OIL CONSERVATION COMMISSION
WELL LOCATION AND ACREAGE DECLARATION

FORM O-122
 REVISED 5-57

SEE INSTRUCTIONS FOR COMPLETING THIS FORM ON THE REVERSE SIDE

SECTION A

Operator SKELLY OIL COMPANY		Lease LYNCH "A"		Well No. 15
Unit Letter B	Section 22	Township 17 SOUTH	Range 31 EAST	County EDDY
Actual Footage Location of Well 660 feet from the NORTH line and 1880 feet from the EAST line		Ground Level Elev. San Andres		
Producing Formation Grayburg Jackson		Well Depth 40		

1. Is the Operator the only owner in the declaration acreage outlined on the plat here attached **XXX** who has the right to drill into and to produce from any pool and is appropriate, the production from another. (65-3-29 (a) NMSA 1953) **no**
2. If the answer to question one is "no," have the interests of all the owners been disclosed as follows? YES NO If answer is "yes," Type of manipulation _____
3. If the answer to question two is "no," list all the owners and their respective interests in _____

Owner _____

RECEIVED
NOV 6 1961
 U. S. GEOLOGICAL SURVEY
 ARTESIA, NEW MEXICO

SECTION B

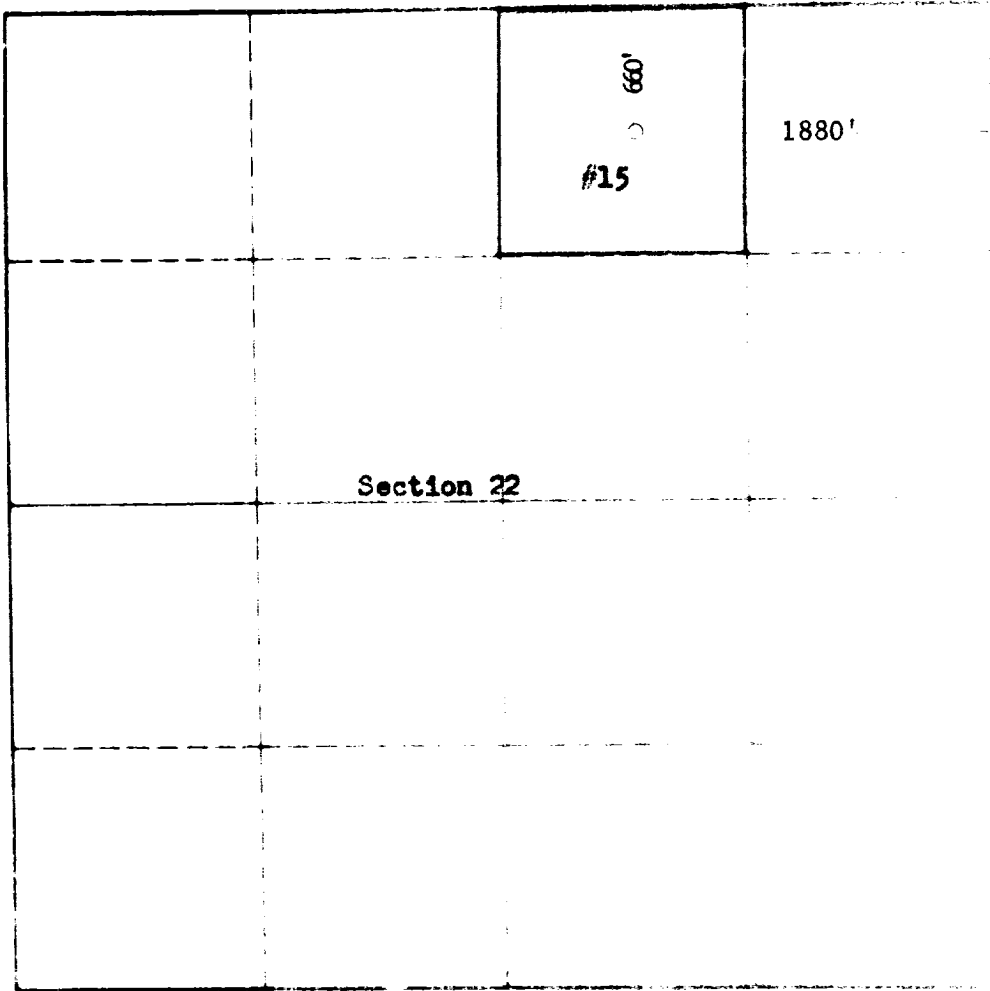

Section 22

J. E. Aeb

Dist. Supt.
 Skelly Oil Co.
 Nov. 2, 1961

0 330 660 990 1320 1650 1980 2310 2640 2970 3300 3630 3960 4290

