

**NEW MEXICO OIL CONSERVATION COMMISSION** E I V Form O-101  
 Santa Fe, New Mexico Revised (12/1/55)

JUN 29 1960

**NOTICE OF INTENTION TO DRILL**

Notice must be given to the District Office of the Oil Conservation Commission and approval obtained before drilling or recompletion begins. If changes in the proposed plan are considered advisable, a copy of this notice showing such changes will be returned to the sender. Submit this notice in **QUINTUPLICATE**. One copy will be returned following approval. See additional instructions in Rules and Regulations of the Commission. **If State Land submit 6 Copies Attach Form O-128 in triplicate to first 3 copies of form O-101**

Breckenridge, Texas (Place) June 27, 1960 (Date)

**OIL CONSERVATION COMMISSION  
 SANTA FE, NEW MEXICO**

Gentlemen:

You are hereby notified that it is our intention to commence the **Drilling** of a well to be known as Granidge Corporation  
 (Company or Operator)

Resler-Yates-State Well No. 384, in H (Lease) (Unit) The well is

located 2310 feet from the North line and 1300 feet from the East line of Section 28, T. 18S, R. 28E, NMPM.

(GIVE LOCATION FROM SECTION LINE) Artesia Pool, Eddy County

If State Land the Oil and Gas Lease is No. 647

If patented land the owner is.....

Address.....

We propose to drill well with drilling equipment as follows: 2100' with rotary equipment

The status of plugging bond is 10,000 Fidelity & Casualty Co. of New York

Bond # 1053517 covering drilling and plugging in State of New Mexico

Drilling Contractor..... (Will advise later)

We intend to complete this well in the 1st Graburg formation at an approximate depth of 2050-2100 feet.

**CASING PROGRAM**

We propose to use the following strings of Casing and to cement them as indicated:

Size of Hole	Size of Casing	Weight per Foot	New or Second Hand	Depth	Sacks Cement
10' 3/4"	8-5/8"	28#	New	300	200
7' 7/8"	4-1/2"	9.5#	New	2100	150

If changes in the above plans become advisable we will notify you immediately.

**ADDITIONAL INFORMATION (If recompletion give full details of proposed plan of work.)**

This well is to be drilled and used as a water injection well for water flood operations for this area. Conservation Commission approval to drill this unorthodox location was granted by order No. 12,103.

Approved..... JUN 29 1960, 19.....  
 Except as follows:

Sincerely yours,

Granidge Corporation  
 (Company or Operator)

By A. C. Andrews, Jr. A. C. Andrews, Jr.

Position Production Clerk  
 Send Communications regarding well to

Name Granidge Corporation

Address Box 752, Breckenridge, Texas

**OIL CONSERVATION COMMISSION**

By M. L. Amundson

NEW MEXICO OIL CONSERVATION COMMISSION JUN 29 1960 FORM C-128 Revised 5/1/57  
**WELL LOCATION AND ACREAGE DEDICATION PLAT** D. C. C.

SEE INSTRUCTIONS FOR COMPLETING THIS FORM ON THE REVERSE SIDE ARTESIA, OFFICE

**SECTION A**

Operator <b>Graridge Corporation</b>		Lease <b>Resler Yates State</b>		Well No. <b>304</b>
Unit Letter <b>4</b>	Section <b>28</b>	Township <b>10S</b>	Range <b>28E</b>	County <b>LOS</b>
Actual Footage Location of Well: <b>2310</b> feet from the <b>North</b> line and <b>1300</b> feet from the <b>East</b> line				
Ground Level Elev. <b>3945</b>	Producing Formation <b>1st Grabung</b>		Pool <b>Artesia</b>	Dedicated Acreage: Acres

1. Is the Operator the only owner in the dedicated acreage outlined on the plat below? YES  NO  . ("Owner" means the person who has the right to drill into and to produce from any pool and to appropriate the production either for himself or for himself and another. (65-3-29 (e) NMSA 1935 Comp.)
2. If the answer to question one is "no," have the interests of all the owners been consolidated by communitization agreement or otherwise? YES  NO  . If answer is "yes," Type of Consolidation \_\_\_\_\_
3. If the answer to question two is "no," list all the owners and their respective interests below:

Owner	Land Description

**SECTION B**

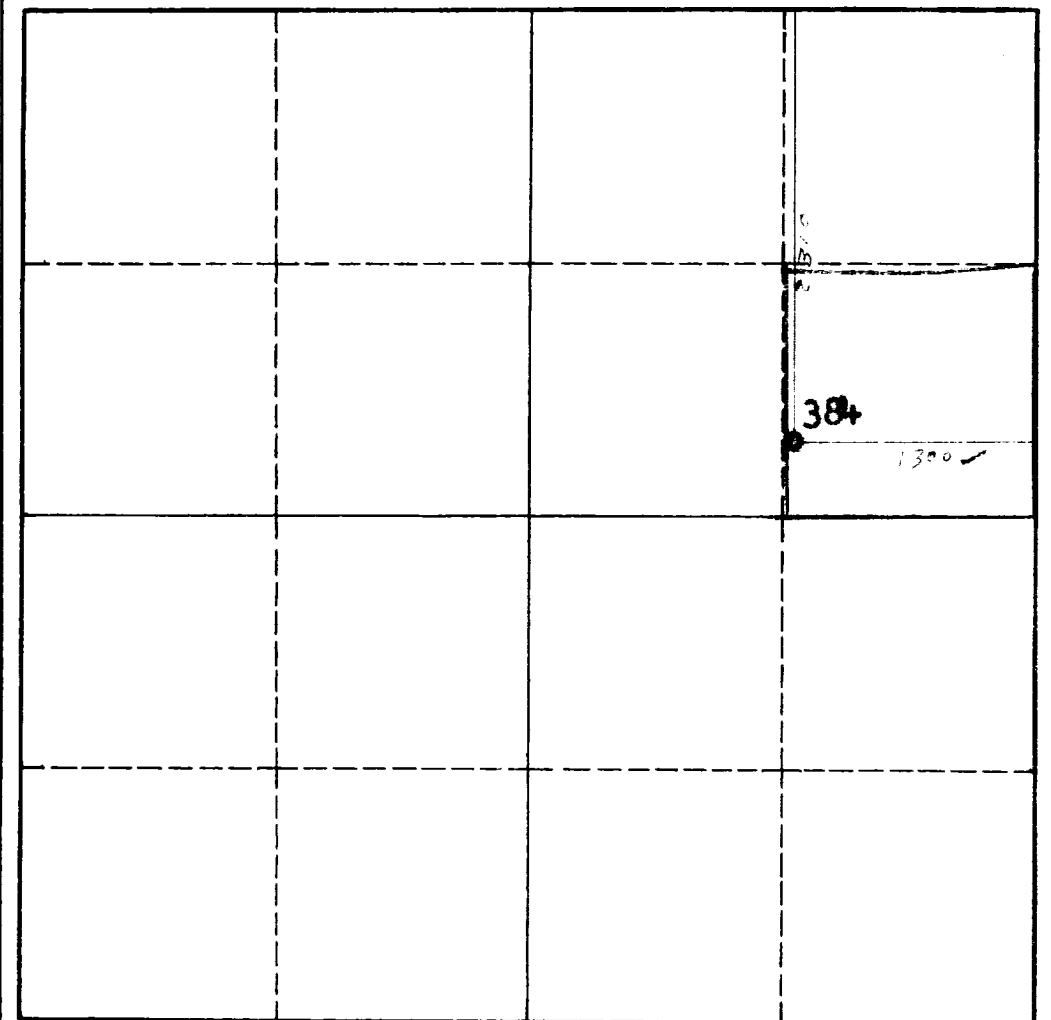

**CERTIFICATION**

I hereby certify that the information in SECTION A above is true and complete to the best of my knowledge and belief.

Name <i>A. C. Andrews, Jr.</i> <b>A. C. Andrews, Jr.</b>
Position <b>Production Clerk</b>
Company <b>Graridge Corporation</b>
Date <b>June 17, 1960</b>

I hereby certify that the well location shown on the plat in SECTION B was plotted from field notes of actual surveys made by me or under my supervision, and that the same is true and correct to the best of my knowledge and belief.

Date Surveyed <b>June 23, 1960</b>
Registered Professional Engineer and/or Land Surveyor <i>John A. MacInnes</i>
Certificate No.

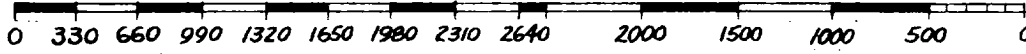

## INSTRUCTIONS FOR COMPLETION OF FORM C-128

1. Operator shall furnish and certify to the information called for in Section A.
2. Operator shall outline the dedicated acreage for *both* oil and gas wells on the plat in Section B.
3. A registered professional engineer or land surveyor registered in the State of New Mexico or approved by the Commission shall show on the plat the location of the well and certify this information in the space provided.
4. All distances shown on the plat must be from the outer boundaries of the Section.
5. If additional space is needed for listing owners and their respective interests as required in question 3 of Section A, please use space below.

OIL CONSERVATION COMMISSION	
ARTESIA DISTRICT OFFICE	
No. Copies Received	6
DISTRIBUTION	
OPERATOR	FILED
SANTA FE	/
DIVISION OFFICE	/
STATE LAND OFFICE	/
U. S. G. S.	/
TRANSPORTER	/
FILE	/
BUREAU OF MINES	/