

N. M. O. C. C. COPY
UNITED STATES
DEPARTMENT OF THE INTERIOR
GEOLOGICAL SURVEY

SUBMIT IN **LICATE***
(Other instructions on reverse side)
Copy J.

Form approved.
Budget Bureau No. 42-R1425.

APPLICATION FOR PERMIT TO DRILL, DEEPEN, OR PLUG BACK

1a. TYPE OF WORK
 DRILL DEEPEN PLUG BACK

b. TYPE OF WELL
 OIL WELL GAS WELL OTHER
 SINGLE ZONE MULTIPLE ZONE

2. NAME OF OPERATOR
Yates Petroleum Corporation

3. ADDRESS OF OPERATOR
309 Carper Building, Artesia, New Mexico

4. LOCATION OF WELL (Report location clearly and in accordance with any State requirements.)
 At surface
660' FSL and 1980 FNL of Sec. 11, T. 18S., R. 29E
 At proposed prod. zone

14. DISTANCE IN MILES AND DIRECTION FROM NEAREST TOWN OR POST OFFICE*

15. DISTANCE FROM PROPOSED* LOCATION TO NEAREST PROPERTY OR LEASE LINE, FT. (Also to nearest drig. line, if any)

18. DISTANCE FROM PROPOSED LOCATION* TO NEAREST WELL, DRILLING, COMPLETED, OR APPLIED FOR, ON THIS LEASE, FT.

21. ELEVATIONS (Show whether DF, RT, GR, etc.)

5. LEASE DESIGNATION AND SERIAL NO.
LC 058481

6. IF INDIAN, ALLOTTEE OR TRIBE NAME

7. UNIT AGREEMENT NAME

8. FARM OR LEASE NAME
Arriard

9. WELL NO.
10

10. FIELD AND POOL, OR WILDCAT
Loon Hills

11. SEC., T., R., M., OR BLM. AND SURVEY OR AREA
Unit N, Sec. 11, T. 18S R. 29E. N.M.P.M.

12. COUNTY OR PARISH 13. STATE
Sady New Mexico

16. NO. OF ACRES IN LEASE
320

19. PROPOSED DEPTH
2750'

17. NO. OF ACRES ASSIGNED TO THIS WELL
40

20. ROTARY OR CABLE TOOLS
Rotary

22. APPROX. DATE WORK WILL START*

23. **PROPOSED CASING AND CEMENTING PROGRAM**

SIZE OF HOLE	SIZE OF CASING	WEIGHT PER FOOT	SETTING DEPTH	QUANTITY OF CEMENT
11"	8 5/8"	24#	450'	50 sacks
7 7/8"	4 1/2"	9.50#	2750'	100 sacks

Drill minimum of 11" hole to approximately 450' and set 8 5/8" casing, 24#, and cement with 50 sacks.

Drill 7 7/8" hole to approximately 2750' and set 4 1/2", 9.50# casing and cement with 100 sacks.

RECEIVED

MAY 27 1964

O. C. C.
ARTESIA OFFICE

IN ABOVE SPACE DESCRIBE PROPOSED PROGRAM: If proposal is to deepen or plug back, give data on present productive zone and proposed new productive zone. If proposal is to drill or deepen directionally, give pertinent data on subsurface locations and measured and true vertical depths. Give blowout preventer program, if any.

24. SIGNED *Bruce E. Monroe* TITLE Drilling Superintendent DATE May 25, 1964
 (This space for Federal or State office use)

PERMIT NO. _____ APPROVAL DATE _____
 TITLE _____ DATE _____

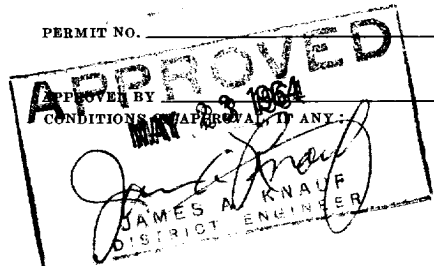

*See Instructions On Reverse Side

Instructions

General: This form is designed for submitting proposals to perform certain well operations, as indicated, on all types of lands and leases for appropriate action by either a Federal or a State agency, or both, pursuant to applicable Federal and/or State laws and regulations. Any necessary special instructions concerning the use of this form and the number of copies to be submitted, particularly with regard to local, area, or regional procedures and practices, either are shown below or will be issued by, or may be obtained from, the local Federal and/or State office.

Item 1: If the proposal is to redrill to the same reservoir at a different subsurface location or to a new reservoir, use this form with appropriate notations. Consult applicable State or Federal regulations concerning subsequent work proposals or reports on the well.

Item 4: If there are no applicable State requirements, locations on Federal or Indian land should be described in accordance with Federal requirements. Consult local State or Federal office for specific instructions.

Item 14: Needed only when location of well cannot readily be found by road from the land or lease description. A plat, or plats, separate or on this reverse side, showing the roads to, and the surveyed location of, the well, and any other required information, should be furnished when required by Federal or State agency offices.

Items 15 and 18: If well is to be, or has been directionally drilled, give distances for subsurface location of hole in any present or objective production zone.

Item 22: Consult applicable Federal or State regulations, or appropriate officials, concerning approval of the proposal before operations are started.

NUMBER OF COPIES RECEIVED	
DISTRIBUTION	
SANTA FE	
FILE	
U.S.G.S.	
LAND OFFICE	
TRANSPORTER	OIL
	GAS
PRORATION OFFICE	
OPERATOR	

NEW MEXICO OIL CONSERVATION COMMISSION
WELL LOCATION AND ACREAGE DEDICATION PLAT
 SEE INSTRUCTIONS FOR COMPLETING THIS FORM ON THE REVERSE SIDE

FORM C-128
 Revised 5/1/57

SECTION A

Operator Yates Petroleum Corporation		Lease Brainerd		Well No. 10
Unit Letter N	Section 11	Township 18 North	Range 29 East	County Eddy
Actual Footage Location of Well: 660 feet from the South line and 1980 feet from the West line				
Ground Level Elev. 3514	Producing Formation <i>Gl. S. A.</i>	Pool	Dedicated Acreage: 40 Acres	

- Is the Operator the only owner in the dedicated acreage outlined on the plat below? YES NO . ("Owner" means the person who has the right to drill into and to produce from any pool and to appropriate the production either for himself or for himself and another. (65-3-29 (e) NMSA 1935 Comp.)
- If the answer to question one is "no," have the interests of all the owners been consolidated by communitization agreement or otherwise? YES NO . If answer is "yes," Type of Consolidation _____
- If the answer to question two is "no," list all the owners and their respective interests below:

RECEIVED

Owner	Land Description
	MAY 27 1964

SECTION B

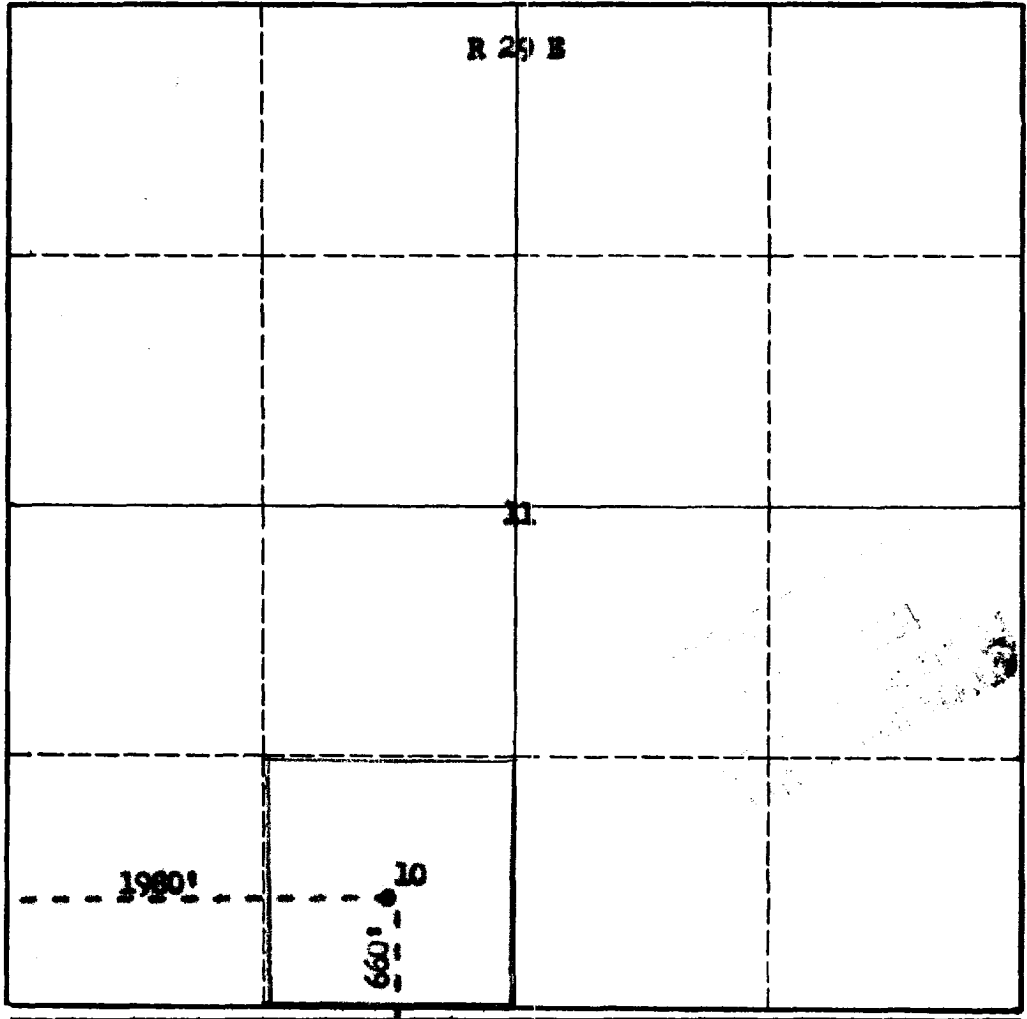

**G. C. C.
 ARTSIA OFFICE
 CERTIFICATION**

I hereby certify that the information in SECTION A above is true and complete to the best of my knowledge and belief.

Bruce C. Monroe
 Name

Bruce C. Monroe
 Position

Drilling Superintendent
 Company

Yates Petroleum Corp.
 Date

May 26, 1964

I hereby certify that the well location shown on the plat in SECTION B was plotted from field notes of actual surveys made by me or under my supervision, and that the same is true and correct to the best of my knowledge and belief.

Date Surveyed

May 26, 1964
 Registered Professional Engineer
 and/or Land Surveyor

James H. Brown
 Certificate No.

N.M.L.S. No. 542

INSTRUCTIONS FOR COMPLETION OF FORM C-128

1. Operator shall furnish and certify to the information called for in Section A.
2. Operator shall outline the dedicated acreage for *both* oil and gas wells on the plat in Section B.
3. A registered professional engineer or land surveyor registered in the State of New Mexico or approved by the Commission shall show on the plat the location of the well and certify this information in the space provided.
4. All distances shown on the plat must be from the outer boundaries of the Section.
5. If additional space is needed for listing owners and their respective interests as required in question 3 of Section A, please use space below.