

NEW MEXICO OIL CONSERVATION COMMISSION

Well Location and Acreage Dedication Plat

Section A.

Date October 15, 1957

Operator Ralph Nix & Jerry Curtis Lease Nix-State
Well No. 1 Unit Letter A Section 6 Township 19S Range 29E NMPM
Located 660 Feet From North Line, 660 Feet From East Line
County Eddy G. L. Elevation 3401 Dedicated Acreage 40.91 Acres
Name of Producing Formation San Andres Pool Wildcat

RECEIVED
OCT 17 1957
ARTESIA OFFICE

1. Is the Operator the only owner* in the dedicated acreage outlined on the plat below?
Yes No
2. If the answer to question one is "no," have the interests of all the owners been consolidated by communitization agreement or otherwise? Yes No . If answer is "yes," Type of Consolidation _____
3. If the answer to question two is "no," list all the owners and their respective interests below:

<u>Owner</u>	<u>Land Description</u>

Section B

R29E

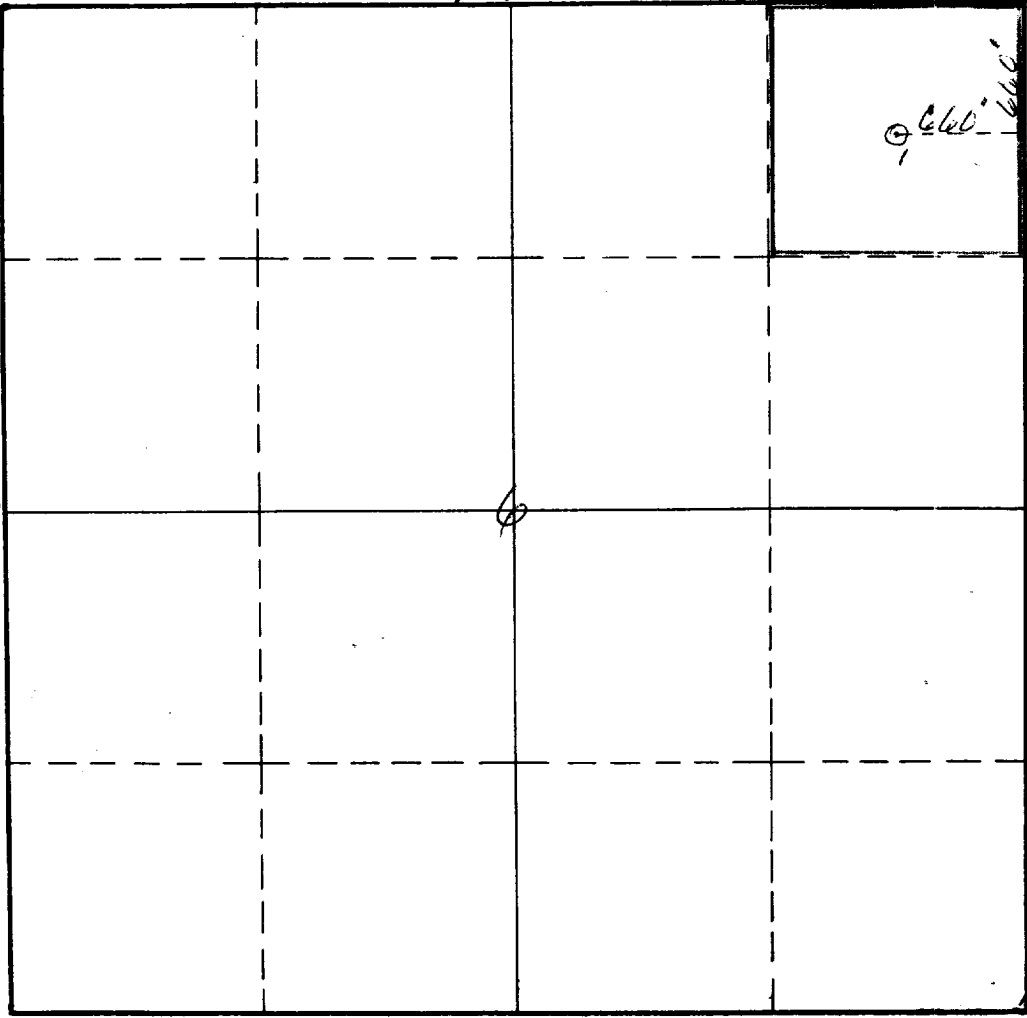

This is to certify that the information in Section A above is true and complete to the best of my knowledge and belief.

Ralph Nix & Jerry Curtis
(Operator)
Ralph Nix
P.O. Box 605, Artesia, N. Mex.
(Representative)

Address _____

This is to certify that the well location shown on the plat in Section B was plotted from field notes of actual surveys made by me or under my supervision and that the same is true and correct to the best of my knowledge and belief.

Date Surveyed Sept 27th 1957
James H. Brown
Registered Professional
Engineer and/or Land Surveyor.



Certificate No. 5421

(See instructions for completing this form on the reverse side)

INSTRUCTIONS FOR COMPLETION

1. Operator shall furnish and certify to the information called for in Section A.
2. Operator shall outline the dedicated acreage for both oil and gas wells on the plat in Section B.
3. A registered professional engineer or land surveyor registered in the State of New Mexico or approved by the Commission shall show on the plat the location of the well and certify this information in the space provided.
4. All distances shown on the plat must be from the outer boundaries of Section.
5. If additional space is needed for listing owners and their respective interests as required in question 3, Section A, please use space below

OIL CONSERVATION COMMISSION	
ALBUQUERQUE DISTRICT OFFICE	
No. of Wells Proposed	
Section	
County	
State	
Proposed by	
State Land Office	
U. S. G. S.	
Transfer	
File	

* "Owner" means the person who has the right to drill into and to produce from any pool and to appropriate the production either for himself or for himself and another. (65-3-29 (e) NMSA 1953 Comp.)