

NEW MEXICO  
OIL CONSERVATION COMMISSION

Form C-128

Well Location and/or Gas Proration Plat

Date 3-30-57

Operator Robert L. Bunnell Lease Stanolind- State State

Well No. 1 Section 36 Township 19 South Range 30 East NMPM

Located 2310 Feet From North Line, 1650 Feet From East Line,

Eddy County, New Mexico. G. L. Elevation 3412' above sea

Name of Producing Formation \_\_\_\_\_ Pool \_\_\_\_\_ Dedicated Acreage \_\_\_\_\_

(Note: All distances must be from outer boundaries of Section)

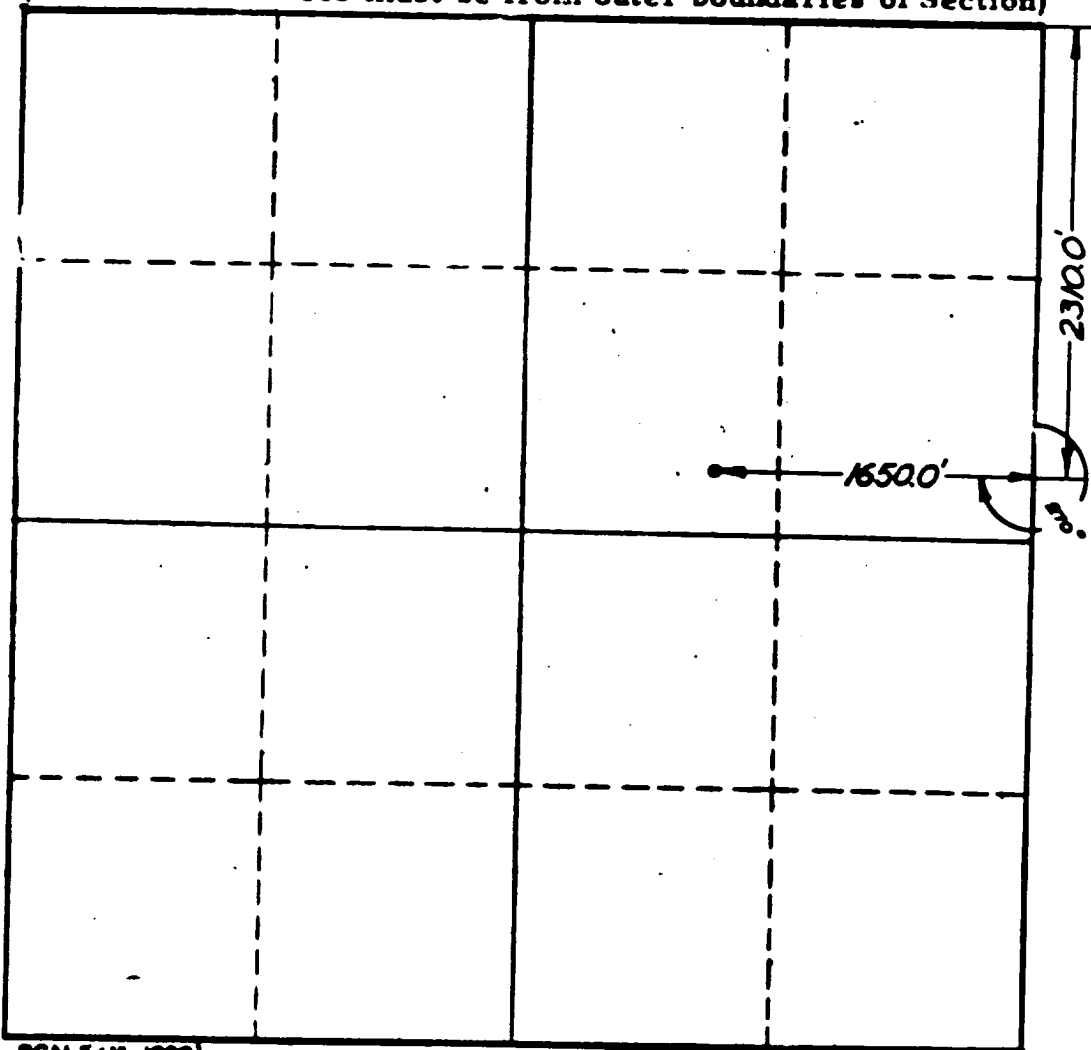

NOTE

section of  
is to be  
for gas  
only.

SCALE: 1"=1000'

this Well a Dual Comp. ? Yes  No

the answer to Question 1 is yes, are there  
other dually completed wells within the  
cated acreage? Yes  No

nting \_\_\_\_\_

This is to certify that the above plat was  
prepared from field notes of actual surveys  
made by me or under my supervision and  
that the same are true and correct to the  
best of my knowledge and belief.

Date Surveyed 3-30-57

Ben T. Phillips, Jr., L.S. # 1554

Registered  
Land Surveyor