

UNITED STATES
DEPARTMENT OF THE INTERIOR
GEOLOGICAL SURVEY

30-015-20253

APPLICATION FOR PERMIT TO DRILL, DEEPEN, OR PLUG BACK

1a. TYPE OF WORK

DRILL DEEPEN PLUG BACK

b. TYPE OF WELL

OIL WELL GAS WELL OTHER SINGLE ZONE MULTIPLE ZONE

2. NAME OF OPERATOR

H. N. Sweeney and D. L. Hannifin dba Sweeney & Hannifin *

3. ADDRESS OF OPERATOR

P. O. Box 1502, Roswell N. M. 88201

4. LOCATION OF WELL (Report location clearly and in accordance with any State requirements.)*

At surface 600 feet from west line and 535 feet from south line
Sec. 31 T. 21 S., R. 28 E., N.M.P.M.
At proposed prod. zone same

14. DISTANCE IN MILES AND DIRECTION FROM NEAREST TOWN OR POST OFFICE*

6 miles east of Carlsbad, New Mexico

15. DISTANCE FROM PROPOSED* LOCATION TO NEAREST PROPERTY OR LEASE LINE, FT. (Also to nearest drlg. unit line, if any)

660'

16. NO. OF ACRES IN LEASE

195.08

17. NO. OF ACRES ASSIGNED TO THIS WELL

37.58

18. DISTANCE FROM PROPOSED LOCATION* TO NEAREST WELL, DRILLING, COMPLETED, OR APPLIED FOR, ON THIS LEASE, FT.

None

19. PROPOSED DEPTH

4600'

20. ROTARY OR CABLE TOOLS:

Rotary

21. ELEVATIONS (Show whether DF, RT, GR, etc.)

3119 GR

22. APPROX. DATE WORK WILL START*

9-26-69

23. PROPOSED CASING AND CEMENTING PROGRAM

SIZE OF HOLE	SIZE OF CASING	WEIGHT PER FOOT	SETTING DEPTH	QUANTITY OF CEMENT
11"	8-5/8"	20#	900'	300 sacks
7-7/8"	4-1/2"	9.5#	T.D.	100 sacks

Surface casing will be set below base of salt -- expected at 850 feet. Primary objective will be test of pay found in Union Tracy No. 1 -- expected at 3,700 feet but if dry in this interval entire Cherry Canyon formation will be drilled.

Blowout preventer -- 10" Shaffer Type B Series 900 -- will be installed on 8-5/8" casing.

* Sweeney & Hannifin designated agent for Perry R. Bass, Unit Operator of Big Eddy Unit

IN ABOVE SPACE DESCRIBE PROPOSED PROGRAM: If proposal is to deepen or plug back, give data on present productive zone and proposed new productive zone. If proposal is to drill or deepen directionally, give pertinent data on subsurface locations and measured and true vertical depths. Give blowout preventer program, if any.

24. SIGNED H. N. Sweeney TITLE Operator

(This space for Federal or State office use)

PERMIT NO.

RECEIVED
SEP 19 1969
U.S. GEOLOGICAL SURVEY
ARTESIA, NEW MEXICO

RECEIVED
SEP 22 1969
D. C. E.
ARTESIA, NEW MEXICO

DECLARED WATER BASIN

CEMENT BEHIND THE CASING MUST BE CIRCULATED

APPROVED
SEP 19 1969
R. L. BEEKMAN
ACTING DISTRICT ENGINEER

THIS APPROVAL IS RESCINDED IF OPERATIONS ARE NOT COMMENCED WITHIN 3 MONTHS. EXPIRES DEC 19 1969

*See Instructions On Reverse Side

NOTIFY USGS IN SUFFICIENT TIME TO WITNESS CEMENTING THE 8 7/8" CASING.

Instructions

General: This form is designed for submitting proposals to perform certain well operations, as indicated, on all types of lands and leases for appropriate action by either a Federal or a State agency, or both, pursuant to applicable Federal and/or State laws and regulations. Any necessary special instructions concerning the use of this form and the number of copies to be submitted, particularly with regard to local, area, or regional procedures and practices, either are shown below or will be issued by, or may be obtained from, the local Federal and/or State office.

Item 1: If the proposal is to redrill to the same reservoir at a different subsurface location or to a new reservoir, use this form with appropriate notations. Consult applicable State or Federal regulations concerning subsequent work proposals or reports on the well.

Item 4: If there are any applicable State requirements, locations on Federal or Indian land should be described in accordance with Federal requirements. Consult local State or Federal office for specific instructions.

Item 14: Needed only when location of well cannot readily be found by road from the land or lease description. A plat, or plats, separate or on this reverse side, showing the roads to, and the surveyed location of, the well, and any other required information, should be furnished when required by Federal or State agency offices.

Items 15 and 18: If well is to be, or has been directionally drilled, give distances for subsurface location of hole in any present or objective production zone.

Item 22: Consult applicable Federal or State regulations, or appropriate officials, concerning approval of the proposal before operations are started.

N MEXICO OIL CONSERVATION COMMISS
WELL LOCATION AND ACREAGE DEDICATION PLAT

Form C-102
Supersedes C-128
Effective 1-1-65

All distances must be from the outer boundaries of the Section.

Operator Sweeney & Hannifin		Lease Big Eddy Unit		Well No. 31
Unit Letter M	Section 31	Township 21 S	Range 28 E	County Eddy
Actual Footage Location of Well: 535 feet from the N South line and 660 feet from the West line				
Ground Level Elev: 3119	Producing Formation	Pool Wildcat	Dedicated Acreage: xxx 37.53 Acres	

- Outline the acreage dedicated to the subject well by colored pencil or hachure marks on the plat below.
- If more than one lease is dedicated to the well, outline each and identify the ownership thereof (both as to working interest and royalty).
- If more than one lease of different ownership is dedicated to the well, have the interests of all owners been consolidated by communitization, unitization, force-pooling, etc?

RECEIVED
SEP 22 1969
D. C. C.
ARTERIA OFFICE

Yes No If answer is "yes," type of consolidation _____
If answer is "no," list the owners and tract descriptions which have actually been consolidated. (Use reverse side of this form if necessary.) _____

No allowable will be assigned to the well until all interests have been consolidated (by communitization, unitization, forced-pooling, or otherwise) or until a non-standard unit, eliminating such interests, has been approved by the Commission.

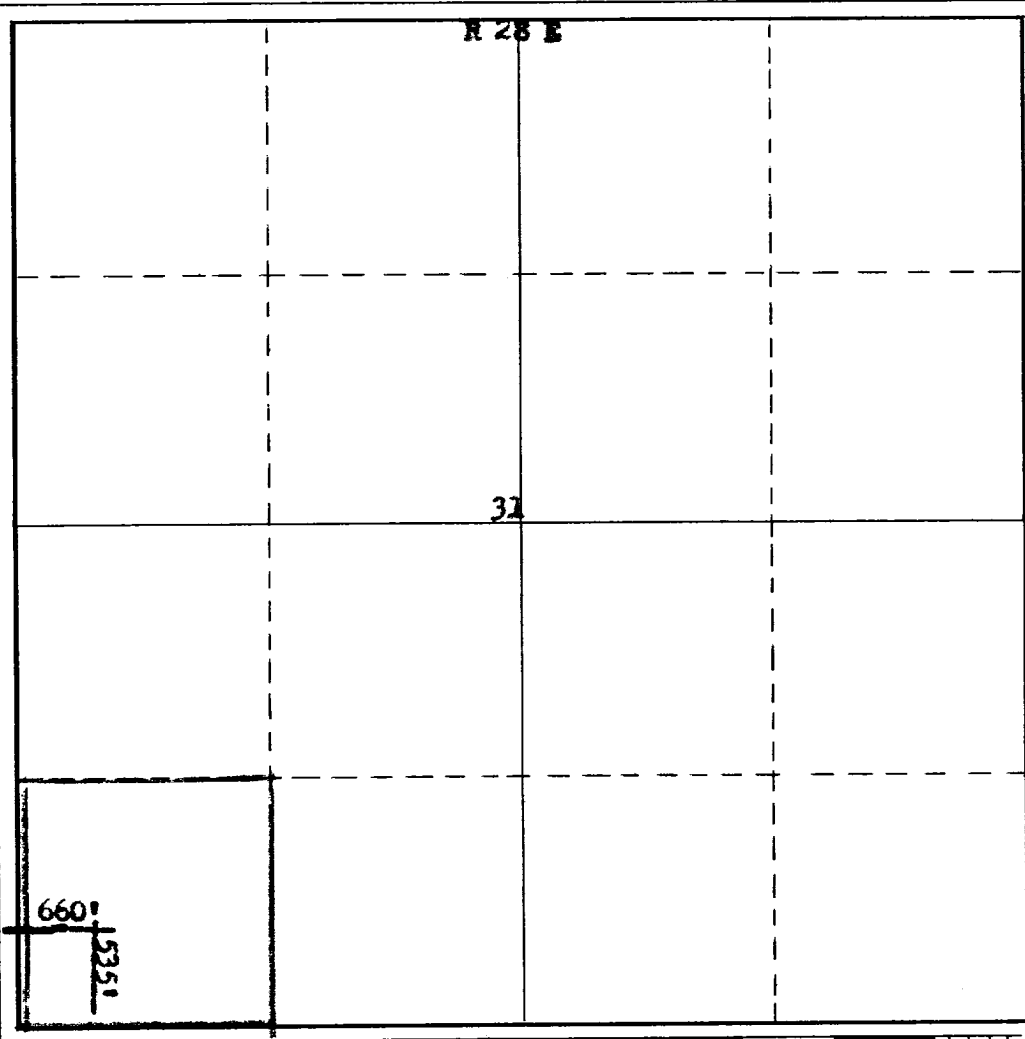

CERTIFICATION

I hereby certify that the information contained herein is true and complete to the best of my knowledge and belief.

H. M. Sweeney
Name

Operator
Position

Sweeney & Hannifin
Company

Date **9-19-69**

I hereby certify that the well location shown on this plat was plotted from field notes of actual surveys made by me or under my supervision, and that the same is true and correct to the best of my knowledge and belief.

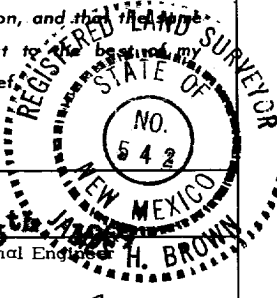

Date Surveyed

September 18, 1969
Registered Professional Engineer and/or Land Surveyor

James H. Brown
Certificate No.

542

