

Amended 11/27/73

N. M. O. C. C. COMMISSION
NEW MEXICO OIL CONSERVATION COMMISSION
WELL LOCATION AND ACREAGE DEDICATION PLAT

Form O-162
Supersedes O-128
Effective 1-1-67

All distances must be from the outer boundaries of the Section.

EL PASO NATURAL GAS COMPANY			Lease PATTERSON		Well No. A-1
Section 20	Township 22 South	Range 22 East	County Eddy		
Approximate Location of Well 2310 feet from the West line and 660 feet from the South line					
Well Flow 4477	Production Formation Rocky Arroyo	Pool Wolfcamp		Dedicated Acreage 160	

RECEIVED

NOV 29 1973

- Outline the acreage dedicated to the subject well by colored pencil or hatchure marks on the plat below.
- If more than one lease is dedicated to the well, outline each and identify the ownership thereof (both as to working interest and royalty).
- If more than one lease of different ownership is dedicated to the well, have the interests of all owners been consolidated by communitization, unitization, force-pooling, etc?

Yes No If answer is "yes," type of consolidation _____

If answer is "no," list the owners and tract descriptions which have actually been consolidated. (Use reverse side of this form if necessary.) Will be unitized if commercial production is established.

No allowable will be assigned to the well until all interests have been consolidated (by communitization, unitization, force-pooling, or otherwise) or until a non-standard unit, eliminating such interests, has been approved by the Commission.

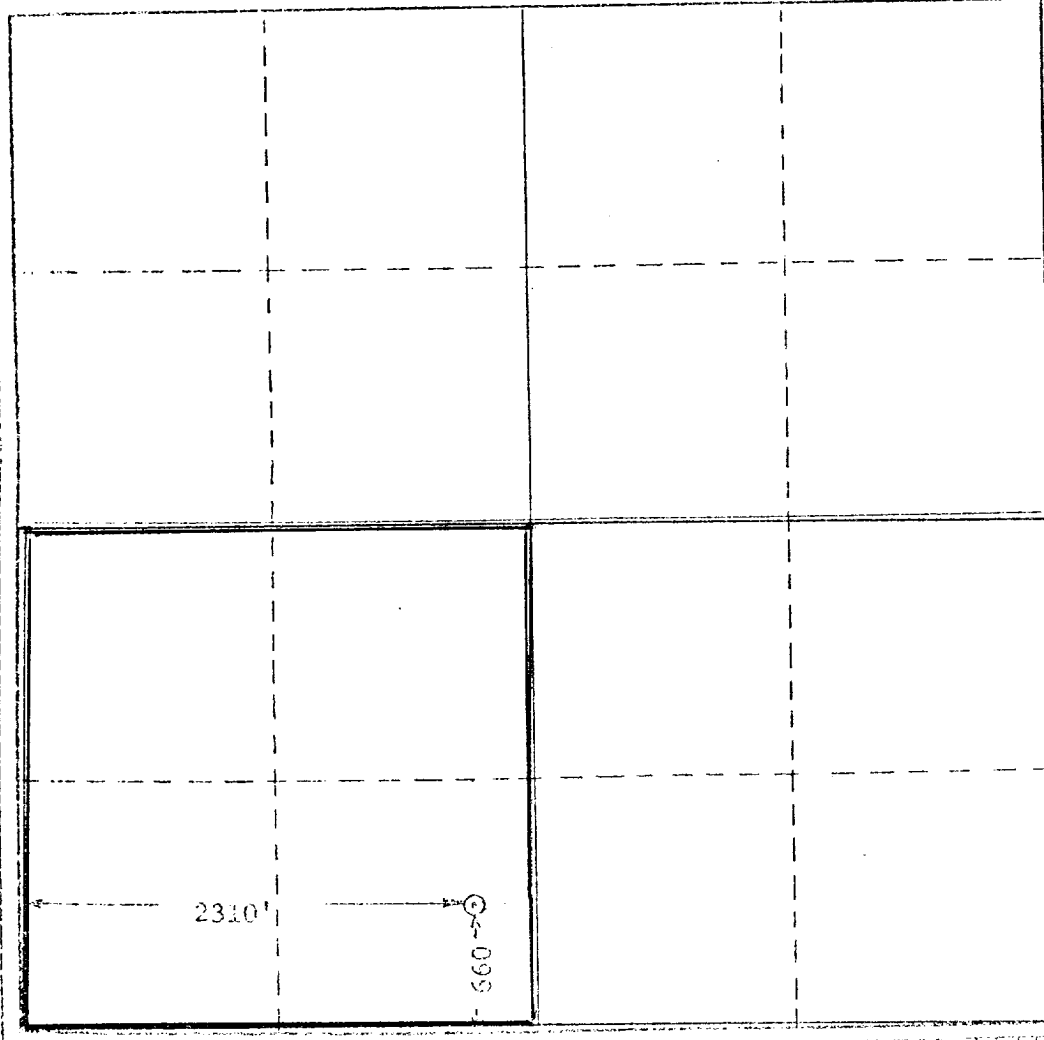

CERTIFICATION

I hereby certify that the information contained herein is true and complete to the best of my knowledge and belief.

C. D. Lyman
Name

Production Clerk
Position

El Paso Natural Gas
Company

August 28, 1973
Date

I hereby certify that the well location shown on this plat was plotted from field notes or actual surveys made by me or under my supervision and that the same is true and correct to the best of my knowledge and belief.

RECEIVED

J. D. Quinn
Geological Survey
Alameda, New Mexico

August 23, 1973
Date Surveyed

Registered Professional Engineer and/or Land Surveyor

J. D. Quinn
Certificate No. 114