

Exxon Lse. No. _____

NEW MEXICO OIL CONSERVATION COMMISSION

Form C-102
Supersedes C-128
Effective 1-4-65

State Lse. No. _____

WELL LOCATION AND ACREAGE DEDICATION PLAT

Federal Lse. No. _____

All distances must be from the outer boundaries of the Section.

Operator Exxon Corporation		Lease Yates Federal <i>Yates</i>		Well No. 2
-------------------------------	--	-------------------------------------	--	---------------

Unit Letter J	Section 31	Township 20 S	Range 28 E	County Eddy
------------------	---------------	------------------	---------------	----------------

Actual Footage Location of Well:
1980 feet from the East line and 1980 feet from the South line

Ground Level Elev. 3229'	Producing Formation Atoka (Gas)	Pool W. Burton Flat (Undesignated)	Dedicated Acreage: 320.57 Acres
-----------------------------	------------------------------------	---------------------------------------	------------------------------------

- Outline the acreage dedicated to the subject well by colored pencil or hachure marks on the plat below.
- If more than one lease is dedicated to the well, outline each and identify the ownership thereof (both as to working interest and royalty).
- If more than one lease of different ownership is dedicated to the well, have the interests of all owners been consolidated by communitization, unitization, force-pooling, etc?

Yes No If answer is "yes," type of consolidation _____

If answer is "no," list the owners and tract descriptions which have actually been consolidated. (Use reverse side of this form if necessary.) _____

No allowable will be assigned to the well until all interests have been consolidated (by communitization, unitization, forced-pooling, or otherwise) or until a non-standard unit, eliminating such interests, has been approved by the Commission.

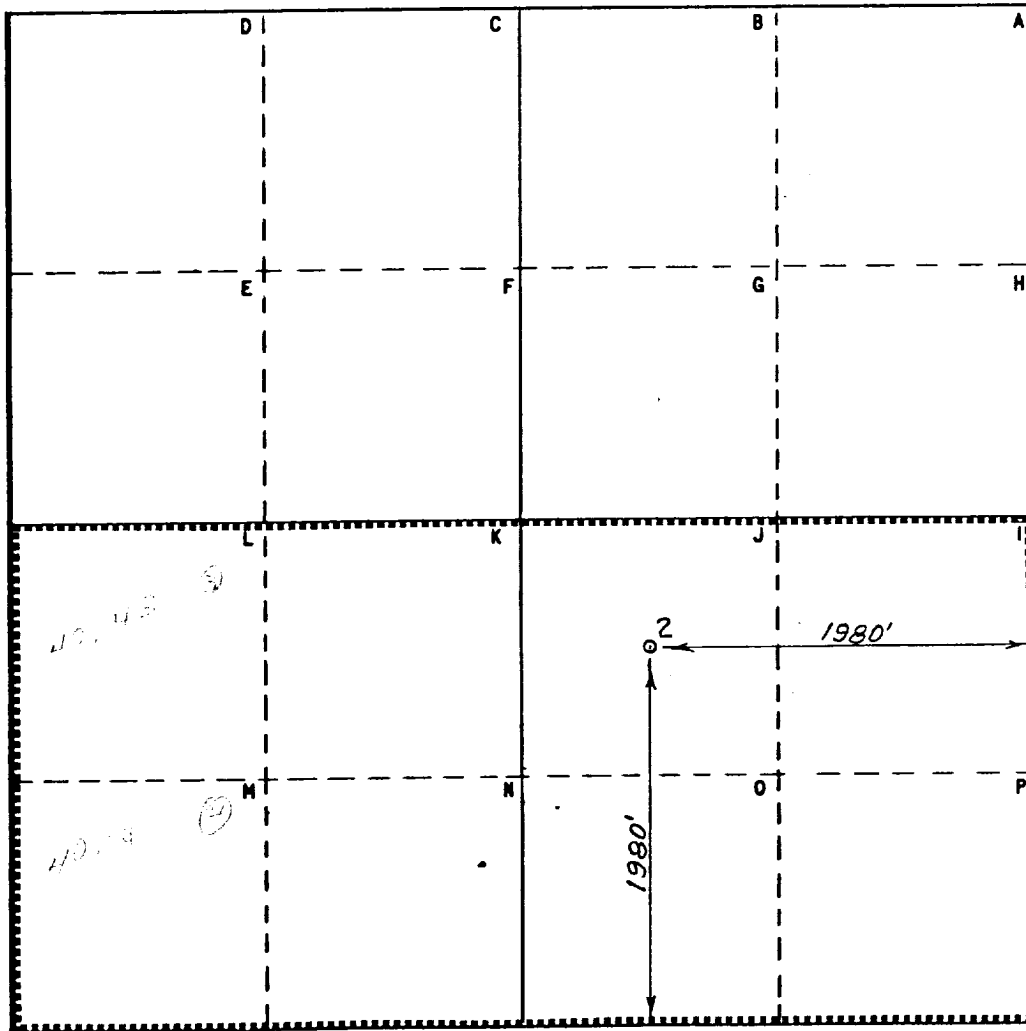

CERTIFICATION

I hereby certify that the information contained herein is true and complete to the best of my knowledge and belief.

Name
Melba Knippling

Position
Proration Specialist

Company Exxon Corporation
Box 1600 Midland, Texas

Date
12-17-81

I hereby certify that the well location shown on this plat was plotted from field notes of actual surveys made by me or under my supervision, and that the same is true and correct to the best of my knowledge and belief.

Date Surveyed
12-11-81

Registered Professional Engineer and/or Land Surveyor

G. S. Hesterfeld

Certificate No.
1382

