

DISTRICT I
 P. O. Box 1980
 Hobbs, NM 88240

OIL CONSERVATION DIVISION
 P. O. Box 2088
 Santa Fe, New Mexico 87504-2088

RECEIVED
 AUG - 7 1992
 O. C. D.
 OFFICE

DISTRICT II
 P. O. Drawer DD
 Artesia, NM 88210

DISTRICT III
 1000 Rio Brazos Rd
 Aztec, NM 87410

WELL LOCATION AND ACREAGE DEDICATION PLAT
 All distances must be from the outer boundaries of the section.

Operator ENRON OIL & GAS COMPANY			Lease POKER LAKE "32" STATE		Well No. 8
Unit Letter E	Section 32	Township 23 SOUTH	Range 31 EAST, N.M.P.M.	County EDDY	
Actual Footage Location of Well					
1980 feet from the NORTH line and		660 feet from the WEST line			
Ground Level Elev. 3349'	Producing Formation Delaware	Pool Wildcat	Acres 40		

- Outline the acreage dedicated to the subject well by colored pencil or hachure marks on the plat below.
- If more than one lease is dedicated to the well, outline each and identify the ownership thereof (both as to working interest and royalty).
- If more than one lease of different ownership is dedicated to the well, have the interest of all the owners been consolidated by communitization, unitization, forced-pooling, etc.?
 - Yes No If answer is "yes", type of consolidation _____
 - If the answer is "no", list the owners and tract descriptions which have actually been consolidated. (Use the reverse side of this form if necessary.) _____
 - No allowable will be assigned to the well until all interests have been consolidated (by communitization, unitization, forced-pooling, or otherwise) or until a non-standard unit, eliminating such interest, has been approved by the division.

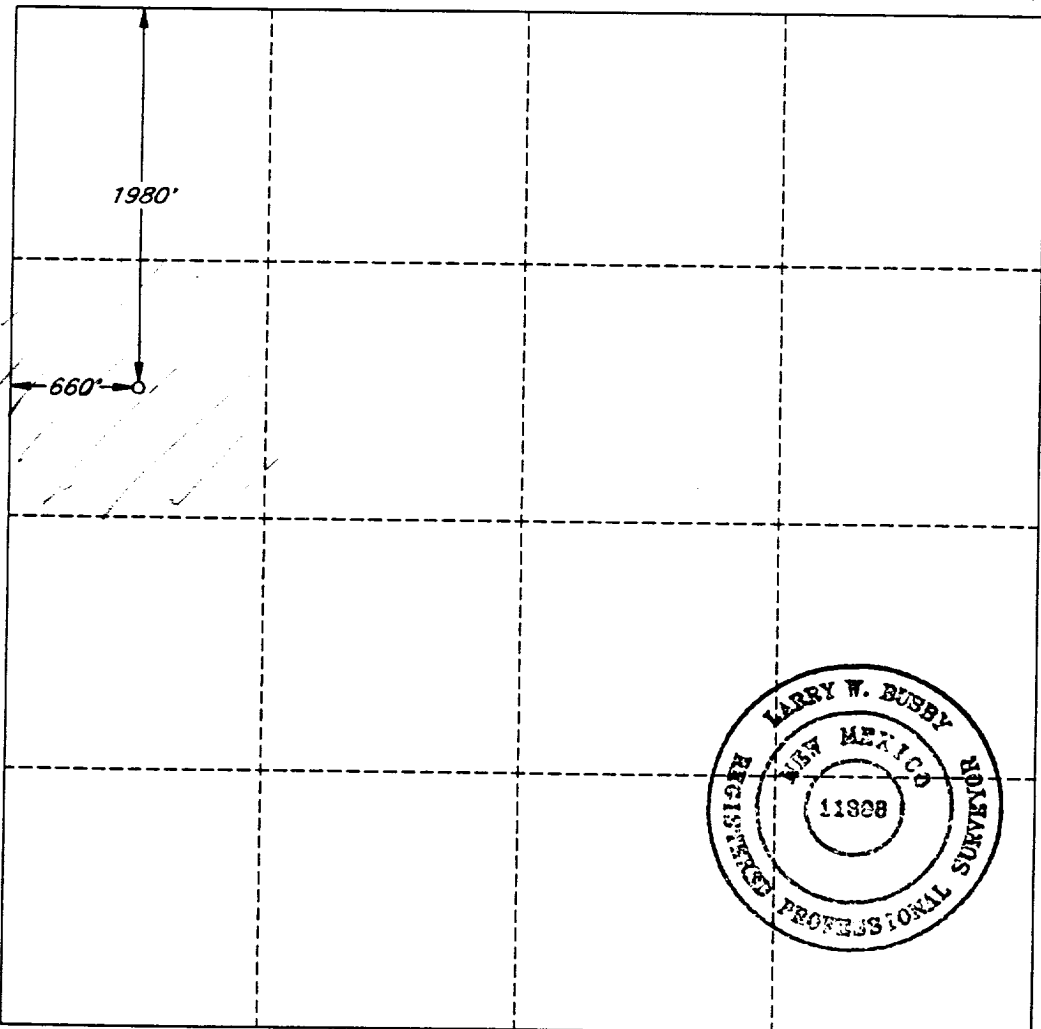

OPERATOR CERTIFICATION

I hereby certify that the information herein is true and complete to the best of my knowledge and belief.

Signature <i>Betty Gildon</i>
Printed Name Betty Gildon
Position Regulatory Analyst
Company Enron Oil & Gas Company
Date 7/24/92

SURVEYOR CERTIFICATION

I hereby certify that the well location shown on this plat was plotted from field notes of actual surveys made by me or under my supervision, and that the same is true and correct to the best of my knowledge and belief.

Date Surveyed JULY 17, 1992
Signature and Seal of Professional Surveyor <i>Larry W. Busby</i>
Certificate No. LARRY W. BUSBY R.P.S. #11308
cdg

