

NM OIL CONS. COMMISSION  
Drawer DD  
Artesia, NM UNITED STATES  
DEPARTMENT OF THE INTERIOR  
GEOLOGICAL SURVEY

RECEIVED

SUBMIT IN TR DATE

AUG 4 1982

30-015-24249  
Form approved.  
Budget Bureau No. 42-R1425

O. C. D.

5. LEASE DESIGNATION AND SERIAL NO.	NM 13997
6. IN INDIAN ALLOTTEE OR TRIBE NAME	
7. UNIT AGREEMENT NAME	
8. FARM OR LEASE NAME	EP USA
9. WELL NO.	3
10. FIELD AND POOL, OR WILDCAT	Brushy
11. SEC., T., R., M., OR BLK. AND SURVEY OR AREA	Section 26, T-26 S, R-29 E
12. COUNTY OR PARISH	Eddy
13. STATE	New Mexico

APPLICATION FOR PERMIT TO DRILL, DEEPEN, OR PLUG BACK

1a. TYPE OF WORK  
DRILL  DEEPEN  PLUG BACK

b. TYPE OF WELL  
OIL WELL  GAS WELL  OTHER   
SINGLE ZONE  MULTIPLE ZONE

2. NAME OF OPERATOR  
J. C. Williamson

3. ADDRESS OF OPERATOR  
P. O. Box 16 Midland, Texas 79702

4. LOCATION OF WELL (Report location clearly and in accordance with any State requirements.)\*  
At surface  
1980' FSL & 460' FEL  
At proposed prod. zone  
1980' FSL & 460' FEL

14. DISTANCE IN MILES AND DIRECTION FROM NEAREST TOWN OR POST OFFICE\*  
14 Miles SE of Malaga, New Mexico

15. DISTANCE FROM PROPOSED\* LOCATION TO NEAREST PROPERTY OR LEASE LINE, FT. (Also to nearest drlg. unit line, if any) 460'  
16. NO. OF ACRES IN LEASE 280  
17. NO. OF ACRES ASSIGNED TO THIS WELL 40

18. DISTANCE FROM PROPOSED LOCATION\* TO NEAREST WELL, DRILLING, COMPLETED, OR APPLIED FOR, ON THIS LEASE, FT. 460'  
19. PROPOSED DEPTH 6250'  
20. ROTARY OR ~~XXXXXXXXXX~~ Rotary

21. ELEVATIONS (Show whether DF, RT, GR, etc.)  
2904.0 GR  
22. APPROX. DATE WORK WILL START\*  
August 15, 1982

23. PROPOSED CASING AND CEMENTING PROGRAM

SIZE OF HOLE	SIZE OF CASING	WEIGHT PER FOOT	SETTING DEPTH	QUANTITY OF CEMENT
17 1/2"	12 3/4"	35#	350'	300 sx
11"	8 5/8"	24# & 32#	2900'	150 sx tie back to base of salt
7 7/8"	4 1/2"	10.5#	6250'	750 sx

pooped VOI  
API + NY BOOKS  
8-26-82

RECEIVED  
AUG 10 1982

OIL & GAS  
U.S. GEOLOGICAL SURVEY  
ROSWELL, NEW MEXICO

IN ABOVE SPACE DESCRIBE PROPOSED PROGRAM: If proposal is to deepen or plug back, give data on present productive zone and proposed new productive zone. If proposal is to drill or deepen directionally, give pertinent data on subsurface locations and measured and true vertical depths. Give blowout preventer program, if any.

24. SIGNED *George H. Stewart* TITLE Production Secretary DATE 8/3/82

(This space for Federal or State approval) PERMIT NO. APPROVAL DATE

APPROVED BY *JAMES A. GILLHAM* TITLE DISTRICT SUPERVISOR DATE

NE EXICO OIL CONSERVATION COMMISSIC  
WELL LOCATION AND ACREAGE DEDICATION PLAT

Form C-102  
Supersedes C-128  
Effective 1-1-65

All distances must be from the outer boundaries of the Section.

Operator J. C. WILLIAMSON		Lease EP USA			Well No. 3
Unit Letter I	Section 26	Township 26 SOUTH	Range 29 EAST	County EDDY	
Actual Footage Location of Well:					
1980 feet from the SOUTH line and		460 feet from the EAST line			
Ground Level Elev. 2904.0	Producing Formation BRUSHY CANYON	Pool <i>Unch</i> BRUSHY <del>DRAW</del> <i>Canyon</i>	Dedicated Acreage: 40 Acres		

1. Outline the acreage dedicated to the subject well by colored pencil or hachure marks on the plat below.
2. If more than one lease is dedicated to the well, outline each and identify the ownership thereof (both as to working interest and royalty). N/A
3. If more than one lease of different ownership is dedicated to the well, have the interests of all owners been consolidated by communitization, unitization, force-pooling, etc?

Yes  No If answer is "yes," type of consolidation N/A

If answer is "no," list the owners and tract descriptions which have actually been consolidated. (Use reverse side of this form if necessary.) N/A

No allowable will be assigned to the well until all interests have been consolidated (by communitization, unitization, forced-pooling, or otherwise) or until a non-standard unit, eliminating such interests, has been approved by the Commission.

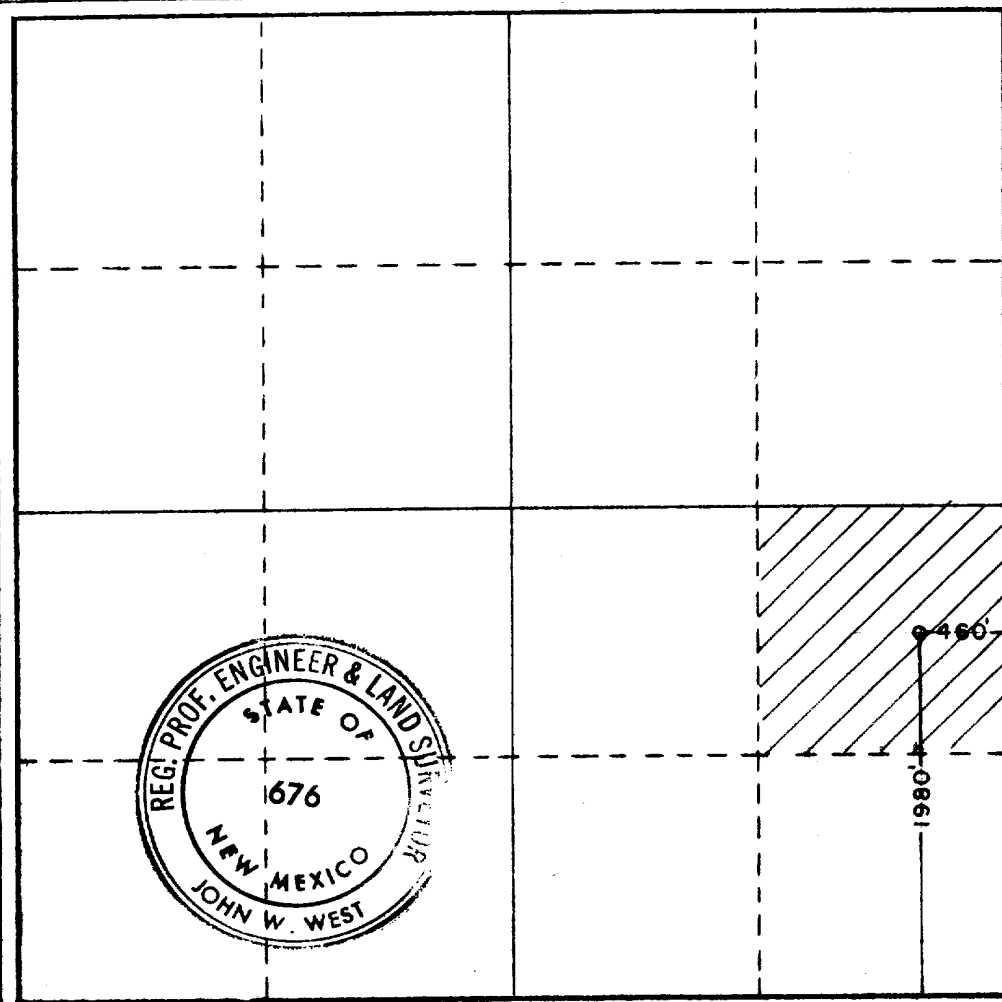

CERTIFICATION

I hereby certify that the information contained herein is true and complete to the best of my knowledge and belief.

*John V. Crawford*  
Name

Jamie V. Crawford

Position

Production Secretary

Company

J. C. Williamson

Date

8/5/82

I hereby certify that the well location shown on this plat was plotted from field notes of actual surveys made by me or under my supervision, and that the same is true and correct to the best of my knowledge and belief.

3 AUGUST 1982

Date Surveyed

Registered Professional Engineer and/or Land Surveyor

*John W. West*

Certificate No. JOHN W. WEST 676  
PATRICK A. ROMERO 668  
RONALD J. EIDSON 3238

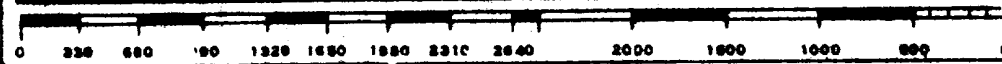

*John*

SUPPLEMENTAL DRILLING DATA

J. C. WILLIAMSON  
WELL #3 EP-USA

1. SURFACE FORMATION: Quaternary Alluvium

2. ESTIMATED TOPS OF GEOLOGIC MARKERS:

Rustler Anhydrite	450'
Lamar	3000'
Ramsey Sand	3025'
Olds Sand	3050'
Top Cherry Canyon	4150'
Top Brushy Canyon	5100'

3. ANTICIPATED POSSIBLE WATER AND HYDROCARBON BEARING ZONES:

Fresh Water	above 300'
Delaware (Oil)	3025' - 3075'
Brushy Canyon (Oil)	5100' - 5150'
Lower Brushy Canyon	6150' - 6200'

4. PROPOSED CASING AND CEMENTING PROGRAM:

Casing program is shown on Form 9-331 C.

Hole for surface casing will be drilled to a depth below fresh water zones. Surface casing will then be run to bottom and cemented to the surface to protect fresh water zones. 12 3/4" pipe will be run and cemented at 350 feet.

8 5/8" pipe will be run and cemented at 2900 feet, prior to entering Delaware section.

12 3/4" surface casing will be cemented to the surface with 300 sacks of Class "C" cement.

8 5/8" protection casing will be cemented with 150 sacks of Class "C" cement at 2900 feet, tying back into the base of the salt.

4 1/2" in production casing will be cemented at total depth or shallower if significant shows are encountered in the Brushy Canyon formation.

5. PRESSURE CONTROL EQUIPMENT:

Pressure control equipment will consist of a dual ram hydraulically controlled blow out preventer.

6. CIRCULATING MEDIUM:

The circulating medium will be fresh water down to 350 feet and brine water in the rest of the hole.

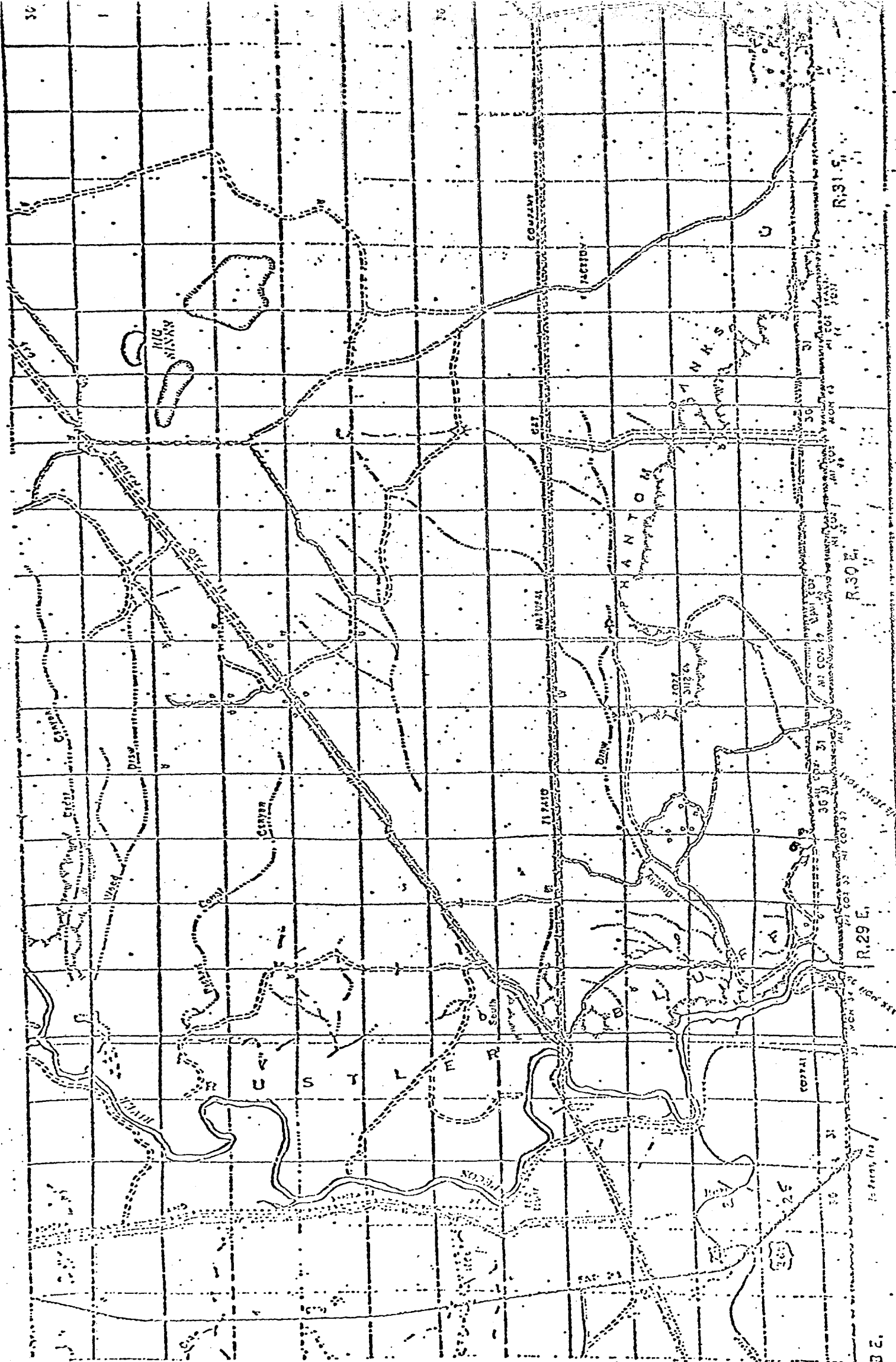

EXHIBIT "A"  
 J. C. Williamson  
 EP-USA  
 Well #3

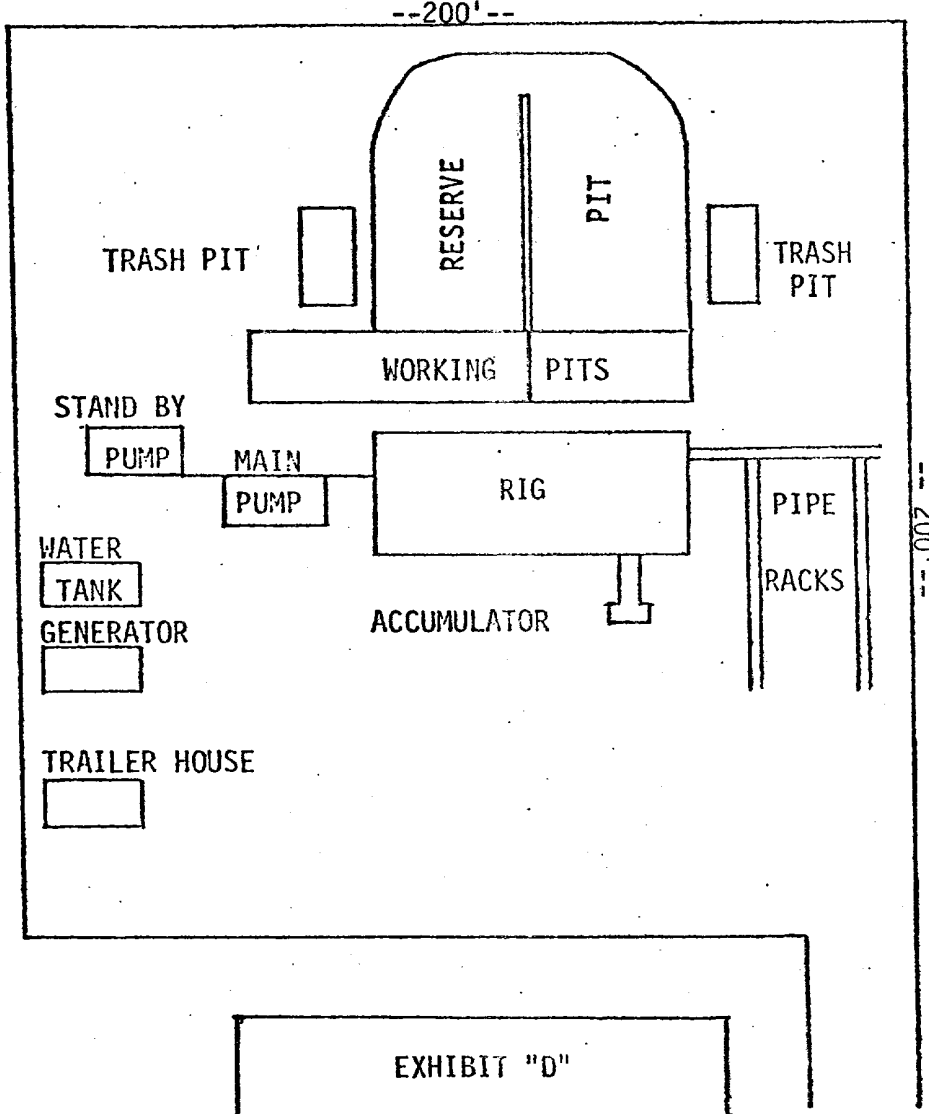
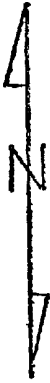

EXHIBIT "D"  
J. C. Williamson  
EP-USA #3