

DATE IN	SUSPENSE	ENGINEER	LOGGED IN	TYPE	APP NO.
---------	----------	----------	-----------	------	---------

ABOVE THIS LINE FOR DIVISION USE ONLY

NEW MEXICO OIL CONSERVATION DIVISION

- Engineering Bureau -

1220 South St. Francis Drive, Santa Fe, NM 87505



79

30-005-62630 Estellita AFO Federal Com #1

ADMINISTRATIVE APPLICATION CHECKLIST

THIS CHECKLIST IS MANDATORY FOR ALL ADMINISTRATIVE APPLICATIONS FOR EXCEPTIONS TO DIVISION RULES AND REGULATIONS WHICH REQUIRE PROCESSING AT THE DIVISION LEVEL IN SANTA FE

Application Acronyms:

[NSL-Non-Standard Location] [NSP-Non-Standard Proration Unit] [SD-Simultaneous Dedication]
[DHC-Downhole Commingling] [CTB-Lease Commingling] [PLC-Pool/Lease Commingling]
[PC-Pool Commingling] [OLS - Off-Lease Storage] [OLM-Off-Lease Measurement]
[WFX-Waterflood Expansion] [PMX-Pressure Maintenance Expansion]
[SWD-Salt Water Disposal] [IPI-Injection Pressure Increase]
[EOR-Qualified Enhanced Oil Recovery Certification] [PPR-Positive Production Response]

[1] TYPE OF APPLICATION - Check Those Which Apply for [A]

[A] Location - Spacing Unit - Simultaneous Dedication
☐ NSL ☐ NSP ☐ SD

Check One Only for [B] or [C]

[B] Commingling - Storage - Measurement
☒ DHC ☐ CTB ☐ PLC ☐ PC ☐ OLS ☐ OLM

[C] Injection - Disposal - Pressure Increase - Enhanced Oil Recovery
☐ WFX ☐ PMX ☐ SWD ☐ IPI ☐ EOR ☐ PPR

[D] Other: Specify _____

RECEIVED
 APR 26 2004
 OCB-ARTESIA

[2] NOTIFICATION REQUIRED TO: - Check Those Which Apply, or ☒ Does Not Apply

- [A] ☐ Working, Royalty or Overriding Royalty Interest Owners
 [B] ☐ Offset Operators, Leaseholders or Surface Owner
 [C] ☐ Application is One Which Requires Published Legal Notice
 [D] ☐ Notification and/or Concurrent Approval by BLM or SLO
U.S. Bureau of Land Management - Commissioner of Public Lands, State Land Office
 [E] ☐ For all of the above, Proof of Notification or Publication is Attached, and/or,
 [F] ☐ Waivers are Attached

[3] SUBMIT ACCURATE AND COMPLETE INFORMATION REQUIRED TO PROCESS THE TYPE OF APPLICATION INDICATED ABOVE.

[4] **CERTIFICATION:** I hereby certify that the information submitted with this application for administrative approval is **accurate** and **complete** to the best of my knowledge. I also understand that **no action** will be taken on this application until the required information and notifications are submitted to the Division.

Note: Statement must be completed by an individual with managerial and/or supervisory capacity.

Cherry Matchus

Print or Type Name

Cherry Matchus
Signature

Engineering Technician

Title

4-21-04

Date

e-mail Address

District I
1625 N. French Drive, Hobbs, NM 88240

District II
811 South First Street, Artesia, NM 88210

District III
1000 Rio Brazos Road, Aztec, NM 87410

Pools

District IV
WELLBORE

2040 South Pacheco, Santa Fe, NM 87505

State of New Mexico
Energy, Minerals and Natural Resources Department

Form C-107A
Revised May 15, 2000

OIL CONSERVATION DIVISION

2040 South Pacheco
Santa Fe, New Mexico 87505

APPLICATION TYPE

☒ Single Well
☐ Establish Pre-Approved

EXISTING

APPLICATION FOR DOWNHOLE COMMINGLING

☒ Yes ☐ No

Yates Petroleum Corporation 105 South Fourth Street Artesia, New Mexico 88210
Operator Address
Estellita AFO Federal Com 1 H 15 14S 27E Chaves
Lease Well No. Unit Letter-Section-Township-Range County
OGRID No. 025575 Property Code API No. 30-005-62630 Lease Type: ☒ Federal ☐ State ☐ Fee

DATA ELEMENT	UPPER ZONE	INTERMEDIATE ZONE	LOWER ZONE
Pool Name	Springer Basin Strawn		Springer Basin Atoka Morrow
Pool Code			
Top and Bottom of Pay Section (Perforated or Open-Hole Interval)	7442-7548'		7649-7721'
Method of Production (Flowing or Artificial Lift)	Flowing		Flowing
Bottomhole Pressure (Note: Pressure data will not be required if the bottom perforation in the lower zone is within 150% of the depth of the top perforation in the upper zone)	NA		NA
Oil Gravity or Gas BTU (Degree API or Gas BTU)	NA		NA
Producing, Shut-In or New Zone	New Zone		Producing
Date and Oil/Gas/Water Rates of Last Production. (Note: For new zones with no production history, applicant shall be required to attach production estimates and supporting data.	Date: Rates: Will submit Rates and Allocation Formula upon completion		Date: 4/4/04 Rates: 28 mcf/d 0 bwpd 0 bopd
Fixed Allocation Percentage (Note: If allocation is based upon something other than current or past production, supporting data or explanation will be required.)	Oil % Gas %		Oil % Gas %

ADDITIONAL DATA

Are all working, royalty and overriding royalty interests identical in all commingled zones? Yes ☒ No ☒

If not, have all working, royalty and overriding royalty interest owners been notified by certified mail? Yes ☒ No ☐

Are all produced fluids from all commingled zones compatible with each other? Yes ☒ No ☐

Will commingling decrease the value of production? Yes ☐ No ☒

If this well is on, or communitized with, state or federal lands, has either the Commissioner of Public Lands or the United States Bureau of Land Management been notified in writing of this application? Yes ☐ No ☐

NMOCD Reference Case No. applicable to this well: _____

Attachments:

- C-102 for each zone to be commingled showing its spacing unit and acreage dedication.
- Production curve for each zone for at least one year. (If not available, attach explanation.)
- For zones with no production history, estimated production rates and supporting data.
- Data to support allocation method or formula.
- Notification list of working, royalty and overriding royalty interests for uncommon interest cases.
- Any additional statements, data or documents required to support commingling.

PRE-APPROVED POOLS

If application is to establish Pre-Approved Pools, the following additional information will be required:

- List of other orders approving downhole commingling within the proposed Pre-Approved Pools
- List of all operators within the proposed Pre-Approved Pools
- Proof that all operators within the proposed Pre-Approved Pools were provided notice of this application.
- Bottomhole pressure data.

I hereby certify that the information above is true and complete to the best of my knowledge and belief.

SIGNATURE James W. Pringle TITLE Operations Engineer DATE: 04/21/04
TYPE OR PRINT NAME James W. Pringle TELEPHONE NO. (505)-748-4182

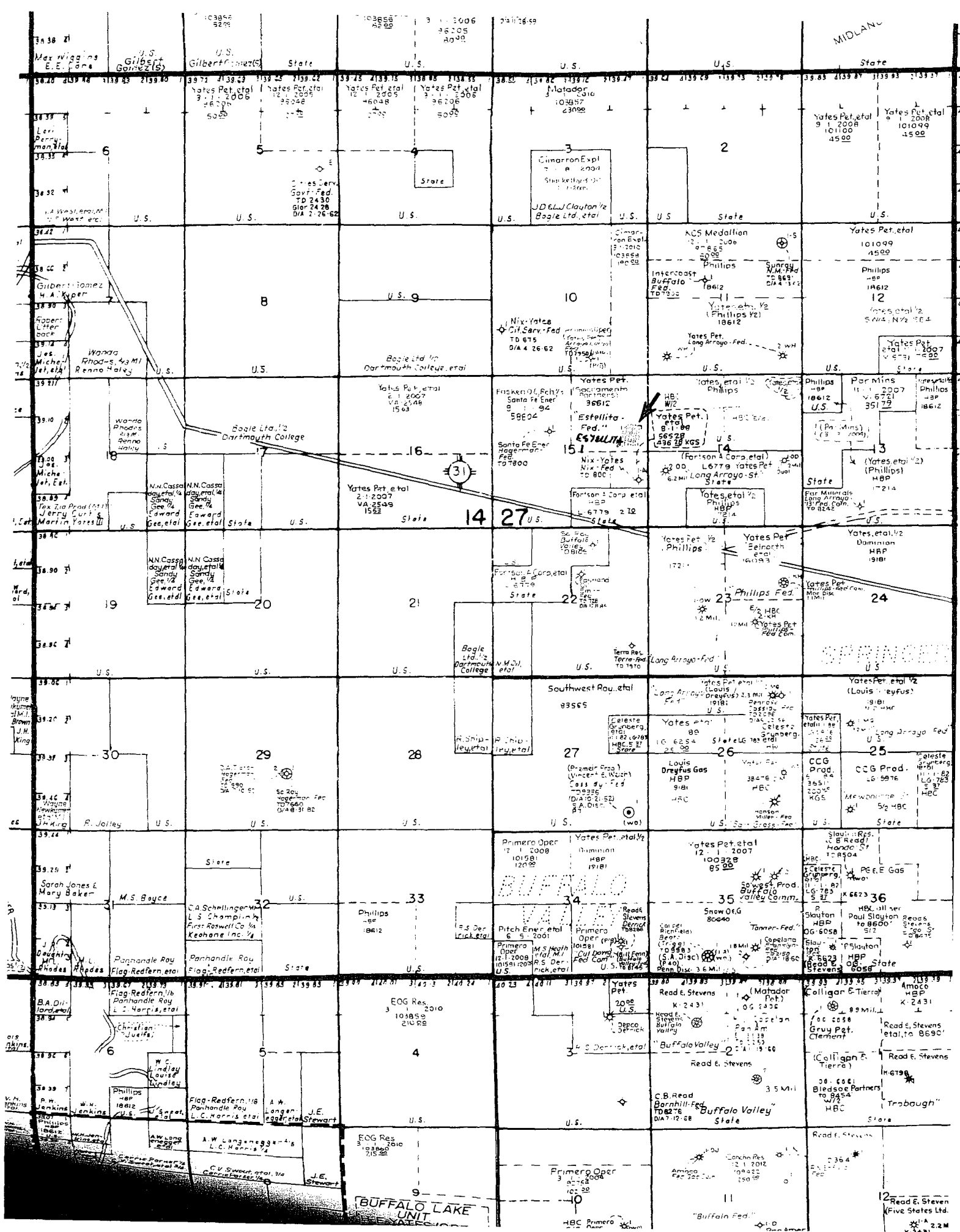

MARTIN YATES, III
1912 - 1985
FRANK W. YATES
1936 - 1986



105 SOUTH FOURTH STREET
ARTESIA, NEW MEXICO 88210-2118
TELEPHONE (505) 748-1471

S. P. YATES
CHAIRMAN OF THE BOARD
JOHN A. YATES
PRESIDENT
PEYTON YATES
EXECUTIVE VICE PRESIDENT
RANDY G. PATTERSON
SECRETARY
DENNIS G. KINSEY
TREASURER

April 21, 2004

Tim Gum
State of New Mexico
OIL CONSERVATION DIVISION
1301 W. Grand Street
Artesia, NM 88210

Dear Mr. Gum,

Yates Petroleum Corporation hereby seeks administrative approval to downhole commingle the production from the Springer Basin Atoka Morrow and the Springer Basin Strawn in our Estellita AFO Federal Com #1, located in Unit of Section 15, Township 14S, Range 27 East, Chaves County.

If you have any questions or need additional information, please call me at (505) 748-4182

Sincerely,

James W. Pringle
Operations Engineer

JWP/Cm

Enclosure

RECEIVED

APR 26 2004

OED-ARTESIA

MARTIN YATES, III
1912 - 1985
FRANK W. YATES
1936 - 1986



105 SOUTH FOURTH STREET
ARTESIA, NEW MEXICO 88210-2118
TELEPHONE (505) 748-1471

S. P. YATES
CHAIRMAN OF THE BOARD
JOHN A. YATES
PRESIDENT
PEYTON YATES
EXECUTIVE VICE PRESIDENT
RANDY G. PATTERSON
SECRETARY
DENNIS G. KINSEY
TREASURER

April 21, 2004

David Catanach
State of New Mexico
OIL CONSERVATION DIVISION
1220 South Saint Francis Drive
Santa Fe, NM 87505

Dear Mr. Catanach,

Yates Petroleum Corporation hereby seeks administrative approval to downhole commingle the production from the Springer Basin Atoka Morrow and the Springer Basin Strawn in our Estellita AFO Federal Com #1, located in Unit of Section 15, Township 14S, Range 27 East, Chaves County.

If you have any questions or need additional information, please call me at (505) 748-4182

Sincerely,

James W. Pringle
Operations Engineer

JWP/Cm

Enclosure

RECEIVED

APR 26 2004

000-ARTESIA

MARTIN YATES, III
1912 - 1985
FRANK W. YATES
1936 - 1986



105 SOUTH FOURTH STREET
ARTESIA, NEW MEXICO 88210-2118
TELEPHONE (505) 748-1471

S. P. YATES
CHAIRMAN OF THE BOARD
JOHN A. YATES
PRESIDENT
PEYTON YATES
EXECUTIVE VICE PRESIDENT
RANDY G. PATTERSON
SECRETARY
DENNIS G. KINSEY
TREASURER

April 21, 2004

Armando Lopez
Bureau of Land Management
2909 2nd Street
Roswell, New Mexico 88201

Dear Mr. Lopez;

Yates Petroleum Corporation hereby seeks administrative approval to downhole commingle the production from the Springer Basin Atoka Morrow and the Springer Basin Strawn in our Estellita AFO Federal Com #1, located in Unit of Section 15, Township 14S, Range 27 East, Chaves County.

If you have any questions or need additional information, please call me at (505) 748-4182

Sincerely,

James W. Pringle
Operations Engineer

JWP/Cm

Enclosure

RECEIVED
APR 26 2004
OED-ARTESIA

District I

1625 N. French Dr., Hobbs, NM 88240

District II

811 South First, Artesia, NM 88210

District III

1000 Rio Brazos Rd., Aztec, NM 87410

District IV

1220 S. St. Francis Dr., Santa Fe, NM 87505

State of New Mexico
Energy, Minerals & Natural Resources Department

Form C-102
 Revised August 15, 2000

OIL CONSERVATION DIVISION
1220 South St. Francis Dr.
Santa Fe, NM 87505

Submit to Appropriate District Office

State Lease - 4 Copies

Fee Lease - 3 Copies

**AMENDED REPORT****WELL LOCATION AND ACREAGE DEDICATION PLAT**

¹ API Number 30-005-62630		³ Pool Name Springer Basin Strawn	
⁴ Property Code	⁵ Property Name Estellita AFO Federal Com		⁶ Well Number 1
⁷ OGRID No. 025575	⁸ Operator Name Yates Petroleum Corporation		⁹ Elevation 3460.6'

¹⁰ Surface Location

UL or lot no. H	Section 15	Township 14S	Range 27E	Lot Idn	Feet from the 1980	North/South line North	Feet from the 660	East/West line East	County Chaves
---------------------------	----------------------	------------------------	---------------------	---------	------------------------------	----------------------------------	-----------------------------	-------------------------------	-------------------------

¹¹ Bottom Hole Location If Different From Surface

UL or lot no.	Section	Township	Range	Lot Idn	Feet from the	North/South line	Feet from the	East/West line	County
¹² Dedicated Acres 320		¹³ Joint or Infill		¹⁴ Consolidation Code		¹⁵ Order No.			

NO ALLOWABLE WILL BE ASSIGNED TO THIS COMPLETION UNTIL ALL INTERESTS HAVE BEEN CONSOLIDATED OR A NON-STANDARD UNIT HAS BEEN APPROVED BY THE DIVISION

	17 OPERATOR CERTIFICATION	
	I hereby certify that the information contained herein is true and complete to the best of my knowledge and belief.	
	Signature	
	Cherry Matchus Printed Name Engineering Technician Title Date: <u>04/19/04</u>	
<p align="center">RECEIVED APR 26 2004 OCD-ARTESIA</p>		18 SURVEYOR CERTIFICATION
		I hereby certify that the well location shown on this plat was plotted from field notes of actual surveys made by me or under my supervision, and that the same is true and correct to the best of my belief.
		Date of Survey
		Signature and Seal of Professional Surveyor:
		Certificate Number

The Springer Basin Strawn is a new zone and production curves are not available

District I

1625 N. French Dr., Hobbs, NM 88240

District II

811 South First, Artesia, NM 88210

District III

1000 Rio Brazos Rd., Aztec, NM 87410

District IV

1220 S. St. Francis Dr., Santa Fe, NM 87505

State of New Mexico
Energy, Minerals & Natural Resources Department

Form C-102
 Revised August 15, 2000

OIL CONSERVATION DIVISION
1220 South St. Francis Dr.
Santa Fe, NM 87505

Submit to Appropriate District Office
 State Lease - 4 Copies
 Fee Lease - 3 Copies

**AMENDED REPORT****WELL LOCATION AND ACREAGE DEDICATION PLAT**

¹ API Number 30-005-62630		³ Pool Name Springer Basin Atoka Morrow	
⁴ Property Code	⁵ Property Name Estellita AFO Federal Com		⁶ Well Number 1
⁷ OGRID No. 025575	⁸ Operator Name Yates Petroleum Corporation		⁹ Elevation 3460.6'

¹⁰ Surface Location									
UL or lot no. H	Section 15	Township 14S	Range 27E	Lot Idn	Feet from the 1980	North/South line North	Feet from the 660	East/West line East	County Chaves

¹¹ Bottom Hole Location If Different From Surface									
UL or lot no.	Section	Township	Range	Lot Idn	Feet from the	North/South line	Feet from the	East/West line	County
¹² Dedicated Acres 320	¹³ Joint or Infill		¹⁴ Consolidation Code		¹⁵ Order No.				

NO ALLOWABLE WILL BE ASSIGNED TO THIS COMPLETION UNTIL ALL INTERESTS HAVE BEEN CONSOLIDATED OR A NON-STANDARD UNIT HAS BEEN APPROVED BY THE DIVISION

	<p align="center">RECEIVED APR 26 2004 OCD-ARTESIA</p>		<p>¹⁷ OPERATOR CERTIFICATION</p> <p>I hereby certify that the information contained herein is true and complete to the best of my knowledge and belief.</p> <p>Signature _____</p> <p>Cherry Matchus</p> <p>Printed Name _____</p> <p>Engineering Technician</p> <p>Title _____</p> <p>Date: <u>04/19/04</u></p>
			<p>¹⁸ SURVEYOR CERTIFICATION</p> <p>I hereby certify that the well location shown on this plat was plotted from field notes of actual surveys made by me or under my supervision, and that the same is true and correct to the best of my belief.</p>
			<p>Date of Survey _____</p> <p>Signature and Seal of Professional Surveyor: _____</p>
			<p>Certificate Number _____</p>

Property 1
ESTELLITA AFO FED 1
Springer Basin Atoka Morrow
Monthly Oil and Gas Production

Major Phase: GAS

