

District I
1625 N. French Dr., Hobbs, NM 88240
District II
1301 W. Grand Avenue, Artesia, NM 88210
District III
1000 Rio Brazos Road, Aztec, NM 87410
District IV
1220 S. St. Francis Dr., Santa Fe, NM 87505

State of New Mexico
Energy Minerals and Natural Resources

Oil Conservation Division
1220 South St. Francis Dr.
Santa Fe, NM 87505

Form C-144
March 12, 2004

For drilling and production facilities, submit to appropriate NMOCD District Office.
For downstream facilities, submit to Santa Fe office

Pit or Below-Grade Tank Registration or Closure

Is pit or below-grade tank covered by a "general plan"? Yes ☐ No ☒

Type of action: Registration of a pit or below-grade tank ☒ Closure of a pit or below-grade tank ☐

Operator: Marathon Oil Co Telephone: 713-296-3254 E-mail address: mfmick@marathonoil.com
Address: P.O. Box 3128 Houston, TX 77253
Facility or well name: Indian Hills U. #45 API #: 30-015-32338 U/L or Qm/Qtr: A Sec: 28 T: 21S R: 24E
County: Eddy Latitude: _____ Longitude: _____ NAD: 1927 ☐ 1983 ☐ Surface Owner Federal ☐ State ☐ Private ☒ Indian ☐

Pit

Type: Drilling ☒ Production ☐ Disposal ☐

Workover ☐ Emergency ☐

Lined ☒ Unlined ☐

Liner type: Synthetic ☐ Thickness 20 mil Clay ☐ Volume _____ bbl

Below-grade tank

Volume: _____ bbl Type of fluid: _____

Construction material: _____

Double-walled, with leak detection? Yes ☐ If not, explain why not. _____

Depth to ground water (vertical distance from bottom of pit to seasonal high water elevation of ground water.) 100' +

Less than 50 feet	(20 points)
50 feet or more, but less than 100 feet	(10 points)
100 feet or more	(0 points)

Wellhead protection area: (Less than 200 feet from a private domestic water source, or less than 1000 feet from all other water sources.)

Yes	(20 points)
No <input checked="" type="checkbox"/>	(0 points)

RECEIVED

APR 22 2004

Distance to surface water: (horizontal distance to all wetlands, playas, migration canals, ditches, and perennial and ephemeral watercourses.)

Less than 200 feet	(20 points)
200 feet or more, but less than 1000 feet	(10 points)
1000 feet or more <input checked="" type="checkbox"/>	(0 points)

ARTESIA

Ranking Score (Total Points)

If this is a pit closure: (1) attach a diagram of the facility showing the pit's relationship to other equipment and tanks. (2) Indicate disposal location:

onsite ☒ offsite ☐ If offsite, name of facility: _____ (3) Attach a general description of remedial action taken including remediation start date and end date. (4) Groundwater encountered: No ☒ Yes ☐ If yes, show depth below ground surface: _____ ft. and attach sample results. (5) Attach soil sample results and a diagram of sample locations and excavations.

I hereby certify that the information above is true and complete to the best of my knowledge and belief. I further certify that the above-described pit or below-grade tank has been/will be constructed or closed according to NMOCD guidelines ☒ a general permit ☐ or an (attached) alternative OCD-approved plan ☐.

Date: 4-21-04
Printed Name/Title: Mike Mick - Eng. Tech Signature: mammick

Our certification and NMOCD approval of this application/closure does not relieve the operator of liability should the contents of the pit or tank contaminate ground water or otherwise endanger public health or the environment. Nor does it relieve the operator of its responsibility for compliance with any other federal, state, or local laws and/or regulations.

Approval: MAY 4 2004 Gail Sep ID
Printed Name/Title: _____ Signature: [Signature]



NEW MEXICO ENERGY, MINERALS and NATURAL RESOURCES DEPARTMENT

BILL RICHARDSON
Governor

Joanna Prukop
Cabinet Secretary
Acting Director
Oil Conservation Division

4 May 2004

Marathon Oil Co
P.O. Box 3128
Houston, Texas 77253

30-015-32338

RE: Pit stipulations for:

Indian Hills Unit # 45

A-28-21S-24E

1. Notify O.C.D. prior to construction of pit(s)
2. Construction and closing of pit(s) must meet the criteria of Rule 19.15.2.50 and the Pit Guidelines.
3. Notice must be given to O.C.D. 48 hours prior to closing of pit.
4. Pit shall not be constructed in any watercourse, lakebed, sinkhole, wetland, or playa lake.

Van Barton
Field Rep. II

Additional Information- Indian Hills Unit # 45

General

The Indian Hills Unit # 45 SL is located on Fee lands and Federal subsurface. The applied for pit will be constructed with-in the original pit area, with no new surface disturbances. Approx. size 120' x 120' x 4'.

- Topsoil will be stripped and stockpiled for use as the final cover of fill at the time of closure.
- Contents removed from old pit will be stockpiled on a liner to prevent soil contamination.
- A 20 mil. Liner will be installed. Padding will be added if necessary. Liner will be anchored per OCD's guidelines. OCD will be contacted 24 hrs. prior to liner installation.
- All necessary steps will be taken to prevent liner damage.
- Marathon will used a combination of produced and freshwater during drilling, anticipated chloride content of drilling fluids - 10,000 ppm.
- Pit Area will be fence, work access will remain open during operations, closed once rig operations cease.
- All fluids will be removed from pit in a timely manner after operations cease.
- OCD will be contacted when pit closure commences.
- Closure of pit will be performed as per current OCD guidelines for onsite encapsulation The liner edges shall be folded over the contents and a 40 mil liner shall be installed on top. A min. of 3 foot of clean soil shall be spread over encapsulated pit contents. Stockpiled top soil shall be spread and contoured. Pit area will be re-seeded and re-vegetation promoted.

Indian Hills Unit # 45

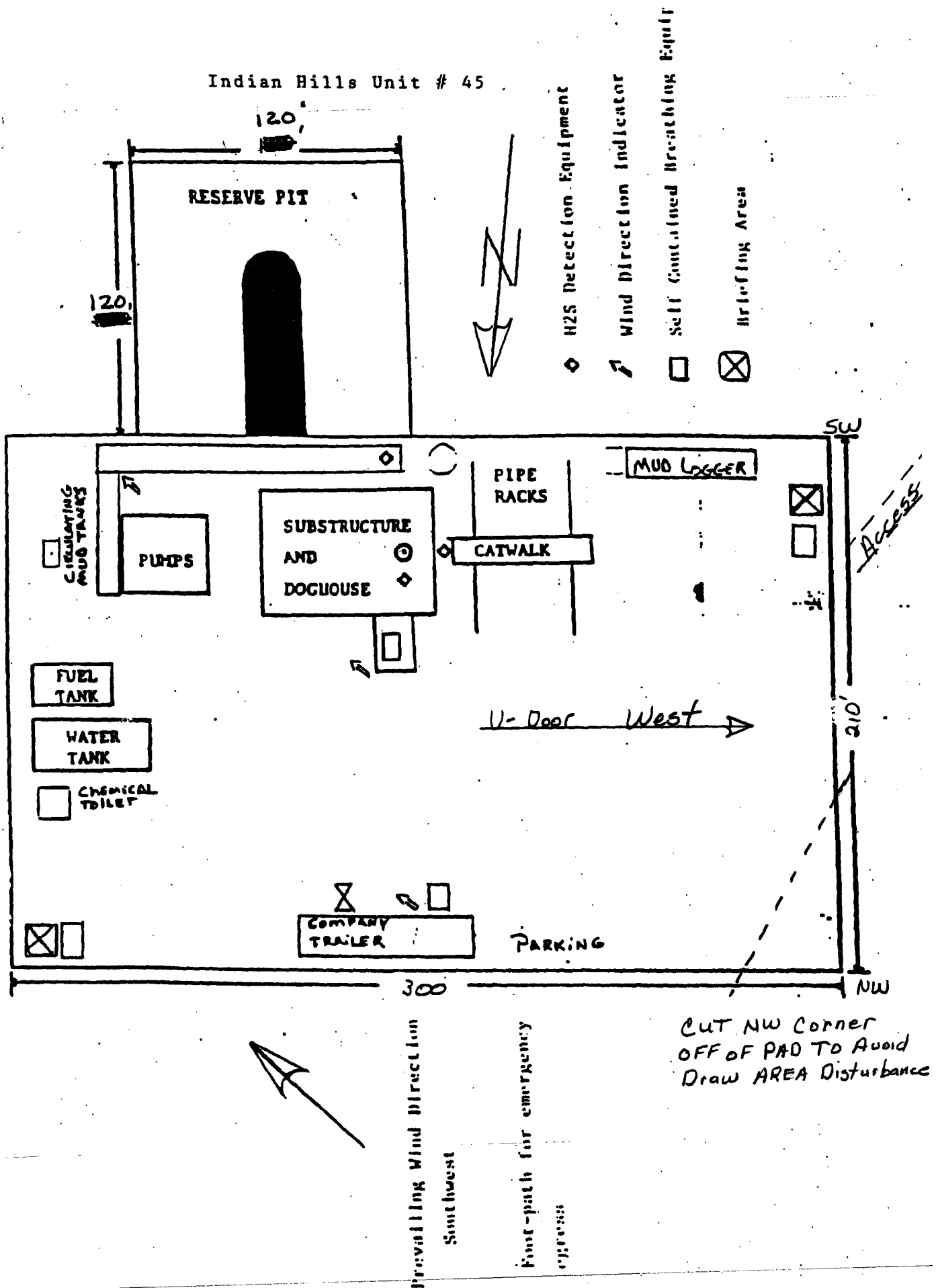

TRICT I
Box 1980, Hobbs, NM 88241-1980

TRICT II
Lawyer DD, Artesia, NM 88211-0710

TRICT III
Rio Brazos Rd., Aztec, NM 87410

TRICT IV
Box 2088, Santa Fe, N.M. 87504-2088

State of New Mexico
Energy, Minerals and Natural Resources Department

OIL CONSERVATION DIVISION
P.O. Box 2088
Santa Fe, New Mexico 87504-2088

Form C-102
Revised February 10, 1994
Submit to Appropriate District Office
State Lease - 4 Copies
Fee Lease - 3 Copies

WELL LOCATION AND ACREAGE DEDICATION PLAT

☐ AMENDED REPORT

API Number	Pool Code	Pool Name
	78960	Indian Basin Morrow Gas Pool
Property Code	Property Name	Well Number
	INDIAN HILLS UNIT	45
OGRID No.	Operator Name	Elevation
1021	MARATHON OIL COMPANY	3654'

Surface Location

or lot No.	Section	Township	Range	Lot Idn	Feet from the	North/South line	Feet from the	East/West line	County
A	28	21-S	24-E		806	NORTH	1010	EAST	EDDY

Bottom Hole Location If Different From Surface

or lot No.	Section	Township	Range	Lot Idn	Feet from the	North/South line	Feet from the	East/West line	County
I	21	21-S	24-E		2084'	South	785'	EAST	EDDY

Allocated Acres	Joint or Infill	Consolidation Code	Order No.
20 E/2			

NO ALLOWABLE WILL BE ASSIGNED TO THIS COMPLETION UNTIL ALL INTERESTS HAVE BEEN CONSOLIDATED
OR A NON-STANDARD UNIT HAS BEEN APPROVED BY THE DIVISION

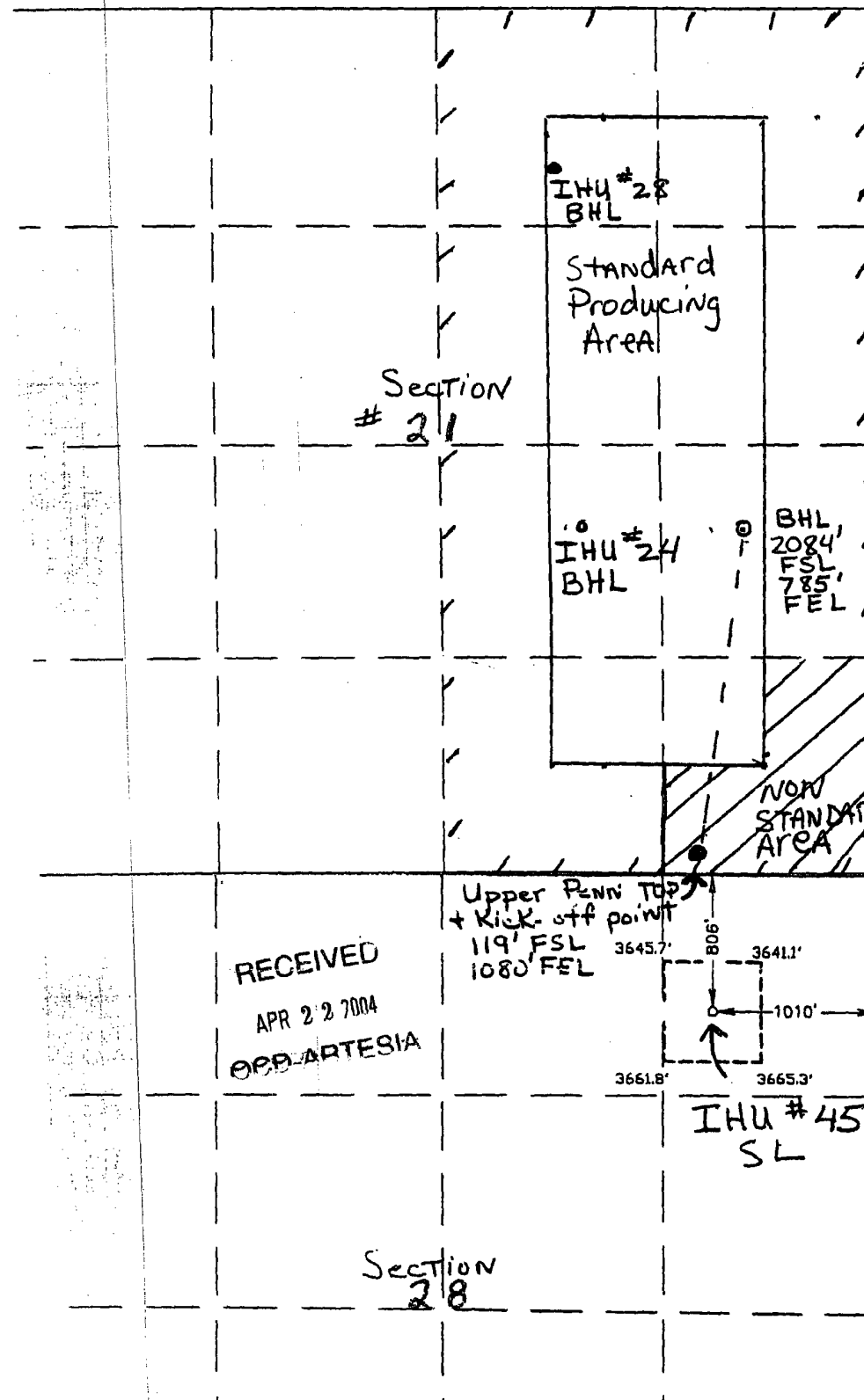

OPERATOR CERTIFICATION

I hereby certify the the information
contained herein is true and complete to the
best of my knowledge and belief.

Mike Mick
Signature
MIKE MICK
Printed Name
Engineer Tech.
Title
3-24-04
Date

SURVEYOR CERTIFICATION

I hereby certify that the well location shown
on this plat was plotted from field notes of
actual surveys made by me or under my
supervision, and that the same is true and
correct to the best of my belief.

JANUARY 29, 2002

Date Surveyed AWB
Signature & Seal of
Professional Surveyor
RONALD J. EDSON 01/31/02
02.11.0080
Certificate No. RONALD J. EDSON 3238
GARY EDSON 12841

OPERATOR CERTIFICATION

I hereby certify the the information
contained herein is true and complete to the
best of my knowledge and belief.

Signature
Printed Name
Title
Date

SURVEYOR CERTIFICATION

I hereby certify that the well location shown
on this plat was plotted from field notes of
actual surveys made by me or under my
supervision, and that the same is true and
correct to the best of my belief.