

OIL CONSERVATION DIVISION

2040 South Pacheco
Santa Fe, New Mexico 87505

DISTRICT I

1625 N. Fench Dr., Hobbs, NM 88240

DISTRICT II

811 S. First Street, Artesia, NM 88210

DISTRICT III

1000 Rio Brazos Rd., Aztec, NM 87410

WELL API NO.
30-005-63517

5. Indicate Type of Lease
STATE FEE

6. State Oil & Gas Lease No.
VA-1953

7. Lease Name or Unit Agreement Name

BLUEGILL STATE

8. Well No.
1

9. Pool Name or Wildcat

SUNDRY NOTICES AND REPORTS ON WELLS
(DO NOT USE THIS FORM FOR PROPOSALS TO DRILL OR TO DEEPEN OR PLUG BACK TO A DIFFERENT RESERVOIR. USE "APPLICATION FOR PERMIT" (FORM C-101) FOR SUCH PROPOSALS.)

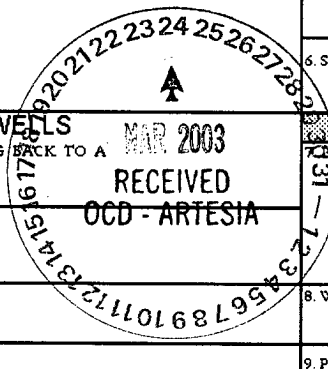

1. Type of Well:
OIL WELL GAS WELL OTHER

2. Name of Operator
ELK OIL COMPANY

3. Address of Operator
POST OFFICE BOX 310, ROSWELL, NEW MEXICO 88202-0310

4. Well Location
Unit Letter **F** : **2310** Feet From The **NORTH** Line and **1980** Feet From The **WEST** Line
Section **32** Township **9 SOUTH** Range **27 EAST** NMPM **CHAVES** County

10. Elevation (Show whether DF, RKB, RT, GR, etc.)
3910' GR

11. Check Appropriate Box to Indicate Nature of Notice, Report, or Other Data

NOTICE OF INTENTION TO:				SUBSEQUENT REPORT OF:			
PERFORM REMEDIAL WORK	<input type="checkbox"/>	PLUG AND ABANDON	<input type="checkbox"/>	REMEDIAL WORK	<input type="checkbox"/>	ALTERING CASING	<input type="checkbox"/>
TEMPORARILY ABANDON	<input type="checkbox"/>	CHANGE PLANS	<input type="checkbox"/>	COMMENCE DRILLING OPNS.	<input type="checkbox"/>	PLUG AND ABANDONMENT	<input type="checkbox"/>
PULL OR ALTER CASING	<input type="checkbox"/>	MULTIPLE COMPLETION	<input type="checkbox"/>	CASING TEST AND CEMENT JOB	<input type="checkbox"/>		
OTHER:	<input type="checkbox"/>			OTHER:	<input checked="" type="checkbox"/>		

12. Describe Proposed or Completed Operations (Clearly state all pertinent details, and give pertinent dates, including estimated date of starting any proposed work)
SEE RULE 1103 For Multiple Completions: Attach wellbore diagram of proposed completion or recompletion.

As required by OCD Rule 118 (Hydrogen Sulfide Gas) the following is submitted:

- (1) Plat of wellsite with proper signage.
- (2) Copy of public roads and road to wellsite.

The Bluegill State #1 has a 400 PPM concentration. There is no public area or public road within the exposure area.

The calculation for the radius of exposure is as follows:

$$X = [(1.589) (.0004) (5,000,000)]^{0.6258} = 155 \text{ Feet}$$

Therefore no H2S contingency plan is required.

I hereby certify that the information above is true and complete to the best of my knowledge and belief.

SIGNATURE TITLE **PRESIDENT** DATE **3/21/03**
TYPE OR PRINT NAME **JOSEPH J. KELLY** TELEPHONE NO. **505-623-3190**

(This space for State Use)

APPROVED BY Accepted for record TITLE _____ DATE **APR 9 2003**
CONDITIONS OF APPROVAL, IF ANY: _____

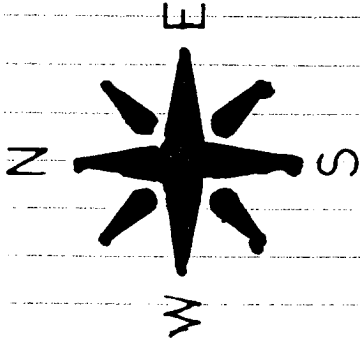

ELK DIL COMPANY
 Bluegill STATE #1
 SEC 32, T-9S, R-27E
 2310 FWL, 1980 FWL
 CHAVES COUNTY, NM

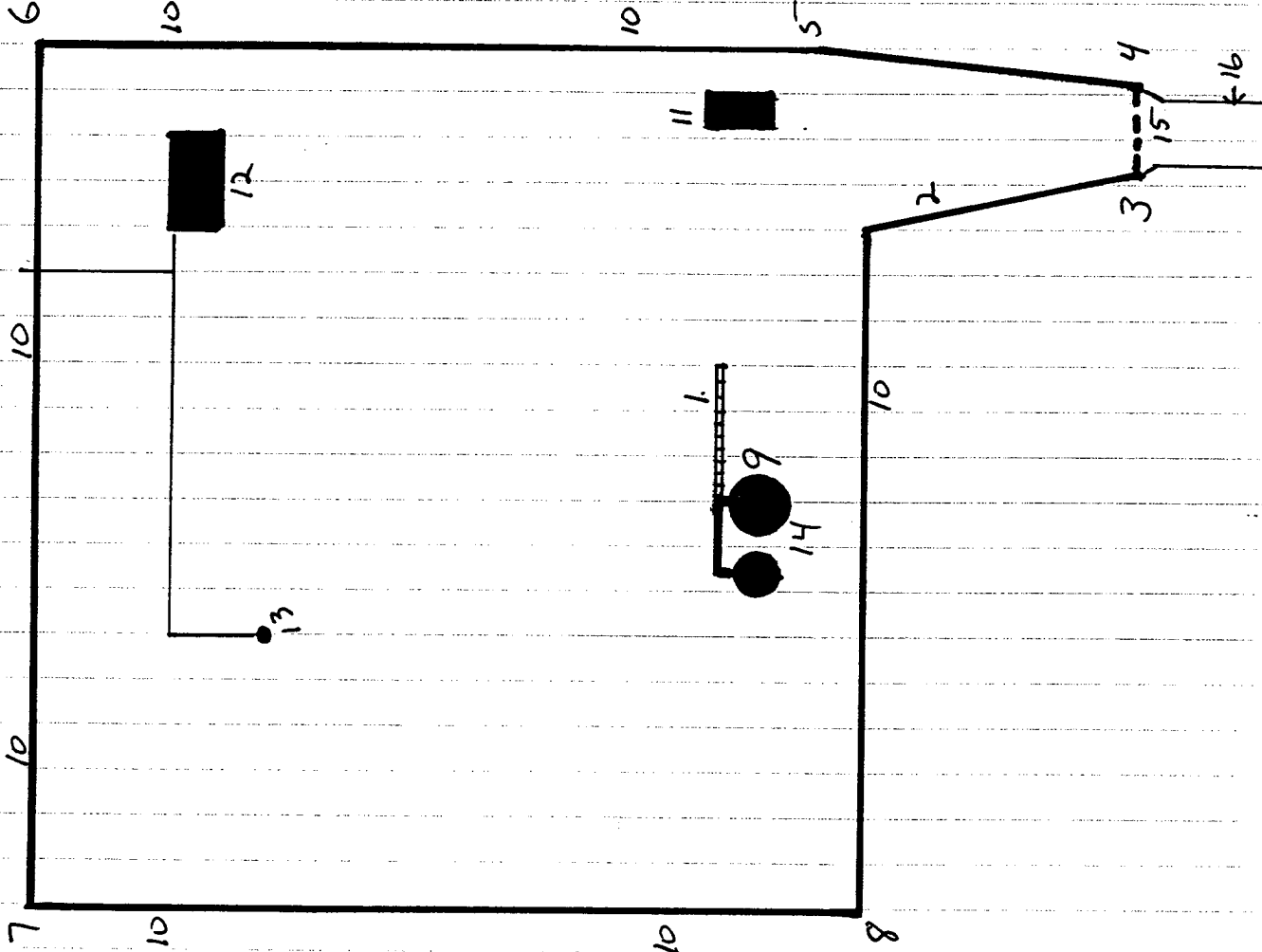

1. Sign Across STEPS
 DANGER WEAR APPROVED
 BREATHING APPARATUS
 BEYOND THIS POINT
2. Sign ENTERING location
 DANGER
 H₂S POISON GAS
 NO TRESPASSING
 IN CASE OF EMERGENCY
 CALL (505) 623-3190
3. Wind sock
4. DIRECTIONAL ARROW
- 5 wind sock
- 6 wind sock
- 7 wind sock
- 8 wind sock
- 9 wind sock ATOP TANK
- 10 DANGER H₂S POISON GAS Signs
- 11 GAS METER HOUSE
- 12 GAS PRODUCTION UNIT
- 13 WELL HEAD
- 14 TANK BATTERY
- 15 GATE
- 16 Access Road