

DISTRICT I
1625 N. FRENCH DR., HOBBS, NM 88240

State of New Mexico
Energy, Minerals and Natural Resources Department

Form C-102

Revised October 12, 2005

Submit to Appropriate District Office

State Lease - 4 Copies

Fee Lease - 3 Copies

DISTRICT II
1301 W. GRAND AVENUE, ARTESIA, NM 88210

OIL CONSERVATION DIVISION

11885 SOUTH ST. FRANCIS DR.

Santa Fe, New Mexico 87505

DISTRICT III
1000 RIO BRAZOS RD., AZTEC, NM 87410

DISTRICT IV
11885 S ST FRANCIS DR., SANTA FE, NM 87505

WELL LOCATION AND ACREAGE DEDICATION PLAT

☐ AMENDED REPORT

API Number 30-015 - 39133	Pool Code 97213	Pool Name Fren; Glorieta-Yeso, East
Property Code 34284	Property Name PUCKETT 24 ✓	Well Number 37 ✓
OGRID No 229137	Operator Name COG OPERATING, LLC	Elevation 3894' ✓

Surface Location

UL or lot No. D	Section 24	Township 17-S	Range 31-E	Lot Idn	Feet from the 895	North/South line NORTH	Feet from the 330	East/West line WEST	County EDDY ✓
--------------------	---------------	------------------	---------------	---------	----------------------	---------------------------	----------------------	------------------------	------------------

Bottom Hole Location If Different From Surface

UL or lot No.	Section	Township	Range	Lot Idn	Feet from the	North/South line	Feet from the	East/West line	County
---------------	---------	----------	-------	---------	---------------	------------------	---------------	----------------	--------

Dedicated Acres 40	Joint or Infill	Consolidation Code	Order No.
-----------------------	-----------------	--------------------	-----------

NO ALLOWABLE WILL BE ASSIGNED TO THIS COMPLETION UNTIL ALL INTERESTS HAVE BEEN CONSOLIDATED
OR A NON-STANDARD UNIT HAS BEEN APPROVED BY THE DIVISION

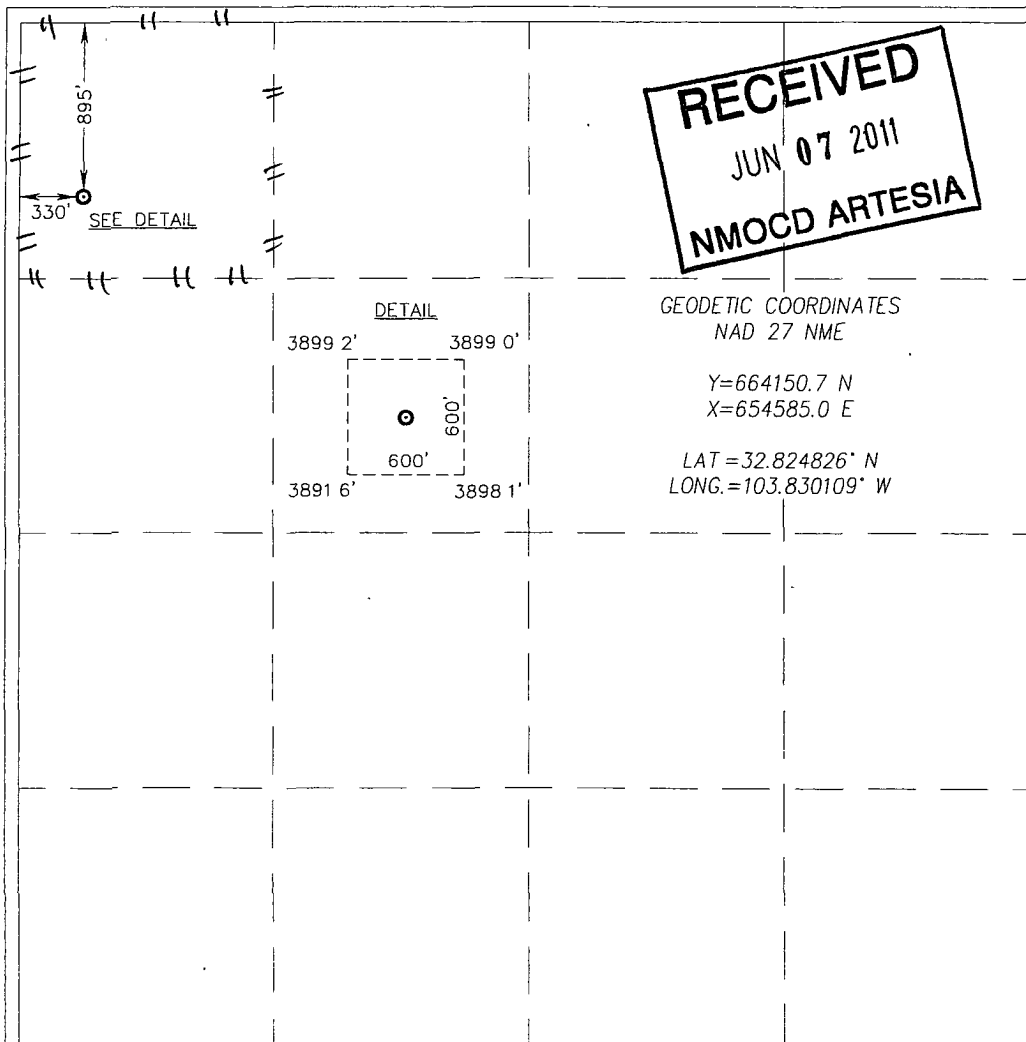

OPERATOR CERTIFICATION

I hereby certify that the information herein is true and complete to the best of my knowledge and belief, and that this organization either owns a working interest or unleased mineral interest in the land including the proposed bottom hole location or has a right to drill this well at this location pursuant to a contract with an owner of such mineral or working interest, or to a voluntary pooling agreement or a compulsory pooling order heretofore entered by the division

Signature: Kelly J. Holly
Date: 3-28-11

Printed Name: Kelly J. Holly

SURVEYOR CERTIFICATION

I hereby certify that the well location shown on this plat was plotted from field notes of actual surveys made by me or under my supervision, and that the same is true and correct to the best of my belief

MARCH 16, 2011

Date Surveyed: LA

Signature & Seal of Professional Surveyor

Signature: Ronald J. Eidson
Date: 3/21/2011
Professional Surveyor No. 11110207

Certificate No. GARY G. EIDSON 12641
RONALD J. EIDSON 3239