

Surface Use Plan  
COG Operating, LLC  
Puckett 13 #54  
1600' FSL & 1650' FWL  
Section 13, T-17-S, R-31-E, UL K  
Eddy County, New Mexico

30-015-39181

# Surface Use & Operating Plan

## Puckett 13 #54

- Surface Tenant: Olane Caswell, 1702 Gillham, Brownfield, TX 79316
- New Road: approx. 0'
- Flow Line: approx. 0.2 mi
- Facilities: Puckett 13 Tank Battery (Existing)

### Well Site Information

V Door: Southeast

Topsoil: Southwest

Interim Reclamation: Northwest/Southwest

### Notes

-N/A

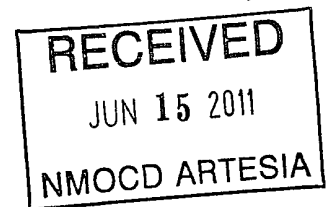

**Onsite:** 1/25/2011

Tanner Nygren (BLM), Chris Moon (COG), Curtis Griffin (COG), Gary Box (J.W.S)

## **SURFACE USE AND OPERATING PLAN**

### **1. Existing & Proposed Access Roads**

- A. The well site survey and elevation plat for the proposed well is shown in Exhibit #1. It was staked by John West Engineering, Hobbs, NM.
- B. All roads to the location are shown in the topographic map Exhibit #2. The existing lease roads are illustrated and are adequate for travel during drilling and production operations. Upgrading existing roads prior to drilling the well will be done where necessary.
- C. Directions to location: : From the intersection US Highway 82 and Co. Rd. 224 (Ripple Road), Go Southeast approx. 0.1 mile. This location is approx. 120 feet Southwest of Co. Rd. #224. See Vicinity Map, Exhibit #3
- D.
- E. Routine grading and maintenance of existing roads will be conducted as necessary to maintain their condition as long as any operations continue on this lease. Roads will be maintained according to specifications in section 2A of this Surface Use and Operating Plan.

### **2. Proposed Access Road:**

Exhibit #4 shows that 0' of new access road will be required for this location. If any road is required it will be constructed as follows:

- A. The width of the running surface will be 14'. The road will be crowned, ditched and constructed of 6" rolled and compacted caliche. Ditches will be at 3:1 slope and 4 feet wide. Water will be diverted where necessary to avoid ponding, prevent erosion, maintain good drainage, and to be consistent with local drainage patterns. If existing road conditions do not meet the above stated qualifications, upgrades will be constructed to meet these standards on all existing or non-existing lease roads.
- B. The average grade will be less than 1%.
- C. No turnouts are planned.
- D. No culverts, cattleguard, gates, low water crossings or fence cuts are necessary.

- E. Surfacing material will consist of native caliche. Caliche will be obtained from the actual well site if available. If not available onsite, caliche will be hauled from the nearest BLM caliche pit.

**3. Location of Existing Well:**

Exhibit #5 shows all existing wells within a one-mile radius of this well.

As shown on this plat there are numerous wells producing from the San Andres and Yeso formations.

**4. Location of Existing and/or Proposed Facilities:**

- A. COG Operating LLC does operate a production facility on this lease.
- B. If the well is productive, contemplated facilities will be as follows:
  - 1) Production will be sent to the Puckett 13 Tank battery located in Section 13 at the Puckett 13 #58 well location. The facility location is shown in Exhibit #5.
  - 2) The tank battery and facilities including all flow lines and piping will be installed according to API specifications.
  - 3) Any additional caliche will be obtained from the actual well site. If caliche does not exist or is not plentiful from the well site, the caliche will be hauled from a BLM approved caliche pit. Any additional construction materials will be purchased from contractors.
  - 4) Proposed flow lines, will follow an archaeologically approved route to the Puckett 13 Tank battery located in Section 13 at the Puckett 13 #58 well location. The flowline will be SDR 7 3" poly line laid on the surface and will be approximately 0.2 miles in length.
  - 5) It will be necessary to run electric power if this well is productive. Power will be provided by CVE and they will submit a separate plan and ROW for service to the well location.
  - 6) If the well is productive, rehabilitation plans will include the following:
    - a) The original topsoil from the well site will be returned to the location, and the site will be re-contoured as close as possible to the original site.

**5. Location and Type of Water Supply:**

The well will be drilled with combination brine and fresh water mud system as outlined in the drilling program. The water will be obtained from commercial water stations in the area and hauled to location by transport truck over the existing and proposed access roads shown in Exhibit #2. If a commercial fresh water source is nearby, fast line may be laid along existing road ROW's and fresh water pumped to the well. No water well will be drilled on the location.

**6. Source of Construction Materials and Location "Turn-Over" Procedure:**

Obtaining caliche: The primary way of obtaining caliche to build locations and roads will be by "turning over" the location. This means, caliche will be obtained from the actual well sight. A caliche permit will be obtained from BLM prior to pushing up any caliche. 2400 cu. Yards is max amount of caliche needed for pad and roads. Amount will vary for each pad. The procedure below has been approved by BLM personnel:

- A. The top 6 inches of topsoil is pushed off and stockpiled along the side of the location.**
- B. An approximate 120' X 120' area is used within the proposed well site to remove caliche.**
- C. Subsoil is removed and piled alongside the 120' by 120' area within the pad site.**
- D. When caliche is found, material will be stock piled within the pad site to build the location and road.**
- E. Then subsoil is pushed back in the hole and caliche is spread accordingly across entire location and road.**
- F. Once well is drilled, the stock piled top soil will be used for interim reclamation and spread along areas where caliche is picked up and the location size is reduced. Neither caliche or subsoil will be stock piled outside of the well pad. Topsoil will be stockpiled along the edge of the pad as depicted in attached plat.**

In the event that no caliche is found onsite, caliche will be hauled in from a BLM approved caliche pit.

**7. Methods of Handling Water Disposal:**

- A. The well will be drilled utilizing a closed loop mud system. Drill cuttings will be held in roll-off style mud boxes and taken to an NMOCD approved disposal site.
- B. Drilling fluids will be contained in steel mud pits.
- C. Water produced from the well during completion will be held temporarily in steel tanks and then taken to an NMOCD approved commercial disposal facility.
- D. Garbage and trash produced during drilling or completion operations will be collected in a trash bin and hauled to an approved landfill. No toxic waste or hazardous chemicals will be produced by this operation.
- E. After the rig is moved out and the well is either completed or abandoned, all waste materials will be cleaned up within 30 days. In the event of a dry hole only a dry hole marker will remain.

**8. Ancillary Facilities:**

No airstrip, campsite or other facilities will be built as a result of the operation on this well.

**9. Well Site Layout:**

- A. The drill pad layout, with elevations staked by John West Engineering, is shown in Exhibit #4. Dimensions of the pad and pits are shown on Exhibit #6. V door direction is Southeast. Topsoil, if available, will be stockpiled per BLM specifications. Because the pad is almost level no major cuts will be required.
- B. Exhibit #6 also shows the proposed orientation of closed loop system and access road. No permanent living facilities are planned, but a temporary foreman/toolpusher's trailer will be on location during the drilling operations.

**10. Plans for Restoration of the Surface:**

- A. Interim Reclamation will take place after the well has been completed. The pad will be downsized by reclaiming the areas not needed for production operations. The portions of the pad that are not needed for production operations will be re-contoured to its original state as much as possible. The caliche that is removed will be reused to either build another pad site or for road repairs within the lease. The stockpiled topsoil will

then be spread out reclaimed area and reseeded with a BLM approved seed mixture. In the event that the well must be worked over or maintained, it may be necessary to drive, park, and/or operate machinery on reclaimed land. This area will be repaired or reclaimed after work is complete.

- B. Final Reclamation: Upon plugging and abandoning the well, All caliche for well pad and lease road will be removed and surface will be recountoured to reflect its surroundings as much as possible. Caliche will be recycled for road repair or reused for another well pad within the lease. If any topsoil remains, it will be spread out and the area will be re-seeded with a BLM approved mixture and re-vegetated as per BLM orders.

#### **11.Surface Ownership:**

- A. The surface is owned by the U.S. Government and is administered by the Bureau of Land Management. The surface is multiple uses with the primary uses of the region for grazing of livestock and the production of oil and gas.
- B. The surface tenant for this site is Olane Caswell, 1702 Gillham, Brownfield, TX 79316.
- C. The proposed road routes and surface location will be restored as directed by the BLM

#### **12.Other Information:**

- A. The area around the well site is grassland and the topsoil is sandy. The vegetation is moderately sparse with native prairie grasses, some mesquite and shinnery oak. No wildlife was observed but it is likely that mule deer, rabbits, coyotes and rodents traverse the area.
- B. There is no permanent or live water in the immediate area.
- C. There are no dwellings within 2 miles of this location.
- D. If needed, a Cultural Resources Examination is being prepared by Southern New Mexico Archaeological Services, Inc. P.O. Box 1, Bent New Mexico, 88314, phone # 505-671-4797 and the results will be forwarded to your office in the near future. Otherwise, **COG will be participating in the Permian Basin MOA Program.**

**13. Bond Coverage:**

Bond Coverage is Nationwide Bond # 000215

**14. Lessee's and Operator's Representative:**

The COG Operating LLC representative responsible for assuring compliance with the surface use plan is as follows:

John Coffman,	Erick Nelson.
Drilling Superintendent	Division Operations Manager
COG Operating LLC	COG Operating LLC
550 W. Texas, Suite 1300	550 W. Texas, Suite 1300
Midland, TX 79701	Midland, TX 79701
Phone (432) 683-7443 (office)	Phone (505) 746-2210 (office)
(432) 631-9762 (cell)	(432) 238-7591 (cell)

*Surface Use Plan  
COG Operating, LLC  
Puckett 13 #54  
1600' FSL & 1650' FWL  
Section 13, T-17-S, R-31-E, UL K  
Eddy County, New Mexico*

---

I hereby certify that I, or persons under my direct supervision, have inspected the drill site and access road proposed herein; that I am familiar with the conditions that presently exist; that I have full knowledge of State and Federal laws applicable to this operation; that the statements made in this APD package are, to the best of my knowledge, true and correct; and that the work associated with the operations proposed herein will be performed in conformity with this APD package and the terms and conditions under which it is approved. I also certify that I, or COG Operating, LLC, am responsible for the operations conducted under this application. These statements are subject to the provisions of 18 U.S.C. 1001 for the filing of false statements. Executed this 25th day of February, 2011.

Signed: Carl Bird

Printed Name: Carl Bird

Position: Drilling Engineer

Address: 550 W. Texas, Suite 1300, Midland, Texas 79701

Telephone: (432) 683-7443

Field Representative (if not above signatory): Same

E-mail: cbird@conchoresources.com



**SECTION 13, TOWNSHIP 17 SOUTH, RANGE 31 EAST, N.M.P.M.**  
 EDDY COUNTY NEW MEXICO

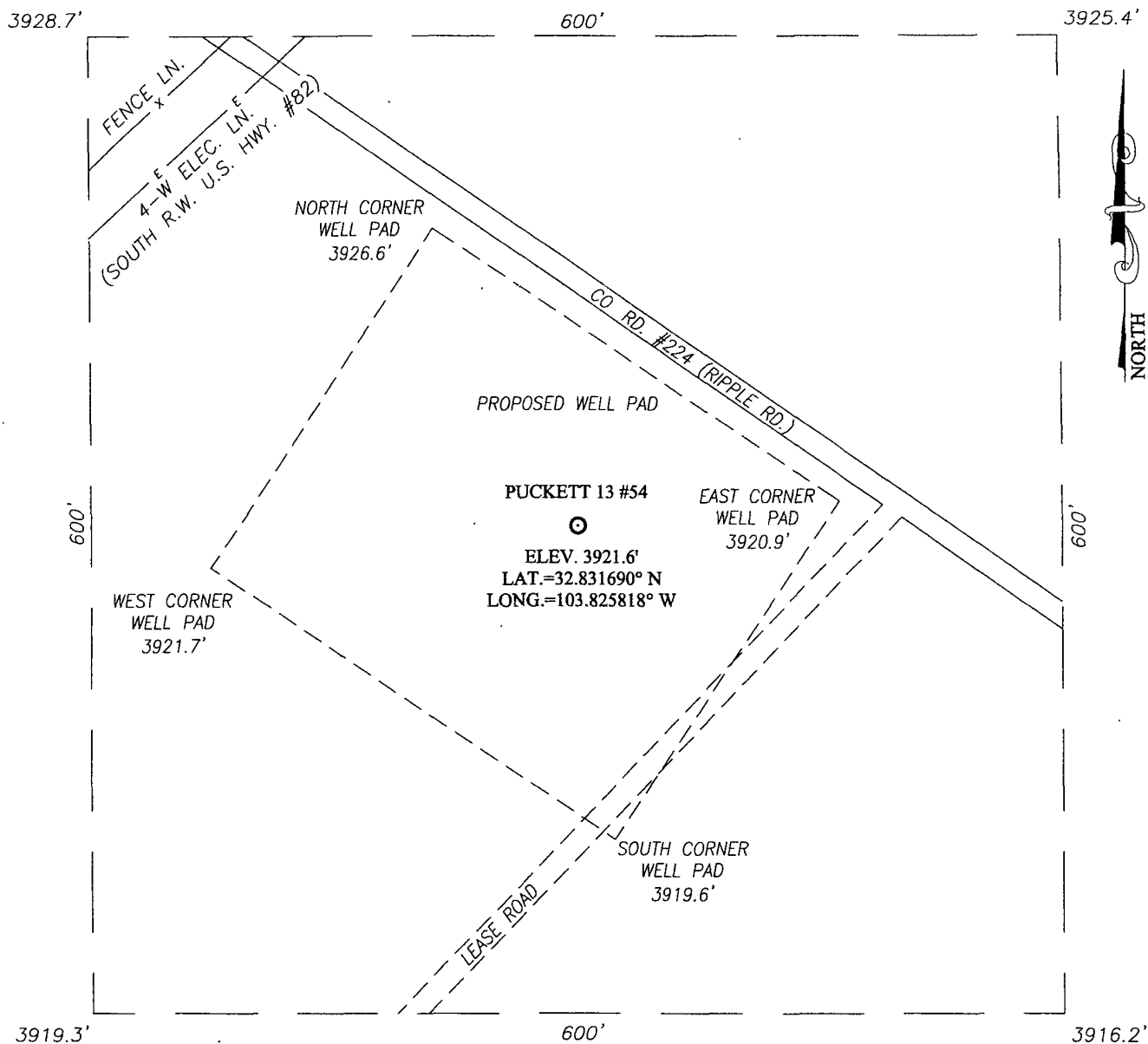

**DIRECTIONS TO LOCATION**

FROM THE INTERSECTION OF U.S. HWY. #82 AND CO. RD. #224 (RIPPLE ROAD), GO SOUTHEAST APPROX. 0.1 MILE. THIS LOCATION IS APPROX. 120 FEET SOUTHWEST OF CO. RD. #224.

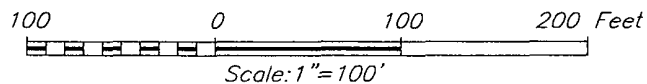

PROVIDING SURVEYING SERVICES  
 SINCE 1946  
**JOHN WEST SURVEYING COMPANY**  
 412 N DAL PASO  
 HOBBS, N.M. 88240  
 (575) 393-3117

**COG OPERATING, LLC**

PUCKETT 13 #54 WELL  
 LOCATED 1600 FEET FROM THE SOUTH LINE  
 AND 1650 FEET FROM THE WEST LINE OF SECTION 13,  
 TOWNSHIP 17 SOUTH, RANGE 31 EAST, N.M.P.M.,  
 EDDY COUNTY, NEW MEXICO

Survey Date: 1/28/11	Sheet 1 of 1 Sheets
W.O. Number: 11.11.0198	Dr By: LA
Date: 2/2/11	11110198
	Scale: 1"=100'

# VICINITY MAP

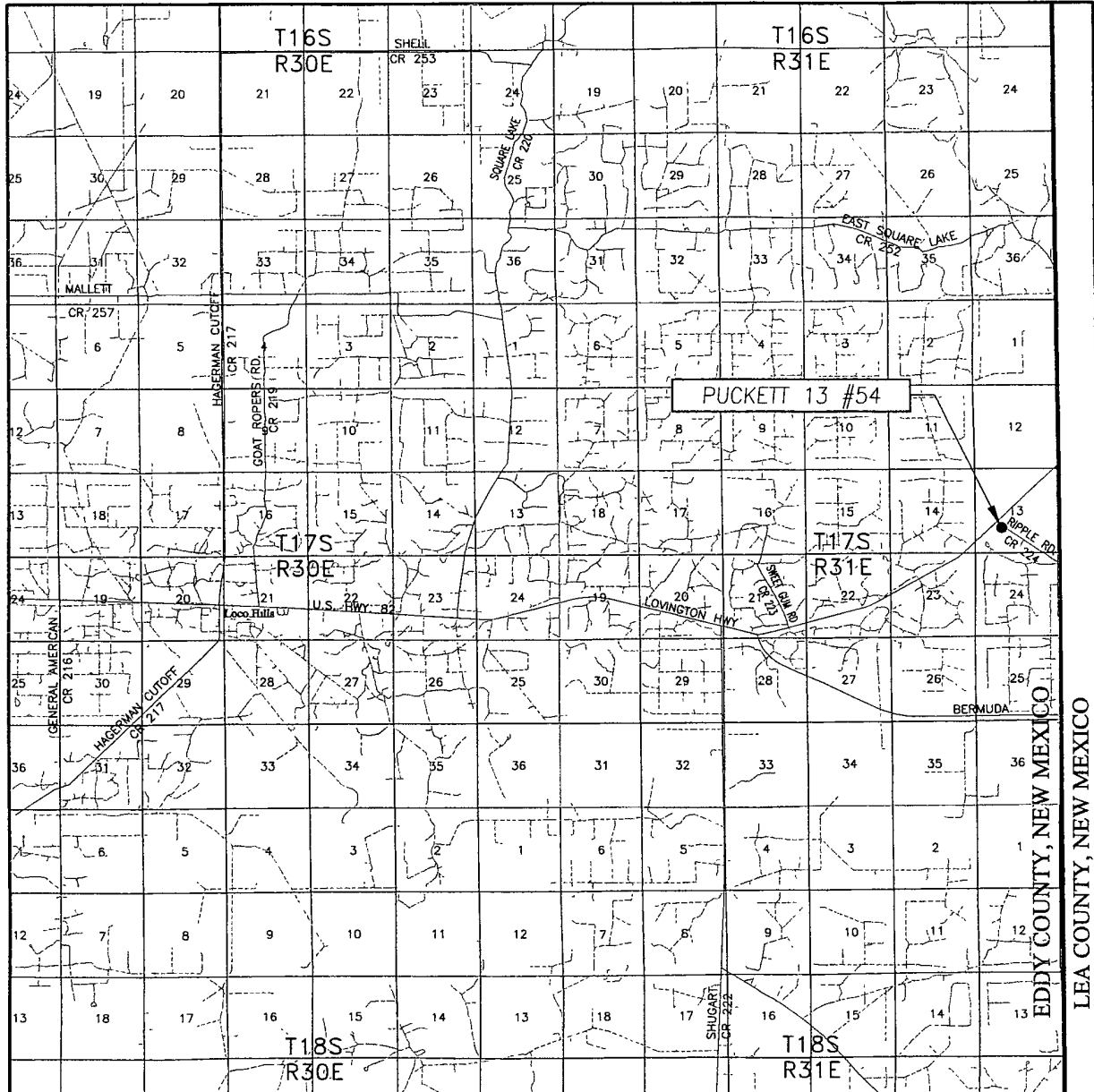

SCALE: 1" = 2 MILES

SEC. 13 TWP. 17-S RGE. 31-E

SURVEY N.M.P.M.

COUNTY EDDY STATE NEW MEXICO

DESCRIPTION 1600' FSL & 1650' FWL

ELEVATION 3922'

OPERATOR COG OPERATING, LLC

LEASE PUCKETT 13



PROVIDING SURVEYING SERVICES  
SINCE 1946  
**JOHN WEST SURVEYING COMPANY**  
412 N. DAL PASO  
HOBBS, N.M. 88240  
(575) 393-3117

# LOCATION VERIFICATION MAP

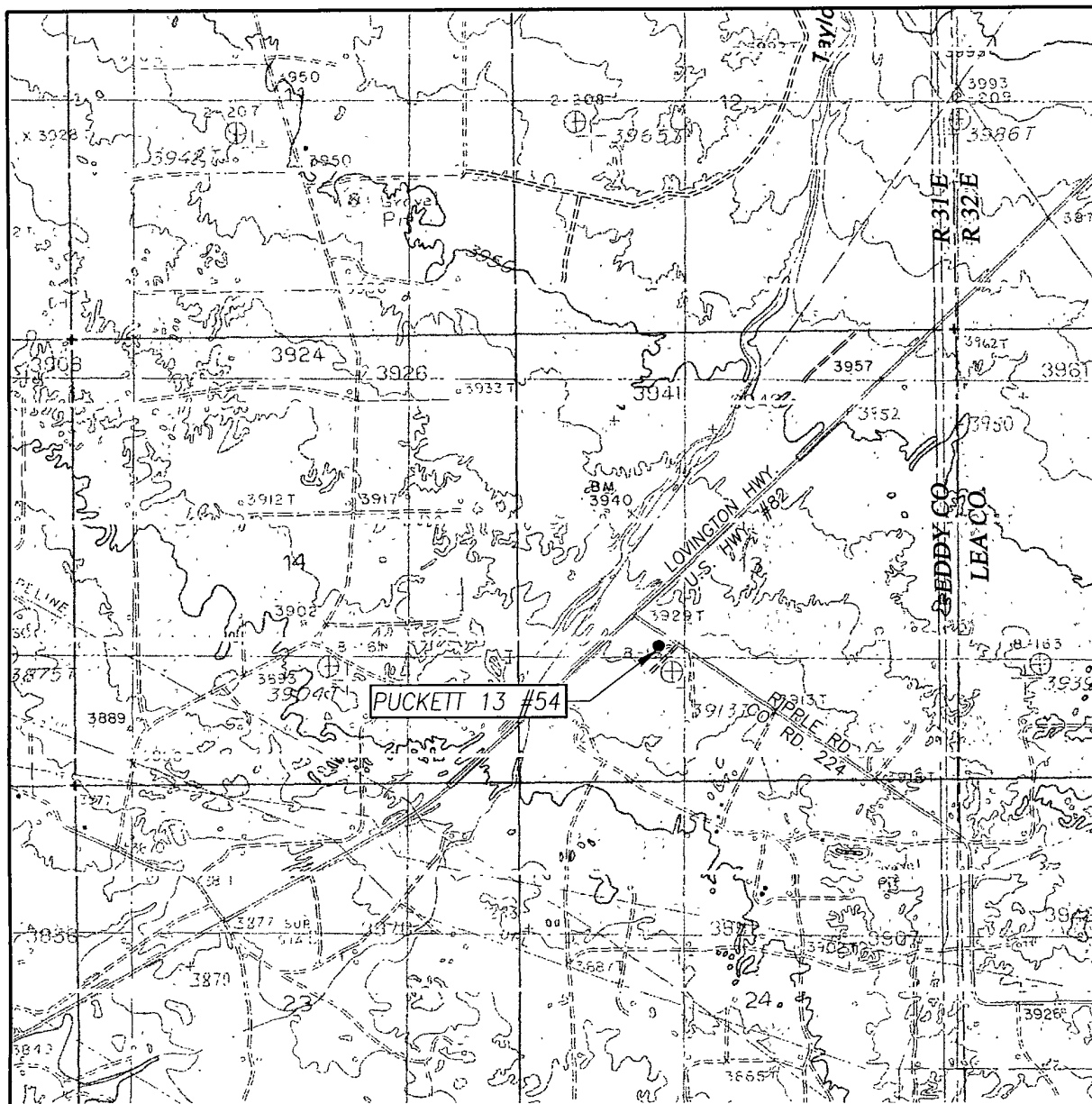

SCALE: 1" = 2000'

CONTOUR INTERVAL:  
MALJAMAR, N.M. - 10'

SEC. 13 TWP. 17-S RGE. 31-E

SURVEY \_\_\_\_\_ N.M.P.M.

COUNTY EDDY STATE NEW MEXICO

DESCRIPTION 1600' FSL & 1650' FWL

ELEVATION 3922'

OPERATOR COG OPERATING, LLC

LEASE PUCKETT 13

U.S.G.S. TOPOGRAPHIC MAP  
MALJAMAR, N.M.

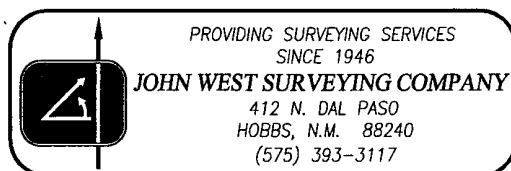



Data use subject to license

© DeLorme XMap® 7.

www.delorme.com



Scale 1 : 3,600

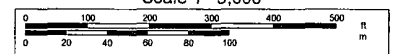

1" = 300.0 ft

Data Zoom 15-7



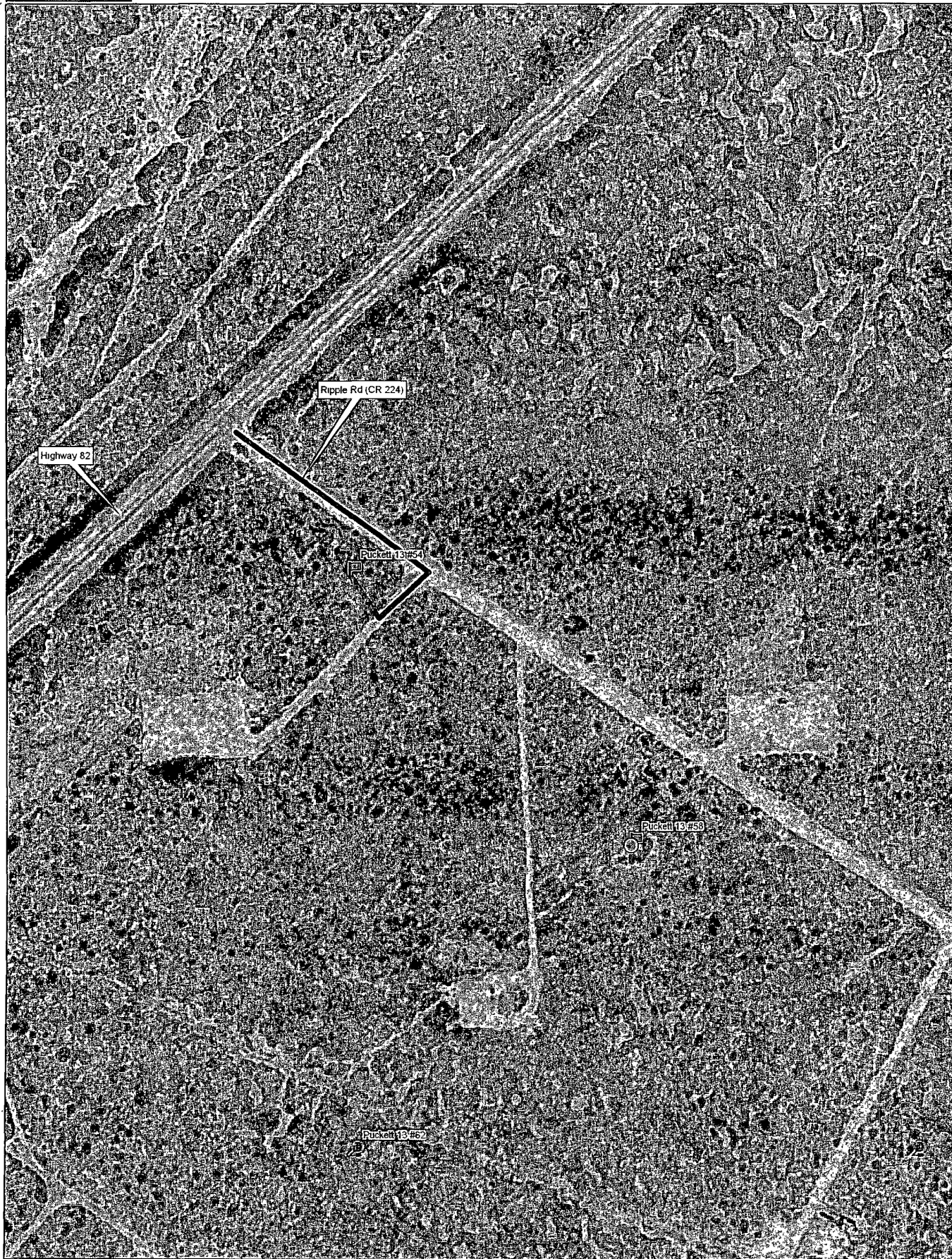

Data use subject to license.

© DeLorme. XMap® 7.

www.delorme.com

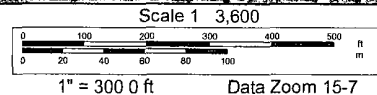

## Offset wells to Puckett 13 #54

API#	Operator	County	Legal	Lease	Well#	Date Issued	Permitted Depth	Permit TVD	Images	Doc	Total Depth	Well Type	Well Status	Permit#
30-015-38379	COG OPERATING LLC	EDDY	S:23, T:17S, R:31E	SKELLY UNIT	814	12/10/2010	6,700		No	link	6,700	PO	Active Permit	TEMP412334538
30-025-39974	CIMAREX ENERGY CO. OF COLORADO	LEA	S 18, T:17S, R 32E	HT FEDERAL	1	12/1/2010	7,028		Yes	link	7,028	PO	Active Permit	TEMP669325595
30-015-38349	COG OPERATING LLC	EDDY	S:23, T:17S, R:31E	SKELLY UNIT	807	11/22/2010	6,850		No	link	6,850	PO	Active Permit	TEMP1282820010
30-015-38362	COG OPERATING LLC	EDDY	S:14, T:17S, R:31E	SKELLY UNIT	646	11/22/2010	6,945	6,900	Yes	link	6,945	PO	Active Permit	TEMP169842468
30-015-38015	COG OPERATING LLC	EDDY	S 23, T:17S, R:31E	SKELLY UNIT	782	7/15/2010	7,113	7,100	Yes	link	7,113	PO	Active	TEMP499317321
30-015-37911	HUDSON OIL COMPANY OF TEXAS	EDDY	S:13, T:17S, R:31E	PUCKETT NORTH	9	6/7/2010	4,300		Yes	link	4,300	PO	Active Permit	TEMP774753213
30-015-38224	COG OPERATING LLC	EDDY	S 14, T:17S, R 31E	SKELLY UNIT	651	5/28/2010	6,800		Yes	link	6,800	PO	Active Permit	TEMP8230580
30-015-37881	COG OPERATING LLC	EDDY	S:14, T:17S, R:31E	SKELLY UNIT	672	5/20/2010	6,925	6,900	Yes	link	6,925	PO	Active Permit	TEMP1693910708
30-015-37885	COG OPERATING LLC	EDDY	S:23, T:17S, R:31E	SKELLY UNIT	783	5/20/2010	7,100		Yes	link	7,100	PO	Active Permit	TEMP1002832164
30-019-37820	COG OPERATING LLC	GUADALUPE	S 14, T 17S, R 31E	SKELLY UNIT	679	4/23/2010	7,100		Yes	link	7,100	PO	Active Permit	TEMP498215849
30-015-37840	COG OPERATING LLC	EDDY	S:23, T:17S, R:31E	SKELLY UNIT	614	4/23/2010	6,900		Yes	link	6,900	PO	Active Permit	TEMP1732668153
30-015-37820	COG OPERATING LLC	EDDY	S:14, T:17S, R:31E	SKELLY UNIT	679	4/23/2010	7,100		Yes	link	7,100	PO	Active Permit	TEMP192471633
30-015-37613	COG OPERATING LLC	EDDY	S:14, T:17S, R:31E	SKELLY UNIT	642	2/8/2010		7,000	Yes	link	7,038	O	Active Permit	TEMP1608128122
30-025-39976	CIMAREX ENERGY CO. OF COLORADO	LEA	S:18, T:17S, R:32E	HT FEDERAL	8	1/1/2010	7,000		Yes	link	7,000	PO	Active Permit	TEMP1615430510
30-015-37476	COG OPERATING LLC	EDDY	S:14, T:17S, R:31E	SKELLY UNIT	767	12/18/2009	6,900		Yes	link	6,900	PO	Active Permit	TEMP1263940295
30-015-37446	COG OPERATING LLC	EDDY	S:23, T:17S, R 31E	SKELLY UNIT	795	12/11/2009	6,900		Yes	link	6,920	O	Active Permit	TEMP157458034
30-015-37245	COG OPERATING LLC	EDDY	S:14, T:17S, R:31E	SKELLY UNIT	660	8/26/2009	6,800		Yes	link	6,800	PO	Active Permit	TEMP349099075
30-015-37222	COG OPERATING LLC	EDDY	S:14, T:17S, R:31E	SKELLY UNIT	685	8/12/2009	6,800		Yes	link	6,808	O	Active Permit	TEMP996859581
30-015-37161	HUDSON OIL COMPANY OF TEXAS	EDDY	S:13, T:17S, R:31E	PUCKETT NORTH	7	7/10/2009	4,300		Yes	link	4,296	O	Active Permit	TEMP273544166
30-015-37160	HUDSON OIL COMPANY OF TEXAS	EDDY	S:12, T:17S, R:31E	PUCKETT NORTH	6	7/10/2009	4,300		Yes	link	4,290	O	Active Permit	TEMP1280882995
30-025-39420	COG OPERATING LLC	LEA	S:19, T:17S, R:32E	G C FEDERAL	34	5/19/2009	6,922	6,900	Yes	link	6,900	O	Active Permit	TEMP1360209628
30-025-39358	COG OPERATING LLC	LEA	S:19, T:17S, R:32E	BC FEDERAL	37	1/30/2009	6,800		Yes	link	7,010	O	Active Permit	TEMP615591651
30-015-36847	COG OPERATING LLC AGENT or COG OPERATING LLC	EDDY	S:11, T:17S, R:31E	TEX MACK 11 FEDERAL	5	12/12/2008	6,631	6,600	Yes	link	6,845	O	Active Permit	TEMP1524485577

30-015-36832	COG OPERATING LLC	EDDY	S 14, T:17S, R:31E	SKELLY UNIT	621	12/5/2008	6,628	6,600	Yes	link	6,857	O	Active Permit	TEMP1082235356
30-015-36780	COG OPERATING LLC	EDDY	S:14, T:17S, R:31E	SKELLY UNIT	624	11/21/2008	6,600		Yes	link	6,620	O	Active Permit	TEMP1356502269
30-015-36885	COG OPERATING LLC	EDDY	S:14, T:17S, R:31E	SKELLY UNIT	605	11/4/2008	6,700		Yes	link	6,721	O	Active Permit	TEMP1484592087
30-015-36633	HUDSON OIL COMPANY OF TEXAS	EDDY	S:12, T:17S, R:31E	PUCKETT NORTH	3	9/17/2008	4,300		Yes	link	4,250	O	Active Permit	TEMP1755063219
30-015-36589	COG OPERATING L L C AGENT or COG OPERATING LLC	EDDY	S:23, T:17S, R:31E	SKELLY UNIT	990	8/19/2008	6,700		Yes	link	6,720	U	Active Permit	TEMP462510266
30-015-36597	COG OPERATING L L C AGENT or COG OPERATING LLC	EDDY	S:14, T:17S, R:31E	SKELLY UNIT	974	8/4/2008	6,511	6,500	Yes	link	6,500	O	Active Permit	TEMP1115166405
30-015-36471	COG OPERATING LLC AGENT or COG OPERATING LLC	EDDY	S 14, T:17S, R:31E	SKELLY UNIT	991	7/31/2008	6,700		Yes	link	6,521	O	Active Permit	TEMP1244534606
30-025-39021	COG OPERATING LLC	LEA	S:19, T:17S, R:32E	BC FEDERAL	35	6/13/2008	6,800		Yes	link	6,825	O	Active Permit	TEMP2056387133
30-015-36356	CHEVRON U S A INC or CHEVRON USA INC	EDDY	S:23, T:17S, R:31E	SKELLY UNIT	975	5/29/2008	6,600		Yes	link	6,747	O	Active Permit	TEMP1218095490
30-025-38837	COG OPERATING LLC	LEA	S:19, T:17S, R:32E	BC FEDERAL	19	3/26/2008	7,200		Yes	link	7,200	PO	Active Permit	TEMP282327276
30-025-38725	COG OPERATING LLC	LEA	S 19, T:17S, R:32E	BC FEDERAL	18	1/25/2008	7,200		Yes	link	7,180	O	Active Permit	TEMP194870078
30-015-34747	HUDSON OIL COMPANY OF TEXAS	EDDY	S:12, T:17S, R:31E	PUCKETT NORTH	2	3/28/2006	4,300		No	link	4,300	PO	Active Permit	TEMP1927347174
30-025-36998	MACK ENERGY CORPORATION or MACK ENERGY CORP	LEA	S:19, T:17S, R:32E	BC FEDERAL	011	12/8/2004	7,000		No	link	6,720	O	Active Permit	TEMP395711160
30-025-36999	MACK ENERGY CORPORATION or MACK ENERGY CORP	LEA	S:19, T:17S, R:32E	GC FEDERAL	005	12/8/2004	7,000		No	link	7,220	O	Active	TEMP1900010551
30-025-36999	MACK ENERGY CORP	LEA	S:19, T:17S, R:32E	GC FEDERAL	005	11/30/2004			No	link	7,220	O	Active	TEMP116932085
30-015-32023	HUDSON OIL COMPANY OF TEXAS	EDDY	S:24, T:17S, R:31E	PUCKETT A	031	6/16/2003	4,200		No	link	4,200	O	Active	TEMP218953726
30-015-32287	HUDSON OIL COMPANY OF TEXAS	EDDY	S:13, T:17S, R:31E	WESCOTT FEDERAL	001	6/16/2003	6,200		No	link	6,200	O	Active	TEMP412112998
30-015-32023	HUDSON OIL COMPANY OF TEXAS	EDDY	S:24, T:17S, R:31E	PUCKETT A	031	5/31/2003			No	link	4,200	O	Active	TEMP324459305
30-015-32287	HUDSON OIL COMPANY OF TEXAS	EDDY	S:13, T:17S, R:31E	WESCOTT FEDERAL	001	5/31/2003			No	link	6,200	O	Active	TEMP315762864
30-025-08027	CONOCOPHILLIPS COMPANY	LEA	S:18, T:17S, R:32E	MCA UNIT	017	1/1/2003			No	link		O	Plugged and Abandoned	TEMP2039413596
30-025-08040	CONOCOPHILLIPS COMPANY	LEA	S:19, T:17S, R:32E	MCA UNIT	055	1/1/2003			No	link	0	O	Pumping	TEMP1047146182

30-025-08046	CONOCOPHILLIPS COMPANY	LEA	S 19, T:17S, R:32E	MCA UNIT	056	1/1/2003		No	link	3,984	I	Temporarily Abandoned	TEMP1223361179
30-015-31860	HUDSON OIL COMPANY OF TEXAS	EDDY	S:24, T:17S, R:31E	PUCKETT A	030	9/3/2002	4,200	No	link	4,200	PO	Active Permit	TEMP638381170
30-015-31860	HUDSON OIL COMPANY OF TEXAS	EDDY	S 24, T:17S, R:31E	PUCKETT A	030	8/31/2002		No	link	4,200	PO	Active Permit	TEMP643617747
30-015-31740	HUDSON OIL COMPANY OF TEXAS	EDDY	S:12, T:17S, R:31E	PUCKETT B 12	002	8/8/2002		No	link	12,500	G	Active	TEMP605942659
30-015-31740	HUDSON OIL COMPANY OF TEXAS	EDDY	S 12, T:17S, R:31E	PUCKETT B 12	002	7/31/2002		No	link	12,500	G	Active	TEMP1835725331
30-015-31371	CHEVRON USA, INC. or CHEVRON U S A INC	EDDY	S:14, T:17S, R:31E	SKELLY UNIT	905	5/1/2002		No	link	12,470	O	Active	TEMP1410731807
30-015-32008	HUDSON OIL COMPANY OF TEXAS	EDDY	S:13, T:17S, R:31E	PUCKETT B	037	3/8/2002		No	link	12,600	O	Pumping	TEMP91196321
30-015-05133	WESTBROOK OIL CORP	EDDY	S:11, T 17S, R:31E	LEA C	005	3/1/2002		No	link		O	Active	TEMP39097044
30-015-20704	WESTBROOK OIL CORP	EDDY	S:11, T:17S, R:31E	LEA C	013	3/1/2002		No	link	4,000	I	Temporarily Abandoned	TEMP1255211935
30-015-10304	HUDSON OIL COMPANY OF TEXAS	EDDY	S:24, T:17S, R:31E	PUCKETT A	026	2/2/2001	0	No	link	5,250	O	Active	TEMP1032595564
30-015-05365	WISER OIL CO (THE)	EDDY	S 23, T 17S, R 31E	SKELLY UNIT	070	9/10/2000	0	No	link	0	PI	Temporarily Abandoned	TEMP1773114365
30-015-05384	HUDSON OIL COMPANY OF TEXAS	EDDY	S 24, T:17S, R:31E	PUCKETT A	008	8/30/2000	0	No	link	0	I	Pumping	TEMP1456081271
30-015-31304	HUDSON OIL COMPANY OF TEXAS	EDDY	S:13, T:17S, R 31E	PUCKETT A LL	001	8/18/2000		No	link	4,045	O	Pumping	TEMP1345008382
30-015-31305	HUDSON OIL COMPANY OF TEXAS	EDDY	S 13, T:17S, R 31E	PUCKETT A LL	002	8/18/2000		No	link	4,070	O	Active	TEMP1500062189
30-015-31306	HUDSON OIL COMPANY OF TEXAS	EDDY	S 13, T:17S, R 31E	PUCKETT A LL	003	8/18/2000		No	link	4,023	O	Pumping	TEMP1134165985
30-015-31081	HUDSON OIL COMPANY OF TEXAS	EDDY	S 24, T 17S, R:31E	PUCKETT A W H	001	4/12/2000		No	link	4,040	O	Active	TEMP1640434240
30-015-31082	HUDSON OIL COMPANY OF TEXAS	EDDY	S:24, T 17S, R:31E	PUCKETT A W H	002	4/12/2000		No	link	4,052	O	Pumping	TEMP1358798045
30-025-08036	CONOCO, INC.	LEA	S 19, T:17S, R:32E	MCA UNIT	018	1/18/1999		No	link	4,002	I	Injection Well	TEMP1039498021
30-015-10457	HUDSON OIL COMPANY OF TEXAS	EDDY	S 24, T:17S, R:31E	PUCKETT A	027	6/1/1998		No	link	3,900	O	Pumping	TEMP537549373
30-015-29202	WISER OIL CO (THE)	EDDY	S:14, T 17S, R 31E	SKELLY UNIT	186	4/7/1998		No	link		X	Cancelled	TEMP1189218252
30-015-29218	WISER OIL CO (THE)	EDDY	S 14, T:17S, R:31E	SKELLY UNIT	195	4/7/1998		No	link		X	Cancelled	TEMP1231910056
30-015-20469	WISER OIL CO (THE)	EDDY	S:14, T:17S, R:31E	SKELLY UNIT	110	7/18/1997	0	No	link	0	PI	Injection Well	TEMP1919242564
30-015-10773	WISER OIL CO (THE)	EDDY	S:14, T 17S, R 31E	SKELLY UNIT	035	4/4/1997	0	No	link	3,944	I	Pumping	TEMP1643638114



30-015-05359	WISER OIL CO (THE)	EDDY	S 23, T:17S, R:31E	SKELLY UNIT	049	3/31/1997	0		No	link	3,850	O	Active	TEMP1260261288
30-015-29452	WISER OIL CO (THE)	EDDY	S:23, T:17S, R:31E	SKELLY UNIT	300	3/10/1997			No	link	4,050	PI	Injection Well	TEMP1640117890
30-015-29273	WISER OIL CO (THE)	EDDY	S 14, T:17S, R:31E	SKELLY UNIT	217	11/14/1996			No	link	4,120	O	Pumping	TEMP863447778
30-015-29235	WISER OIL CO (THE)	EDDY	S:23, T:17S, R:31E	SKELLY UNIT	229	10/23/1996			No	link	4,025	O	Pumping	TEMP902564998
30-015-29236	WISER OIL CO (THE)	EDDY	S:23, T:17S, R 31E	SKELLY UNIT	230	10/23/1996			No	link	4,100	O	Active	TEMP782138592
30-015-29237	WISER OIL CO (THE)	EDDY	S:23, T:17S, R:31E	SKELLY UNIT	242	10/23/1996			No	link	4,025	O	Temporarily Abandoned	TEMP755590918
30-015-29223	WISER OIL CO (THE)	EDDY	S:14, T:17S, R:31E	SKELLY UNIT	216	10/11/1996			No	link	4,100	O	Pumping	TEMP1678603529
30-015-29217	WISER OIL CO (THE)	EDDY	S 14, T:17S, R:31E	SKELLY UNIT	194	10/9/1996			No	link	4,100	O	Pumping	TEMP950273861
30-015-29219	WISER OIL CO (THE)	EDDY	S:14, T:17S, R:31E	SKELLY UNIT	203	10/9/1996			No	link	4,100	PO	Pumping	TEMP1203823386
30-015-29183	WISER OIL CO (THE)	EDDY	S:23, T:17S, R:31E	SKELLY UNIT	243	9/24/1996			No	link	4,050	O	Pumping	TEMP1196790637
30-015-28971	WISER OIL CO (THE)	EDDY	S:14, T:17S, R 31E	SKELLY UNIT	185	5/9/1996			No	link	4,150	O	Pumping	TEMP828481601
30-015-28966	WISER OIL CO (THE)	EDDY	S:14, T:17S, R:31E	SKELLY UNIT	204	5/2/1996			No	link	4,150	O	Active	TEMP1213230501
30-015-05141	WISER OIL CO (THE)	EDDY	S:14, T 17S, R:31E	SKELLY UNIT	022	9/1/1995	0		No	link	3,311	G	Flowing	TEMP1315603833
30-015-05147	WISER OIL CO (THE)	EDDY	S 14, T:17S, R:31E	SKELLY UNIT	102	9/1/1995	0		No	link	0	I	Injection Well	TEMP842362686
30-015-05362	WISER OIL CO (THE)	EDDY	S 23, T:17S, R:31E	SKELLY UNIT	037	9/1/1995			No	link	3,886	O	Temporarily Abandoned	TEMP1682698373
30-015-10770	WISER OIL CO (THE)	EDDY	S:23, T 17S, R:31E	SKELLY UNIT	038	9/1/1995			No	link	3,910	PI	Injection Well	TEMP1884490925
30-015-20548	WISER OIL CO (THE)	EDDY	S:14, T:17S, R:31E	SKELLY UNIT	111	9/1/1995	0		No	link	3,835	O	Active	TEMP424647735
30-015-20549	WISER OIL CO (THE)	EDDY	S:14, T:17S, R:31E	SKELLY UNIT	112	9/1/1995	0		No	link	3,947	O	Active	TEMP391944079
30-015-20558	WISER OIL CO (THE)	EDDY	S 14, T:17S, R:31E	SKELLY UNIT	113	9/1/1995	0		No	link	3,959	PO	Pumping	TEMP1203748934
30-015-22484	WISER OIL CO (THE)	EDDY	S 23, T:17S, R:31E	SKELLY UNIT	141	9/1/1995	0		No	link	2,700	O	Active	TEMP2126970865
30-015-22513	WISER OIL CO (THE)	EDDY	S 23, T 17S, R:31E	SKELLY UNIT	143	9/1/1995	0		No	link	2,650	O	Temporarily Abandoned	TEMP428931403
30-015-22530	WISER OIL CO (THE)	EDDY	S:14, T:17S, R:31E	SKELLY UNIT	148	9/1/1995			No	link		O	Temporarily Abandoned	TEMP140496970
30-015-22493	STEVENS OPERATING CORPORATION or HANAGAN PETROLEUM CORP	EDDY	S:14, T:17S, R:31E	PRE-ONGARD WELL	149	1/1/1970			No	link		PO	Active Permit	TEMP755496528
30-015-05393	HUDSON OIL COMPANY OF TEXAS	EDDY	S:24, T 17S, R:31E	PUCKETT A	022	12/13/1960			No	link		I	Injection Well	TEMP1817008271

## Offset wells to Puckett 13 #54

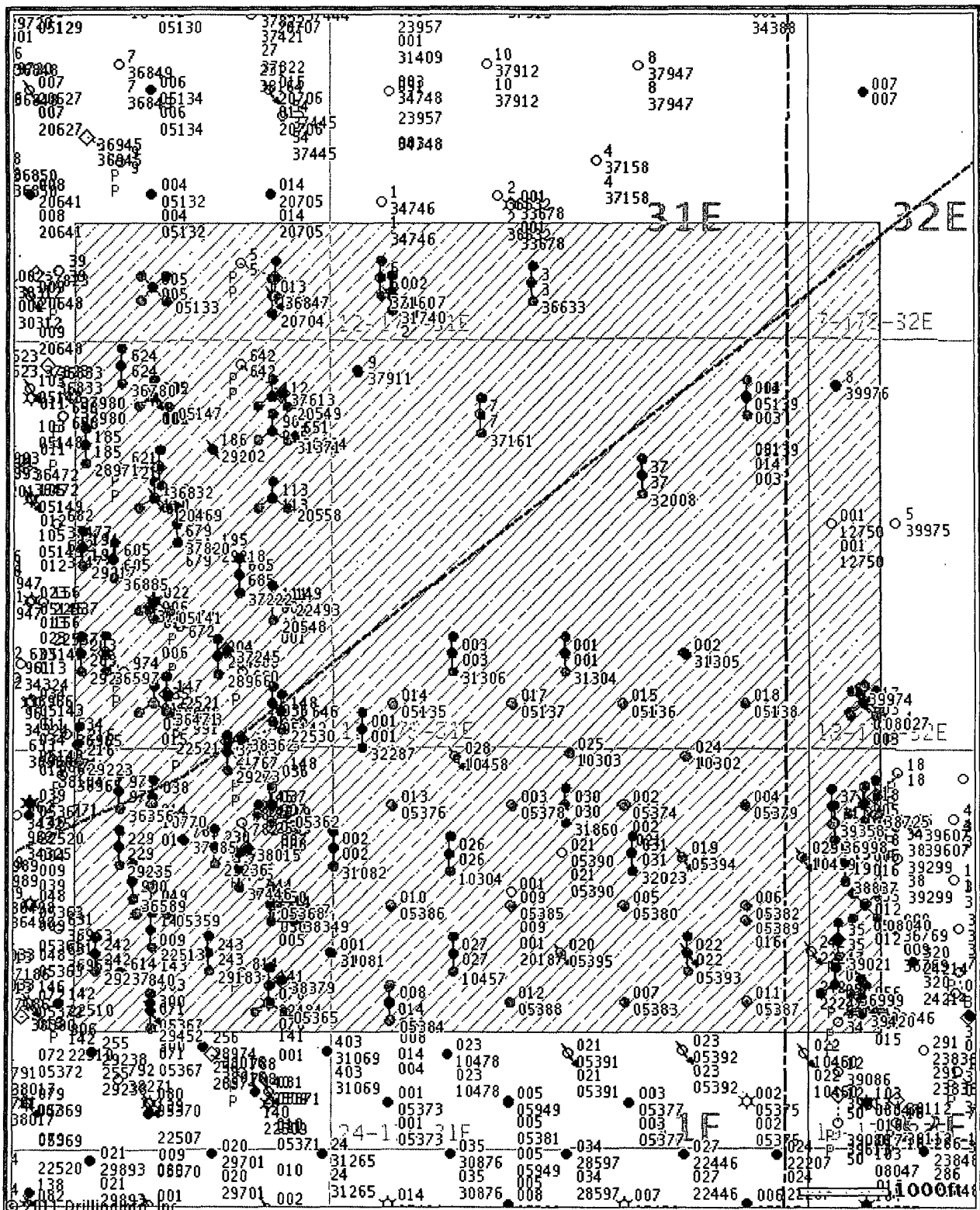

© 2011 Drilling Info, Inc. All rights reserved. All data and information is provided "As Is" and subject to the DI subscription agreement.