

District I
1625 N. French Dr., Hobbs, NM 88240
District II
1301 W. Grand Avenue, Artesia, NM 88210
District III
1000 Rio Brazos Road, Aztec, NM 87410
District IV
1220 S. St. Francis Dr., Santa Fe, NM 87505

State of New Mexico
Energy Minerals and Natural
Resources

Oil Conservation Division
1220 South St. Francis Dr.
Santa Fe, NM 87505

Form C-144
June 1, 2004

For drilling and production facilities, submit
to appropriate NMOCD District Office.
For downstream facilities, submit to Santa Fe
office

Pit or Below-Grade Tank Registration or Closure

Is pit or below-grade tank covered by a "general plan"? Yes X No ☐

Type of action: Registration of a pit or below-grade tank ☐ Closure of a pit or below-grade tank X

Operator: Yates Petroleum Corporation Telephone: 505-748-4500 e-mail address: mikes@ypc.com		
Address: 105. South 4 th street, Artesia, N.M. 88210		
Facility or well name: Margene AWM Fed. # 4 API #: 30-005-63483 U/L or Qtr/Qtr O_Sec 19 T 9s_R 26e		
County: Chaves Latitude 33.5126 Longitude 104.33311 NAD: 1927 <input type="checkbox"/> 1983 X		
Surface Owner: Federal X State Private Indian <input type="checkbox"/>		
Pit Type: Drilling X Production <input type="checkbox"/> Disposal <input type="checkbox"/> Work over <input type="checkbox"/> Emergency <input type="checkbox"/> Lined X Unlined <input type="checkbox"/> Liner type: Synthetic X 12 mil. Thickness NA mil Clay <input type="checkbox"/> Pit Volume 15,000_bbl	Below-grade tank Volume: bbl Type of fluid: Construction material: Double-walled, with leak detection? Yes <input type="checkbox"/> If not, explain why not. 	
Depth to ground water (vertical distance from bottom of pit to seasonal high water elevation of ground water.)	Less than 50 feet	(20 points)
	50 feet or more, but less than 100 feet	(10 points)X
	100 feet or more	(0 points)
Wellhead protection area: (Less than 200 feet from a private domestic water source, or less than 1000 feet from all other water sources.)	Yes	(20 points)
	No	(0 points)X
Distance to surface water: (horizontal distance to all wetlands, playas, irrigation canals, ditches, and perennial and ephemeral watercourses.)	Less than 200 feet	(20 points)
	200 feet or more, but less than 1000 feet	(10 points)
	1000 feet or more	(0 points)
Ranking Score (Total Points)		10 Points

If this is a pit closure: (1) Attach a diagram of the facility showing the pit's relationship to other equipment and tanks. (2) Indicate disposal location: (check the onsite box if your are burying in place) onsite X offsite ☐ If offsite, name of facility (3) Attach a general description of remedial action taken including remediation start date and end date. (4) Groundwater encountered: No ☐ Yes ☐ If yes, show depth below ground surface ft. and attach sample results. (5) Attach soil sample results and a diagram of sample locations and excavations.

Additional Comments: Workplan closure for Encapsulation trench. The drilling pit contents will be mixed to stiffen the pit contents. Encapsulation trench will be excavated and lined with a 12 mil. Synthetic liner on former drilling pit site. Drilling pit contents will then be emplaced into the encapsulation trench. A 20 mil. Synthetic liner will then be placed over the pit contents with a min. of a 3' over lap of the under laying trench area. The encapsulation trenches will then backfilled back to grade using a min. of 3' of clean soil and like material. A one call & 48 hour notice will be provide to the Oil Conservation Division before pit closure actions began.
Pit Closure actions to begin by NA. Ending date NA.

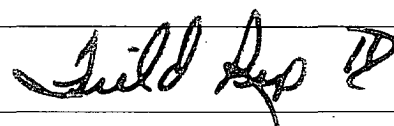
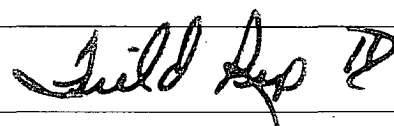
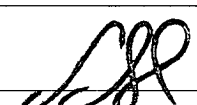
I hereby certify that the information above is true and complete to the best of my knowledge and belief. I further certify that the above-described pit or below-grade tank has been/will be constructed or closed according to NMOCD guidelines <input type="checkbox"/> , a general permit X, or an (attached) alternative OCD-approved plan <input type="checkbox"/> .		
Date: 3/24/2005	Signature 	
Printed Name/Title Dan Dolan/ Regulatory agent	Signature 	
Your certification and NMOCD approval of this application/closure does not relieve the operator of liability should the contents of the pit or tank contaminate ground water or otherwise endanger public health or the environment. Nor does it relieve the operator of its responsibility for compliance with any other federal, state, or local laws and/or regulations.		
Approval: 	Signature 	Date: MAR 29 2005

New Mexico Office of the State Engineer
Well Reports and Downloads

Township: 09S Range: 26E Sections:

NAD27 X: Y: Zone: Search Radius:

County: Basin: Number: Suffix:

Owner Name: (First) (Last) ☐ Non-Domestic ☐ Domestic
☒ All

Well / Surface Data Report

Avg Depth to Water Report

Water Column Report

Clear Form

WATERS Menu

Help

AVERAGE DEPTH OF WATER REPORT 03/24/2005

Bsn	Tws	Rng	Sec	Zone	X	Y	Wells	(Depth Water in Feet)		
								Min	Max	Avg
RA	09S	26E	12				1	99	99	99

Record Count: 1

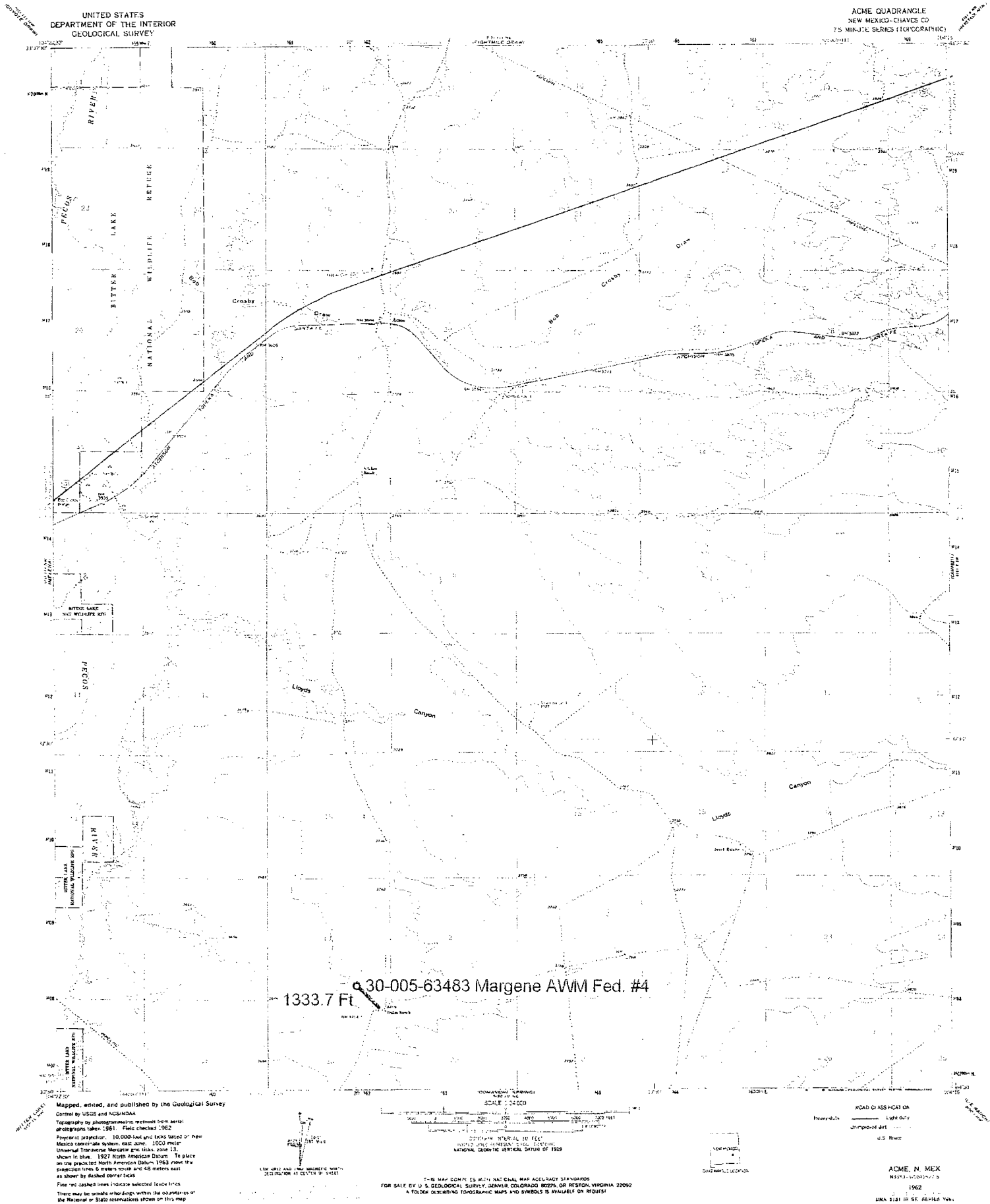

Mapped, edited, and published by the Geological Survey
Control by USGS and NGS/INDIA
Topography by photogrammetric methods from aerial
photographs taken 1961. Field checked 1962
Polyconic projection. 10,000-foot and ticks based on New
Mexico coordinate system, east zone, 1953 meridian
Universal Transverse Mercator and ticks, zone 13,
shown in blue. 1927 North American Datum. To place
on the published North American Datum 1983, move the
projection lines 6 meters south and 48 meters east
as shown by dashed corner ticks
Five red dashed lines indicate selected tie lines
There may be small encroachments within the boundaries of
the National or State reservations shown on this map

SCALE 1:24,000
CONTINENTAL SHEET NO. 100
NATIONAL GEODETIC VERTICAL DATUM OF 1929
THIS MAP COMPLETES WITH NATIONAL MAP ACCURACY STANDARDS
FOR SALE BY U.S. GEOLOGICAL SURVEY, JENNIFER COLORADO 80525 OR RESTON, VIRGINIA 22092
A FOLDER DESCRIBING TOPOGRAPHIC MAPS AND SYMBOLS IS AVAILABLE ON REQUEST

ROAD CLASSIFICATION
Heavy-duty Light-duty
Unimproved dirt
U.S. Road
ACME, N. MEX.
N30P3-10001-1/2 S
1962
DATA 2181 IN ST. REVER YER.

◦ 30-005-63481 Dallas AUE St. #5

◦ 30-005-63618 Quiniela "AXQ" State #3