

District I  
1625 N. French Dr., Hobbs, NM 88240  
District II  
1301 W. Grand Avenue, Artesia, NM 88210  
District III  
1000 Rio Brazos Road, Aztec, NM 87410  
District IV  
1220 S. St. Francis Dr., Santa Fe, NM 87505

State of New Mexico  
Energy Minerals and Natural Resources

Form C-144  
June 1, 2004

Oil Conservation Division  
1220 South St. Francis Dr.  
Santa Fe, NM 87505

For drilling and production facilities, submit to appropriate NMOCD District Office.  
For downstream facilities, submit to Santa Fe office

**Pit or Below-Grade Tank Registration or Closure**

Is pit or below-grade tank covered by a "general plan"? Yes ☐ No ☒

Type of action: Registration of a pit or below-grade tank ☒ Closure of a pit or below-grade tank ☐

Operator: <u>Mewbourne Oil Company</u> Telephone: <u>505-393-5905</u> e-mail address: <u>hobeng@mewbourne.com</u>		
Address: <u>P.O. Box 5270, Hobbs, New Mexico 88241</u>		
Facility or well name: <u>Patriot "30" Federal Com #1</u> API #: <u>30-015-33471</u> U/L or Qtr/Qtr <u>K</u> Sec <u>30</u> T <u>20S</u> R <u>29E</u>		
County: <u>Eddy</u> Latitude <u>32-32-30.4 N</u> Longitude <u>104-07-02.3 W</u> NAD: 1927 <input type="checkbox"/> 1983 <input checked="" type="checkbox"/>		
Surface Owner: Federal <input checked="" type="checkbox"/> State <input type="checkbox"/> Private <input type="checkbox"/> Indian <input type="checkbox"/>		
<b>Pit</b> Type: Drilling <input type="checkbox"/> Production <input type="checkbox"/> Disposal <input checked="" type="checkbox"/> Workover <input type="checkbox"/> Emergency <input type="checkbox"/> Lined <input checked="" type="checkbox"/> Unlined <input type="checkbox"/> Liner type: Synthetic <input checked="" type="checkbox"/> Thickness <u>12</u> mil Clay <input type="checkbox"/> Pit Volume <u>4800</u> bbl	<b>Below-grade tank</b> Volume: _____ bbl Type of fluid: _____ Construction material: _____ Double-walled, with leak detection? Yes <input type="checkbox"/> If not, explain why not. _____	
Depth to ground water (vertical distance from bottom of pit to seasonal high water elevation of ground water.)	Less than 50 feet 50 feet or more, but less than 100 feet 100 feet or more	(20 points) No ground water records in (10 points) section 30 or the surrounding ( 0 points) sections.
Wellhead protection area: (Less than 200 feet from a private domestic water source, or less than 1000 feet from all other water sources.)	Yes No <u>X</u>	(20 points) ( 0 points) <u>X</u>
Distance to surface water: (horizontal distance to all wetlands, playas, irrigation canals, ditches, and perennial and ephemeral watercourses.)	Less than 200 feet 200 feet or more, but less than 1000 feet 1000 feet or more <u>X</u>	(20 points) (10 points) ( 0 points) <u>X</u>
	<b>Ranking Score (Total Points)</b>	<b>0 points</b>

**If this is a pit closure:** (1) Attach a diagram of the facility showing the pit's relationship to other equipment and tanks. (2) Indicate disposal location: (check the onsite box if you are burying in place) onsite ☐ offsite ☐ If offsite, name of facility \_\_\_\_\_. (3) Attach a general description of remedial action taken including remediation start date and end date. (4) Groundwater encountered: No ☐ Yes ☐ If yes, show depth below ground surface \_\_\_\_\_ ft. and attach sample results. (5) Attach soil sample results and a diagram of sample locations and excavations.

Additional Comments: Mewbourne Oil Company proposes to dig a "deep bury" pit to dispose of the reserve pit from this location and another pit to dispose of the contents of the reserve pit on the Justice Federal Com #1. Please find attached the BLM Sundry with permission to dispose of the reserve pit contents on this location. Also enclosed is a diagram of the above location showing the approximate spot of the "deep bury" pits. We will start to reclaim these pits as soon as possible after your approval.
We will send both closure forms as soon as the remediation is complete.

I hereby certify that the information above is true and complete to the best of my knowledge and belief. I further certify that the above-described pit or below-grade tank has been/will be constructed or closed according to NMOCD guidelines ☒ a general permit ☐, or an (attached) alternative OCD-approved plan ☐.

Date: 03/11/2005

Printed Name/Title F. Lathan / Drilling Foreman

Signature F. Lathan

Your certification and NMOCD approval of this application/closure does not relieve the operator of liability should the contents of the pit or tank contaminate ground water or otherwise endanger public health or the environment. Nor does it relieve the operator of its responsibility for compliance with any other federal, state, or local laws and/or regulations.

Approval:

Printed Name/Title Wild Ap ID

Signature [Signature]

MAR 16 2005

RECEIVED

MAR 14 2005

SPECIAL STIPULATIONS  
PARIOT 30 FEDERAL COM #1  
Sec. 30, T20S, R29E  
JUSTICE FEDERAL COM #1  
Sec. 1, T21S, R27E

Give BLM three working day notice before reclamation of the pits begins and three working days notice before any reseeded is done so this work can be witnessed.

PATRIOT "30" FED COM # 1

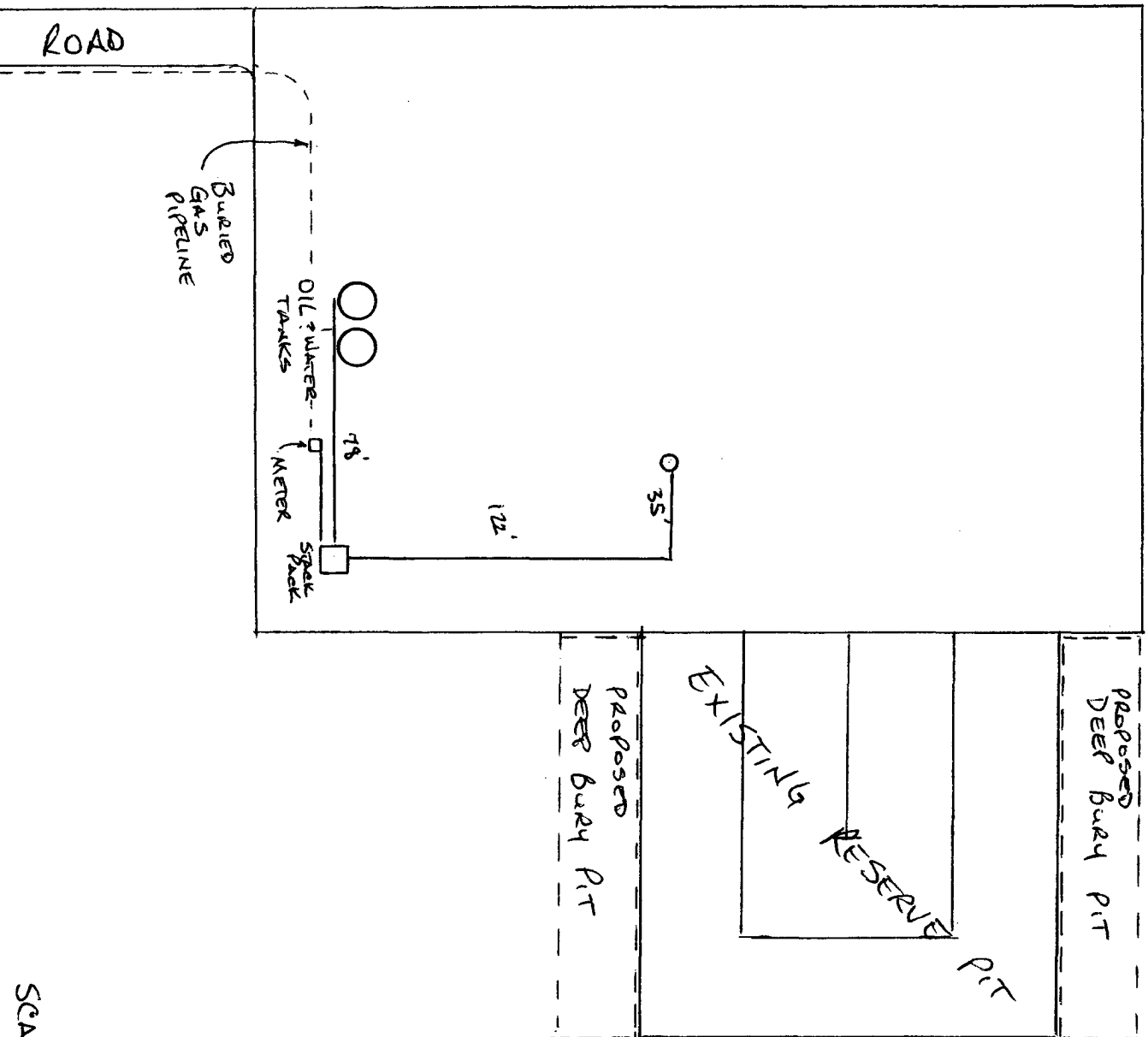
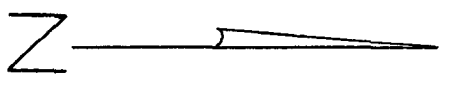

SCALE: 1" = 60'