

District I
1625 N. French Dr., Hobbs, NM 88240
District II
1301 W. Grand Avenue, Artesia, NM 88210
District III
1000 Rio Brazos Road, Aztec, NM 87410
District IV
1220 S. St. Francis Dr., Santa Fe, NM 87505

State of New Mexico
Energy Minerals and Natural Resources

Form C-144
June 1, 2004

Oil Conservation Division
1220 South St. Francis Dr.
Santa Fe, NM 87505

For drilling and production facilities, submit to appropriate NMOCD District Office.
For downstream facilities, submit to Santa Fe office

Pit or Below-Grade Tank Registration or Closure

Is pit or below-grade tank covered by a "general plan"? Yes X No ☐

Type of action: Registration of a pit or below-grade tank ☐ Closure of a pit or below-grade tank X

Operator: Yates Petroleum Company Telephone: 505-748-4500 e-mail address: mikes@ypc.com

Address: 105 South 4th Street, Artesia, N.M. 88210

Facility or well name: Buder CAN #2 API #: 30-005-63513 U/L or Qtr/Qtr K Sec 22 T 6S R 26E

County: Chaves Latitude 33.77832 Longitude 104.28778 NAD: 1927 ☐ 1983 X

Surface Owner: Federal ☐ State ☒ Private ☐ Indian ☐

RECEIVED

MAR 16 2005

~~OFF-ARTESIA~~

Pit

Type: Drilling X Production ☐ Disposal ☐

Work over ☐ Emergency ☐

Lined X Unlined ☐

Liner type: Synthetic ☐ Thickness 12 mil Clay ☐

Pit Volume 12,000 bbl

Below-grade tank

Volume: _____ bbl Type of fluid: _____

Construction material: _____

Double-walled, with leak detection? Yes ☐ If not, explain why not. _____

Depth to ground water (vertical distance from bottom of pit to seasonal high water elevation of ground water.)

Less than 50 feet

(20 points)

50 feet or more, but less than 100 feet

(10 points) XXXX

100 feet or more

(0 points)

Wellhead protection area: (Less than 200 feet from a private domestic water source, or less than 1000 feet from all other water sources.)

Yes

(20 points)

No

(0 points)XXXX

Distance to surface water: (horizontal distance to all wetlands, playas, irrigation canals, ditches, and perennial and ephemeral watercourses.)

Less than 200 feet

(20 points)

200 feet or more, but less than 1000 feet

(10 points)

1000 feet or more

(0 points) XXXX

Ranking Score (Total Points)

10 POINTS

- If this is a pit closure:** (1) Attach a diagram of the facility showing the pit's relationship to other equipment and tanks. (2) Indicate disposal location: (check the onsite box if your are burying in place) onsite X offsite If offsite, name of facility NA. (3) Attach a general description of remedial action taken including remediation start date and end date.
- (4) Groundwater encountered: No ☐ Yes ☐ If yes, show depth below ground surface _____ ft. and attach sample results.
- (5) Attach soil sample results and a diagram of sample locations and excavations.

Additional Comments: Closure work plan for encapsulation trench. The drilling pit contents will be mixed to stiffen the pit contents. Encapsulation trench will be excavated and lined with a 12 mil. Synthetic liner on former drilling pit site. Drilling pit contents will then be emplaced into the encapsulation trench. A 20 mil. Synthetic liner will then be placed over the pit contents with a min. of a 3' over lap of the underlying trench areas. The encapsulation trenches will then be backfilled back to grade using a min. of 3' of clean soil and like material. A one call & 48 hour notice will be provided to the Oil Conservation Division before pit closure actions begin.

Pit Closure actions to begin by NA. Ending date NA

I hereby certify that the information above is true and complete to the best of my knowledge and belief. I further certify that the above-described pit or below-grade tank has been/will be constructed or closed according to NMOCD guidelines ☐, a general permit X, or an (attached) alternative OCD-approved plan ☐.

Date: 03/15/2005

Printed Name/Title DAN J. LARSEN, REG. GEOL. Signature _____

Your certification and NMOCD approval of this application/closure does not relieve the operator of liability should the contents of the pit or tank contaminate ground water or otherwise endanger public health or the environment. Nor does it relieve the operator of its responsibility for compliance with any other federal, state, or local laws and/or regulations.

Approval:

Printed Name/Title Wild App ID Signature _____

Date: _____

MAR 17 2005

30-005-63513
Buder ACN #2

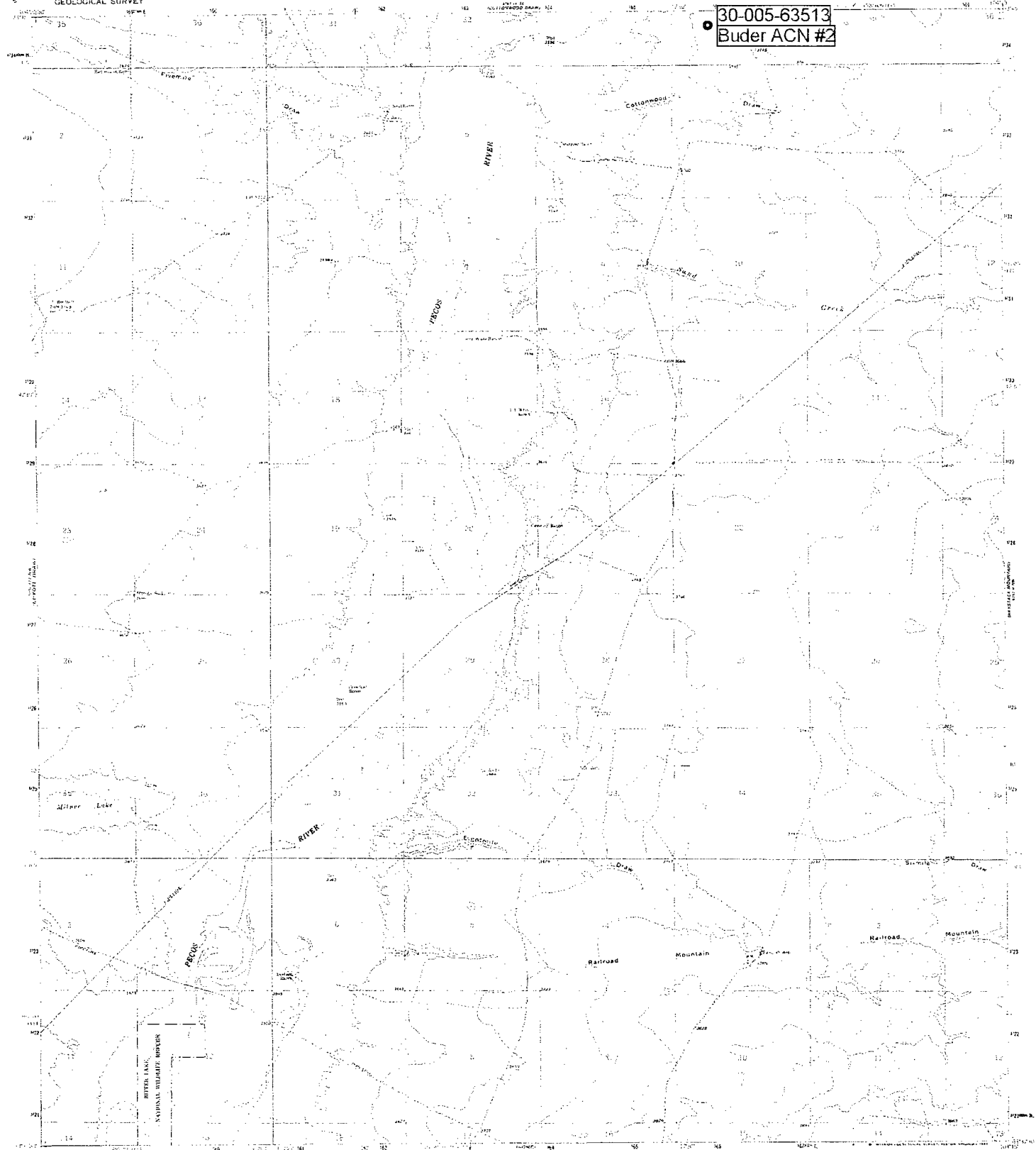

Mapped, edited, and published by the Geological Survey

Control by USGS and HOSKIN

Topography by photogrammetric methods from aerial
photographs taken 1961. Field checked 1962.
Polyconic projection. 10,000-foot grid. Data based on New
Mexico coordinate system, east zone, 1000-meter Universal
Transverse Mercator grid ticks, zone 13, shown in blue.
1927 North American Datum. To place on the projected Aztec
American Datum 1983 move the projection on lines 6 meters
south and 48 meters east as shown by metric corner ticks.
Fine red dashed lines indicate selected fence lines.
There may be private landholdings within the boundaries of
the National or State Reservations shown on this map.

NEW MEXICO AND U.S. BOUNDARY NORTH
DECLINATION AT CENTER OF SHEET

SCALE 1:24,000

1:24,000

1:24,000

1:24,000

1:24,000

1:24,000

1:24,000

1:24,000

1:24,000

1:24,000

1:24,000

1:24,000

1:24,000

1:24,000

1:24,000

1:24,000

1:24,000

1:24,000

ROAD CLASSIFICATION

1:24,000

EIGHTMILE DRAW N. MEX.

1:24,000

1962

1:24,000

1:24,000

1:24,000

1:24,000

1:24,000

1:24,000

1:24,000

1:24,000

1:24,000

1:24,000

New Mexico Office of the State Engineer

Well Reports and Downloads

Under ACN#2

Township: 06S Range: 26E Sections: 22

NAD27 X: Y: Zone: Search Radius:

County: Basin: Number: Suffix:

Owner Name: (First) (Last) ☐ Non-Domestic ☐ Domestic
☒ All

Well / Surface Data Report

Avg Depth to Water Report

Water Column Report

Clear Form

WATERS Menu

Help

AVERAGE DEPTH OF WATER REPORT 03/14/2005

Bsn	Tws	Rng	Sec	Zone	X	Y	Wells	(Depth Water in Feet)		
								Min	Max	Avg
FS	06S	26E	17				1	65	65	65
FS	06S	26E	33				1	6	6	6

Record Count: 2