

UNITED STATES
DEPARTMENT OF THE INTERIOR
BUREAU OF LAND MANAGEMENT

OCD Artesia

FORM APPROVED

OM B No. 1004-0137

Expires: March 31, 2007

SUNDRY NOTICES AND REPORTS ON WELLS
*Do not use this form for proposals to drill or to re-enter an
abandoned well Use Form 3160-3 (APD) for such proposals*
SUBMIT IN TRIPLICATE - Other instructions on reverse side.

1. Type of Well <input checked="" type="checkbox"/> Oil Well <input type="checkbox"/> Gas Well <input type="checkbox"/> Other		5. Lease Serial No. NMLC029435B
2. Name of Operator Apache Corporation		6. If Indian, Allottee or Tribe Name NA
3a. Address PO Box 1849 Eunice, NM 88231		7. If Unit of CA / Agreement, Name and/or No. NA
3b. Phone No. (include area code) 575-390-4186		8. Well Name and No. NFE Federal #10
4. Location of (Footage, Sec., T., R., or Survey Description) 1650' FNL and 330' FEL H-8-17S-31E		9. API Well No. 30-015-37360
		10. Field and Pool, or Exploratory Area Glorieta-Yeso
		11. County or Parish, State Eddy County, NM

12. CHECK APPROPRIATE BOX(ES) TO INDICATE NATURE OF NOTICE, REPORT, OR OTHER DATA

TYPE OF SUBMISSION	TYPE OF ACTION			
<input checked="" type="checkbox"/> Notice of Intent	<input type="checkbox"/> Acidize	<input type="checkbox"/> Deepen	<input type="checkbox"/> Production (Start/Resume)	<input type="checkbox"/> Water Shut-off
<input type="checkbox"/> Subsequent Report	<input type="checkbox"/> Alter Casing	<input type="checkbox"/> Fracture Treat	<input checked="" type="checkbox"/> Reclamation	<input type="checkbox"/> Well Integrity
<input type="checkbox"/> Final Abandonment Notice	<input type="checkbox"/> Casing Repair	<input type="checkbox"/> New Construction	<input type="checkbox"/> Recomplete	<input checked="" type="checkbox"/> Other Downsize _____
	<input type="checkbox"/> Change Plans	<input type="checkbox"/> Plug and Abandon	<input type="checkbox"/> Temporarily Abandon	Reseeding
	<input type="checkbox"/> Convert to Injection	<input type="checkbox"/> Plug Back	<input type="checkbox"/> Water Disposal	

13. Describe Proposed or Completed Operation (clearly state all pertinent details, including estimated starting date of any proposed work and approximate duration thereof. If the proposal is to deepen directionally or recompleat horizontally, give subsurface locations and measured and true vertical depths of all pertinent markers and zones. Attach the Bond under which the work will be performed or provide the bond No. on file with the BLM / BIA. Required subsequent reports shall be filed within 30 days following completion of the involved operations. If the operation results in multiple completion or recompleat in a new interval, a Form 3160-4 shall be filed once testing has been completed. Final Abandonment Notices shall be filed only after all requirements, including reclamation, have been completed, and the operator has determined that the site is ready for final inspection)

This well was drilled in 2010, site was downsized on 02/3/11 and was reseeded on 8/23/2011. BLM Seed #2 was added as per APD. The site was watered a total of five days. Location drawing is attached.

RECEIVED

MAY 15 2012

NMOCD ARTESIA

ACCEPTED FOR RECORD

MAY 13 2012

BUREAU OF LAND MANAGEMENT
CARLSBAD FIELD OFFICE

14. I hereby certify that the following is true and correct

Name

Natalie Gladden

Title

EHS Environmental Tech

Signature

Date

2/13/12

THIS SPACE FOR FEDERAL OR STATE OFFICE USE

Approved by

Title

Date

Conditions of approval, if any, are attached. Approval of this notice does not warrant or certify that the applicant holds legal or equitable title to those rights in the subject lease which would entitle the applicant to conduct operations thereon.

Office

Title 18 U.S.C., Section 1001 and Title 43 U.S.C., Section 1212, make it a crime for any person knowingly and willfully to make to any department or agency of the United States any false, fictitious or fraudulent statements or representations as to any matter within its jurisdiction

(Down size, location pad.)

Date / /

Lease name NFE Federal Well # 10

Notes:

- #1, Before &, after location size.
- #2, Where the electric cable pole is located.
- #3, Date and year of down size.
- #4, Draw road direction coming in, and direction of pump jack.
- #5, Leave more space towards front of P/Jack head, or side away flow line.
- #6, Don't remove entrance road coming into location.

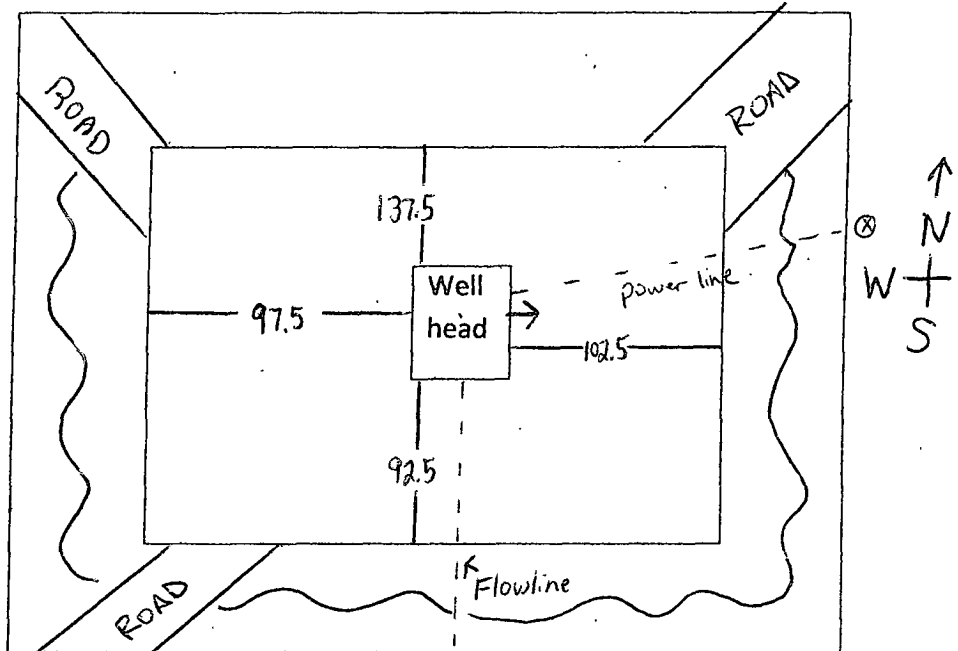

(A) Before down size.	275 X 275
(B) After down size.	235 X 200
(C) Calliche dirt Destiny.	

Description. Downsize Location

(Operator Name) _____ Date / /