

UNITED STATES
DEPARTMENT OF THE INTERIOR
BUREAU OF LAND MANAGEMENT

OCD-ARTESIA

FORM APPROVED
OMB NO. 1004-0135
Expires: November 30, 2000**SUNDRY NOTICES AND REPORTS ON WELLS**
*Do not use this form for proposals to drill or to re-enter an abandoned well. Use form 3160-3 (APD) for such proposals.*5. Lease Serial No.
NMNM 111960

6. If Indian, Allottee or Tribe Name

7. If Unit or CA/Agreement, Name and/or No.

SUBMIT IN TRIPLICATE - Other instructions on reverse side.

1. Type of Well

☐ Oil Well ☒ Gas Well ☐ Other8. Well Name and No.
ROYAL FLUSH FEDERAL 12. Name of Operator
CHESAPEAKE OPERATING INCContact: LINDA GOOD
E-Mail: lgood@chkenergy.com9. API Well No.
30-015-337363a. Address
P O BOX 18496
OKLAHOMA CITY, OK 73154-04963b. Phone No. (include area code)
Ph: 405-767-4275
Fx: 405-879-958310. Field and Pool, or Exploratory
UNKNOWN SOUTH SAND DUNES-

4. Location of Well (Footage, Sec., T., R., M., or Survey Description)

Sec 15 T24S R31E SWNE 1480FNL 1980FEL

RECEIVED

APR 14 2005

OCD-ARTESIA

11. County or Parish, and State

EDDY COUNTY, NM

12. CHECK APPROPRIATE BOX(ES) TO INDICATE NATURE OF NOTICE, REPORT, OR OTHER DATA

TYPE OF SUBMISSION	TYPE OF ACTION			
<input type="checkbox"/> Notice of Intent	<input type="checkbox"/> Acidize	<input type="checkbox"/> Deepen	<input type="checkbox"/> Production (Start/Resume)	<input type="checkbox"/> Water Shut-Off
<input checked="" type="checkbox"/> Subsequent Report	<input type="checkbox"/> Alter Casing	<input type="checkbox"/> Fracture Treat	<input type="checkbox"/> Reclamation	<input type="checkbox"/> Well Integrity
<input type="checkbox"/> Final Abandonment Notice	<input type="checkbox"/> Casing Repair	<input type="checkbox"/> New Construction	<input type="checkbox"/> Recomplete	<input checked="" type="checkbox"/> Other
	<input type="checkbox"/> Change Plans	<input type="checkbox"/> Plug and Abandon	<input type="checkbox"/> Temporarily Abandon	
	<input type="checkbox"/> Convert to Injection	<input type="checkbox"/> Plug Back	<input type="checkbox"/> Water Disposal	

13. Describe Proposed or Completed Operation (clearly state all pertinent details, including estimated starting date of any proposed work and approximate duration thereof. If the proposal is to deepen directionally or recompleat horizontally, give subsurface locations and measured and true vertical depths of all pertinent markers and zones. Attach the Bond under which the work will be performed or provide the Bond No. on file with BLM/BIA. Required subsequent reports shall be filed within 30 days following completion of the involved operations. If the operation results in a multiple completion or recompleat in a new interval, a Form 3160-4 shall be filed once testing has been completed. Final Abandonment Notices shall be filed only after all requirements, including reclamation, have been completed, and the operator has determined that the site is ready for final inspection.)

Attached is the Archelological Survey of the access road and well pad for the Royal Flush Federal 1 new location.

BLM Nationwide Bond #NM2634.

OK
B. Howell
4/17/05
(CHK PN 819524)

14. I hereby certify that the foregoing is true and correct.

Electronic Submission #55008 verified by the BLM Well Information System
For CHESAPEAKE OPERATING INC, sent to the Carlsbad

Name (Printed/Typed) LINDA GOOD

Title PERMITTING AGENT

Signature (Electronic Submission)

Date 03/16/2005

THIS SPACE FOR FEDERAL OR STATE OFFICE USE

Approved By

/s/ James Stovall

FOR

Title FIELD MANAGER

APR - 8 2005
Date

Conditions of approval, if any, are attached. Approval of this notice does not warrant or certify that the applicant holds legal or equitable title to those rights in the subject lease which would entitle the applicant to conduct operations thereon.

Office CARLSBAD FIELD OFFICE

Title 18 U.S.C. Section 1001 and Title 43 U.S.C. Section 1212, make it a crime for any person knowingly and willfully to make to any department or agency of the United States any false, fictitious or fraudulent statements or representations as to any matter within its jurisdiction.

** OPERATOR-SUBMITTED ** OPERATOR-SUBMITTED ** OPERATOR-SUBMITTED **

523-00012

Survey for the Royal Flush Federal No. 1 Well Pad and Access Road

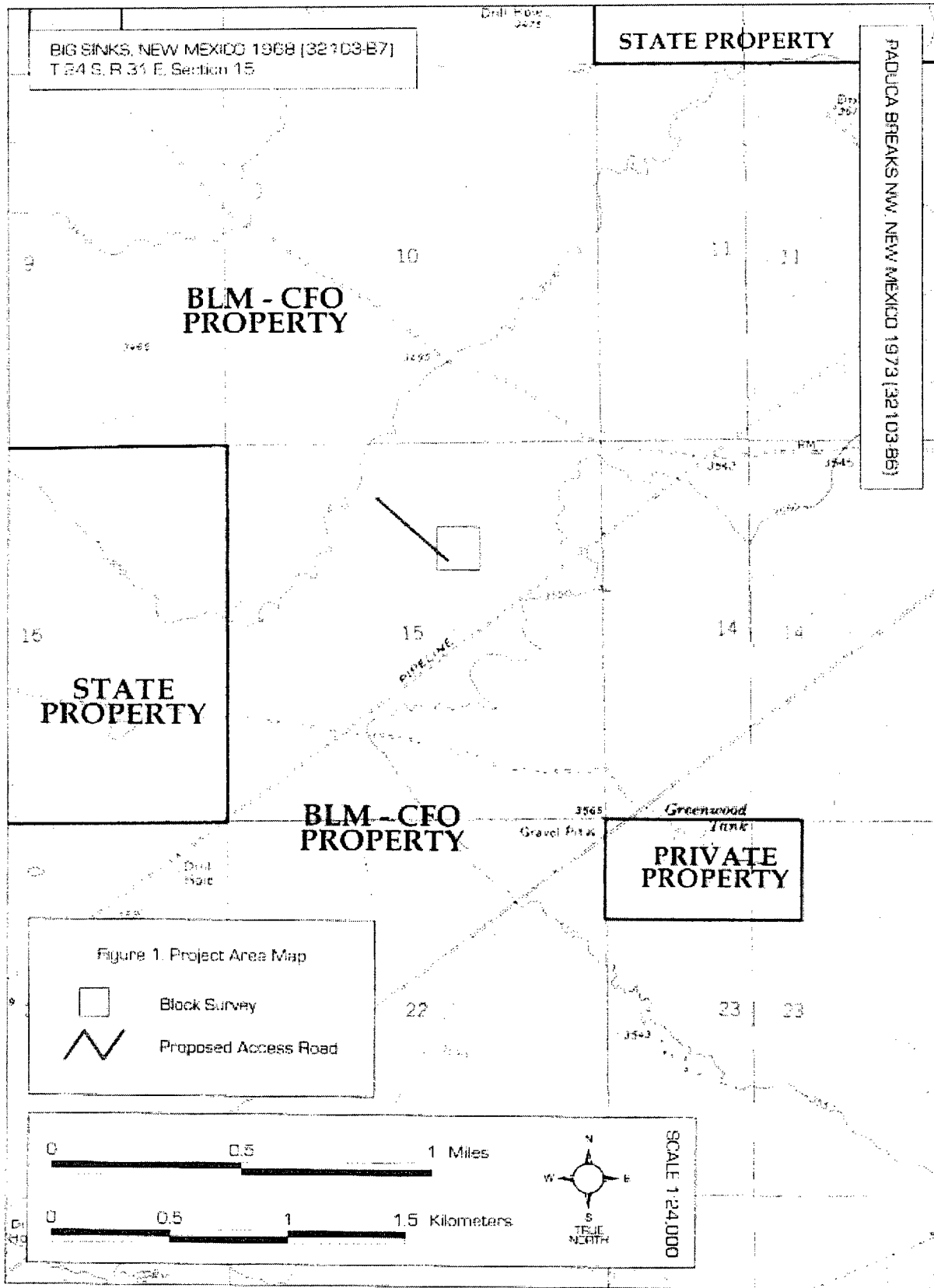

BAS-02-05-74

1. (For BLM Use) BLM Report No.		2. (For BLM Use) Reviewer's Initials/Date _____ Accepted () Rejected ()		3. NMCRIS Number: 52112	
4. Type of Report: Negative (<input checked="" type="checkbox"/>) Positive ()					
5. Title of Report: A Class III Cultural Resource Survey for the Royal Flush Federal No. 1 Well Pad and Access Road Author(s): Justin Rein				6. Fieldwork Date(s): March 9, 2005	
				7. Report Date: March 11, 2005	
8. Consultant Name/Address: Boone Archaeological Services, LLC Direct Charge: Danny Boone Field Personnel Names: Justin Rein Address: 2030 North Canal Carlsbad, New Mexico 88220 Phone (505) 885-1352				9. Cultural Resource Permit No.: 190-2920-03-E	
				10. Consultant Report No.: BAS-02-05-74	
11. Customer Name: Chesapeake Operating Inc. Responsible Individual: Linda Good Address: PO Box 18496 Oklahoma City, OK 73154-0496 Phone: (405) 767-4275				12. Customer Project No.:	
13. Land Status	BLM	State	Private	Other	Total
a. Area Surveyed (acres)	11.20				11.20
b. Area of Effect (acres)	5.14				5.14
14. Block	Length <u>600 ft</u>	Width <u>600 ft</u>			
Linear	Length <u>1,281 ft</u>	Width <u>100 ft</u>			
15. Location (Map[s] Attached):					
a. State: New Mexico					
b. County: Eddy County					
c. BLM Office: Carlsbad Field Office					
d. Nearest City or Town: Carlsbad, New Mexico					
e. Legal Description: T 24 S, R 31 E, Section 15, NE¼ NW¼, E½ NE¼					
f. Well Pad Footages: The Royal Flush Fed No. 1 is centered 1,480 feet from the north line and 1,980 feet from the east line of Section 15.					
g. USGS 7.5' Map Name(s), Date(s), and Code(s): Big Sinks, New Mexico 1968 (32103-B7)					

16. Project Data:

a. Records Search: Date(s) of BLM File Review: March 7, 2005 Name of Reviewer(s): Justin Rein

Date(s) of ARMS Data Review: March 7, 2005 Name of Reviewer(s): Justin Rein

Findings (see Field Office requirements to determine area to be reviewed during records search): No previously recorded sites were found within 0.25 miles of the project area. An expanded search revealed eight sites (LA 85121, LA 101390, LA 107811, LA 107812, LA 107814, LA 110291, LA 116376, and LA 116379) within one mile of the project. None of these sites will be affected by the current undertaking.

b. Description of Undertaking: Chesapeake Operating Inc. plans to construct the Royal Flush Federal No. 1 well pad and associated access road. Linda Good, with Chesapeake Operating, requested the survey and provided plats. The project can be found in Township 24 South, Range 31 East, Section 15. The proposed well is centered 1,480 feet from the north line and 1,980 feet from the east line of Section 15. The access road begins at the southwest corner of the proposed well location and travels 1,261 ft northwest to an existing well location. A 600 ft by 600 ft block was surveyed around the well center to ensure protection of cultural resources. Similarly, a 100 ft wide corridor was surveyed along the staked access road centerline. In all, 11.20 acres was surveyed on Federal property owned and administered by the Bureau of Land Management - Carlsbad Field Office (BLM-CFO).

c. Environmental Setting (NRCS soil designation; vegetative community; elevation; etc.): The project area is located on a flat plain roughly 30 miles southeast of Carlsbad, New Mexico. The elevation ranges from 3,505 feet to 3,530 feet above mean sea level. The terrain slopes gradually downhill towards the northeast at a grade of 1.6 percent. Local soils are of the Kermit-Berino and Simona-Pajarito associations as defined by the Soil Conservation Service of the U.S. Department of Agriculture. The reddish sandy soils have been wind-worked into occasional low coppice dunes averaging less than one meter high. Local vegetation is typical of Chihuahuan Desert scrub and includes various low forbes, grasses, mesquite, yucca, and cacti. Due to the vegetative ground cover, surface visibility averaged 95 percent at the time of survey. In addition to cattle, which range freely in the area, an existing well location is located northwest of the project area. The immediate area is otherwise undeveloped and susceptible to naturally occurring aeolian and alluvial processes.

Climatic data was obtained for the nearby city of Carlsbad, New Mexico from the Western Regional Climate Center (WRCC) online database. From 1914 to 2004, Carlsbad received an average annual precipitation of 12.65 inches. During the same time, Carlsbad had an average high temperature of 78.3 degrees Fahrenheit and an average low temperature of 47.3 degrees Fahrenheit. January was the coldest month averaging 58.5 degrees Fahrenheit, while July was the warmest on average at 95.8 degrees Fahrenheit.

d. Field Methods (transect intervals; crew size; time in field; etc.): A crew of one spent 2.5 hours surveying the project area. A 15 m transect interval was used.

e. Artifacts Collected?: None

17. Cultural Resource Findings: No cultural materials were encountered.

a. Location/Identification of Each Resource: N/A

b. Evaluation of Significance of Each Resource: N/A

18. Management Summary (Recommendations): No cultural materials were encountered during the survey. As such, archaeological clearance is recommended for the proposed Royal Flush Fed No. 1 well and access road. If any cultural materials are encountered during construction, work at that location should cease and archaeologists with the BLM-CFO should be notified immediately.

19.

I certify the information provided above is correct and accurate and meets all applicable BLM standards.

Responsible Archaeologist [Signature]

Signature

3/1/05
Date