

Submit to Appropriate  
District Office  
State Lease - 6 copies  
Fee Lease - 5 copies  
**DISTRICT I**  
P.O. Box 1980, Hobbs, NM 88240

**DISTRICT II**  
811 South First, Artesia, NM 88210

**DISTRICT III**  
1000 Rio Brazos Rd., Aztec, NM 87410

State of New Mexico  
Energy, Minerals and Natural Resources Department

**OIL CONSERVATION DIVISION**

2040 South Pacheco  
Santa Fe, New Mexico 87505

Form C-105  
Revised 1-1-89

WELL API NO.

30-015-25072

5. Indicate Type of Lease

STATE ☒

FEE ☐

6. State Oil & Gas Lease No.

V-5752

**WELL COMPLETION OR RECOMPLETION REPORT AND LOG**

1. Type of Well:

OIL WELL ☐

GAS WELL ☒

DRY ☐

OTHER \_\_\_\_\_

b. Type of Completion:

NEW  
WELL ☐

WORK  
OVER ☐

Deepen ☐

PLUG  
BACK ☐

DIFF  
RESVR ☐

OTHER \_\_\_\_\_

Re-entry

7. Lease Name or Unit Agreement Name

Oryx State

2. Name of Operator

Mack Energy Corporation

3. Address of Operator

P.O. Box 960, Artesia, NM 88211-0960

4. Well Location

Unit Letter N : 990 Feet From The South 2180 Feet From The West Line

Section 16 Township 16S Range 27E NMPM Eddy County

10. Date Spudded

3/23/2005

11. Date TD Reached

3/26/2005

12. Date Compl. (Ready to Prod.)

4/20/2005

13. Elevations (DF & RKB, RT, GR, etc.)

3580' RKB

14. Elev. Casinghead

3566'

15. Total Depth

7918

16. Plug Back TD

7235

17. If Multiple Compl. How  
Many Zones?

18. Intervals  
Drilled By

Rotary Tools

Yes

Cable Tools

19. Producing Interval(s), of this completion - Top, Bottom, Name

6613-6623', Wolfcamp

20. Was Directional Survey Made

N/A

21. Type Electric and Other Logs Run

Gamma Ray, Neutron, Density, Lateralog, Spectral Gamma Ray

22. Was Well Cored

No

23.

**CASING RECORD (Report all strings set in well)**

CASING SIZE	WEIGHT LB./FT.	DEPTH SET	HOLE SIZE	CEMENTING RECORD	AMOUNT PULLED
13 3/8	48	360	17 1/2	400 sx	None
8 5/8	24	1500	12 1/4	700 sx	None
5 1/2	17	7370	7 7/8	700 sx	None

24. **LINER RECORD**

SIZE	TOP	BOTTOM	SACKS CEMENT	SCREEN

25. **TUBING RECORD**

SIZE	DEPTH SET	PACKER SET
2 3/8	6555	6555

26. Perforation record (interval, size, and number)

6613-6623', .41, 21

27. ACID, SHOT, FRACTURE, CEMENT, SQUEEZE, ETC.

DEPTH INTERVAL

AMOUNT AND KIND MATERIAL USED

6613-6623'

1500 gals 15% NEFE

28.

**PRODUCTION**

Date First Production

4/27/2005

Production Method (Flowing, gas lift, pumping - Size and type pump)

Flowing

Well Status (Prod. or Shut-in)

Producing

Date of Test	Hours Tested	Choke Size	Prod'n For Test Period	Oil - Bbl.	Gas - MCF	Water - Bbl.	Gas - Oil Ratio
5/6/2005	24 hours			0	463	3	
Flow Tubing Press.	Casing Pressure	Calculated 24- Hour Rate	Oil - Bbl.	Gas - MCF	Water - Bbl.	Oil Gravity - API - (Corr.)	
		0		463	3		

29. Disposition of Gas (Sold, used for fuel, vented, etc.)

Sold

Test Witnessed By

Robert C. Chase

30. List Attachments

31. I hereby certify that the information shown on both sides of this form is true and complete to the best of my knowledge and belief

Signature

*Jerry W. Sherrell*

Printed  
Name

Jerry W. Sherrell

Title

Production Clerk

Date

5/20/2005

**NEW MEXICO OIL CONSERVATION COMMISSION  
WELL LOCATION AND ACREAGE DEDICATION PLAT**

Form C-10  
Superseded  
Effective 1

All distances must be from the outer boundaries of the Section.

Operator <b>Mack Energy Corporation</b>			Lease <b>Oryx State</b>		Well No. <b>1</b>
Unit Letter <b>N</b>	Section <b>16</b>	Township <b>16S</b>	Range <b>27E</b>	County <b>Eddy</b>	
Actual Footage Location of Well: <div style="display: flex; justify-content: space-between;"> <span>990</span> <span>feet from the</span> <span>South</span> <span>line and</span> <span>2180</span> <span>feet from the</span> <span>West</span> <span>line</span> </div>					
Ground Level Elev. <b>3566.3</b>	Producing Formation <b>Wolfcamp</b>		Pool <b>Diamond Mound</b>		Dedicated Acreage: <b>320</b>

1. Outline the acreage dedicated to the subject well by colored pencil or hachure marks on the plat below.
2. If more than one lease is dedicated to the well, outline each and identify the ownership thereof (both as to working interest and royalty).
3. If more than one lease of different ownership is dedicated to the well, have the interests of all owners been consolidated by communitization, unitization, force-pooling, etc?

☐ Yes   ☐ No   If answer is "yes," type of consolidation \_\_\_\_\_

If answer is "no," list the owners and tract descriptions which have actually been consolidated. (Use reverse side of this form if necessary.) \_\_\_\_\_

No allowable will be assigned to the well until all interests have been consolidated (by communitization, unitization, forced-pooling, or otherwise) or until a non-standard unit, eliminating such interests, has been approved by the Commission.

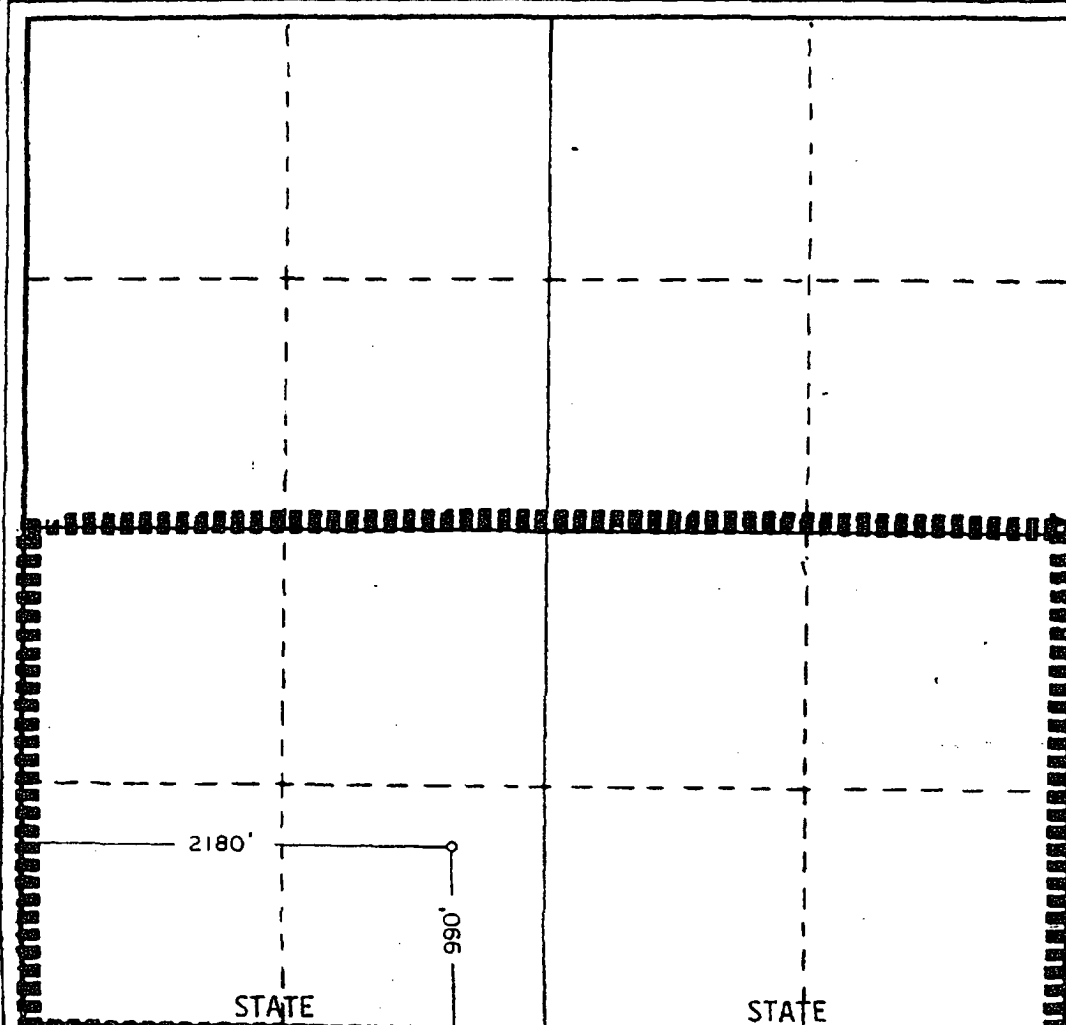

**CERTIFICATION**

I hereby certify that the information contained herein is true and complete to the best of my knowledge and belief.

*Darrell Roberts*

Name  
**Darrell Roberts**

Position  
**Operations Engineer**

Company  
**Southland Royalty Company**

Date  
**8-6-85**

I hereby certify that the well location shown on this plat was plotted from notes of actual surveys made by me under my supervision, and that the same is true and correct to the best of my knowledge and belief.

Date Surveyed  
**Nov. 2, 1984**  
Registered Professional Engineer and/or Land Surveyor

*John W. White*