

UNITED STATES  
DEPARTMENT OF THE INTERIOR  
BUREAU OF LAND MANAGEMENT

## WELL COMPLETION OR RECOMPLETION REPORT AND LOG

FORM APPROVED  
OMB NO. 1004-0137  
Expires: March 31, 2007

1a. Type of Well ☐ Oil Well ☐ Gas Well ☒ Dry ☐ Other \_\_\_\_\_

b. Type of Completion: ☒ New Well ☐ Work Over ☐ Deepen ☐ Plug Back ☐ Diff. Resrv.,  
Other \_\_\_\_\_

2. Name of Operator **COG Operating LLC**

3. Address **550 W. Texas, Suite 1300**

3a Phone No. (include area code)  
432-685-4340

4. Location of Well (Report location clearly and in accordance with Federal requirements)\*

At surface      660' FSL & 1150' FWL

At top prod. interval reported below 660' ESL & 1150' FWL

At total depth **660' FSL & 1150' FWL**

14. Date Spudded  
11/09/2004

Added 2004	15. Date T.D. Reached 12/15/2004
---------------	-------------------------------------

16. Date Completed **02/28/2005**  
☒ D & A ☐ Ready to Prod

18. Total Depth: MD  
TVD 8900

19. Plug Back T.D.: MD  
TVD

20. Depth Bridge Plug Set: MD  
TVD

21. Type Electric & Other Mechanical Logs Run (Submit copy of each)

**Platform Express Laterlog CFL / HNGS & Litho Density CNL / HNGS**

22. Was well cored? ☒ No ☐ Yes (Submit analysis)  
Was DST run? ☒ No ☐ Yes (Submit report)  
Directional Survey? ☒ No ☐ Yes (Submit copy)

23. Casing and Liner Record (Report all strings set in well)[illegible]

## 24. Tubing Record

[illegible]

## 25. Producing Intervals

Formation	Top	Bottom	Perforated Interval	Size	No. Holes	Perf. Status
A)						
B)						
C)						
D)						

## 26. Perforation Record

Perforated Interval	Size	No. Holes	Perf. Status

## 27. Acid, Fracture, Treatment, Cement Squeeze, etc.

Depth Interval	Amount and Type of Material

**28. Production - Interval A**

Date First Produced	Test Date	Hours Tested	Test Production ➔	Oil BBL	Gas MCF	Water BBL	Oil Gravity Corr. API	Gas Gravity	Production Method
Choke Size	Tbg. Press. Flwg. SI	Csg. Press.	24 Hr. Rate ➔	Oil BBL	Gas MCF	Water BBL	Gas/Oil Ratio	Well Status	ACCEPTED FOR RECORD

28a. Production - Interval B

Date First Produced	Test Date	Hours Tested	Test Production ➔	Oil BBL	Gas MCF	Water BBL	Oil Gravity Corr. API	Gas Gravity	Production Method	JUN 28 2005
Choke Size	Tbg. Press. Flwg. SI	Csg. Press.	24 Hr. Rate ➔	Oil BBL	Gas MCF	Water BBL	Gas/Oil Ratio	Well Status		acs ALEXIS C. SWOBODA DATE

*\*(See instructions and spaces for additional data on page 2)*

ACCEPTED FOR RECORD

JUN 28 2005

ALEXIS C. SWOBODA  
PETROLEUM ENGINEER

## 28b. Production - Interval C

Date First Produced	Test Date	Hours Tested	Test Production →	Oil BBL	Gas MCF	Water BBL	Oil Gravity Corr. API	Gas Gravity	Production Method
Choke Size	Tbg. Press. Flwg. SI	Csg. Press.	24 Hr. Rate →	Oil BBL	Gas MCF	Water BBL	Gas/Oil Ratio	Well Status	

## 28c. Production - Interval D

Date First Produced	Test Date	Hours Tested	Test Production →	Oil BBL	Gas MCF	Water BBL	Oil Gravity Corr. API	Gas Gravity	Production Method
Choke Size	Tbg. Press. Flwg. SI	Csg. Press.	24 Hr. Rate →	Oil BBL	Gas MCF	Water BBL	Gas/Oil Ratio	Well Status	

29. Disposition of Gas (Sold, used for fuel, vented, etc.)

## 30. Summary of Porous Zones (Include Aquifers):

Show all important zones of porosity and contents thereof: Cored intervals and all drill-stem tests, including depth interval tested, cushion used, time tool open, flowing and shut-in pressures and recoveries.

## 31. Formation (Log) Markers

Formation	Top	Bottom	Descriptions, Contents, etc.	Name	Top Meas. Depth
Glorieta	2135				
Tubb	3115				
Abo	3728				
Wolfcamp	4990				
Cisco Shale	6360				
Canyon	7095				
Strawn	7514				
T / Atoka	8027				
T / Lower Morrow	8734				

## 32. Additional remarks (include plugging procedure):

12-18-04 Set plugs @:

1st plug 8500' - 8347' 55 sx 15.2# H

2nd plug 7095' - 6942' 55 sx 15.2# H

3rd plug 5156' - 4988' 50 sx 14.8# C

4th plug 1475' - 1317' 50 sx 14.8# C

5th plug 70' - Surf 25 sx 14.8# C Plugs approved by Clark Bennett of Carlsbad BLM. Rig Released @ 11 AM 12/18/04. Well P&amp;A'd.

## 33. Indicate which items have been attached by placing a check in the appropriate boxes:

- ☒ Electrical/Mechanical Logs (1 full set req'd.) 
 ☐ Geologic Report 
 ☐ DST Report 
 ☐ Directional Survey  
☒ Sundry Notice for plugging and cement verification 
 ☐ Core Analysis 
 ☐ Other:

## 34. I hereby certify that the foregoing and attached information is complete and correct as determined from all available records (see attached instructions)\*

Name (please print) Phyllis A. EdwardsTitle Regulatory Analyst

Signature

Phyllis A. EdwardsDate 06/22/2005

Title 18 U.S.C Section 1001 and Title 43 U.S.C Section 1212, make it a crime for any person knowingly and willfully to make to any department or agency of the United States any false, fictitious or fraudulent statements or representations as to any matter within its jurisdiction.

OPERATOR: COG OPERATING  
WELL/LEASE: BOX CAR BILLY FED 29-1  
COUNTY: EDDY, NM

503-0255

STATE OF NEW MEXICO  
DEVIATION REPORT

285	1/4	7,562	1 3/4
512	1/2	7,787	1 1/4
764	1/2	8,036	1
976	3/4	8,228	1 1/2
1,199	3/4	8,417	1 1/2
1,380	1/2	8,675	3/4
1,680	1	8,900	2
1,997	3/4		
2,312	1		
2,626	1/2		
2,912	3/4		
3,227	1 1/4		
3,543	1/2		
3,864	1		
4,175	1/2		
4,463	3/4		
4,775	1/2		
5,062	1/2		
5,376	3/4		
5,723	1		
6,006	1		
6,322	1 1/4		
6,615	1		
6,868	1 1/2		
7,119	1 1/2		
7,380	1 3/4		

By: 

STATE OF TEXAS  
COUNTY OF MIDLAND

The foregoing instrument was acknowledged before me on December 21st, 2004, by  
Steve Moore on behalf of Patterson-UTI Drilling Company LP, LLLP.

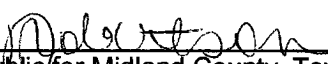
  
Notary Public for Midland County, Texas  
My Commission Expires: 8/23/2007

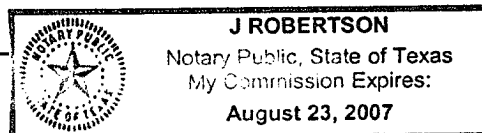

**DISTRICT I**

1625 N. French Dr., Hobbs, NM 88240

**DISTRICT II**

1301 W. Grand Avenue, Artesia, NM 88210

**DISTRICT III**

1000 Rio Brazos Rd., Aztec, NM 87410

**DISTRICT IV**

1220 S. St. Francis Dr., Santa Fe, NM 87505

State of New Mexico

Energy, Minerals, and Natural Resources Department

**OIL CONSERVATION DIVISION**

1220 South St. Francis Dr.

Santa Fe, New Mexico 87505

Form C-1

Revised August 15, 20

Submit to Appropriate District Office

State Lease - 4 copies

Fee Lease - 3 copies

☒ AMENDED REPORT**WELL LOCATION AND ACREAGE DEDICATION PLAT**

<sup>1</sup> API Number 30-015-33615	<sup>2</sup> Pool Code	<sup>3</sup> Pool Name MISSISSIPPIAN LILDCAT
<sup>4</sup> Property Code 300812	<sup>5</sup> Property Name BOX CAR BILLY FEDERAL "29"	
<sup>7</sup> OGRID No. 299137	<sup>8</sup> Operator Name COG Operating LLC	<sup>6</sup> Well Number 1
		<sup>9</sup> Elevation 4341'

**<sup>10</sup> Surface Location**

UL or lot no. M	Section 29	Township 20 SOUTH	Range 23 EAST, N.M.P.M.	Lot Idn	Feet from the 660'	North/South line SOUTH	Feet from the 1150'	East/West line WEST	County EDDY
--------------------	---------------	----------------------	----------------------------	---------	-----------------------	---------------------------	------------------------	------------------------	----------------

**<sup>11</sup> Bottom Hole Location If Different From Surface**

UL or lot no.	Section	Township	Range	Lot Idn	Feet from the	North/South line	Feet from the	East/West line	County
<sup>12</sup> Dedicated Acres 320		<sup>13</sup> Joint or Infill		<sup>14</sup> Consolidation Code		<sup>15</sup> Order No.			

NO ALLOWABLE WELL BE ASSIGNED TO THIS COMPLETION UNTIL ALL INTERESTS HAVE BEEN CONSOLIDATED OR A NON-STANDARD UNIT HAS BEEN APPROVED BY THE DIVISION

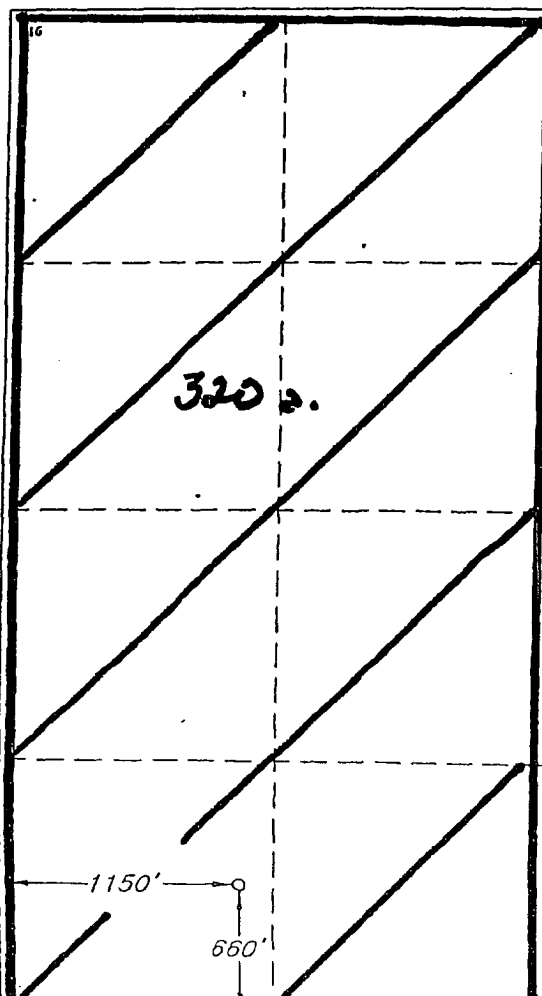

RECEIVED  
JUN 29 2005  
OCU-ARTESIA

**<sup>17</sup> OPERATOR CERTIFICATION**

I hereby certify that the information contained herein is true and complete to the best of my knowledge and belief.

Signature: *[Signature]*  
Printed Name: DANNY LEDFORD  
Title: JR. GEOLOGIST  
Date: 7-22-04

**<sup>18</sup> SURVEYOR CERTIFICATION**

I hereby certify that the well location shown on this plat was plotted from field notes of actual surveys made by me or under my supervision, and that the same is true and correct to the best of my belief.

JUNE 15, 2004

Date of Survey

Signature and Seal of Professional Surveyor

*[Signature]*  
V. LYNN BEZNER  
NO. 7920  
6-21-04  
Certificate Number  
V. L. BEZNER R.P.S. #7920