

RECEIVED

SEP 23 2005

NEW MEXICO OIL CONSERVATION COMMISSION
WELL LOCATION AND ACREAGE DEDICATION PLATForm C-102
Supersedes C-128
Effective 1-1-85

30-015-20348

All distances must be from the outer boundaries of the Section.

Operator MARBOB ENERGY CORPORATION			Lease PANAGRA COM		Well No. 1
Unit Letter B	Section 11	Township 23 SOUTH	Range 26 EAST	County EDDY	
Actual Footage Location of Wells: 990 feet from the NORTH line and 1980 feet from the EAST line					
Ground Level Elev. 3268.5	Producing Formation WOLFCAMP		Pool CARLSBAD, SOUTH (74200)	Dedicated Acreage 320 Acres	

1. Outline the acreage dedicated to the subject well by colored pencil or hatchure marks on the plat below.
2. If more than one lease is dedicated to the well, outline each and identify the ownership thereof (both as to working interest and royalty).
3. If more than one lease of different ownership is dedicated to the well, have the interests of all owners been consolidated by communitization, unitization, force-pooling, etc?

☒ Yes ☐ No If answer is "yes," type of consolidation Force Pooling R-4033

If answer is "no," list the owners and tract descriptions which have actually been consolidated. (Use reverse side of this form if necessary.)

No allowable will be assigned to the well until all interests have been consolidated (by communitization, unitization, forced-pooling, or otherwise) or until a non-standard unit, eliminating such interests, has been approved by the Commission.

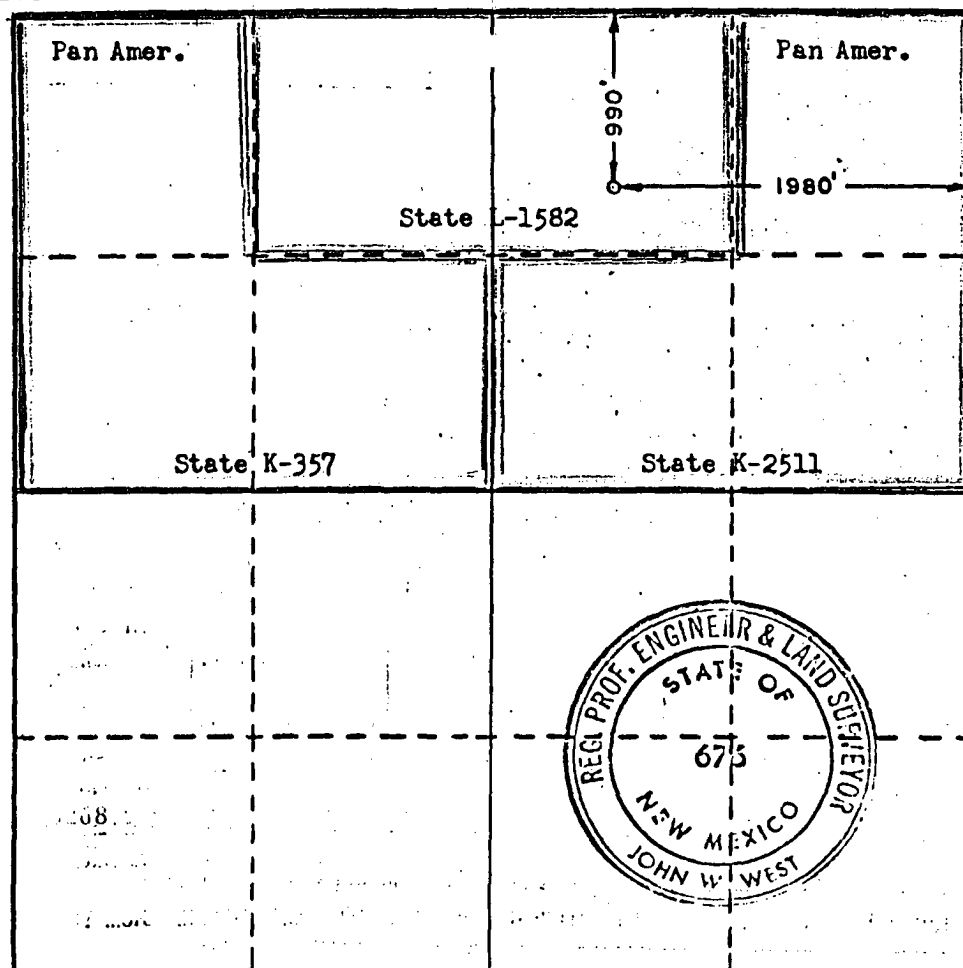

CERTIFICATION

I hereby certify that the information contained herein is true and complete to the best of my knowledge and belief.

Diana J. Briggs
DIANA J. BRIGGS

Position

PRODUCTION ANALYST

Company

MARBOB ENERGY CORPORATION

Date

SEPTEMBER 21, 2005

I hereby certify that the well location shown on this plat was plotted from field notes of actual surveys made by me or under my supervision, and that the same is true and correct to the best of my knowledge and belief.

Date Surveyed

NOVEMBER 7, 1970

Registered Professional Engineer and/or Land Surveyor

John W. West
Certificate No.

676