

District I
1625 N. French Dr., Hobbs, NM 88240
District II
811 S. First St., Artesia, NM 88210
District III
1000 Rio Brazos Road, Aztec, NM 87410
District IV
1220 S. St. Francis Dr., Santa Fe, NM 87505

State of New Mexico
Energy Minerals and Natural Resources

Form C-141
Revised August 8, 2011

Oil Conservation Division
1220 South St. Francis Dr.
Santa Fe, NM 87505

Submit 1 Copy to appropriate District Office in
accordance with 19.15.29 NMAC.

Release Notification and Corrective Action

JMW1402853427 OPERATOR ☒ Initial Report ☐ Final Report

Name of Company: BOPCO, L.P. 260737	Contact: Tony Savoie
Address: 522 W. Mermod, Suite 704 Carlsbad, N.M. 88220	Telephone No. 575-887-7329
Facility Name: PLU-188Y The injection line spill is 630 ft. West of the well.	Facility Type: Exploration and Production

Surface Owner: U.S.A.	Mineral Owner: U.S.A.	API No. 30-015-33776
-----------------------	-----------------------	----------------------

(State or Fed?) LOCATION OF RELEASE

Unit Letter C	Section 5	Township 24S	Range 30E	Feet from the 725	North/South Line North	Feet from the 1270	East/West Line West	County: Eddy
------------------	--------------	-----------------	--------------	----------------------	---------------------------	-----------------------	------------------------	-----------------

Latitude N 32.25196 Longitude W 103.90815

NATURE OF RELEASE

Type of Release: Produced water	Volume of Release: 250 bbls.	Volume Recovered: 30 bbls.
Source of Release: 3" fiberglass high pressure flow line	Date and Hour of Occurrence: 1/10/14 Time Unknown	Date and Hour of Discovery: 1/10/14 at 12:30 p.m.
Was Immediate Notice Given? <input checked="" type="checkbox"/> Yes <input type="checkbox"/> No <input type="checkbox"/> Not Required	If YES, To Whom? NMOCD emergency #104 and the BLM	
By Whom? Tony Savoie	Date and Hour: 1/10/14 at 3:41 p.m.	
Was a Watercourse Reached? <input type="checkbox"/> Yes <input checked="" type="checkbox"/> No	If YES, Volume Impacting the Watercourse.	

If a Watercourse was Impacted, Describe Fully.*

RECEIVED
JAN 15 2014
NMOCD ARTESIA

Describe Cause of Problem and Remedial Action Taken.*
The fiberglass injection line ruptured, cause unknown. The line segment was isolated until the section of line can be replaced

Describe Area Affected and Cleanup Action Taken.*
Approximately 23,224 sq. ft. of pasture and approximately 7,888 sq.ft. of well pad and road were impacted by the release. All of the free standing fluid was recovered with a vacuum truck. The area was surveyed with a GIS and the data was given to the BLM, permission to start removing contamination was received at 2:00 p.m. on 1/14/14. Crews will start removing the impacted soil when the one-call clears.
The remediation will comply with the NMOCD and BLM remediation guidelines.

I hereby certify that the information given above is true and complete to the best of my knowledge and understand that pursuant to NMOCD rules and regulations all operators are required to report and/or file certain release notifications and perform corrective actions for releases which may endanger public health or the environment. The acceptance of a C-141 report by the NMOCD marked as "Final Report" does not relieve the operator of liability should their operations have failed to adequately investigate and remediate contamination that pose a threat to ground water, surface water, human health or the environment. In addition, NMOCD acceptance of a C-141 report does not relieve the operator of responsibility for compliance with any other federal, state, or local laws and/or regulations.

Signature: Tony Savoie		OIL CONSERVATION DIVISION	
Printed Name: Tony Savoie		Approved by Environmental Specialist Signed By Mike Brannon	
Title: Waste Management and Remediation Specialist		Approval Date: JAN 28 2014	Expiration Date:
E-mail Address: tasavoie@basspet.com		Conditions of Approval:	Attached <input type="checkbox"/>
Date: 1/14/14	Phone: 432-556-8730	Remediation per OCD Rule & Guidelines, & like approval by BLM. SUBMIT REMEDIATION PROPOSAL NO LATER THAN: February 28, 2014	

* Attach Additional Sheets If Necessary

2RP-2162

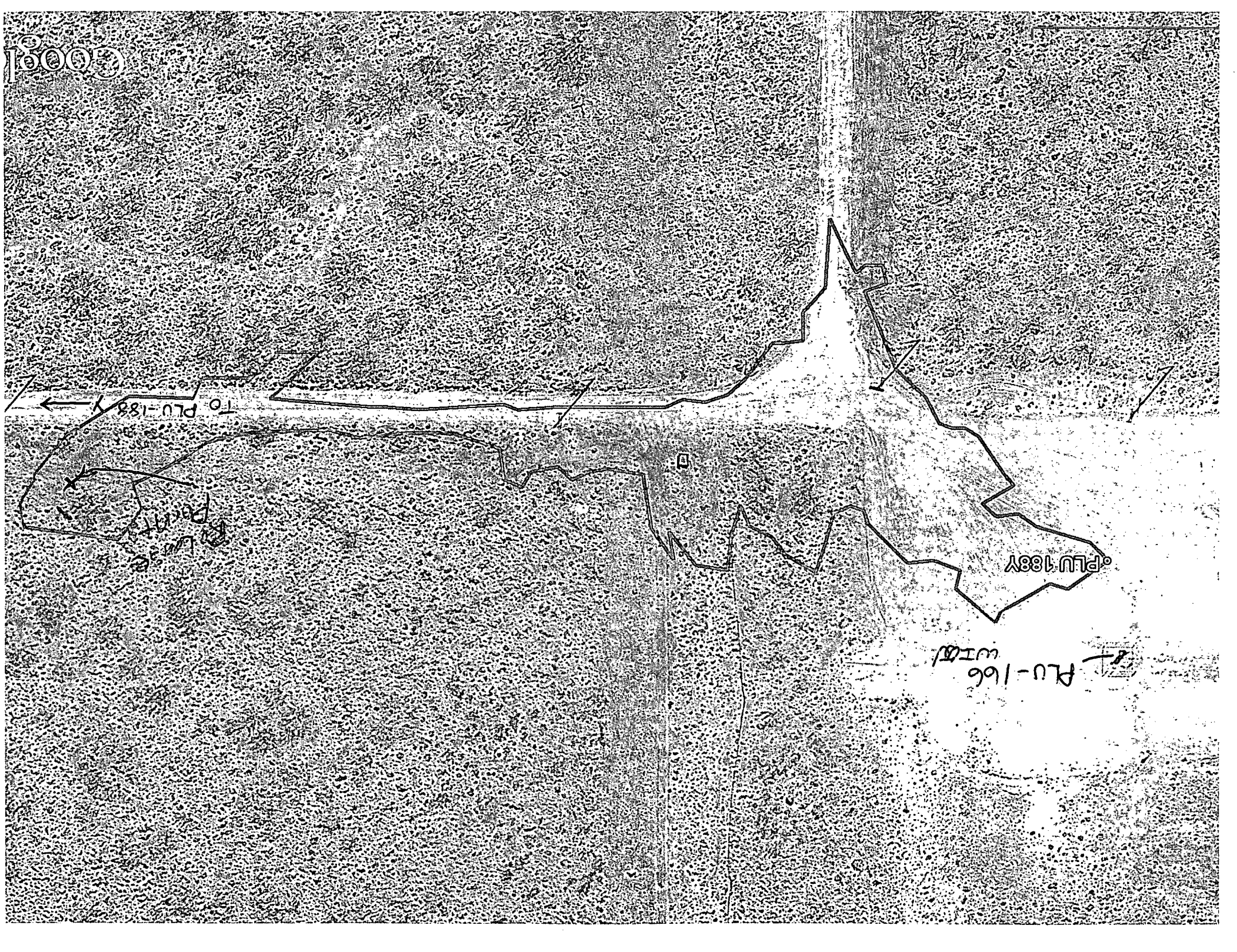

0001

To PLU-188

PLU 188Y

PLU-166

PLU 188Y

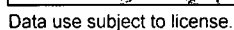

www.delorme.com

Scale 1 : 12,800

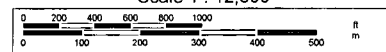

1" = 1,066.7 ft Data Zoom 14-0