

NM OIL CONSERVATION

ARTESIA DISTRICT

NOV 04 2014

Form C-102

Revised August 1, 2011

DISTRICT I

1625 N. French Dr., Hobbs, NM 88240
Phone (505) 503-0151 Fax: (505) 503-0720

DISTRICT II

811 S. First St., Artesia, NM 88210
Phone (505) 745-1255 Fax: (505) 745-0750

DISTRICT III

1000 Rio Bravos Rd., Anteo, NM 87410
Phone (505) 336-0170 Fax: (505) 336-0170

DISTRICT IV

1820 S. St. Francis Dr., Santa Fe, NM 87505
Phone (505) 476-3400 Fax: (505) 476-3400

State of New Mexico
Energy, Minerals and Natural Resources Department

OIL CONSERVATION DIVISION

1220 South St. Francis Dr.
Santa Fe, New Mexico 87505

Submit one copy to appropriate
District Office

WELL LOCATION AND ACREAGE DEDICATION PLAT

☐ AMENDED REPORT

API Number 30-015-42475	Pool Code 98017	Pool Name WC-0155262728A; Wolfcamp
Property Code 313419	Property Name OWL DRAW 22 W1AP Fed Com	Well Number 1H
GRID No. 14744	Operator Name MEWBOURNE OIL COMPANY	Elevation 3149'

Surface Location

UL or lot No.	Section	Township	Range	Lot Idn	Feet from the	North/South line	Feet from the	East/West line	County
P	15	26 S	27 E		230	SOUTH	660	EAST	EDDY

Bottom Hole Location If Different From Surface

UL or lot No.	Section	Township	Range	Lot Idn	Feet from the	North/South line	Feet from the	East/West line	County
P	22	26S	27E		333	SOUTH	650'	EAST	EDDY

Dedicated Acres	Joint or Infill	Consolidation Code	Order No.
320			

NO ALLOWABLE WILL BE ASSIGNED TO THIS COMPLETION UNTIL ALL INTERESTS HAVE BEEN CONSOLIDATED
OR A NON-STANDARD UNIT HAS BEEN APPROVED BY THE DIVISION

SURFACE LOCATION
Lat - N 32°02'07.19"
Long - W 104°10'15.84"
NMSPC- N 376617.82
E 550281.70
(NAD-27)

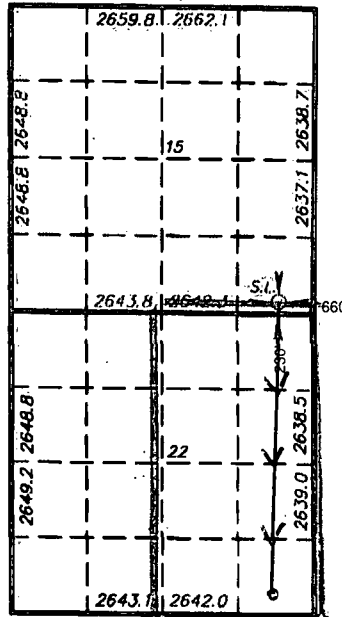

OPERATOR CERTIFICATION

I hereby certify that the information contained herein is true and complete to the best of my knowledge and belief, and that this organization either owns a working interest or undivided mineral interest in the land including the proposed bottom hole location or has a right to drill this well at this location pursuant to a contract with an owner of such a mineral or working interest or to a voluntary pooling agreement or a compulsory pooling order heretofore entered by the division.

Jackie Lathan 10/30/14
Signature Date

Jackie Lathan
Printed Name

Email Address

SURVEYOR CERTIFICATION

I hereby certify that the well location shown on this plat was plotted from field notes of actual surveys made by me or under my supervision, and that the same is true and correct to the best of my belief.

GARY L. JONES
Date Surveyed
Signature & Seal of Professional Surveyor

GARY L. JONES
W.S. No. 27993

Certificate No. Gary L. Jones 7977

BASIN SURVEYS 27993

1" = 3000'