

UNITED STATES
DEPARTMENT OF THE INTERIOR
BUREAU OF LAND MANAGEMENT

FORM APPROVED
OMB No. 1004-0137
Expires: November 30, 2000

WELL COMPLETION OR RECOMPLETION REPORT AND LOG

5. Lease Serial No.
NM89052

1a. Type of Well ☒ Oil Well ☐ Gas Well ☐ Dry ☐ Other
b. Type of Completion ☐ New Well ☐ Work Over ☐ Deepen ☐ Plug Back ☒ Diff. Resvr.
Other _____

6. If Indian, Allottee or Tribe Name

7. Unit or CA Agreement Name and No.

2. Name of Operator
DEVON ENERGY PRODUCTION CO. LP
Contact: KAREN COTTOM
E-Mail: karen.cottom@dvn.com

8. Lease Name and Well No.
APACHE 25 FEDERAL 2

3. Address 20 NORTH BROADWAY
OKLAHOMA CITY, OK 73102-8260

3a. Phone No. (include area code)
Ph: 405.228.7512

9. API Well No.
30-015-27478

4. Location of Well (Report location clearly and in accordance with Federal requirements)*

At surface SESE 660FSL 1310FEL

At top prod interval reported below SESE 660FSL 1310FEL

At total depth SESE 660FSL 1310FEL

10. Field and Pool, or Exploratory
LOS MEDANOS BONE SPRING

11. Sec., T., R., M., or Block and Survey
or Area Sec 25 T22S R30E Mer NMP

12. County or Parish
EDDY

13. State
NM

14. Date Spudded
08/16/1993

15. Date T.D. Reached
09/23/1993

16. Date Completed
☐ D & A ☒ Ready to Prod.
03/16/2003

17. Elevations (DF, KB, RT, GL)*
3336 GL

18. Total Depth: MD
TVD 14575

19. Plug Back T.D.: MD
TVD 12000

20. Depth Bridge Plug Set: MD
TVD 11666

21. Type Electric & Other Mechanical Logs Run (Submit copy of each)
LOGS RAN ON ORIGINAL COMPLETION

22. Was well cored? ☒ No ☐ Yes (Submit analysis)
Was DST run? ☒ No ☐ Yes (Submit analysis)
Directional Survey? ☒ No ☐ Yes (Submit analysis)

23. Casing and Liner Record (Report all strings set in well)

Hole Size	Size/Grade	Wt. (#/ft.)	Top (MD)	Bottom (MD)	Stage Cementer Depth	No. of Sk. & Type of Cement	Slurry Vol. (BBL)	Cement Top*	Amount Pulled
17.500	13.375 K55	54.5	0	550		550		0	
12.250	9.625 K55	40.0	0	3864		1580		0	
8.750	7.000 N80 S95	26.0	0	12410	7783	1875		3400	
6.000	4.500 P110	13.5	12006	14565		300		12006	

24. Tubing Record

Size	Depth Set (MD)	Packer Depth (MD)	Size	Depth Set (MD)	Packer Depth (MD)	Size	Depth Set (MD)	Packer Depth (MD)
2.875	10950							

25. Producing Intervals

26. Perforation Record

Formation	Top	Bottom	Perforated Interval	Size	No. Holes	Perf. Status
A) BONE SPRING	10884	10944	14113 TO 14132	0.400	68	BELOW RBP @14105 W/35' CM
B)			11824 TO 12154		60	BELOW CIBP @11536
C)			10884 TO 10944		32	PRODUCING
D)						

27. Acid, Fracture, Treatment, Cement Squeeze, Etc.

Depth Interval	Amount and Type of Material
10884 TO 10944	2000 GAL 7.5% NEFE, FRAC'D W/104,000# RC 16/30 SD

28. Production - Interval A

Date First Produced	Test Date	Hours Tested	Test Production	Oil BBL	Gas MCF	Water BBL	Oil Gravity Corr. API	Gas Gravity	Production Method
03/16/2003	03/18/2003	24	→	138.0	249.0	61.0	45.8	0.77	ELECTRIC PUMPING UNIT
Choke Size	Tbg. Press. Flwg. SI	Csg. Press.	24 Hr. Rate	Oil BBL	Gas MCF	Water BBL	Gas:Oil Ratio	Well Status	
	225	125.0	→	138	249	61	1804	POW	

28a. Production - Interval B

Date First Produced	Test Date	Hours Tested	Test Production	Oil BBL	Gas MCF	Water BBL	Oil Gravity Corr. API	Gas Gravity	Production Method
			→						
Choke Size	Tbg. Press. Flwg. SI	Csg. Press.	24 Hr. Rate	Oil BBL	Gas MCF	Water BBL	Gas:Oil Ratio	Well Status	
			→						

(See Instructions and spaces for additional data on reverse side)

ELECTRONIC SUBMISSION #19519 VERIFIED BY THE BLM WELL INFORMATION SYSTEM

**** ORIGINAL ** ORIGINAL ** ORIGINAL ** ORIGINAL ** ORIGINAL ** ORIGINAL ** ORIGINAL ****

28b. Production - Interval C

Date First Produced	Test Date	Hours Tested	Test Production →	Oil BBL	Gas MCF	Water BBL	Oil Gravity Corr. API	Gas Gravity	Production Method
Choke Size	Tbg. Press. Flwg. SI	Csg. Press.	24 Hr. Rate →	Oil BBL	Gas MCF	Water BBL	Gas:Oil Ratio	Well Status	

28c. Production - Interval D

Date First Produced	Test Date	Hours Tested	Test Production →	Oil BBL	Gas MCF	Water BBL	Oil Gravity Corr. API	Gas Gravity	Production Method
Choke Size	Tbg. Press. Flwg. SI	Csg. Press.	24 Hr. Rate →	Oil BBL	Gas MCF	Water BBL	Gas:Oil Ratio	Well Status	

29. Disposition of Gas(*Sold, used for fuel, vented, etc.*)
SOLD

30. Summary of Porous Zones (Include Aquifers):

Show all important zones of porosity and contents thereof: Cored intervals and all drill-stem tests, including depth interval tested, cushion used, time tool open, flowing and shut-in pressures and recoveries.

31. Formation (Log) Markers

Formation	Top	Bottom	Descriptions, Contents, etc.	Name	Top Meas. Depth
DELAWARE	7246	7696		T/DELAWARE	3914
1ST BONE SPRING	8769	9208		T/BONE SPRING	7725
3RD BS CARBONATE	9860	10552		T WOLFCAMP	11240
3RD BS SAND	10552	11240		T/STRAWN	12590
ATOKA AC SAND	12975	12990		T/ATOKA	12872
ATOKA BANK	13056	13086		T/MORROW	13116
MORROW	13892	14358			

32. Additional remarks (include plugging procedure):

3/1/03 - set RBP @ 11,650' Pkr @ 10,790', PERF 10,926'-44', acidized w/2000 gal 7.5% NEFE
 3/3/03 - TIH w/gun perf'd well from 10884'-10944' 2SPF total 32 holes
 3/3/03 - Set second RBP @ 11,536' tested to 3000 psi
 3/5/03 - Frac'd well w/104,000# 16/30 sd,
 3/8/03 - Well flowing to frac tanks.

33. Circle enclosed attachments:

- | | | | |
|---|--------------------|---------------|-----------------------|
| 1. Electrical/Mechanical Logs (1 full set req'd.) | 2. Geologic Report | 3. DST Report | 4. Directional Survey |
| 5. Sundry Notice for plugging and cement verification | 6. Core Analysis | 7 Other: | |

34. I hereby certify that the foregoing and attached information is complete and correct as determined from all available records (see attached instructions):

**Electronic Submission #19519 Verified by the BLM Well Information System.
 For DEVON ENERGY PRODUCTION CO. LP, sent to the Carlsbad**

Name (please print) KAREN COTTOMTitle ENGINEERING TECHNICIANSignature (Electronic Submission)Date 03/27/2003

Title 18 U.S.C. Section 1001 and Title 43 U.S.C. Section 1212, make it a crime for any person knowingly and willfully to make to any department or agency of the United States any false, fictitious or fraudulent statements or representations as to any matter within its jurisdiction.

**** ORIGINAL ** ORIGINAL ** ORIGINAL ** ORIGINAL ** ORIGINAL ** ORIGINAL ** ORIGINAL ****

Submit to Appropriate
District Office
State Lease - 4 copies
Fee Lease - 3 copies

State of New Mexico
Energy, Minerals and Natural Resources Department

Form C-102
Revised 1-1-89

OIL CONSERVATION DIVISION

P.O. Box 2088
Santa Fe, New Mexico 87504-2088

RECEIVED

FEB 4 11 58 AM '93

DISTRICT I
P.O. Box 1980, Hobbs, NM 88240

DISTRICT II
P.O. Drawer DD, Artesia, NM 88210

DISTRICT III
1000 Rio Brazos Rd., Aztec, NM 87410

WELL LOCATION AND ACREAGE DEDICATION PLAT

All Distances must be from the outer boundaries of the section

Operator Devon Energy Production Company, LP			Lease Apache "25" Fed		Well No. 2
Unit Letter P	Section 25	Township 22S	Range 30E	County NMPM	Eddy
Actual Footage Location of Well: 1310 feet from the East line and 660 feet from the South line					
Ground level Elev. 3336	Producing Formation Bone Spring		Pool Los Medanos	Dedicated Acreage: 40 Acres	

1. Outline the acreage dedicated to the subject well by colored pencil or hatchure marks on the plat below.
2. If more than one lease is dedicated to the well, outline each and identify the ownership thereof (both as to working interest and royalty).
3. If more than one lease of different ownership is dedicated to the well, have the interest of all owners been consolidated by communitization, unitization, force-pooling, etc.?
☐ Yes ☐ No If answer is "yes" type of consolidation _____
If answer is "no" list the owners and tract descriptions which have actually been consolidated. (Use reverse side of this form if necessary.) _____
No allowable will be assigned to the well until all interests have been consolidated (by communitization, unitization, forced-pooling, or otherwise) or until a non-standard unit, eliminating such interest, has been approved by the Division.

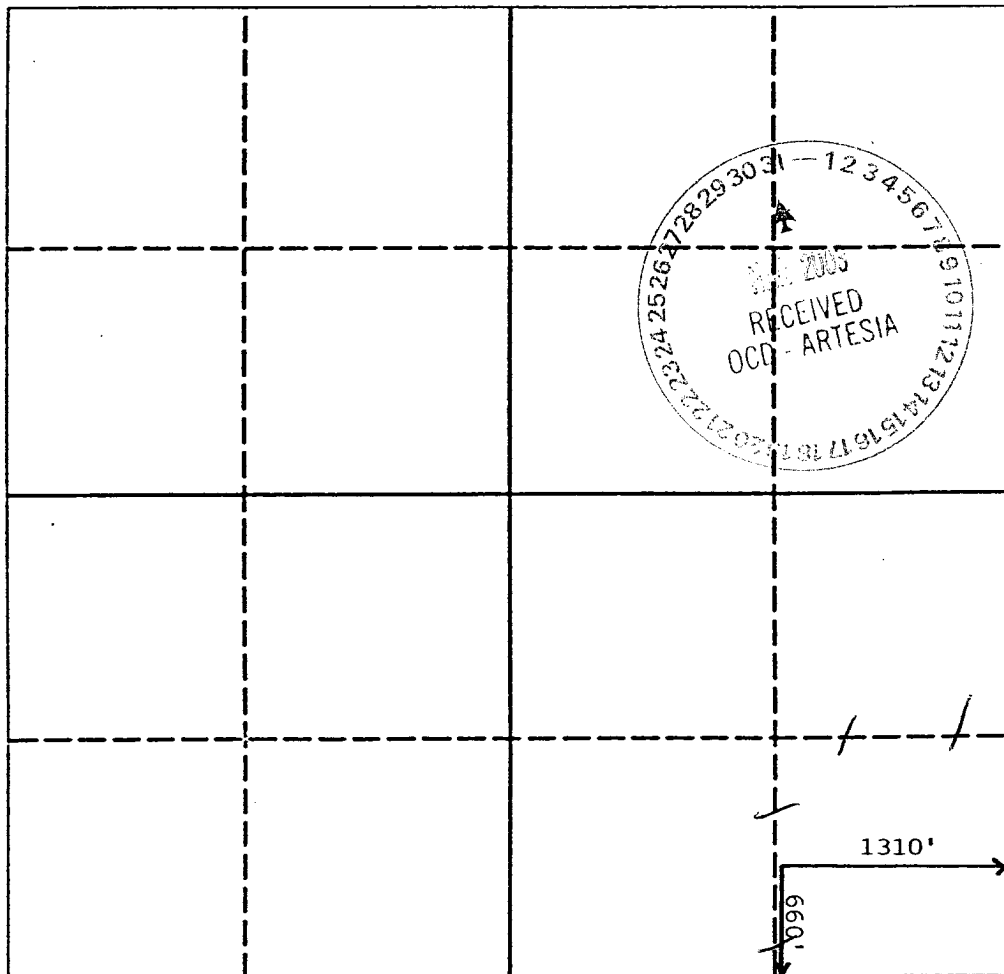

OPERATOR CERTIFICATION

I hereby certify that the information contained herein is true and complete to the best of my knowledge and belief.

Signature
James Blount
Printed Name
James Blount
Position
Operations Engineer Advisor
Company
Devon Energy Production Co. LP
Date
March 26, 2003

SURVEYOR CERTIFICATION

I hereby certify that the well location shown on this plat was plotted from field notes of actual surveys made by me or under my supervision, and that the same is true and correct to the best of my knowledge and belief.

Date Surveyed
Signature & Seal of
Professional Surveyor

Certificate No.