

District I
1625 N. French Dr., Hobbs, NM 88240
District II
811 South First, Artesia, NM 88210
District III
1000 Rio Brazos Road, Aztec, NM 87410
District IV
2040 South Pacheco, Santa Fe, NM 87505

State of New Mexico
Energy, Minerals and Natural Resources

Form C-101
Revised March 17, 1999

Submit to appropriate District Office
State Lease - 6 Copies
Fee Lease - 5 Copies

☐ AMENDED REPORT

APPLICATION FOR PERMIT TO DRILL, RE-ENTER, DEEPEN, PLUGBACK, OR ADD A ZONE

¹ Operator Name and Address Devon Energy Production Company, L.P. 20 N. Broadway, Suite 1500 Oklahoma City, OK 73102-8260		² OGRID Number 6137
⁴ Property Code 32278	⁵ Property Name Chase 2 State Com.	³ API Number 30-015- 32803
		⁶ Well No. 3

⁷ Surface Location

UL or lot no.	Section	Township	Range	Lot Idn	Feet from the	North/South line	Feet from the	East/West line	County
M	2	22S	27E		1310'	south	1310'	west	Eddy

⁸ Proposed Bottom Hole Location If Different From Surface

UL or lot no.	Section	Township	Range	Lot Idn	Feet from the	North/South line	Feet from the	East/West line	County

⁹ Proposed Pool 1 Carlsbad; Morrow, East (Gas) 73920	¹⁰ Proposed Pool 2
--------------------------------------------------------------------	-------------------------------

¹¹ Work Type Code N	¹² Well Type Code G	¹³ Cable/Rotary R	¹⁴ Lease Type Code S	¹⁵ Ground Level Elevation GL 3108'
¹⁶ Multiple N/A	¹⁷ Proposed Depth 12,250'	¹⁸ Formation Morrow	¹⁹ Contractor Unknown	²⁰ Spud Date 09/01/2003

²¹ Proposed Casing and Cement Program

Hole Size	Casing Size	Casing weight/foot	Setting Depth	Sacks of Cement	Estimated TOC
17 1/2"	13 3/8"	48# H-40	450'	400 sx	surface
12 1/4"	9 5/8"	40# N-80 & J-55	2,620'	1050 sx	surface
7 7/8"	5.5"	17# HCP-110	12,250'	1850 sx	4000'

²² Describe the proposed program. If this application is to DEEPEN or PLUG BACK, give the data on the present productive zone and proposed new productive zone.
Describe the blowout prevention program, if any. Use additional sheets if necessary.

Devon plans to drill the Chase 2 State Com. #3 to a total depth of 12,250 feet and complete it as a Morrow development well. If it is deemed non-commercial then it will be plugged and abandoned in accordance with the rules and regulations established by the New Mexico OCD. Blowout prevention equipment will be installed while drilling the intermediate and production holes. Attached are C102 plat, maps, and BOP equipment schematics.

²³ I hereby certify that the information given above is true and complete to the best of my knowledge and belief.

Signature: *Gerald T. Pepper*

Printed Name: Gerald T. (Tom) Pepper X4513

Title: Operations Engineering Advisor

Date: 05/15/2003

Phone: (405)235-3611

OIL CONSERVATION DIVISION

Approved by: *John W. Brown*

Title: *District Supervisor*

Approval Date: MAY 21 2003

Expiration Date: MAY 21 2004

Conditions of Approval:

Attached ☐

DISTRICT I

P.O. Box 1980, Hobbs, NM 88241-1980

DISTRICT II

P.O. Drawer DD, Artesia, NM 88211-0719

DISTRICT III

1000 Rio Brazos Rd., Aztec, NM 87410

DISTRICT IV

P.O. BOX 2088, SANTA FE, N.M. 87504-2088

State of New Mexico

Energy, Minerals and Natural Resources Department

OIL CONSERVATION DIVISION

P.O. Box 2088

Santa Fe, New Mexico 87504-2088

Form C-102

Revised February 10, 1994

Submit to Appropriate District Office

State Lease - 4 Copies

Fee Lease - 3 Copies

WELL LOCATION AND ACREAGE DEDICATION PLAT

☐ AMENDED REPORT

API Number 30-015-	Pool Code 73920	Pool Name Carlsbad; Morrow, East (Gas)
Property Code 32278	Property Name CHASE 2 STATE Com.	Well Number 3
OGRID No. 6137	Operator Name DEVON ENERGY PRODUCTION COMPANY, L.P.	Elevation 3108'

Surface Location

UL or lot No.	Section	Township	Range	Lot Idn	Feet from the	North/South line	Feet from the	East/West line	County
M	2	22-S	27-E		1310'	SOUTH	1310'	WEST	EDDY

Bottom Hole Location If Different From Surface

UL or lot No.	Section	Township	Range	Lot Idn	Feet from the	North/South line	Feet from the	East/West line	County
Dedicated Acres 3.20	Joint or Infill	Consolidation Code	Order No.						

NO ALLOWABLE WILL BE ASSIGNED TO THIS COMPLETION UNTIL ALL INTERESTS HAVE BEEN CONSOLIDATED
OR A NON-STANDARD UNIT HAS BEEN APPROVED BY THE DIVISION

LOT 4	LOT 3	LOT 2	LOT 1
40.03 AC	40.09 AC	40.15 AC	40.21 AC

OPERATOR CERTIFICATION

I hereby certify that the information contained herein is true and complete to the best of my knowledge and belief.

Signature
Gerald T. (Tom) Pepper

Printed Name
Operations Engr. Advisor

Title
May 14, 2003

Date

SURVEYOR CERTIFICATION

I hereby certify that the well location shown on this plat was plotted from field notes of actual surveys made by me or under my supervision, and that the same is true and correct to the best of my belief.

May 05, 2003

Date Surveyed
Signature & Seal of Professional Surveyor

Certificate No. RONALD J. EDSON 3239
GARY EDSON 12641

VICINITY MAP

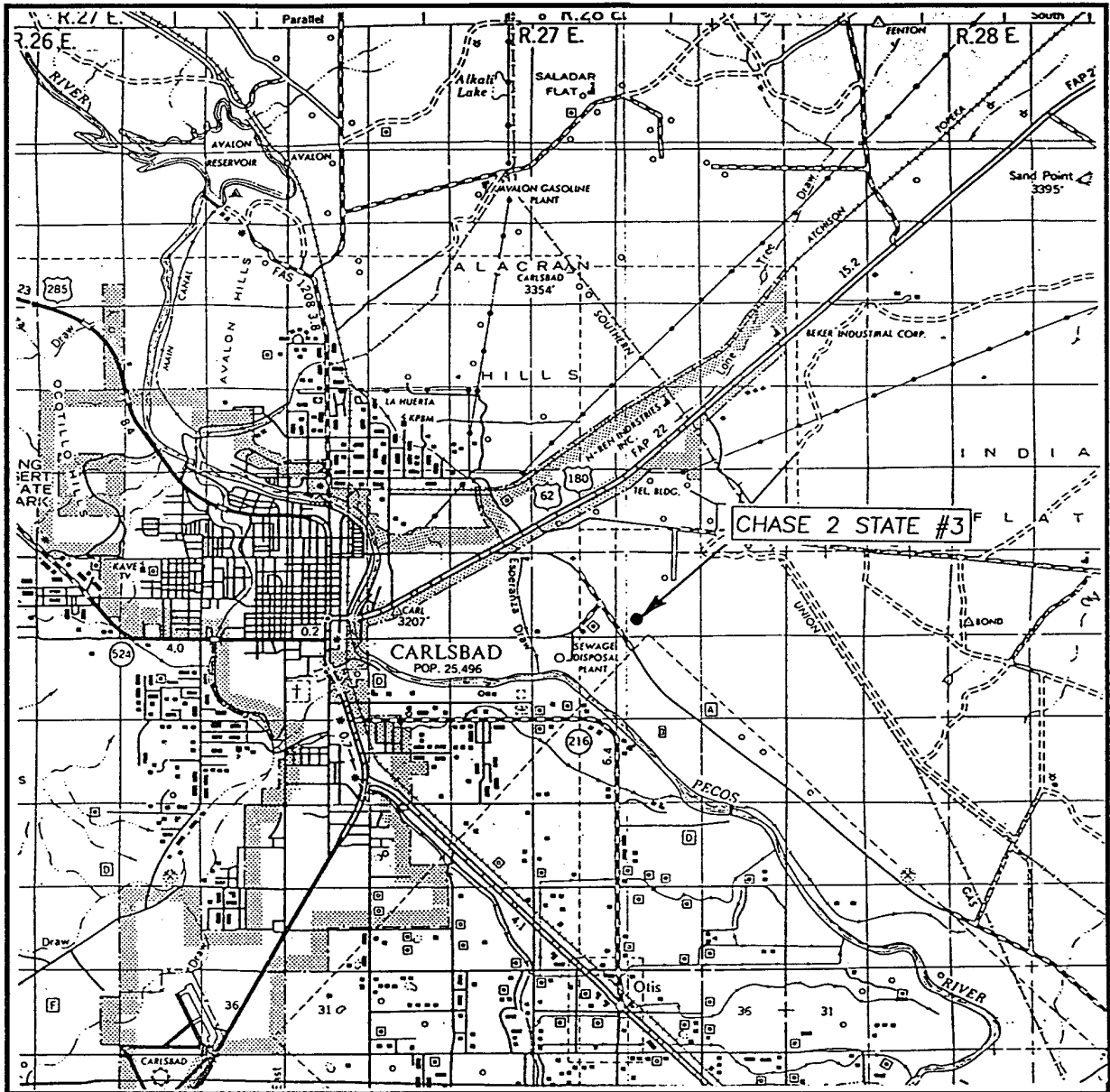

SCALE: 1" = 2 MILES

SEC. 2 TWP. 22-S RGE. 27-E

SURVEY N.M.P.M.

COUNTY EDDY

DESCRIPTION 1310' FSL & 1310' FWL

ELEVATION 3108'

OPERATOR DEVON ENERGY PROD. CO. L.P.

LEASE CHASE 2 STATE #3

JOHN WEST SURVEYING
HOBBS, NEW MEXICO
(505) 393-3117

LOCATION VERIFICATION MAP

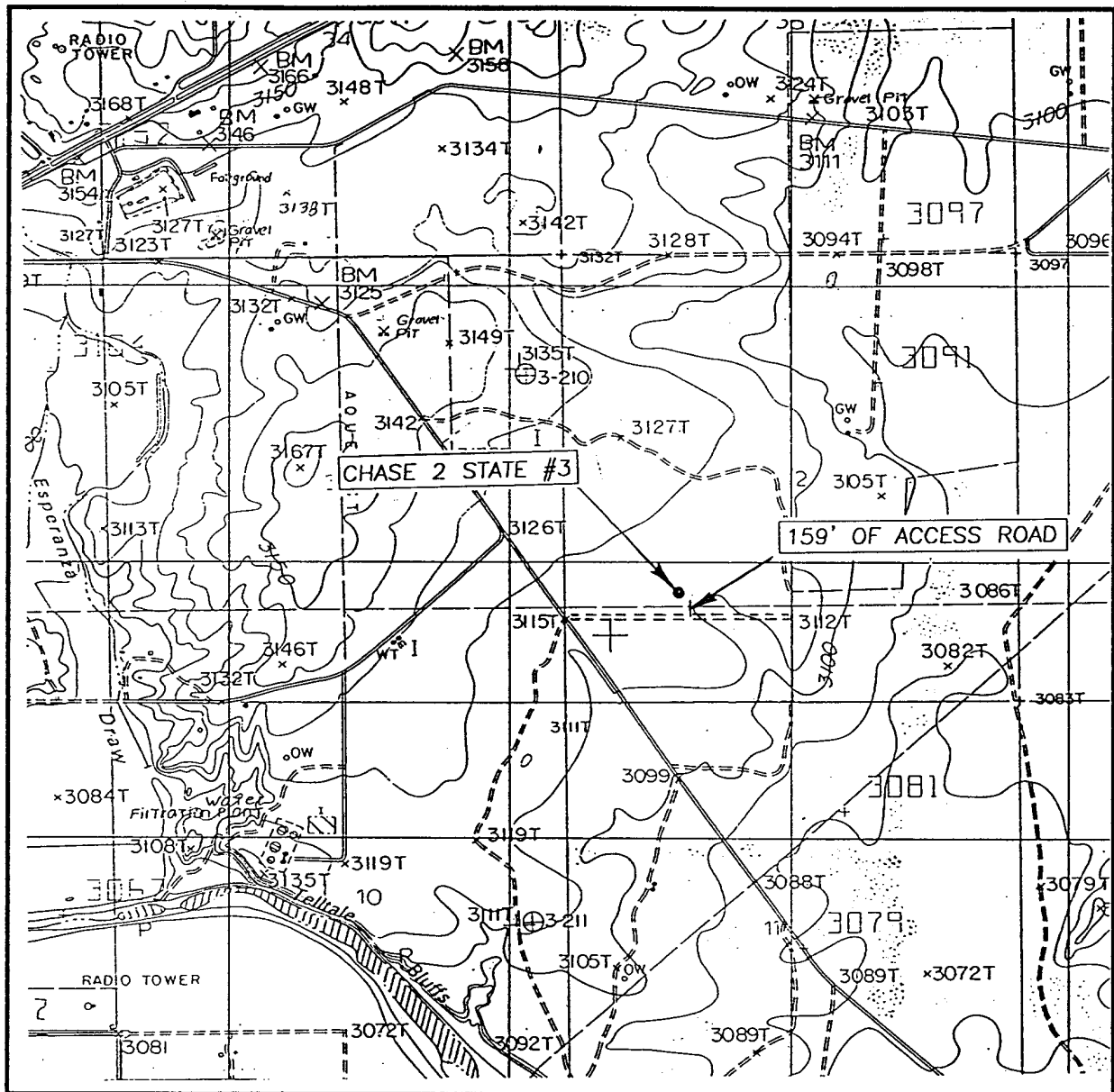

SCALE: 1" = 2000'

CONTOUR INTERVAL: 10'
CARLSBAD EAST, N.M.

SEC. 2 TWP. 22-S RGE. 27-E

SURVEY N.M.P.M.

COUNTY EDDY

DESCRIPTION 1310' FSL & 1310' FWL

ELEVATION 3108'

OPERATOR DEVON ENERGY PROD, CO. L.P.

LEASE CHASE 2 STATE #3

U.S.G.S. TOPOGRAPHIC MAP
CARLSBAD EAST, N.M.

JOHN WEST SURVEYING
HOBBS, NEW MEXICO
(505) 393-3117

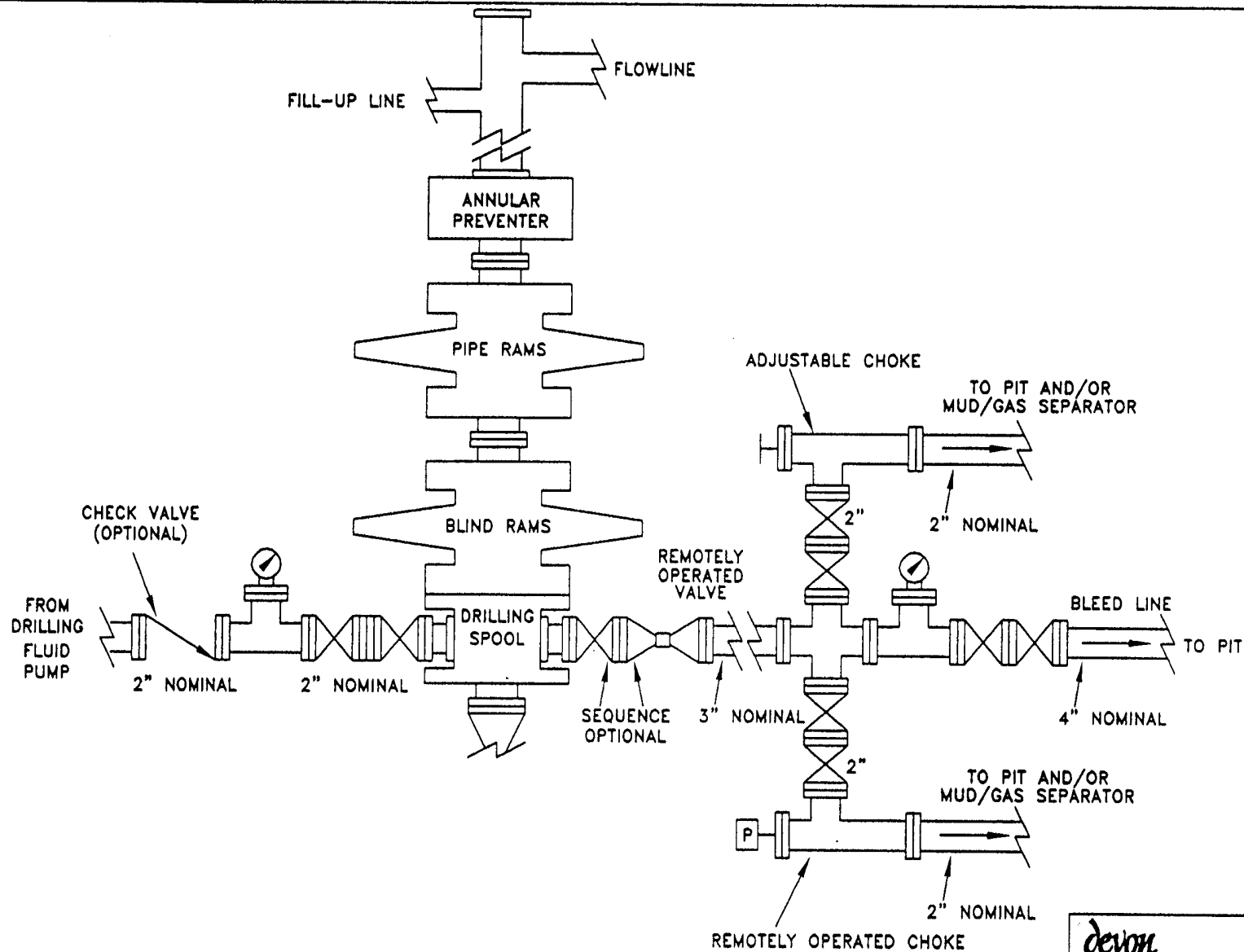

devon
ENERGY CORPORATION

AREA NAME

COUNTY, STATE

SCHEMATIC

PROPOSED 5-M BOPE
AND CHOKE ARRANGEMENT

s:\nm\plats
5mbope.dwg

SC

10/00

MINIMUM CHOKE MANIFOLD
3,000, 5,000 and 10,000 PSI Working Pressure

3 MWP - 5 MWP - 10 MWP

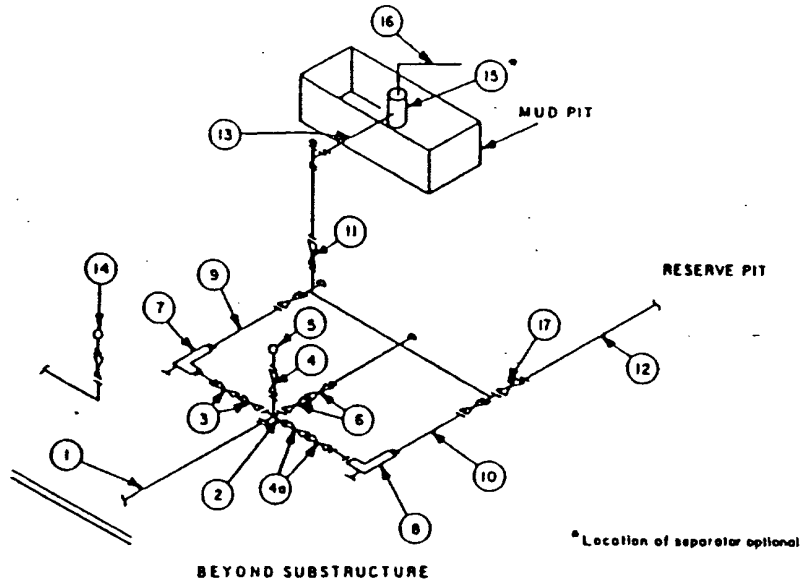

MINIMUM REQUIREMENTS										
No		3,000 MWP			5,000 MWP			10,000 MWP		
		I.D.	NOMINAL	RATING	I.D.	NOMINAL	RATING	I.D.	NOMINAL	RATING
1	Line from drilling spool		3"	3,000		3"	5,000		3"	10,000
2	Cross 3"x3"x3"x2"			3,000			5,000			
	Cross 3"x3"x3"x3"									10,000
3	Valves(1) Gate <input type="checkbox"/> Plug <input <="" td="" type="checkbox/>(2)</td><td>3-1/8"/> <td></td> <td>3,000</td> <td>3-1/8"</td> <td></td> <td>5,000</td> <td>3-1/8"</td> <td></td> <td>10,000</td>		3,000	3-1/8"		5,000	3-1/8"		10,000	
4	Valve Gate <input type="checkbox"/> Plug <input <="" td="" type="checkbox/>(2)</td><td>1-13/16"/> <td></td> <td>3,000</td> <td>1-13/16"</td> <td></td> <td>5,000</td> <td>1-13/16"</td> <td></td> <td>10,000</td>		3,000	1-13/16"		5,000	1-13/16"		10,000	
4a	Valves(1)	2-1/16"		3,000	2-1/16"		5,000	3-1/8"		10,000
5	Pressure Gauge			3,000			5,000			10,000
6	Valves Gate <input type="checkbox"/> Plug <input <="" td="" type="checkbox/>(2)</td><td>3-1/8"/> <td></td> <td>3,000</td> <td>3-1/8"</td> <td></td> <td>5,000</td> <td>3-1/8"</td> <td></td> <td>10,000</td>		3,000	3-1/8"		5,000	3-1/8"		10,000	
7	Adjustable Choke(3)	2"		3,000	2"		5,000	2"		10,000
8	Adjustable Choke	1"		3,000	1"		5,000	2"		10,000
9	Line		3"	3,000		3"	5,000		3"	10,000
10	Line		2"	3,000		2"	5,000		3"	10,000
11	Valves Gate <input type="checkbox"/> Plug <input <="" td="" type="checkbox/>(2)</td><td>3-1/8"/> <td></td> <td>3,000</td> <td>3-1/8"</td> <td></td> <td>5,000</td> <td>3-1/8"</td> <td></td> <td>10,000</td>		3,000	3-1/8"		5,000	3-1/8"		10,000	
12	Lines		3"	1,000		3"	1,000		3"	2,000
13	Lines		3"	1,000		3"	1,000		3"	2,000
14	Remote reading compound standpipe pressure gauge			3,000			5,000			10,000
15	Gas Separator		2'x5'			2'x5'			2'x5'	
16	Line		4"	1,000		4"	1,000		4"	2,000
17	Valves Gate <input type="checkbox"/> Plug <input <="" td="" type="checkbox/>(2)</td><td>3-1/8"/> <td></td> <td>3,000</td> <td>3-1/8"</td> <td></td> <td>5,000</td> <td>3-1/8"</td> <td></td> <td>10,000</td>		3,000	3-1/8"		5,000	3-1/8"		10,000	

(1) Only one required in Class 3M.

(2) Gate valves only shall be used for Class 10M.

(3) Remote operated hydraulic choke required on 5,000 psi and 10,000 psi for drilling.

EQUIPMENT SPECIFICATIONS AND INSTALLATION INSTRUCTIONS

1. All connections in choke manifold shall be welded, studded, flanged or Cameron clamp of comparable rating.
2. All flanges shall be API 6B or 6BX and ring gaskets shall be API RX or BX. Use only BX for 10 MWP.
3. All lines shall be securely anchored.
4. Chokes shall be equipped with tungsten carbide seats and needles, and replacements shall be available.
5. Choke manifold pressure and standpipe pressure gauges shall be available at the choke manifold to assist in regulating chokes. As an alternate with automatic chokes, a choke manifold pressure gauge shall be located on the rig floor in conjunction with the standpipe pressure gauge.
6. Line from drilling spool to choke manifold should be as straight as possible. Lines downstream from chokes shall make turns by large bends or 90° bends using bull plugged tees.
7. Discharge lines from chokes, choke bypass and from top of gas separator should vent as far as practical from the well.