

RECEIVED

FEB 17 2006

UNIVERSITY

If earthen pits are used in association with the drilling of this well, an OCD pit permit must be obtained prior to pit construction.

1st. 2

709

DEPARTMENT OF THE INTERIOR
BUREAU OF LAND MANAGEMENT

APPLICATION FOR PERMIT TO DRILL OR REENTER

1a. Type of Work: <input checked="" type="checkbox"/> DRILL <input type="checkbox"/> REENTER		5. Lease Serial No. NM-27791	
b. Type of Well: <input type="checkbox"/> Oil Well <input checked="" type="checkbox"/> Gas Well <input type="checkbox"/> Other <input checked="" type="checkbox"/> Single Zone <input type="checkbox"/> Multiple Zone		6. If Indian, Allottee or Tribe Name Not Applicable	
2. Name of Operator Yates Petroleum Corporation		7. If Unit or CA Agreement, Name and No. Not Applicable	
3A. Address 105 South Fourth Street Artesia, New Mexico 88210		8. Lease Name and Well No. Q Zane' ABS Federal Com. #4(26575)	
3b. Phone No. (include area code) 25575 (505) 748-1471		9. API Well No. 30-005-63806	
4. Location of Well (Report location clearly and in accordance with any State requirements. *) At surface 660' FSL and 760' FEL, Unit P At proposed prod. Zone same as above		10. Field and Pool, or Exploratory Undesignated Four Ranch, Pre-Permian	
14. Distance in miles and direction from nearest town or post office* Approximately twenty (20) miles northeast of Roswell, New Mexico		11. Sec., T., R., M., or Blk, and Survey or Area Section 15, T9S-R26E	
15. Distance from proposed* location to nearest property or lease line, ft. (Also to nearest drig. unit line, if any)	16. No. of Acres in lease 240	17. Spacing Unit dedicated to this well 320 acres - E/2	
18. Distance from proposed location* to nearest well, drilling, completed, applied for, on this lease, ft.	19. Proposed Depth 6480'	20. BLM/BIA Bond No. on file NM-2811	
21. Elevations (Show whether DF, KDB, RT, GL, etc.) 3789' GL	22. Approximate date work will start* ASAP	23. Estimated duration 30 Days	
24. Attachments ROSWELL CONTROLLED WATER BASIN			

The following, completed in accordance with the requirements of Onshore Oil and Gas Order No. 1, shall be attached to this form:

- | | |
|--|---|
| 1. Well plat certified by a registered surveyor. | 4. Bond to cover the operations unless covered by an existing bond on file (see Item 20 above). |
| 2. A Drilling Plan. | 5. Operator certification. |
| 3. A Surface Use Plan (if the location is on National Forest System Lands, the SUPO shall be filed with the appropriate Forest Service Office. | 6. Such other site specific information and/or plans as may be required by the authorized office. |

25. Signature <i>Debbie L. Caffall</i>	Name (Printed/Typed) Debbie Caffall/Land Department	Date 1/12/2006
Title: Registry Agent email: debbiec@ypcnm.com		
Approved (Signature) (ORIG SGD.) JOHN S. SIMITZ	Name (Printed/Typed) LARRY D. BRAY	Date FEB 14 2006
Title: Assistant Field Manager, Lands And Minerals ROSWELL FIELD OFFICE		

Application approval does not warrant or certify that the applicant holds legal or equitable title to those rights in the subject lease which would entitle the applicant to conduct operations thereon.

Conditions of approval, if any, are attached.

APPROVED FOR 1 YEAR

Title 18 U.S.C. Section 1001 and Title 43 U.S.C. Section 1212, make it a crime for any person knowingly and willfully to make to any department or agency of the United States any false, fictitious or fraudulent statements or representations as to any matter within its jurisdiction.

*(Instructions on reverse)

Previously Approved

C-144

DECLARED WATER BASIN

CASEY BEHIND THE 85"
CASING MUST BE CIRCULATED
WITNESS

APPROVAL SUBJECT TO
GENERAL REQUIREMENTS AND
SPECIAL STIPULATIONS ATTACHED

District II
811 South First, Artesia, NM 88210

OIL CONSERVATION DIVISION
1220 South St. Francis Dr.
Santa Fe, NM 87505

Submit to Appropriate District Office
State Lease - 4 Copies
Fee Lease - 3 Copies

District III
1000 Rio Brazos Rd., Aztec, NM 87410

District IV
1220 S. St. Francis Dr., Santa Fe, NM 87505

AMENDED REPORT

WELL LOCATION AND ACREAGE DEDICATION PLAT

¹ API Number		² Pool Code	³ Pool Name Undesignated Foor Ranch
⁴ Property Code	⁵ Property Name Zane ABS Federal		⁶ Well Number 4
⁷ OGRID No. 025575	⁸ Operator Name Yates Petroleum Corporation		⁹ Elevation 3789'

10 Surface Location

UL or lot no.	Section	Township	Range	Lot Idn	Feet from the	North/South line	Feet from the	East/West line	County
P	15	9S	26E		660	South	760	East	Eddy

¹¹ Bottom Hole Location If Different From Surface

Bottom Hole Location If Different From Surface									
UL or lot no.	Section	Township	Range	Lot Idn	Feet from the	North/South line	Feet from the	East/West line	County

¹² Dedicated Acres 320	¹³ Joint or Infill	¹⁴ Consolidation Code	¹⁵ Order No.
---	-------------------------------	----------------------------------	-------------------------

NO ALLOWABLE WILL BE ASSIGNED TO THIS COMPLETION UNTIL ALL INTERESTS HAVE BEEN CONSOLIDATED OR A NON-STANDARD UNIT HAS BEEN APPROVED BY THE DIVISION

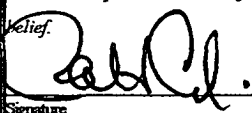
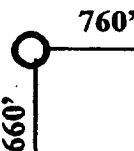
16		NM-28171	NM-27791	<p>17 OPERATOR CERTIFICATION</p> <p><i>I hereby certify that the information contained herein is true and complete to the best of my knowledge and belief.</i></p> <p></p> <p>Signature</p> <p>Robert Asher/Land Department</p> <p>Printed Name</p> <p>Regulatory Agent</p> <p>Title</p> <p>06/22/2004</p> <p>18 SURVEYOR CERTIFICATION</p> <p><i>I hereby certify that the well location shown on this plat was plotted from field notes of actual surveys made by me or under my supervision, and that the same is true and correct to the best of my belief.</i></p> <p>REFER TO ORIGINAL PLAT</p> <p>Date of Survey</p> <p>Signature and Seal of Professional Surveyor:</p> <p>Certificate Number</p>
			FEE	
		NM-27791		
				

DISTRICT I
1025 N. French St., Hobbs, NM 88240

Energy, Minerals and Natural Resources Department

Revised March 17, 1999
Instruction on back
Submit to Appropriate District Office
State Lease - 4 Copies
Fee Lease - 3 Copies

DISTRICT II
811 South First, Artesia, NM 88210

DISTRICT III
1000 Rio Brazos Rd., Aztec, NM 87410

DISTRICT IV
2040 South Pacheco, Santa Fe, NM 87505

OIL CONSERVATION DIVISION

P.O. Box 2088
Santa Fe, New Mexico 87504-2088

☐ AMENDED REPORT

WELL LOCATION AND ACREAGE DEDICATION PLAT

API Number	Pool Code	Pool Name
Property Code	Property Name	Well Number
OGRID No.	Operator Name	Elevation
025575	YATES PETROLEUM CORPORATION	3789

Surface Location

UL or lot No.	Section	Township	Range	Lot Idn	Feet from the	North/South line	Feet from the	East/West line	County
P	15	9S	26E		660	SOUTH	760	EAST	CHAVES

Bottom Hole Location if Different From Surface

UL or lot No.	Section	Township	Range	Lot Idn	Feet from the	North/South line	Feet from the	East/West line	County
Dedicated Acres	Joint or Infill	Consolidation Code	Order No.						
320									

NO ALLOWABLE WILL BE ASSIGNED TO THIS COMPLETION UNTIL ALL INTERESTS HAVE BEEN CONSOLIDATED
OR A NON-STANDARD UNIT HAS BEEN APPROVED BY THE DIVISION

		NM-28171	NM-27791
		1780' 1980' Zane "ABS" Fed. #3	fee
		NM-27791	
		Zane "ABS" Fed. #1 1980'	N.33°31'38.1" W.104°16'44.6" 3791 3792 3785 3787 760'

OPERATOR CERTIFICATION

I hereby certify the the information contained herein is true and complete to the best of my knowledge and belief.

Pat Perez
Signature
Pat Perez
Printed Name
Regulatory Agent
Title
03/11/02
Date

SURVEYOR CERTIFICATION

I hereby certify that the well location shown on this plat was plotted from field notes of actual surveys made by me or under my supervision, and that the same is true and correct to the best of my belief.

1/07/2002
Date Surveyed
Signature of Registered Professional Surveyor
NEW MEXICO
REGISTERED PROFESSIONAL SURVEYOR
JONES RLS 3640
Certificate No. 3640
ZANE
FEDERAL LAND SURVEYING COMPANY

District I
1625 N. French Dr., Hobbs, NM 88240
District II
1301 W. Grand Avenue, Artesia, NM 88210
District III
1000 Rio Brazos Road, Aztec, NM 87410
District IV
1220 S. St. Francis Dr., Santa Fe, NM 87505

State of New Mexico
Energy Minerals and Natural Resources

Oil Conservation Division
1220 South St. Francis Dr.
Santa Fe, NM 87505

For drilling and production facilities, submit to appropriate NMOCD District Office.
For downstream facilities, submit to Santa Fe office

Form C-144
March 12, 2004

105 South Fourth Street, Artesia, NM 88210

Pit or Below-Grade Tank Registration or Closure

Is pit or below-grade tank covered by a "general plan"? Yes ☒ CheckBox1

Type of action: Registration of a pit or below-grade tank ☒ Closure of a pit or below-grade tank ☐

Operator: Yates Petroleum Corporation Telephone: 505-748-4376 e-mail address: debbiec@ypcnm.com

Address: 104 South 4th Street, Artesia, New Mexico 88210

Facility or well name: Zane ABS Federal Corn. #4 API #: U/L or Qtr/Qtr SESE Sec 15 T 9S R 26E

County: Chaves Latitude Longitude NAD: 1927 ☐ 1983 ☐ Surface Owner: Federal ☒ State ☐ Private ☐ Indian ☐

Pit

Type: Drilling ☒ Production ☐ Disposal ☐
Workover ☐ Emergency ☐

Lined ☒ Unlined ☐

Liner type: Synthetic ☒ Thickness 12 mil Clay ☐ Volume
bbl

Below-grade tank

Volume: bbl Type of fluid:

Construction material:

Double-walled, with leak detection? Yes ☐ If not, explain why not.

RECEIVED

NOV 03 2004

OCD-ARTESIA

Depth to ground water (vertical distance from bottom of pit to seasonal high water elevation of ground water.)

Less than 50 feet

(20 points)

50 feet or more, but less than 100 feet

(10 points)

100 feet or more

(0 points)

Wellhead protection area: (Less than 200 feet from a private domestic water source, or less than 1000 feet from all other water sources.)

Yes

(20 points)

No

(0 points)

Distance to surface water: (horizontal distance to all wetlands, playas, irrigation canals, ditches, and perennial and ephemeral watercourses.)

Less than 200 feet

(20 points)

200 feet or more, but less than 1000 feet

(10 points)

1000 feet or more

(0 points)

Ranking Score (Total Points)

30

If this is a pit closure: (1) attach a diagram of the facility showing the pit's relationship to other equipment and tanks. (2) Indicate disposal location:

onsite ☐ offsite ☐ If offsite, name of facility

(3) Attach a general description of remedial action taken including remediation start date and end date. (4) Groundwater encountered: No ☐ Yes ☐ If yes, show depth below ground surface ft. and attach sample results. (5) Attach soil sample results and a diagram of sample locations and excavations.

I hereby certify that the information above is true and complete to the best of my knowledge and belief. I further certify that the above-described pit or below-grade tank has been/will be constructed or closed according to NMOCD guidelines ☐, a general permit ☒, or an (attached) alternative OCD-approved plan ☐.

Date: 11/3/2004

Printed Name/Title Robert Asher/Regulatory Agent

Signature

Your certification and NMOCD approval of this application/closure does not relieve the operator of liability should the contents of the pit or tank contaminate ground water or otherwise endanger public health or the environment. Nor does it relieve the operator of its responsibility for compliance with any other federal, state, or local laws and/or regulations.

Approval:

Date:

Printed Name/Title

Signature

As a condition of approval
a detailed closure plan
must be filed before
closure may commence.

As a condition of approval, if during
construction water is encountered or
if water seeps in pits after
construction the **OCD MUST BE**
CONTACTED IMMEDIATELY!

YATES PETROLEUM CORPORATION

Zane "ABS" Federal Com. #4

660' FSL and 760' FEL

Section 15-T9S-R26E

Chaves County, New Mexico

1. The estimated tops of geologic markers are as follows:

San Andres	1035'
Glorieta	2115'
Yeso	2235'
Tubb	3655'
Abo	4430'
Wolfcamp	5195'
Cisco	5813'
Penn Clastics	5901'
Mississippian	6085'
Ordovician	6135'
Basement	6330'
TD	6480'

2. The estimated depths at which anticipated water, oil or gas formations are expected to be encountered:

Water: 150'-200'
Oil or Gas: All potential zones.

3. Pressure Control Equipment: BOPE will be installed on the 8 5/8" casing and rated for 2000 BOP systems will be consistent with API RP 53. Pressure tests will be conducted before drilling out from under all casing strings which are set and cemented in place. Blowout Preventor controls will be installed prior to drilling the surface plug and will remain in use until the well is completed or abandoned. Preventors will be inspected and operated at least daily to ensure good mechanical working order, and this inspection recorded on the daily drilling report. See Exhibit B.

Auxiliary Equipment:

- A. Auxiliary Equipment: Kelly cock, pit level indicators, flow sensor equipment and a sub with full opening valve to fit the drill pipe and collars will be available on the rig floor in the open position at all times for use when kelly is not in use.

4. THE PROPOSED CASING AND CEMENTING PROGRAM:

- A. Casing Program: (All New)

<u>Hole Size</u>	<u>Casing Size</u>	<u>Wt./Ft</u>	<u>Grade</u>	<u>Coupling</u>	<u>Interval</u>
12 1/4	8 5/8"	24#	J-55	ST&C	0-1100'
7 7/8"	5 1/2"	15.5#	J-55	ST&C	0-6480'

1. Minimum Casing Design Factors: Collapse 1.125, Burst 1.0, Tensile Strength 1.8

A. CEMENTING PROGRAM:

Surface Casing: 350 sx Lite "C" (YLD 2.0 WT 12.5). Tail in with 200 sx "C"
+ 2% CaCL₂ (YLD 1.33 WT 15.6).

Production Casing: 550 sx Pecos Valley Lite (YLD 1.34 WT 13.0). TOC 3800'.

5. MUD PROGRAM AND AUXILIARY EQUIPMENT:

<u>Interval</u>	<u>Type</u>	<u>Weight</u>	<u>Viscosity</u>	<u>Fluid Loss</u>
0-1100'	FW GEL,Paper,LCM	8.6 - 9.6	32-36	N/C
1100'-4340'	Brine	10.0-10.2	28	N/C
4340'-6480'	Starch/Salt Gel	9.3 -10.2	32-40	<6/cc

Sufficient mud material(s) to maintain mud properties, control lost circulation and contain a blow out will be available at the well site during drilling operations. Mud will be checked hourly by rig personnel.

6. EVALUATION PROGRAM:

Samples: 10' samples out from under surface casing.

Logging: CNL/LDT, W/NGT TD-Surf csg; with CNL/GR up to Surf; DLL/MS
FL TD-Surf csg: Long Spaced Sonic TD-SURF CSG

Coring: None

DST's: As warranted.

7. ABNORMAL CONDITIONS, BOTTOM HOLE PRESSURE, AND POTENTIAL HAZARDS:

Anticipated BHP:

From: 0	TO: 1100'	Anticipated Max. BHP: 400 PSI
From: 1100'	TO: 6480'	Anticipated Max. BHP: 2700 PSI

Abnormal Pressures Anticipated: None

Lost Circulation Zones Anticipated: None.

H₂S Zones Anticipated: None Anticipated

Maximum Bottom Hole Temperature: 145 F

8. ANTICIPATED STARTING DATE:

Plans are to drill this well as soon as possible after receiving approval. It should take approximately 25 days to drill the well with completion taking another 20 days.

MULTI-POINT SURFACE USE AND OPERATIONS PLAN
YATES PETROLEUM CORPORATION
Zane "ABS" Federal Com. #4
660' FSL and 760' FEL
Section 15-T9S-R26E
Chaves County, New Mexico

This plan is submitted with Form 3160-3, Application for Permit to Drill, covering the above described well. The purpose of this plan is to describe the location of the proposed well, the proposed construction activities and operations plan, the magnitude of the surface disturbance involved and the procedures to be followed in rehabilitating the surface after completion of the operations, so that a complete appraisal can be made of the environmental effect associated with the operations.

1. EXISTING ROADS:

Exhibit A is a portion of the BLM map showing the well and roads in the vicinity of the proposed location. The proposed well site is located approximately 15 miles northeast of Roswell, New Mexico and the access route to the location is indicated in red and green on Exhibit A.

DIRECTIONS:

Drive NE of Roswell on Highway 70 approx. 14 miles to Magdalena and turn right. Drive on Magdalena approx. 5.4 miles & turn left (east) on lease road. Stay right where road forks & drive approx. 0.4 of a mile to lease road on the right. Turn on lease road & drive approx. 600' where the access road is staked on the left (west) side going to the SW corner of the location.

2. PLANNED ACCESS ROAD:

- A. The proposed new access will be approximately 800' in length from the point of origin to the southwest corner of the drilling pad. The road will lie in a north to south direction.
- B. The new road will be 14 feet in width (driving surface) and will be adequately drained to control runoff and soil erosion.
- C. Existing roads will be maintained in the same or better condition.

3. LOCATION OF EXISTING WELL:

- A. There is drilling activity within a one-mile radius of the well site.
- B. Exhibit D shows existing wells within a one-mile radius of the proposed well site.

4. LOCATION OF EXISTING AND/OR PROPOSED FACILITIES:

- A. There are production facilities on this lease at the present time.
- B. In the event that the well is productive, the necessary production facilities will be installed on the drilling pad. If the well is productive oil, a gas or diesel self-contained unit will be used to provide the necessary power. No power will be required if the well is productive of gas.

5. LOCATION AND TYPE OF WATER SUPPLY:

- A. It is planned to drill the proposed well with a fresh water system. The water will be obtained from commercial sources and will be hauled to the location by truck over the existing and proposed roads shown in Exhibit A.

6. SOURCE OF CONSTRUCTION MATERIALS:

Dirt contractor will locate nearest pit and obtain any permits and materials needed for construction.

7. METHODS OF HANDLING WASTE DISPOSAL:

- A. Drill cuttings will be disposed of in the reserve pits.
- B. Drilling fluids will be allowed to evaporate in the reserve pits until the pits are dry.
- C. Water produced during operations will be collected in tanks until hauled to an approved disposal system, or separate disposal application will be submitted.
- D. Oil produced during operations will be stored in tanks until sold.
- E. Current laws and regulations pertaining to the disposal of human waste will be complied with.
- F. All trash, junk, and other waste materials will be contained in trash cages or bins to prevent scattering and will be removed and deposited in an approved sanitary landfill. Burial on site is not approved.

8. ANCILLARY FACILITIES: NONE

9. WELLSITE LAYOUT:

- A. Exhibit C shows the relative location and dimensions of the well pad, the reserve pits, the location of the drilling equipment, rig orientation and access road approach.
- B. The reserve pits will be plastic lined. Yates Petroleum Corporation is in full compliance with the OCD General Plan for Drilling Pits approved on April 15, 2004.
- C. A 400' x 400' area has been staked and flagged.

10. PLANS FOR RESTORATION:

- A. After finishing drilling and/or completion operations, all equipment and other material not needed for further operations will be removed. The location will be cleaned of all trash and junk to leave the well site in as aesthetically pleasing a condition as possible.
- B. Unguarded pits, if any, containing fluids will be fenced until they have dried and been leveled.
- C. If the proposed well is non-productive, all rehabilitation and/or vegetation requirements of the Bureau of Land Management will be complied with and will be accomplished as expeditiously as possible. All pits will be filled level after they have evaporated and dried.

**11. SURFACE OWNERSHIP: Meredith Ranch, c/o Wes Runyun
Roswell, New Mexico**

12. OTHER INFORMATION:

- A. Topography: Refer to the existing archaeological report for a description of the topography, flora, fauna, soil characteristics, dwellings, historical and cultural sites.
- B. The primary surface use is for grazing.

13. OPERATOR'S REPRESENTATIVE:

- | | |
|--|---|
| A. Through A.P.D. Approval:
Debbie Caffall/ Regulatory Agent
Yates Petroleum Corporation
105 South Fourth Street
Artesia, New Mexico 88210
Phone (505) 748-4376 | B. Through Drilling, Completions & Prod.
Pinson McWhorter, Operations Manager
Yates Petroleum Corporation
105 South Fourth Street
Artesia, New Mexico 88210
Phone (505) 748-1471 |
|--|---|

14. CERTIFICATION:

I hereby certify that I, or persons under my direct supervision, have inspected the proposed drill site and access route, that I am familiar with the conditions which presently exist; that the statements made in this plan are to the best of my knowledge, true and correct; and , that the work associated with the operations proposed herein will be performed by Yates Petroleum Corporation and its contractors and subcontractors in conformity with this plan and the terms and conditions under which it is approved. This statement is subject to the provisions of 18 U.S.C. 1001 for the filing of a false statement.

1/12/2006

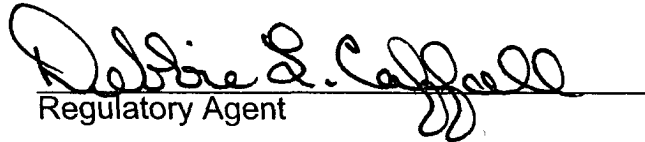
Regulatory Agent

Yates Petroleum Corporation
Zane "ABS" Federal Com. #4
660' FSL & 760' FEL, Unit P
Section 15-T9S-R26E
Chaves County, New Mexico
Exhibit "A"

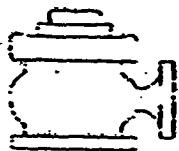

Yates Petroleum Corporation

BOP-2

Typical 2,000 psi Pressure System Schematic Double Ram Preventer Stack

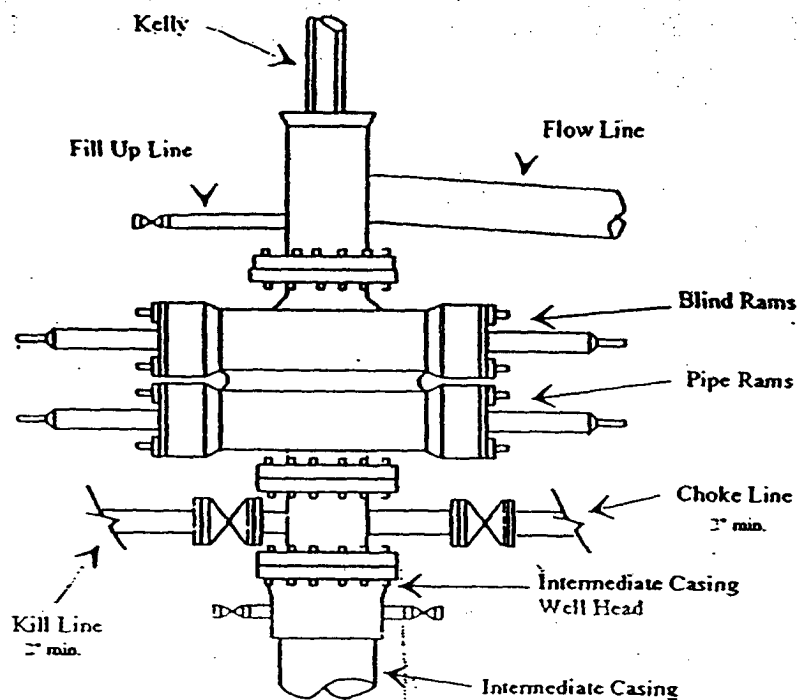

Yates Petroleum Corporation
Zane "ABS" Federal Com. #4
660' FSL & 760' FEL, Unit P
Section 15-T9S-R26E
Chaves County, New Mexico
Exhibit "B"

Typical 2,000 psi choke manifold assembly with at least these minimum features

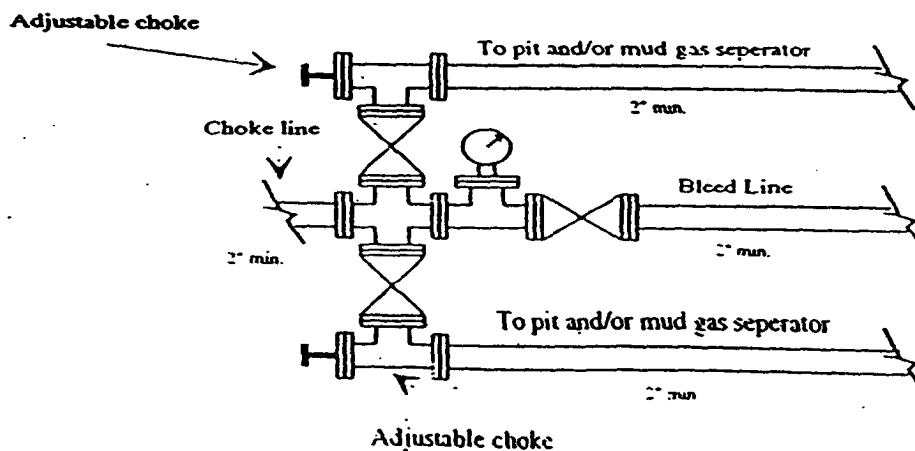

PB - L1

Yates Petroleum Corporation

Location Layout for Permian Basin
Up to 12,000'

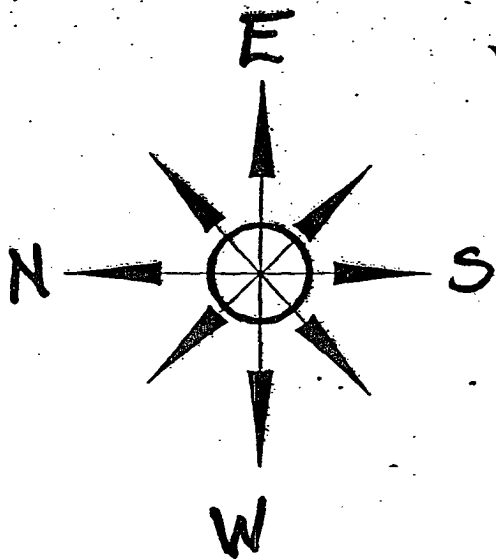

Yates Petroleum Corporation
Zane "ABS" Federal Com. #4
660' FSL & 760' FEL, Unit P
Section 15-T9S-R26E
Chaves County, New Mexico
Exhibit "C"

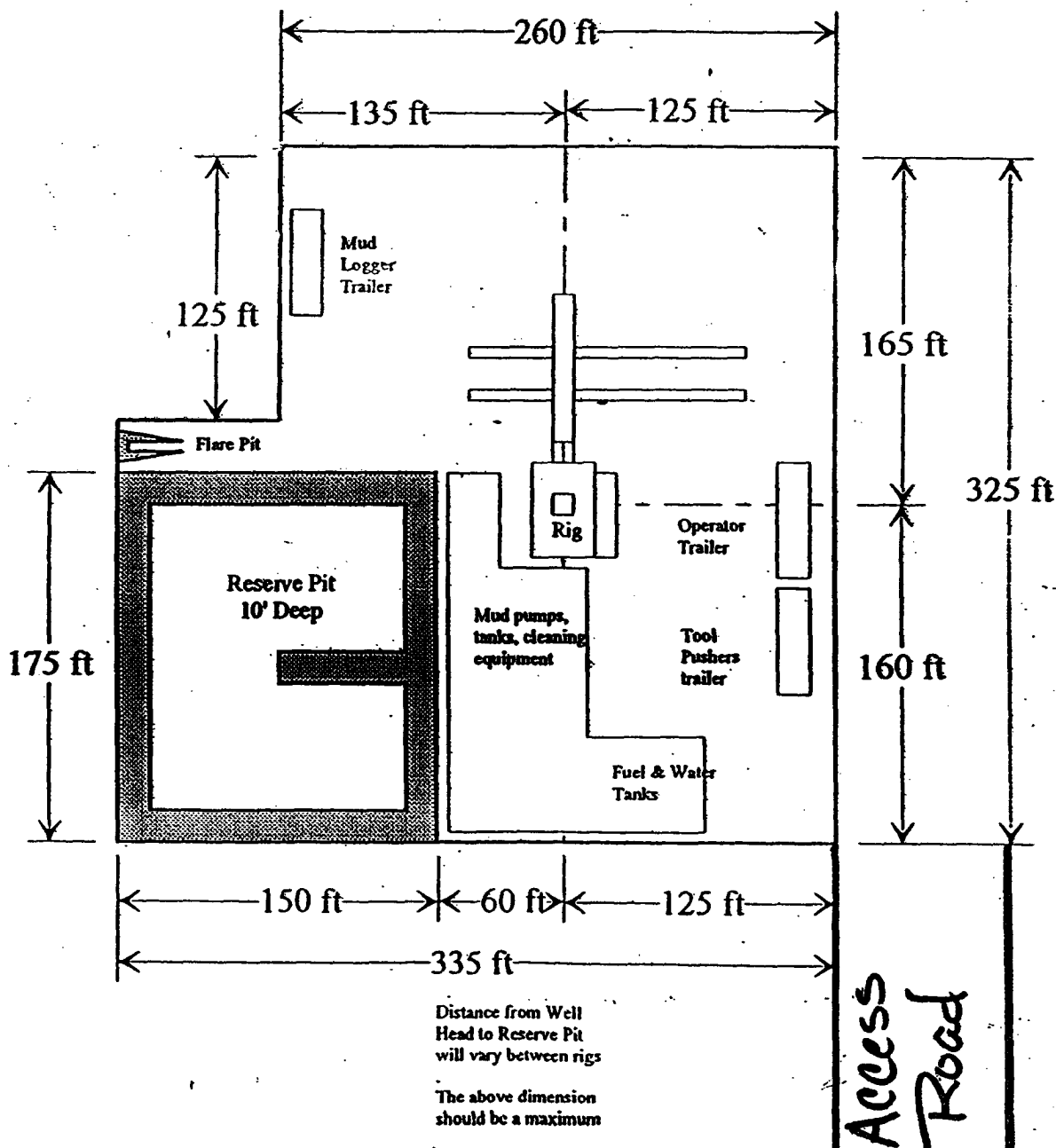

1 Ates Petroleum Corporation
Zane "ABS" Federal Com. #4
660' FSL & 760' FEL, Unit P
Section 15-T9S-R26B
Chaves County, New Mexico
Exhibit "D"

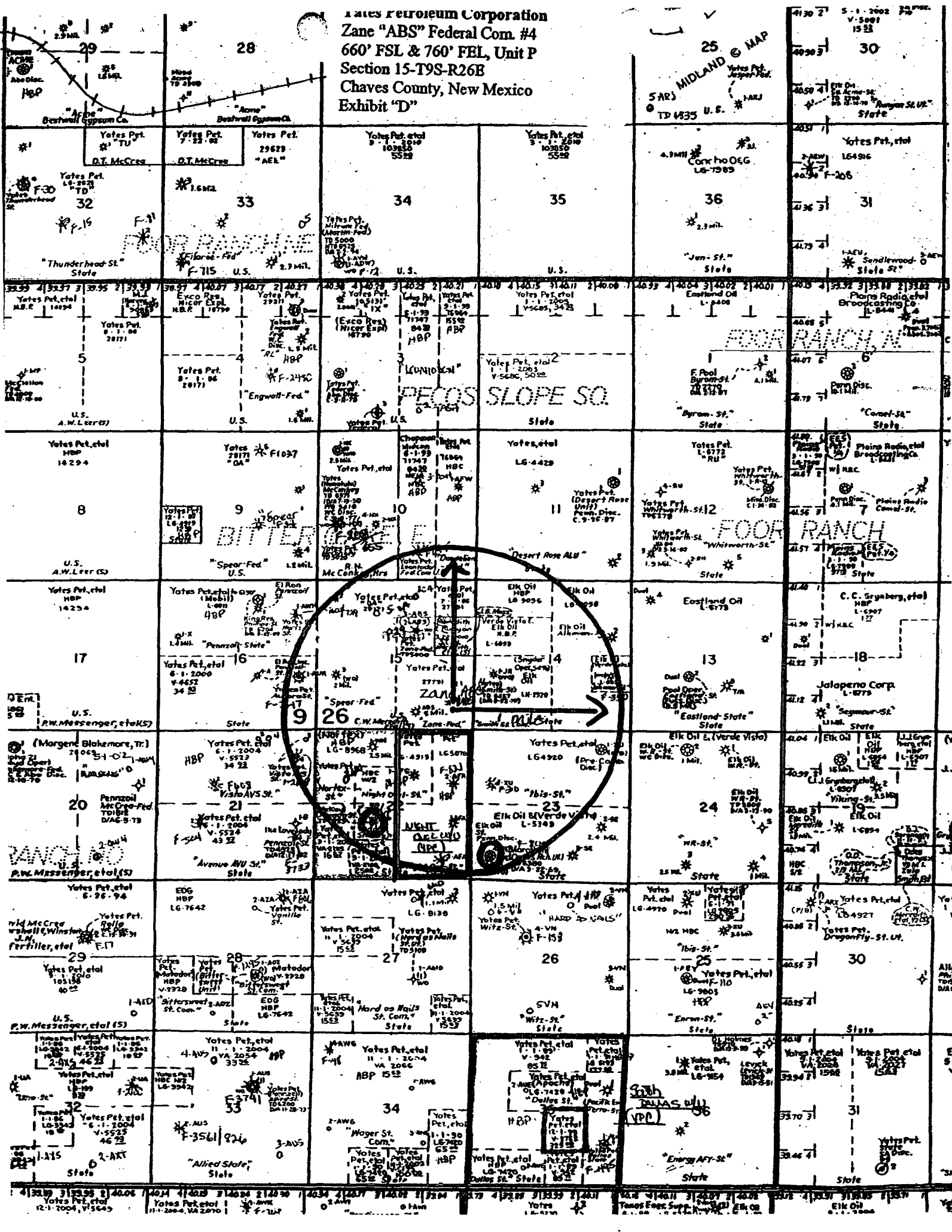

EXHIBIT A

Operator: Yates Petroleum Corporation

BLM Serial Number: NM-27791

Well Name & NO.: Zane "ABS" Federal Com. #4

Location: Section 15, T. 9 S., R. 26 E.

660' FSL & 760' FEL, Chaves County, N.M.

