

**DISTRICT I**  
1625 N. French Dr., Hobbs, NM 88240  
Phone: (575) 393-6161 Fax: (575) 393-0720

**DISTRICT II**  
811 S. First St., Artesia, NM 88210  
Phone: (575) 748-1283 Fax: (575) 748-9720

**DISTRICT III**  
1000 Rio Brazos Road, Aztec, NM 87410  
Phone: (505) 334-6178 Fax: (505) 334-6170

**DISTRICT IV**  
1220 S. St. Francis Dr., Santa Fe, NM 87505  
Phone: (505) 476-3460 Fax: (505) 476-3462

**State of New Mexico**  
**Energy, Minerals & Natural Resources Department**  
**OIL CONSERVATION DIVISION**  
**1220 South St. Francis Dr.**  
**Santa Fe, New Mexico 87505**

Form C-102  
Revised August 1, 2011  
Submit one copy to appropriate District Office

**ARTESIA DISTRICT**  
**MAR 27 2017**  
**AMENDED REPORT**

**WELL LOCATION AND ACREAGE DEDICATION PLAT**

API Number <b>30-015-42994</b>	Pool Code <b>98220</b>	Pool Name <b>Purple Sage; Wolfcamp</b>
Property Code <b>314249</b>	Property Name <b>FOREHAND RANCH 22 STATE</b>	Well Number <b>7H</b>
OGRID No. <b>249099</b>	Operator Name <b>CAZA OPERATING, LLC</b>	Elevation <b>3150'</b>

**Surface Location**

UL or lot No.	Section	Township	Range	Lot Idn	Feet from the	North/South line	Feet from the	East/West line	County
<b>L</b>	<b>22</b>	<b>23-S</b>	<b>27-E</b>		<b>2440</b>	<b>SOUTH</b>	<b>660</b>	<b>WEST</b>	<b>EDDY</b>

**Bottom Hole Location If Different From Surface**

UL or lot No.	Section	Township	Range	Lot Idn	Feet from the	North/South line	Feet from the	East/West line	County
<b>M</b>	<b>27</b>	<b>23-S</b>	<b>27-E</b>		<b>660</b>	<b>SOUTH</b>	<b>825</b>	<b>WEST</b>	<b>EDDY</b>

Dedicated Acres <b>480</b>	Joint or Infill	Consolidation Code	Order No.
			<i>NSP required</i>

**NO ALLOWABLE WILL BE ASSIGNED TO THIS COMPLETION UNTIL ALL INTERFERING WELLS HAVE BEEN CONSOLIDATED OR A NON-STANDARD UNIT HAS BEEN APPROVED BY THE DIVISION**

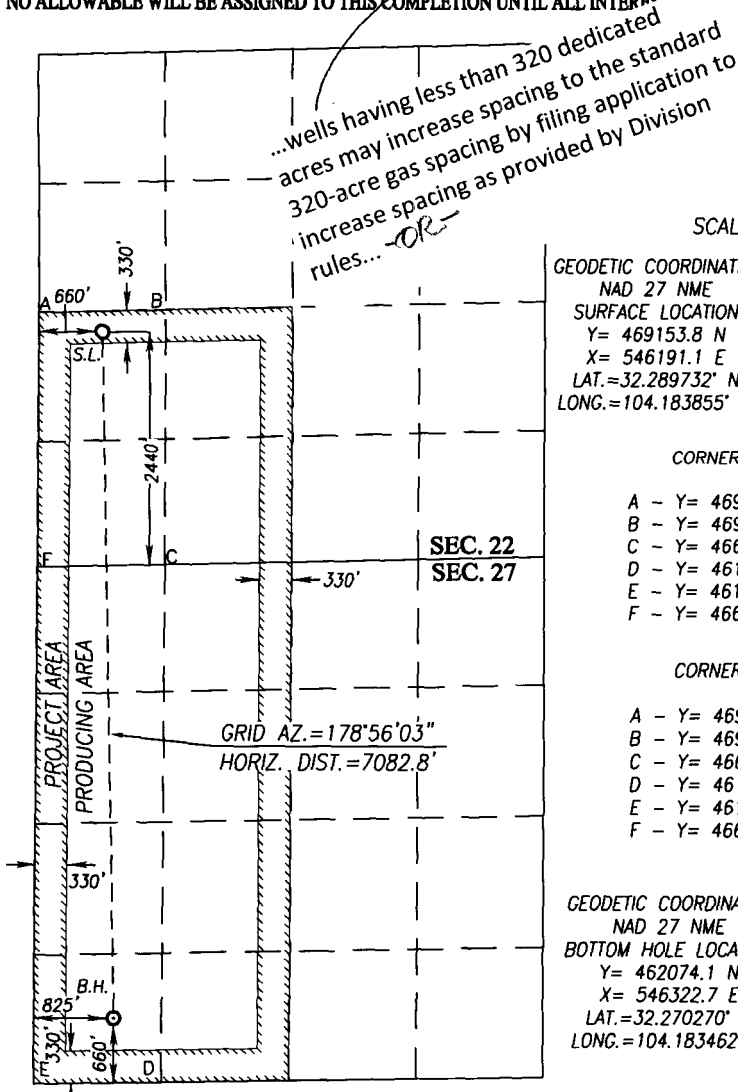

SCALE: 1"=2000'

GEODETIC COORDINATES NAD 27 NME SURFACE LOCATION	GEODETIC COORDINATES NAD 83 NME SURFACE LOCATION
Y = 469153.8 N X = 546191.1 E LAT. = 32.289732° N LONG. = 104.183855° W	Y = 469212.5 N X = 587373.5 E LAT. = 32.289851° N LONG. = 104.184354° W

**CORNER COORDINATES TABLE**  
NAD 27 NME

A - Y = 469349.9 N, X = 545531.7 E
B - Y = 469380.0 N, X = 546844.7 E
C - Y = 466727.9 N, X = 546839.5 E
D - Y = 461421.5 N, X = 546813.5 E
E - Y = 461401.8 N, X = 545493.8 E
F - Y = 466699.3 N, X = 545525.9 E

**CORNER COORDINATES TABLE**  
NAD 83 NME

A - Y = 469408.7 N, X = 586714.0 E
B - Y = 469438.7 N, X = 588027.0 E
C - Y = 466786.6 N, X = 588021.9 E
D - Y = 461480.0 N, X = 587996.0 E
E - Y = 461460.4 N, X = 586676.3 E
F - Y = 466758.0 N, X = 586708.3 E

GEODETIC COORDINATES NAD 27 NME BOTTOM HOLE LOCATION	GEODETIC COORDINATES NAD 83 NME BOTTOM HOLE LOCATION
Y = 462074.1 N X = 546322.7 E LAT. = 32.270270° N LONG. = 104.183462° W	Y = 462132.6 N X = 587505.2 E LAT. = 32.2703889° N LONG. = 104.183960° W

**OPERATOR CERTIFICATION**

I hereby certify that the information herein is true and complete to the best of my knowledge and belief, and that this organization either owns a working interest or unleased mineral interest in the land including the proposed bottom hole location or has a right to drill this well at this location pursuant to a contract with an owner of such mineral or working interest, or to a voluntary pooling agreement or a compulsory pooling order heretofore entered by the division.

*[Signature]* **03/25/2017**  
Signature Date

**Steve Morris**

Printed Name

**steve.morris@mojoenergy.com**  
E-mail Address

**SURVEYOR CERTIFICATION**

I hereby certify that the well location shown on this plat was plotted from field notes of actual surveys made by me or under my supervision and that the same is true and correct to the best of my belief.

Date of Survey  
Signature & Seal of Professional Surveyor:

*[Signature]* **03/24/2017**  
Certificate Number Gary G. Eidson 12641  
Ronald J. Eidson 3239

ACK REV: 3/24/17 JWSC W.O.: 15.11.0229