

Submit 4 Copy To Appropriate District Office  
District I - (575) 393-6161  
1625 N. French Dr., Hobbs, NM 88240  
District II - (575) 748-1283  
811 S. First St., Artesia, NM 88210  
District III - (505) 334-6178  
1000 Rio Brazos Rd., Aztec, NM 87410  
District IV - (505) 476-3460  
1220 S. St. Francis Dr., Santa Fe, NM 87505

State of New Mexico  
Energy, Minerals and Natural Resources

Form C-103  
Revised July 18, 2013

OIL CONSERVATION DIVISION  
1220 South St. Francis Dr.  
Santa Fe, NM 87505

SUNDRY NOTICES AND REPORTS ON WELLS (DO NOT USE THIS FORM FOR PROPOSALS TO DRILL OR TO DEEPEN OR PLUG BACK TO A DIFFERENT RESERVOIR. USE "APPLICATION FOR PERMIT" (FORM C-101) FOR SUCH PROPOSALS.)		WELL API NO. 30-015-33985
1. Type of Well: Oil Well <input type="checkbox"/> Gas Well <input checked="" type="checkbox"/> <b>NM OIL CONSERVATION</b>		5. Indicate Type of Lease STATE <input checked="" type="checkbox"/> FEE <input type="checkbox"/>
2. Name of Operator Cimarex Energy Co. of Colorado		6. State Oil & Gas Lease No.
3. Address of Operator 202 S. Cheyenne Ave., Suite 1000, Tulsa OK 74103		7. Lease Name or Unit Agreement Name New Mexico DD State Com
4. Well Location Unit Letter <u>D</u> : <u>295</u> feet from the <u>North</u> line and <u>750</u> feet from the <u>West</u> line Section <u>32</u> <u>24S</u> Township <u>26E</u> Range <u>NMPM</u> Eddy County		8. Well Number #3
11. Elevation (Show whether DR, RKB, RT, GR, etc.) 3468'		9. OGRID Number 162683
		10. Pool name or Wildcat Purple Sage Wolfcamp (Gas) (98220)

12. Check Appropriate Box to Indicate Nature of Notice, Report or Other Data

NOTICE OF INTENTION TO:		SUBSEQUENT REPORT OF:	
PERFORM REMEDIAL WORK <input type="checkbox"/>	PLUG AND ABANDON <input type="checkbox"/>	REMEDIAL WORK <input type="checkbox"/>	ALTERING CASING <input type="checkbox"/>
TEMPORARILY ABANDON <input type="checkbox"/>	CHANGE PLANS <input type="checkbox"/>	COMMENCE DRILLING OPNS. <input type="checkbox"/>	P AND A <input type="checkbox"/>
PULL OR ALTER CASING <input type="checkbox"/>	MULTIPLE COMPL <input type="checkbox"/>	CASING/CEMENT JOB <input type="checkbox"/>	
DOWNHOLE COMMINGLE <input type="checkbox"/>			
CLOSED-LOOP SYSTEM <input type="checkbox"/>			
OTHER: <input type="checkbox"/>		OTHER: Plugback and Recomplete <input checked="" type="checkbox"/>	

13. Describe proposed or completed operations. (Clearly state all pertinent details, and give pertinent dates, including estimated date of starting any proposed work). SEE RULE 19.15.7.14 NMAC. For Multiple Completions: Attach wellbore diagram of proposed completion or recompletion.

New Mexico DD State Com #3  
Plugback/Recompletion Ops

11/10/2017- Set CIBP @ 10816' and dump 35' Class H Cement. TOC 10816' Pressure up to 3000 psi for 10 min. Good test. Set another CIBP at 10250' Pressure up to 4000 psi for 30 Min. Good Test. Abandon Morrow.  
11/17/2017- Casing Leak Determined. Set CBP @ 7377'. Pump 5 bbls Well Lock. Mill out well lock and CBP. Test Csg to 8450 psi for 30 min. Good Test.  
2/2/2018- Perforate the Cisco Canyon from 9933' - 9710'. 59 shots. Frac with 663905 gal slickwater and 844850 lbs sand. Set CIBP at 9683'. Test to 6700 psi for 10 min. good test. Did not drill out plug. Temporary plug.  
2/6/2018- Perforate the Wolfcamp from 9678'-9454'. 59 shots. Frac with 608590 gal slickwater and 802530 lbs sand. Wolfcamp is only producing formation.  
2/20/2018 Set 2 3/8" tubing Packer & GLVs at 9418'  
3/22/2018 Flowback and turn to production.

Spud Date:

Rig Release Date:

I hereby certify that the information above is true and complete to the best of my knowledge and belief.

SIGNATURE Amithy Crawford TITLE Regulatory Analyst DATE 7/11/2018

Type or print name Amithy Crawford E-mail address: acrawford@cimarex.com PHONE: 432-620-1909

For State Use Only  
APPROVED BY Kristy Klein TITLE Business Ops Spec A DATE 7-12-2018  
Conditions of Approval (if any):

**CIMAREX**

KB - 23' above GL

Cimarex Energy Co. of Colorado  
New Mexico DD State Com #3  
SHL - 295' FNL & 750' FWL  
BHL - 994' FNL & 996' FWL  
Sec. 32, T-24-S, R-26-E, Eddy Co., NM  
S. Runyan 07/11/18

13-3/8", 48# H-40 csg @ 218'  
cmt'd w/ 250 sx, 1" to surface w/ 400 sx

9-5/8", 40# J-55 csg @ 1680'  
cmt'd w/ 1775 sx, cmt circ

2-3/8" 4.7# L-80 Tbg

DV Tool @ 7313'  
cmt'd w/ 1590 sx, cmt circ

AS1X pkr @ 9,418.54'

CIBP @ 9,683

Wolfcamp E Perforations (9678'-9454')

CIBP @ 10,250

Cisco Canyon Perforations (9,710'- 9933')

CIBP @ 10,816 with 35' of CMT  
PBD @ 10,579

Morrow perms (10,868' - 11,284')

5-1/2" 17# P-110 @ 11734' cmt'd w/ 930 sx, cmt circ  
TD @ 11734'

*Purple Sage  
WC*

District I  
1625 N. French Dr., Hobbs, NM 88240  
Phone: (575) 393-6161 Fax: (575) 393-0720  
District II  
811 S. First St., Artesia, NM 88210  
Phone: (575) 748-1283 Fax: (575) 748-9720  
District III  
1000 Rio Brazos Road, Aztec, NM 87410  
Phone: (505) 334-6178 Fax: (505) 334-6170  
District IV  
1220 S. St. Francis Dr., Santa Fe, NM 87505  
Phone: (505) 476-3460 Fax: (505) 476-3462

State of New Mexico  
Energy, Minerals & Natural Resources Department  
OIL CONSERVATION DIVISION  
1220 South St. Francis Dr.  
Santa Fe, NM 87505

Form C-102  
Revised August 1, 2011  
one copy to appropriate  
District Office

**NM OIL CONSERVATION**  
**ARTESIA DISTRICT**

**JUL 12 2018**

☐ AMENDED REPORT

**WELL LOCATION AND ACREAGE DEDICATION PLAT**

**RECEIVED**

<sup>1</sup> API Number 30-015-33985	<sup>2</sup> Pool Code 98220	<sup>3</sup> Pool Name Purple Sage Wolfcamp Gas
<sup>4</sup> Property Code	<sup>5</sup> Property Name NM DD State Com	<sup>6</sup> Well Number 3
<sup>7</sup> OGRID No. 162683	<sup>8</sup> Operator Name Cimarex Energy Co of Colorado	<sup>9</sup> Elevation 3398'

**<sup>10</sup> Surface Location**

UL or lot no.	Section	Township	Range	Lot Idn	Feet from the	North/South line	Feet from the	East/West line	County
D	32	24S	26E		295	North	750	West	Eddy

**<sup>11</sup> Bottom Hole Location If Different From Surface**

UL or lot no.	Section	Township	Range	Lot Idn	Feet from the	North/South line	Feet from the	East/West line	County
D	32	24S	26E		994'	North	996'	East	Eddy

<sup>12</sup> Dedicated Acres 640	<sup>13</sup> Joint or Infill	<sup>14</sup> Consolidation Code	<sup>15</sup> Order No.
--------------------------------------	-------------------------------	----------------------------------	-------------------------

No allowable will be assigned to this completion until all interests have been consolidated or a non-standard unit has been approved by the division.

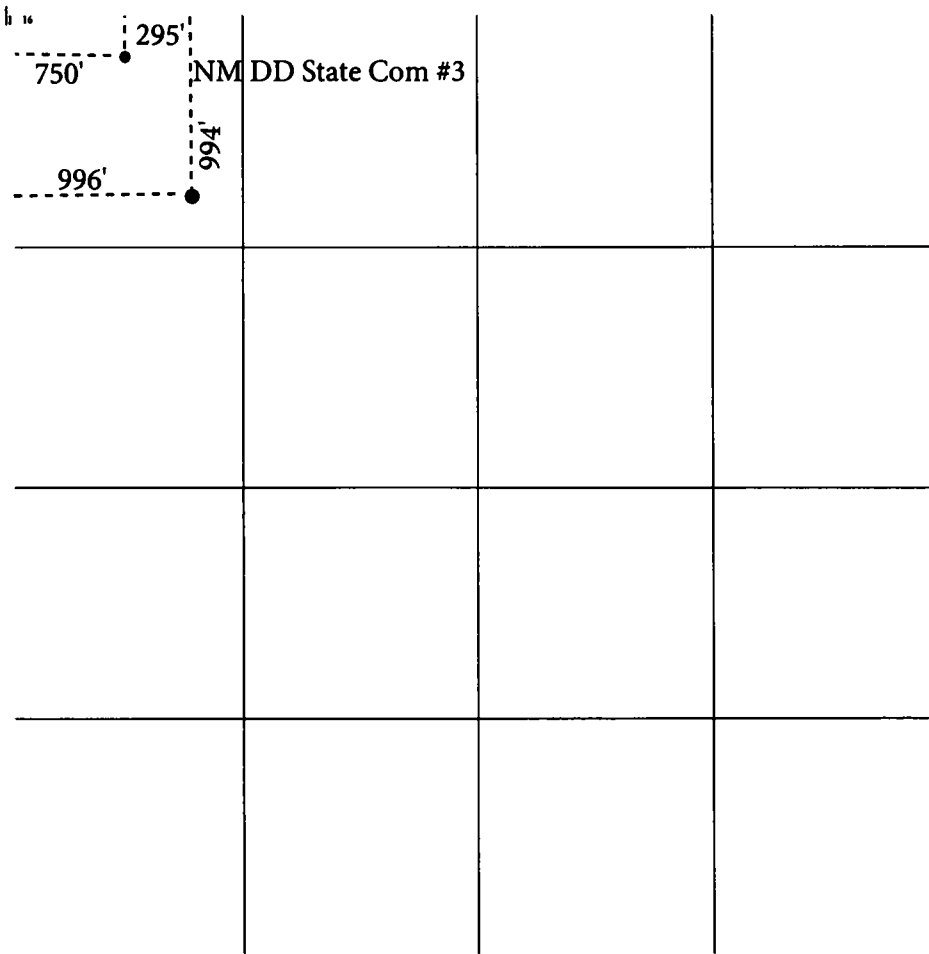

**<sup>17</sup> OPERATOR CERTIFICATION**

I hereby certify that the information contained herein is true and complete to the best of my knowledge and belief, and that this organization either owns a working interest or unleased mineral interest in the land including the proposed bottom hole location or has a right to drill this well at this location pursuant to a contract with an owner of such a mineral or working interest, or to a voluntary pooling agreement or a compulsory pooling order heretofore entered by the division.

*Amithy Crawford* 7/11/2018  
Signature Date

Amithy Crawford  
Printed Name

acrawford@cimarex.com  
E-mail Address

**<sup>18</sup> SURVEYOR CERTIFICATION**

I hereby certify that the well location shown on this plat was plotted from field notes of actual surveys made by me or under my supervision, and that the same is true and correct to the best of my belief.

Date of Survey  
Signature and Seal of Professional Surveyor:

Certificate Number