

District I  
1625 N. French Dr., Hobbs, NM 88240  
District II  
811 S. First St., Artesia, NM 88210  
District III  
1000 Rio Brazos Road, Aztec, NM 87410  
District IV  
1220 S. St. Francis Dr., Santa Fe, NM 87505

State of New Mexico  
Energy, Minerals and Natural Resources Department  
Oil Conservation Division  
1220 South St. Francis Dr.  
Santa Fe, NM 87505

Submit Original  
to Appropriate  
District Office

**NM OIL CONSERVATION  
ARTESIA DISTRICT**

DEC 14 2018

**GAS CAPTURE PLAN**

Date: 8-14-2018

**RECEIVED**

☒ Original

Operator & OGRID No.: OXY USA INC. - 16696

☐ Amended - Reason for Amendment: \_\_\_\_\_

This Gas Capture Plan outlines actions to be taken by the Operator to reduce well/production facility flaring/venting for new completion (new drill, recomple to new zone, re-frac) activity.

*Note: Form C-129 must be submitted and approved prior to exceeding 60 days allowed by Rule (Subsection A of 19.15.18.12 NMAC).*

**Well(s)/Production Facility – Name of facility**

The well(s) that will be located at the production facility are shown in the table below.

Well Name	API	Well Location (ULSTR)	Footages	Expected MCF/D	Flared or Vented	Comments
Length CC 6_7 Fed Com #21H	Pending	4-6-24S-29E	516 N 731 W	8,210	0	
Length CC 6_7 Fed Com #22H	Pending	4-6-24S-29E	548 N 744 W	8,210	0	
Length CC 6_7 Fed Com #23H	Pending	3-6-24S-29E	410 N 2355 W	6,804	0	30-015-45551
Length CC 6_7 Fed Com #24H	Pending	3-6-24S-29E	410 N 2390 W	6,804	0	
Length CC 6_7 Fed Com #25H	Pending	1-6-24S-29E	65 N 1076 E	6,804	0	
Length CC 6_7 Fed Com #26H	Pending	1-6-24S-29E	65 N 971 E	6,804	0	

**Gathering System and Pipeline Notification**

Well(s) will be connected to a production facility after flowback operations are complete, where a gas transporter system is in place. The gas produced from production facility is dedicated to Enterprise Field Services, LLC ("Enterprise") and is connected to Enterprise high pressure gathering system located in Eddy County, New Mexico. OXY USA INC. ("OXY") provides (periodically) to Enterprise a drilling, completion and estimated first production date for wells that are scheduled to be drilled in the foreseeable future. In addition, OXY and Enterprise have periodic conference calls to discuss changes to drilling and completion schedules. Gas from these wells will be processed at Orla Plant Processing Plant located in Sec. 35, Block 57, T2, T&P RR CO, Reeves, County, Texas. The actual flow of the gas will be based on compression operating parameters and gathering system pressures.

**Flowback Strategy**

After the fracture treatment/completion operations, well(s) will be produced to temporary production tanks and gas will be flared or vented. During flowback, the fluids and sand content will be monitored. When the produced fluids contain minimal sand, the wells will be turned to production facilities. Gas sales should start as soon as the wells start flowing through the production facilities, unless there are operational issues on Enterprise system at that time. Based on current information, it is OXY's belief the system can take this gas upon completion of the well(s).

Safety requirements during cleanout operations from the use of underbalanced air cleanout systems may necessitate that sand and non-pipeline quality gas be vented and/or flared rather than sold on a temporary basis.

**Alternatives to Reduce Flaring**

Below are alternatives considered from a conceptual standpoint to reduce the amount of gas flared.

- Power Generation – On lease
  - Only a portion of gas is consumed operating the generator, remainder of gas will be flared
- Compressed Natural Gas – On lease
  - Gas flared would be minimal, but might be uneconomical to operate when gas volume declines
- NGL Removal – On lease
  - Plants are expensive, residue gas is still flared, and uneconomical to operate when gas volume declines

SECTIONS 6 & 7, TOWNSHIP 24 SOUTH, RANGE 29 EAST, N.M.P.M.,  
EDDY COUNTY  
NEW MEXICO

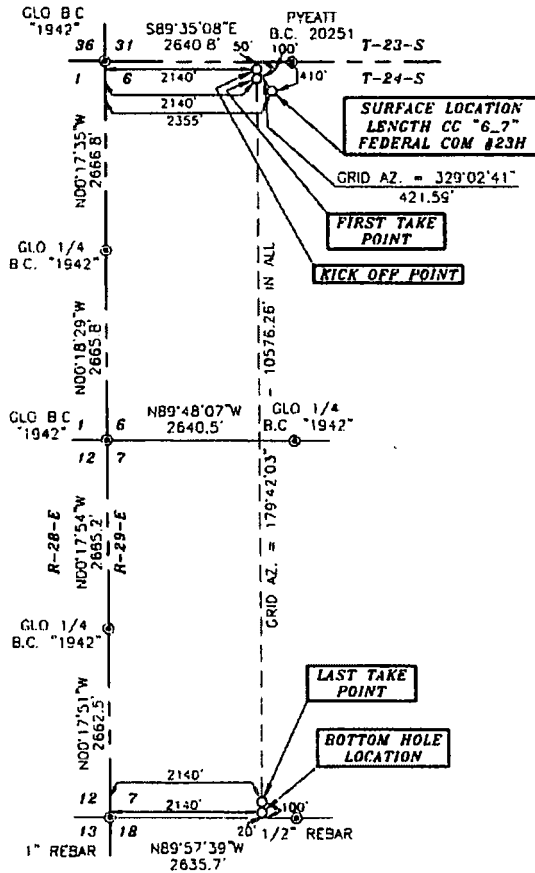

DRIVING DIRECTIONS.  
FROM THE INTERSECTION OF U.S. HWY #285  
AND COUNTY ROAD #731 (ONSUREZ ROAD) IN  
MALAGA, GO NORTH ON COUNTY ROAD #731  
FOR 0.6 MILES. TURN RIGHT ON COUNTY  
ROAD #743 (BRUMBLE ROAD) AND GO EAST  
FOR 1.0 MILES, CONTINUE EAST ON COUNTY  
ROAD #745 (HARROUN ROAD) FOR 2.0 MILES,  
TURN LEFT AND GO NORTH FOR 0.6 MILES,  
TURN RIGHT AND GO EAST FOR 0.2 MILES,  
TURN RIGHT ON PROPOSED ROAD AND GO  
SOUTH FOR 197.4 FEET TO LOCATION.



**SURVEYORS CERTIFICATE**

I, TERRY J. ASEL, NEW MEXICO PROFESSIONAL SURVEYOR  
NO. 15079, DO HEREBY CERTIFY THAT I CONDUCTED AND AM  
RESPONSIBLE FOR THIS SURVEY, THAT THIS SURVEY IS  
TRUE AND CORRECT TO THE BEST OF MY KNOWLEDGE AND  
BELIEF, AND MEETS THE "MINIMUM STANDARDS FOR  
SURVEYING IN NEW MEXICO" AS ADOPTED BY THE NEW  
MEXICO STATE BOARD OF REGISTRATION FOR  
PROFESSIONAL ENGINEERS AND SURVEYORS.

*Terry J. Asel* 8/6/2018  
Terry J. Asel, N.M. R.P.L.S. No. 15079

Asel Surveying

P.O. BOX 392 - 310 W TAYLOR  
HOBBS, NEW MEXICO - 575-393-9146



**LEGEND**

⊙ - DENOTES FOUND MONUMENT AS NOTED

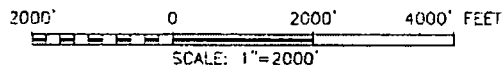

**OXY USA INC.**

LENGTH CC "6.7" FEDERAL COM #23H  
LOCATED AT 410' FNL & 2355' FWL IN  
SECTION 6, TOWNSHIP 24 SOUTH, RANGE 29  
EAST, N.M.P.M., EDDY COUNTY, NEW MEXICO

Survey Date: 06/27/18	Sheet 1 of 1 Sheets
W.O. Number: 180627WL-b	Drawn By: KA Rev:
Date: 08/06/18	180627WL-b Scale: 1"=2000'

Survey of Bearings - GPS Coordinates Measurements  
NAD East Zone (83) North American Datum of 1983