

District I
1625 N. French Dr., Hobbs, NM 88240
District II
1301 W. Grand Avenue, Artesia, NM 88210
District III
1000 Rio Brazos Road, Aztec, NM 87410
District IV
1220 S. St. Francis Dr., Santa Fe, NM 87505

State of New Mexico
Energy Minerals and Natural Resources

Form C-144
March 12, 2004

Oil Conservation Division
1220 South St. Francis Dr.
Santa Fe, NM 87505

For drilling and production facilities, submit to
appropriate NMOCD District Office.
For downstream facilities, submit to Santa Fe
office

105 South Fourth Street, Artesia, NM 88210

Pit or Below-Grade Tank Registration or Closure

Is pit or below-grade tank covered by a "general plan"? Yes ☒ CheckBox1

Type of action: Registration of a pit or below-grade tank ☒ Closure of a pit or below-grade tank ☐

Operator: Yates Petroleum Corporation Telephone: 505-748-4376 e-mail address: debblec@yopcnm.com

Address: 104 South 4th Street, Artesia, New Mexico 88210

Facility or well name: Getty PS 7 Federal #4 API #: 30-005-63645 U/L or Qtr/Qtr NESE Sec 7 T 6S R 26E

County: Chaves Latitude Longitude NAD: 1927 ☐ 1983 ☐ Surface Owner: Federal ☒ State ☐ Private ☐ Indian ☐

Pit

Type: Drilling ☒ Production ☐ Disposal ☐

Workover ☐ Emergency ☐

Lined ☒ Unlined ☐

Liner type: Synthetic ☒ Thickness 12 mil Clay ☐ Volume
bbl

Below-grade tank

Volume: bbl Type of fluid:

Construction material:

Double-walled, with leak detection? Yes ☐ If not, explain why not.

RECEIVED

OCT 26 2004

900-ARTESIA

Depth to ground water (vertical distance from bottom of pit to seasonal high
water elevation of ground water.)

Less than 50 feet

(20 points)

50 feet or more, but less than 100 feet

(10 points)

100 feet or more

(0 points)

Wellhead protection area: (Less than 200 feet from a private domestic
water source, or less than 1000 feet from all other water sources.)

Yes

(20 points)

No

(0 points)

Distance to surface water: (horizontal distance to all wetlands, playas,
irrigation canals, ditches, and perennial and ephemeral watercourses.)

Less than 200 feet

(20 points)

200 feet or more, but less than 1000 feet

(10 points)

1000 feet or more

(0 points)

Ranking Score (Total Points)

10

If this is a pit closure: (1) attach a diagram of the facility showing the pit's relationship to other equipment and tanks. (2) Indicate disposal location:

onsite ☐ offsite ☐ If offsite, name of facility (3) Attach a general description of remedial action taken including remediation start date and end date. (4) Groundwater encountered: No ☐ Yes ☐ If yes, show depth below ground surface ft. and attach sample results. (5) Attach soil sample results and a diagram of sample locations and excavations.

I hereby certify that the information above is true and complete to the best of my knowledge and belief. I further certify that the above-described pit or below-grade tank has been/will be constructed or closed according to NMOCD guidelines ☐, a general permit ☒, or an (attached) alternative OCD-approved plan ☐.

Date: 10/26/2004

Printed Name/Title Robert Asher/Regulatory Agent

Signature

Your certification and NMOCD approval of this application/closure does not relieve the operator of liability should the contents of the pit or tank contaminate ground water or otherwise endanger public health or the environment. Nor does it relieve the operator of its responsibility for compliance with any other federal, state, or local laws and/or regulations.

Approval

Date: OCT 27 2004

Printed Name/Title

Signature



United States Department of the Interior
BUREAU OF LAND MANAGEMENT
Roswell Field Office
2909 West Second Street
Roswell, New Mexico 88201

EXHIBIT A

Operator: Yates Petroleum Corporation
BLM Serial Number: NM-54988
Well Name & NO.: Getty "PS" 7 Federal #4
Location: Section 7, T. 6 S., R. 26 E.
1930' FSL & 860' FEL, Chaves County, N.M.

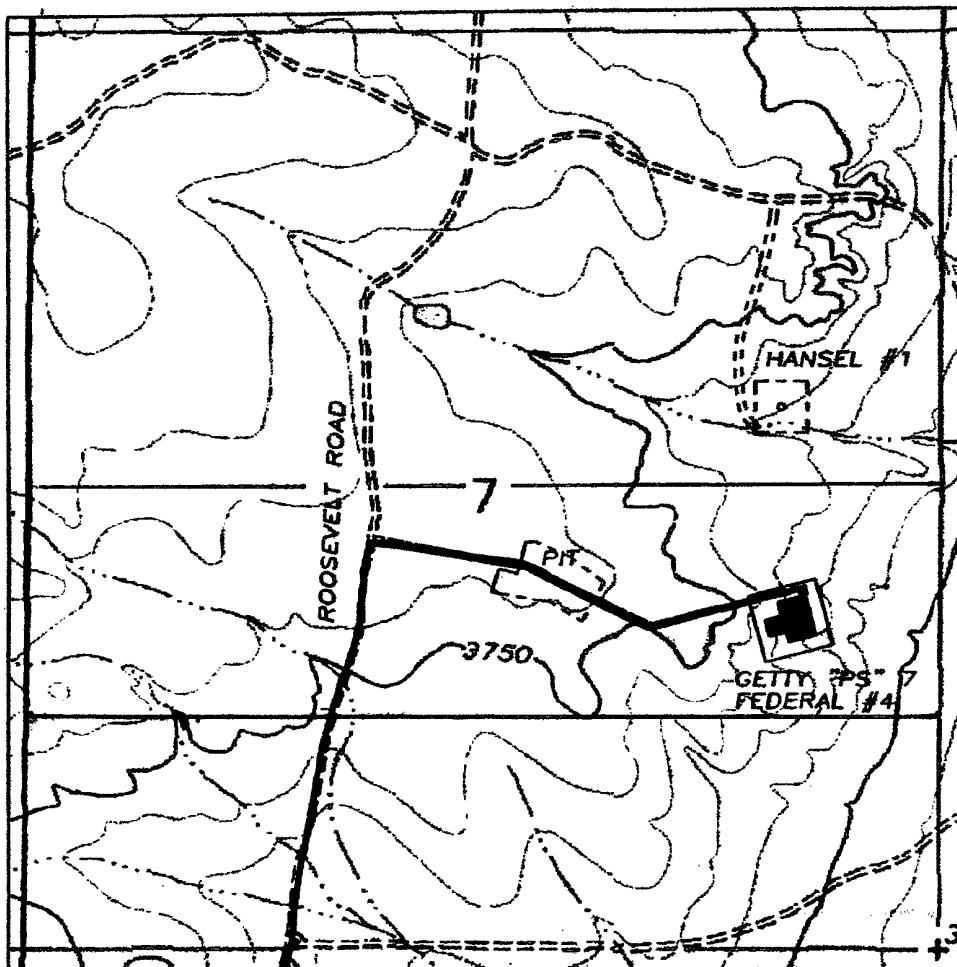

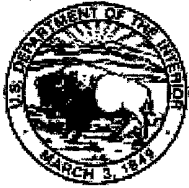

United States Department of the Interior
BUREAU OF LAND MANAGEMENT
Roswell Field Office
2909 West Second Street
Roswell, New Mexico 88201

EXHIBIT B

WELL DRILLING REQUIREMENTS

1 of 5 pages

OPERATORS NAME: Yates Petroleum Corporation LEASE NO.: NM-54988
WELL NAME & NO: Getty "PS" 7 Federal #4
QUARTER/QUARTER & FOOTAGE: NE¼SE¼ - 1930' FSL & 860' FEL
LOCATION: Section 7, T. 6 S., R. 26 E., NMPM
COUNTY: Chaves County, New Mexico

I. GENERAL PROVISIONS:

- A. The operator has the right of administrative review of these requirements pursuant to 43 CFR 3165.1(a).
- B. The operator shall hereafter be identified as the holder in these requirements. The Authorized Officer is the person who approves the Well Drilling Requirements.

II. WELL PAD CONSTRUCTION REQUIREMENTS:

- A. The BLM shall administer compliance and monitor construction of the access road and well pad. Notify Richard G. Hill at least 3 working days (72 Hours) prior to commencing construction of the access road and/or well pad. Roswell Field Office number (505) 627-0247.
- B. Prior to commencing construction of the access road, well pad, or other associated developments, the holder shall provide the dirt contractor with a copy of the approved APD signature page, a copy of the location map (EXHIBIT A), a copy of pages 1 & 2 from the Well Drilling Requirements (EXHIBIT B), and a copy of the Permanent Resource Road Requirements (EXHIBIT D).
- C. The holder shall stockpile the topsoil from the surface of the well pad. The topsoil on the Getty "PS" 7 Federal #4 well pad is approximate 6 inches in depth. Approximately 800 cubic yards of topsoil shall be stockpiled on the Southeast corner of the well pad, opposite the reserve pit.
- D. **Reserve Pit Requirements:**
 - 1. The reserve pit shall be constructed 100' X 100' on the **West/Southwest** side of the well pad.
 - 2. The reserve pit shall be constructed to a minimum depth of four (4) feet below ground level. The reserve pit shall be constructed, so that the cuttings in the reserve pit can be buried a minimum depth of three (3) feet below ground level. See Exhibit E – Surface Reclamation/Restoration Requirements.

3. A synthetic or fabricated liner 12 mil in thickness shall be used to line the reserve pit. The liner shall meet ASTM standards that are designed to be resistant to the reserve pit contents.
4. The reserve pit shall be fenced on three (3) sides during drilling operations. The fourth side shall be fenced immediately upon rig release.
5. The reserve pit shall be constructed so as not to leak, break, or allow discharge of drilling muds. Under no circumstances will the reserve pit be cut to drain drilling muds on the well location.
6. The reserve pit shall not be located in any natural drainage.
7. The reserve pit shall be equipped to deter entry by birds, bats, other wildlife and livestock, if the reserve pit contains any oil and/or toxic fluids.
8. Drilling muds shall be properly disposed of before the reserve pit is reclaimed. Drilling muds can be allowed to evaporate in the reserve pit or be removed and transported to an authorized disposal site. The reserve pit shall be backfilled when dry.
9. Dumping of junk or trash into the reserve pit is not allowed. Junk or trash shall be removed from within the reserve pit before the reserve pit is reclaimed. **Junk or trash shall not be buried in the reserve pit.**

E. Federal Mineral Materials Pit Requirements:

1. Caliche, gravel, or other related materials from new or existing pits on Federal mineral estate shall not be taken without prior approval from the authorized officer. Contact Jerry Dutchover at (505) 627 -0236.
2. Payment for any Federal mineral materials that will be used to surface the access road and the well pad is required prior to removal of the mineral materials.
3. Mineral Materials extracted during construction of the reserve pit may be used for development of the pad and access road as needed, for the Getty "PS" 7 Federal #4 gas well only. Removal of any additional material on location must be purchased from BLM prior to removal of any material.
 - a. An optional mineral material pit may be constructed within the archaeologically cleared area. The mineral material removed in the process can be used for pad and access road construction. However, a mineral material sales contract must be purchased from the BLM prior to removal of any material.

F. Well Pad Surfacing Requirement:

The well pad shall be surfaced with 6 inches of compacted caliche, gravel, or other approved surfacing material. The well pad shall be surfaced prior to drilling operations. See Permanent Resource Road Requirements - EXHIBIT D - requirement #4, for road surfacing.

G. Cave Requirements:

1. If, during any construction activities any sinkholes or cave openings are discovered, all construction activities shall immediately cease. Contact Bill Murry at (505) 627-0220.
2. The BLM Authorized Officer will, within 24 hours of notification in "A" above, conduct an on-the-ground field inspection for karst. At the field inspection the authorized field inspector will authorize or suggest mitigating measures to lessen the damage to the karst environment. A verbal order to proceed or stop the operation will be issued at that time.

WELL DRILLING REQUIREMENTS

3 of 5 pages

III. WELL SUBSURFACE REQUIREMENTS:

A. GENERAL DRILLING REQUIREMENTS:

1. The Bureau of Land Management (BLM) is to be notified at the Roswell Field Office, 2909 West Second St., Roswell NM 88201, (505) 627-0272, in sufficient time for a representative to witness:

A. Spudding B. Cementing casing: 11¾ inch 8% inch 5½ inch C. BOP tests

2. Unless the production casing has been run and cemented or the well has been properly plugged, the drilling rig shall not be removed from over the hole without prior approval.

3. Submit a Sundry Notice (Form 3160-5, one original and five copies) for each casing string, describing the casing and cementing operations. Include pertinent information such as; spud date, hole size, casing (size, weight, grade and thread type), cement (type, quantity and top), water zones and problems or hazards encountered. The Sundry shall be submitted within 15 days of completion of each casing string. The reports may be combined into the same Sundry if they fall within the same 15 day time frame.

4. The API No. assigned to the well by NMOCD shall be included on the subsequent report of setting the first casing string.

B. CASING:

1. The 11¾ inch surface casing shall be set at 925' and cement circulated to the surface. If cement does not circulate to the surface the appropriate BLM office shall be notified and a temperature survey or cement bond log shall be run to verify the top of the cement. Remedial cementing shall be completed prior to drilling out that string.

2. The minimum required fill of cement behind the 8% inch intermediate casing if run is with sufficient amount of cement bring it up at least 200 above shoe.

3. The minimum required fill of cement behind the 5½ inch production casing is cement shall extend upward a minimum of 500 feet above the uppermost perforation.

C. PRESSURE CONTROL:

1. All BOP systems and related equipment shall comply with well control requirements as described in Onshore Oil and Gas Order No. 2. The BOP and related equipment shall be installed and operational before drilling below the 11¾ inch casing shoe and shall be tested as described in Onshore Order No. 2. Any equipment failing to test satisfactorily shall be repaired or replaced.

2. Minimum working pressure of the blowout preventer and related equipment (BOPE) shall be 2000 psi.

3. The appropriate BLM office shall be notified in sufficient time for a representative to witness the tests.

\$ The results of the test shall be reported to the appropriate BLM office.

\$ Testing fluid must be water or an appropriate clear liquid suitable for sub-freezing temperatures. Use of drilling mud for testing is not permitted since it can mask small leaks.

\$ Testing must be done in a safe workman-like manner. Hard line connections shall be required.

\$ BOPE shall be tested before drilling into the Wolfcamp formation.

D. DRILLING MUD:

Mud system monitoring equipment, with derrick floor indicators and visual and audio alarms, shall be operating before drilling into the Wolfcamp formation, and shall be used until production casing is run and cemented. Monitoring equipment shall consist of the following:

\$ Recording pit level indicator to indicate volume gains and losses.

\$ Mud measuring device for accurately determining the mud volumes necessary to fill the hole during trips.

\$ Flow-sensor on the flow-line to warn of abnormal mud returns from the well.