

Submit To Appropriate District Office State Lease - 6 copies Fee Lease - 5 copies District I 1625 N. French Dr., Hobbs, NM 88240 District II 1301 W. Grand Avenue, Artesia, NM 88210 District III 1000 Rio Brazos Rd., Aztec, NM 87410 District IV 1220 S. St. Francis Dr., Santa Fe, NM 87505	State of New Mexico Energy, Minerals and Natural Resources <div style="font-size: 4em; opacity: 0.5; position: relative; top: -50px; left: -100px;">S</div> Oil Conservation Division 1112 So. St. Francis Dr. Santa Fe, NM 87505	Form C-105 Revised June 10, 2003 WELL API NO. : 30 015 33907
--	---	--

WELL COMPLETION OR RECOMPLETION REPORT AND LOG

1a. Type of Well: OIL WELL GAS WELL <input checked="" type="checkbox"/> DRY <input type="checkbox"/> OTHER <input type="checkbox"/> b. Type of Completion: NEW WORK <input type="checkbox"/> DEEPEN <input type="checkbox"/> PLUG <input type="checkbox"/> DIFF. WELL <input type="checkbox"/> OVER BACK RESVR. OTHER: DHC	7. Lease Name or Unit Agreement Name EKG Fee
2. Name of Operator: OGX Resources, LLC	8. Well No.: 1
3. Address of Operator P.O. Box 2064, Midland, TX 79702	9. Pool name or Wildcat: Strawn Gas

4. Well Location			
Unit Letter	EF	1980'	Feet From The
Section 29	Township 24S	Range 28E	Line and 1980' Feet From The
		NMPM	West Line
County Eddy			
10. Date Spudded 2-8-05	11. Date T.D. Reached 4-2-05	12. Date Compl. (Ready to Prod.) 5-23-06	13. Elevations (DF& RKB, RT, GR, etc.) 3049' GR
14. Elev. Casinghead			
15. Total Depth: 12,445'	16. Plug Back T.D.: 11,734'	17. If Multiple Compl. How Many Zones?	18. Intervals Drilled By
19. Producing Interval(s), of this completion - Top, Bottom, Name 11,504-11,630' - Strawn			20. Was Directional Survey Made No
21. Type Electric and Other Logs Run: GR/CCL			22. Was Well Cored: No

23. CASING RECORD (Report all strings set in well)					
CASING SIZE	WEIGHT LB. FT.	DEPTH SET	HOLE SIZE	CEMENTING RECORD	AMOUNT PULLED
13 3/8"	48#	650'	17 1/2"	700 sx	None
9 5/8"	36#	2490'	12 1/4"	750 sx	None
7 5/8"	39#	9736'	8 3/4"	850 sx	None

24. LINER RECORD				25. TUBING RECORD									
SIZE	TOP	BOTTOM	SACKS CEMENT	SCREEN	SIZE	DEPTH SET	PACKER SET						
5 1/2"	9430'	12,348'	360 sx		2 7/8"	10,950'							
26. Perforation record (interval, size, and number): 11,504-24, 11,560-70, 11,620-30 w/2 shots per ft. A to ke				27. ACID, SHOT, FRACTURE, CEMENT, SQUEEZE, ETC. <table border="1" style="width:100%; border-collapse: collapse;"> <tr> <th>DEPTH INTERVAL</th> <th>AMOUNT AND KIND MATERIAL USED</th> </tr> <tr> <td>11,504-11,630'</td> <td>4000 gals 15% HCL</td> </tr> <tr> <td></td> <td>283,000 gal frac w/190,000# sand</td> </tr> </table>				DEPTH INTERVAL	AMOUNT AND KIND MATERIAL USED	11,504-11,630'	4000 gals 15% HCL		283,000 gal frac w/190,000# sand
DEPTH INTERVAL	AMOUNT AND KIND MATERIAL USED												
11,504-11,630'	4000 gals 15% HCL												
	283,000 gal frac w/190,000# sand												

28. PRODUCTION							
Date First Production: 5.23-06		Production Method (Flowing, gas lift, pumping - Size and type pump) pumping			Well Status (Prod. or Shut-in) Producing		
Date of Test 6-20-06	Hours Tested 24	Choke Size	Prod'n For Test Period	Oil - Bbl 0.5	Gas - MCF 75	Water - Bbl. 0	Gas - Oil Ratio 150000
Flow Tubing Press.	Casing Pressure 850	Calculated 24-Hour Rate	Oil - Bbl.	Gas - MCF	Water - Bbl.	Oil Gravity - API - (Corr.)	
29. Disposition of Gas (Sold, used for fuel, vented, etc.)						Test Witnessed By	

30. List Attachments
 Logs & inclination previously submitted. C-104 attached.

Signature		Name : Ann E. Ritchie	Title: Regulatory Agent	Date: 12-7-06
E-mail Address: ann.ritchie@wtor.net				

INSTRUCTIONS

This form is to be filed with the appropriate District Office of the Division not later than 20 days after the completion of any newly-drilled or deepened well. It shall be accompanied by one copy of all electrical and radio-activity logs run on the well and a summary of all special tests

District I
1625 N. French Dr., Hobbs, NM 88240
District II
1301 W. Grand Avenue, Artesia, NM 88210
District III
1000 Rio Brazos Rd., Aztec, NM 87410
District IV
1220 S. St. Francis Dr., Santa Fe, NM 87505

State of New Mexico
Energy, Minerals & Natural Resources Department
OIL CONSERVATION DIVISION
1220 South St. Francis Dr.
Santa Fe, NM 87505

Form C-102
Revised October 12, 2005
Submit to Appropriate District Office
State Lease - 4 Copies
Fee Lease - 3 Copies

☐ AMENDED REPORT

WELL LOCATION AND ACREAGE DEDICATION PLAT

1 API Number 30 015 33907		2 Pool Code 84415		3 Pool Name Salt Draw, Atoka (Gas)	
4 Property Code 34546		5 Property Name EKG Fee			6 Well Number 1
7 OGRID No. 217955		8 Operator Name OGX Resources, LLC			9 Elevation 3049'

10 Surface Location

UL or lot no. F	Section 29	Township 24S	Range 38E 28E	Lot Idn	Feet from the 1980	North/South line North	Feet from the 1980	East/West line West	County Eddy
--------------------	---------------	-----------------	---------------------	---------	-----------------------	---------------------------	-----------------------	------------------------	----------------

11 Bottom Hole Location If Different From Surface

UL or lot no.	Section	Township	Range	Lot Idn	Feet from the	North/South line	Feet from the	East/West line	County
12 Dedicated Acres 320		13 Joint or Infill		14 Consolidation Code		15 Order No. Filed for DHC Form C-107A			

No allowable will be assigned to this completion until all interests have been consolidated or a non-standard unit has been approved by the division.

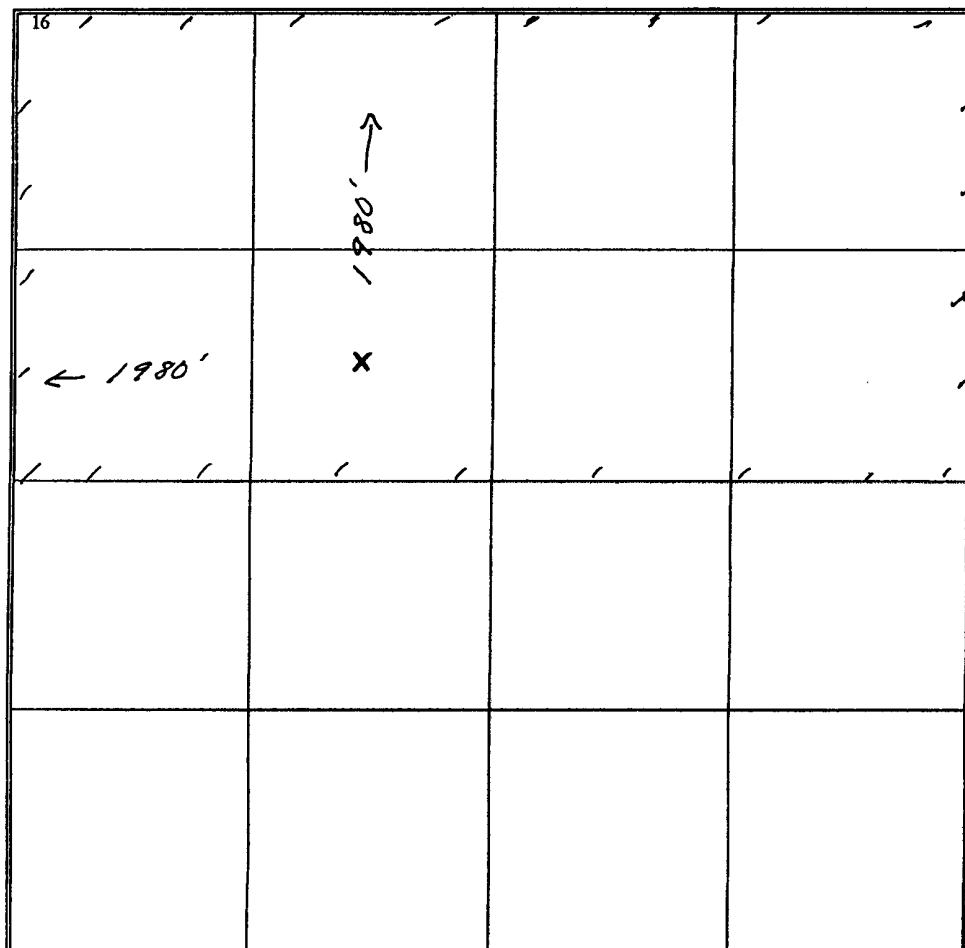
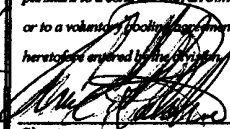
<div>16</div> 				17 OPERATOR CERTIFICATION <i>I hereby certify that the information contained herein is true and complete to the best of my knowledge and belief, and that this organization either owns a working interest or unleased mineral interest in the land including the proposed bottom hole location or has a right to drill this well at this location pursuant to a contract with an owner of such a mineral or working interest, or to a voluntary pooling agreement or a compulsory pooling order heretofore entered by the Division.</i> <div>Signature:  Date: 9-12-06</div> <div>Printed Name: Ann E. Ritchie, Regulatory Agent</div> <div>OGX Resources, LLC</div>	
				18 SURVEYOR CERTIFICATION <i>I hereby certify that the well location shown on this plat was plotted from field notes of actual surveys made by me or under my supervision, and that the same is true and correct to the best of my belief.</i> <div>Date of Survey</div> <div>Signature and Seal of Professional Surveyor</div> <div>Certificate Number</div>	

District I
1625 N. French Dr., Hobbs, NM 88240
District II
1301 W. Grand Avenue, Artesia, NM 88210
District III
1000 Rio Brazos Rd., Aztec, NM 87410
District IV
1220 S. St. Francis Dr., Santa Fe, NM 87505

State of New Mexico
Energy, Minerals & Natural Resources

Oil Conservation Division
1220 South St. Francis Dr.
Santa Fe, NM 87505

Form C-104
Revised June 10, 2003

Submit to Appropriate District Office
5 Copies

☐ AMENDED REPORT

I. REQUEST FOR ALLOWABLE AND AUTHORIZATION TO TRANSPORT

¹ Operator name and Address OGX Resources, LLC P.O. Box 2064 Midland, TX 79702		² OGRID Number: 217955
		³ Reason for Filing Code/ Effective Date DHC-3811
⁴ API Number 30 - 015 33907	⁵ Pool Name Salt Draw; Aiken	⁶ Pool Code 84415
⁷ Property Code:	⁸ Property Name EKG Fee	⁹ Well Number # 1

II. ¹⁰ Surface Location

UL or lot no. E	Section 29	Township 24S	Range 28E	Lot Idn	Feet from the 1980	North/South Line North	Feet from the 1980	East/West line West	County Eddy
--------------------	---------------	-----------------	--------------	---------	-----------------------	------------------------------	-----------------------	------------------------	----------------

¹¹ Bottom Hole Location

UL or lot no.	Section	Township	Range	Lot Idn	Feet from the	North/South line	Feet from the	East/West line	County
¹² Lse Code F	¹³ Producing Method Code P	¹⁴ Gas Connection Date 5-23-06	¹⁵ C-129 Permit Number	¹⁶ C-129 Effective Date	¹⁷ C-129 Expiration Date				

III. Oil and Gas Transporters

¹⁸ Transporter OGRID	¹⁹ Transporter Name and Address	²⁰ POD	²¹ O/G	²² POD ULSTR Location and Description
037627	Enterprise Prod. Op. P.O. Box 4324, Houston, TX 77210		G	Sec 29, T24S, R28E

IV. Produced Water

²³ POD	²⁴ POD ULSTR Location and Description
-------------------	--

V. Well Completion Data

²⁵ Spud Date 2-8-05	²⁶ Ready Date 5-23-06	²⁷ TD 12,445'	²⁸ PBDT 11,734'	²⁹ Perforations 11,504-11,630'	³⁰ DHC, MC DHC
³¹ Hole Size	³² Casing & Tubing Size	³³ Depth Set	³⁴ Sacks Cement		
17 1/2"	13 3/8"	650'	700 sx		
12 1/4"	9 5/8"	2490'	750 sx		
8 3/4"	7 5/8"	9736'	850 sx		
Liner	9430-12,348'	2 7/8" @ 10,950'			

VI. Well Test Data

³⁵ Date New Oil 5-23-06	³⁶ Gas Delivery Date 5-23-06	³⁷ Test Date 6-20-06	³⁸ Test Length 24	³⁹ Tbg. Pressure	⁴⁰ Csg. Pressure
⁴¹ Choke Size	⁴² Oil 0.5	⁴³ Water 0	⁴⁴ Gas 75	⁴⁵ AOF	⁴⁶ Test Method

⁴⁷ I hereby certify that the rules of the Oil Conservation Division have been complied with and that the information given above is true and complete to the best of my knowledge and belief.

Signature:

Printed name: Ann E. Ritchie

Title: Regulatory Agent

E-mail Address: ann.ritchie@wtor.net

Date: 12-7-06

Phone: 432 684-6381

OIL CONSERVATION DIVISION

Approved by:

BRYAN G. ARRANT

Title:

DISTRICT II GEOLOGIST

Approval Date:

MAR 08 2007

OGX Resources, LLC
 EKO Fee #1
 Well Bore Diagram
 8/15/2008

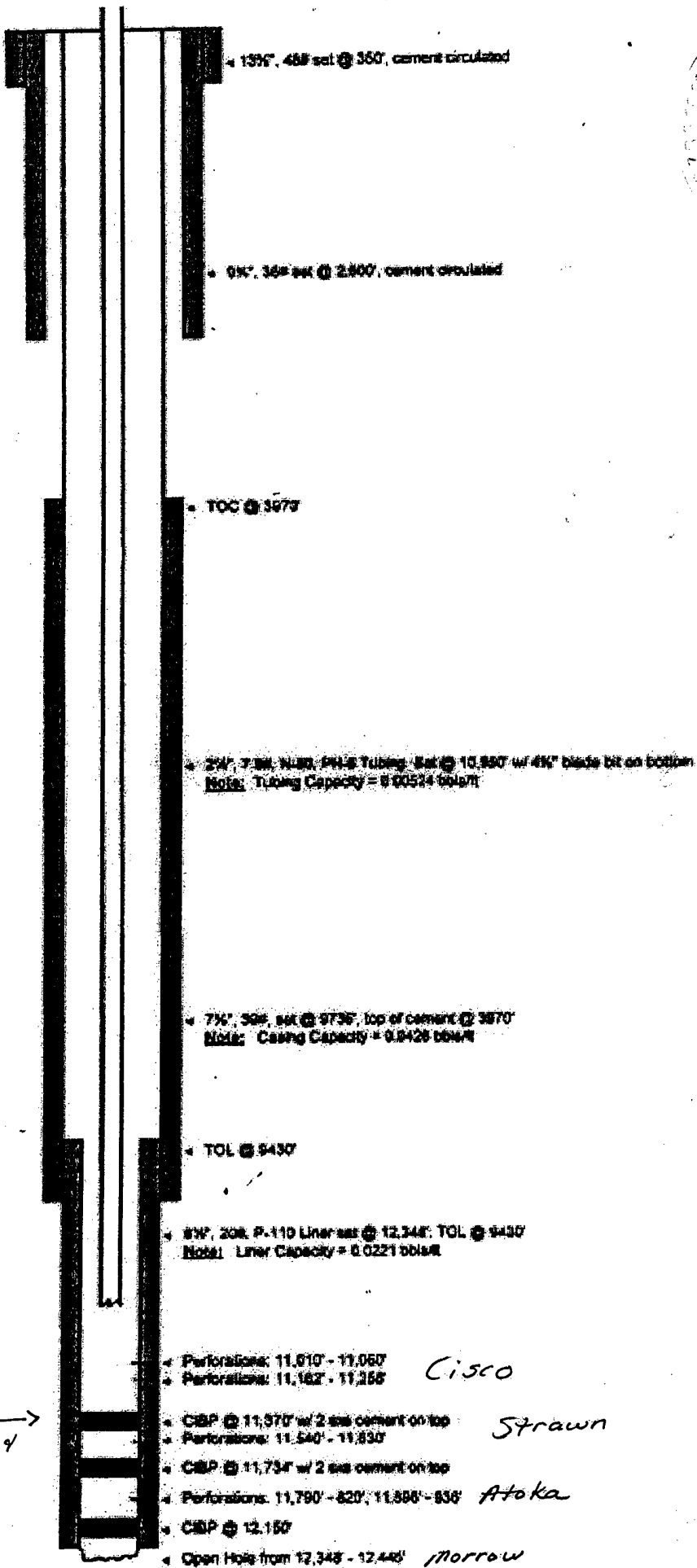

CIBP
 drilled out

Cisco

Strawn

Atoka

Morrow