

UNITED STATES
DEPARTMENT OF THE INTERIOR
BUREAU OF LAND MANAGEMENT

OCD-ARTESIA

AMENDED

FORM APPROVED
OMB No. 1004-0137
Expires March 31, 2007

SUNDRY NOTICES AND REPORTS ON WELLS

Do not use this form for proposals to drill or to re-enter an
abandoned well. Use Form 3160-3 (APD) for such proposals.5 Lease Serial No
NMLC069627

6 If Indian, Allottee or Tribe Name

7. If Unit or CA/Agreement, Name and/or No
NMNM710168 Well Name and No
POKER LAKE UNIT #2279 API Well No
30-015-3392910. Field and Pool, or Exploratory Area
NASH DRAW - DELAWARE11 County or Parish, State
EDDY
NM

SUBMIT IN TRIPLICATE - Other instructions on reverse side.

1 Type of Well
☒ Oil Well ☐ Gas Well ☐ Other

NOV 01 2007

2 Name of Operator
BEPCO, L.P.

OCD-ARTESIA

3a Address
P O BOX 2760 MIDLAND TX 79702-27603b Phone No (include area code)
(432)683-2277

4 Location of Well (Footage, Sec., T., R., M., or Survey Description)

SEC 30, T24S, R30E, SESE UL P, 330' FSL & 560' FEL
32 10559 N LAT 103.54501 W LON

12. CHECK APPROPRIATE BOX(ES) TO INDICATE NATURE OF NOTICE, REPORT, OR OTHER DATA

TYPE OF SUBMISSION	TYPE OF ACTION			
<input checked="" type="checkbox"/> Notice of Intent	<input type="checkbox"/> Acidize	<input type="checkbox"/> Deepen	<input type="checkbox"/> Production (Start/Resume)	<input type="checkbox"/> Water Shut-Off
<input type="checkbox"/> Subsequent Report	<input type="checkbox"/> Alter Casing	<input type="checkbox"/> Fracture Treat	<input type="checkbox"/> Reclamation	<input type="checkbox"/> Well Integrity
<input type="checkbox"/> Final Abandonment Notice	<input type="checkbox"/> Casing Repair	<input type="checkbox"/> New Construction	<input type="checkbox"/> Recomplete	<input checked="" type="checkbox"/> Other COMMINGLING
	<input type="checkbox"/> Change Plans	<input type="checkbox"/> Plug and Abandon	<input type="checkbox"/> Temporarily Abandon	& OFF LEASE
	<input type="checkbox"/> Convert to Injection	<input type="checkbox"/> Plug Back	<input type="checkbox"/> Water Disposal	STORAGE

13 Describe Proposed or Completed Operation (clearly state all pertinent details, including estimated starting date of any proposed work and approximate duration thereof. If the proposal is to deepen directionally or recomplete horizontally, give subsurface locations and measured and true vertical depths of all pertinent markers and zones. Attach the Bond under which the work will be performed or provide the Bond No. on file with BLM/BIA. Required subsequent reports shall be filed within 30 days following completion of the involved operations. If the operation results in a multiple completion or recompletion in a new interval, a Form 3160-4 shall be filed once testing has been completed. Final Abandonment Notices shall be filed only after all requirements, including reclamation, have been completed, and the operator has determined that the site is ready for final inspection.)

BEPCO, L.P. respectfully requests permission for Surface Commingling and Off Lease Storage to the referenced well from the Horned Toad 36 state #2H located 220' FNL & 2410' FEL, Sec 36, T24S, R29E, API No. 30-015-35837. The Poker Lake Unit Battery 227 currently has a commingling permit, PCL-275, which allows commingling with the Horned Toad 36 State #1 and #7 wells. BEPCO will lay a 2-7'8" steel flowline that will be laid within 30' of the center line of the existing lease road. A 3 phase separator will be installed at the 227 battery. The existing power line consisting of 12, 470 volts 3 phase, running from the Horned Toad 36 State #7 well, will be utilized. The Oil, Water and Casinghead Gas will be metered separately from the production on BLM land. A copy of OCD form C-107-B (Application for Surface Commingling) is attached, as is a previously filed 3160-5 which erroneously shows the Horned Toad 36 State 2H as the federal well.

APPROVED

OCT 30 2007

SUBJECT TO LIKE
APPROVAL BY STATE14 I hereby certify that the foregoing is true and correct.
Name (Printed/Typed)ANN MOORE LES BABYAK
PETROLEUM ENGINEER

Title PRODUCTION CLERK

Signature

Date 10/23/2007

THIS SPACE FOR FEDERAL OR STATE OFFICE USE

Approved by

Title

Date

Conditions of approval, if any, are attached. Approval of this notice does not warrant or certify that the applicant holds legal or equitable title to those rights in the subject lease which would entitle the applicant to conduct operations thereon.

Office

Title 18 U.S.C. Section 1001 and Title 43 U.S.C. Section 1212, make it a crime for any person knowingly and willfully to make to any department or agency of the United States any false, fictitious or fraudulent statements or representations as to any matter within its jurisdiction.

(Instructions on page 2)

District I
1625 N. French Drive, Hobbs, NM 88240
District II
1301 W. Grand Ave, Artesia, NM 88210
District III
1000 Rio Brazos Road, Aztec, NM 87410
District IV
1220 S. St Francis Dr, Santa Fe, NM
87505

State of New Mexico
Energy, Minerals and Natural Resources Department

Form C-107-B
Revised June 10, 2003

OIL CONSERVATION DIVISION
1220 S. St Francis Drive
Santa Fe, New Mexico 87505

Submit the original
application to the Santa Fe
office with one copy to the
appropriate District Office.

APPLICATION FOR SURFACE COMMINGLING (DIVERSE OWNERSHIP)

OPERATOR NAME: BEPCO, L.P.

OPERATOR ADDRESS: P.O. BOX 2760 MIDLAND, TX 79702-2760

APPLICATION TYPE:

☐ Pool Commingling ☒ Lease Commingling ☐ Pool and Lease Commingling ☐ Off-Lease Storage and Measurement (Only if not Surface Commingling)

LEASE TYPE: ☐ Fee ☒ State ☐ Federal

Is this an Amendment to existing Order? ☒ Yes ☐ No If #Yes#, please include the appropriate Order No. PLC-275

Have the Bureau of Land Management (BLM) and State Land office (SLO) been notified in writing of the proposed commingling

☒ Yes ☐ No

(A) POOL COMMINGLING

Please attach sheets with the following information

(1) Pool Names and Codes	Gravities / BTU of Non-Commingled Production	Calculated Gravities / BTU of Commingled Production		Calculated Value of Commingled Production	Volumes

(2) Are any wells producing at top allowables? ☐ Yes ☐ No

(3) Has all interest owners been notified by certified mail of the proposed commingling? ☐ Yes ☐ No.

(4) Measurement type: ☐ Metering ☐ Other (Specify)

(5) Will commingling decrease the value of production? ☐ Yes ☐ No If #yes#, describe why commingling should be approved

(B) LEASE COMMINGLING

Please attach sheets with the following information

(1) Pool Name and Code.

(2) Is all production from same source of supply? ☒ Yes ☐ No

(3) Has all interest owners been notified by certified mail of the proposed commingling? ☐ Yes ☒ No 100% BEPCO Ownership

(4) Measurement type: ☒ Metering ☐ Other (Specify)

(C) POOL and LEASE COMMINGLING

Please attach sheets with the following information

(1) Complete Sections A and E.

(D) OFF-LEASE STORAGE and MEASUREMENT

Please attached sheets with the following information

(1) Is all production from same source of supply? ☐ Yes ☐ No

(2) Include proof of notice to all interest owners.

(E) ADDITIONAL INFORMATION (for all application types)

Please attach sheets with the following information

(1) A schematic diagram of facility, including legal location.

(2) A plat with lease boundaries showing all well and facility locations Include lease numbers if Federal or State lands are involved.

(3) Lease Names, Lease and Well Numbers, and API Numbers.

I hereby certify that the information above is true and complete to the best of my knowledge and belief.

SIGNATURE: Ann Moore TITLE: PRODUCTION CLERK

DATE: 10/11/2007

TYPE OR PRINT NAME ANN MOORE

TELEPHONE NO.: (432)683-2277

E-MAIL ADDRESS: camoorebasspet.com

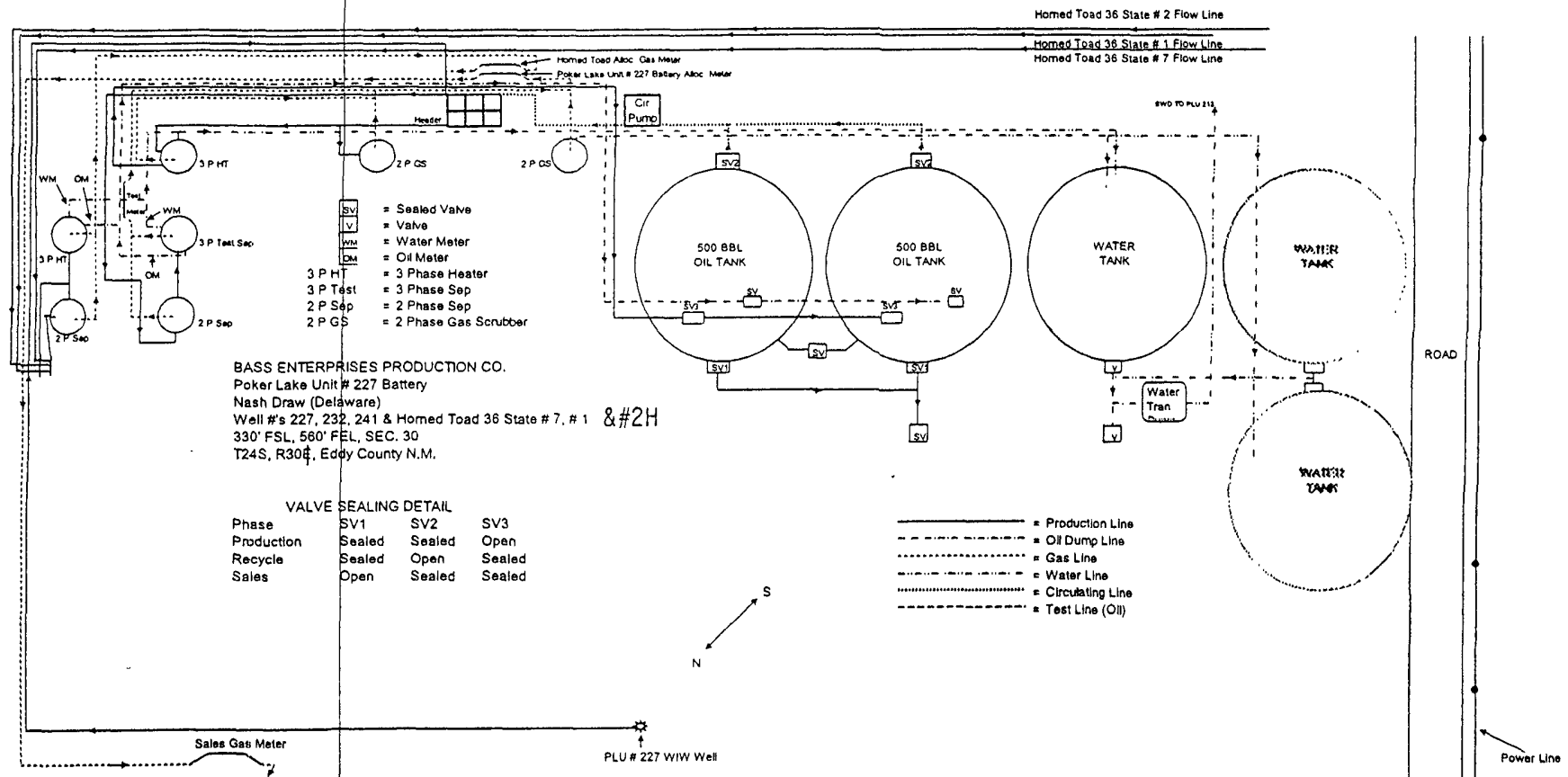

DISTRICT I

1825 N. French Dr., Hobbs, NM 88240

DISTRICT II

811 South First, Artesia, NM 88210

DISTRICT III

1000 Rio Brazos Rd., Ariceo, NM 87410

DISTRICT IV

2040 South Pacheco, Santa Fe, NM 87505

State of New Mexico

Energy, Minerals and Natural Resources Department

Form C-102

Revised March 17, 1999

Submit to Appropriate District Office

State Lease - 4 Copies

Fee Lease - 3 Copies

OIL CONSERVATION DIVISION

2040 South Pacheco

Santa Fe, New Mexico 87504-2088

☐ AMENDED REPORT

WELL LOCATION AND ACREAGE DEDICATION PLAT

API Number 30-015-33929	Pool Code 47545	Pool Name NASH DRAW - DELAWARE
Property Code 001796	Property Name POKER LAKE UNIT	Well Number 227
OGRID No. 001801	Operator Name BASS ENTERPRISES PRODUCTION COMPANY	Elevation 3218'

Surface Location

UL or lot No.	Section	Township	Range	Lot Idn	Feet from the	North/South line	Feet from the	East/West line	County
P	30	24 S	30 E		330	SOUTH	560	EAST	EDDY

Bottom Hole Location If Different From Surface

UL or lot No.	Section	Township	Range	Lot Idn	Feet from the	North/South line	Feet from the	East/West line	County
Dedicated Acres 40	Joint or Infill I	Consolidation Code	Order No.						

NO ALLOWABLE WILL BE ASSIGNED TO THIS COMPLETION UNTIL ALL INTERESTS HAVE BEEN CONSOLIDATED
OR A NON-STANDARD UNIT HAS BEEN APPROVED BY THE DIVISION

LOT 1 40.62 acres	40.62 acres	40.72 acres	40.72 acres
LOT 2 40.63 acres	40.63 acres	40.71 acres	40.71 acres
LOT 3 40.65 acres	40.65 acres	40.69 acres	40.69 acres
LOT 4 40.66 acres	40.66 acres	40.68 acres	40.68 acres

LAT - N32°10'55.9"
 LONG - W103°54'50.1"

3212.0
 560'

3221.1
 560'

OPERATOR CERTIFICATION

I hereby certify the the information contained herein is true and complete to the best of my knowledge and belief.

William R. Dannels
Signature

W.R. DANNELS
Printed Name

DMSION DRILLING SUPT.
Title

12/28/04
Date

SURVEYOR CERTIFICATION

I hereby certify that the well location shown on this plat was plotted from field notes of actual surveys made by me or under my supervision and that the same is true or correct to the best of my belief.

NOVEMBER 24, 2004
Date Surveyed

Signature of Seal of Professional Surveyor
Professional Surveyor

NEW MEXICO
W.O. No. 47835
Certificate No. Gory L. Jones 79