

District I  
1625 N French Dr., Hobbs, NM 88240  
District II  
1301 W Grand Avenue, Artesia, NM 88210  
District III  
1000 Rio Brazos Road, Aztec, NM 87410  
District IV  
1220 S. St. Francis Dr., Santa Fe, NM 87505

State of New Mexico  
Energy Minerals and Natural Resources

Form C-144  
June 1, 2004

Oil Conservation Division  
1220 South St. Francis Dr.  
Santa Fe, NM 87505

For drilling and production facilities, submit to appropriate NMOCD District Office.  
For downstream facilities, submit to Santa Fe office

**Pit or Below-Grade Tank Registration or Closure**

Is pit or below-grade tank covered by a "general plan"? Yes  No

Type of action: Registration of a pit or below-grade tank  Closure of a pit or below-grade tank

Operator: COG Operating LLC Telephone: 432-685-4332 e-mail address: kcarrillo@conchoresources.com  
Address: Fasken Center Tower II, 550 W. Texas Ave, Suite 1300, Midland, TX 79701  
Facility or well name: GJ West Coop Unit #164 API # 30-015-35654 U/L or Qtr/Qtr: L Sec: 21 T: 17S R: 29E  
County: Eddy Latitude: 32.819039 deg. N Longitude: 104.084654 deg. W NAD: 1927  1983   
Surface Owner: Federal  State  Private  Indian

Pit	Below-grade tank	
Type: Drilling <input checked="" type="checkbox"/> Production <input type="checkbox"/> Disposal <input type="checkbox"/> Workover <input type="checkbox"/> Emergency <input type="checkbox"/> Lined <input checked="" type="checkbox"/> Unlined <input type="checkbox"/> Liner type: Synthetic <input checked="" type="checkbox"/> Thickness: 12 mil Clay <input type="checkbox"/> Pit Volume 30,000 bbl	Volume: ___ bbl Type of fluid: _____ Construction material: _____ Double-walled, with leak detection? Yes <input type="checkbox"/> If not, explain why not.	
Depth to ground water (vertical distance from bottom of pit to seasonal high water elevation of ground water.) 110'	Less than 50 feet (20 points) 50 feet or more, but less than 100 feet (10 points) 100 feet or more - X ( 0 points) 0	
Wellhead protection area: (Less than 200 feet from a private domestic water source, or less than 1000 feet from all other water sources.)	Yes (20 points) No - X ( 0 points) 0	
Distance to surface water: (horizontal distance to all wetlands, playas, irrigation canals, ditches, and perennial and ephemeral watercourses.)	Less than 200 feet (20 points) 200 feet or more, but less than 1000 feet (10 points) 1000 feet or more - X ( 0 points) 0	
	<b>Ranking Score (Total Points)</b>	0 points

**If this is a pit closure:** (1) Attach a diagram of the facility showing the pit's relationship to other equipment and tanks. (2) Indicate disposal location: (check the onsite box if you are burying in place) onsite  offsite  If offsite, name of facility \_\_\_\_\_. (3) Attach a general description of remedial action taken including remediation start date and end date (4) Groundwater encountered: No  Yes  If yes, show depth below ground surface \_\_\_\_\_ ft. and attach sample results.

(5) Attach soil sample results and a diagram of sample locations and excavations

Closed by trench burial, procedure attached and on verbal approval by Mike Bratcher on 11-27-2007.  
Dug out Center to 20' and SW corner to 4'. Installed liner at Center and placed excavated soil back in liner for second burial trench inside pit and capped.  
Lab and field sample results are attached.  
*Closed 11/27/07*

I hereby certify that the information above is true and complete to the best of my knowledge and belief. I further certify that the above-described pit or below-grade tank has been/will be constructed or closed according to NMOCD guidelines , a general permit , or an (attached) alternative OCD-approved plan .

Date: 12-04-2007

Printed Name/Title: Gary Miller- Agent

Signature 

Your certification and NMOCD approval of this application/closure does not relieve the operator of liability should the contents of the pit or tank contaminate ground water or otherwise endanger public health or the environment. Nor does it relieve the operator of its responsibility for compliance with any other federal, state, or local laws and/or regulations.

Approval: **Accepted for record NMOCD** Signature \_\_\_\_\_ Date: **DEC 10 2007**



Highlander Environmental Corp.  
Pit Sample Location Plat

Pit wall in feet \_\_\_\_\_

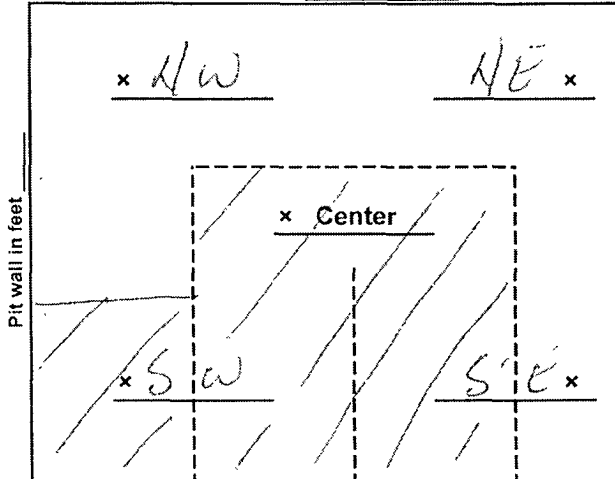

x \_\_\_\_\_ Indicates Sample Location  
(Name by quarter i.e. NW, NE etc)



Draw in North Arrow

Depth of pit in feet 2'

Pit wall in feet \_\_\_\_\_

• Wellhead

Well Pad

Client: POB Oper. LLC  
Well Name: GW West Loop #164  
API# 30-015-35654

## Summary Report

Gary Miller  
Highlander Environmental Services  
1910 N Big Spring Street  
Midland, TX, 79705

Report Date: November 30, 2007

Work Order: 7112830



Project Location: Eddy County, NM  
Project Name: COG-GJ West #164  
Project Number: 3302

Sample	Description	Matrix	Date Taken	Time Taken	Date Received
143833	NE 2'	soil	2007-11-26	00:00	2007-11-28
143834	NW 2'	soil	2007-11-26	00:00	2007-11-28
143835	SE 2'	soil	2007-11-26	00:00	2007-11-28
143836	SW 5'	soil	2007-11-26	00:00	2007-11-28
143837	Center 20'	soil	2007-11-26	00:00	2007-11-28

**Sample: 143833 - NE 2'**

Param	Flag	Result	Units	RL
Chloride		160	mg/Kg	2.00

**Sample: 143834 - NW 2'**

Param	Flag	Result	Units	RL
Chloride		<100	mg/Kg	2.00

**Sample: 143835 - SE 2'**

Param	Flag	Result	Units	RL
Chloride		<100	mg/Kg	2.00

**Sample: 143836 - SW 5'**

Param	Flag	Result	Units	RL
Chloride		<100	mg/Kg	2.00

**Sample: 143837 - Center 20'**

TraceAnalysis, Inc • 6701 Aberdeen Ave., Suite 9 • Lubbock, TX 79424-1515 • (806) 794-1296  
*This is only a summary. Please, refer to the complete report package for quality control data.*

Report Date: November 30, 2007  
3302

Work Order: 7112830  
COG-GJ West #164

Page Number: 2 of 2  
Eddy County, NM

Param	Flag	Result	Units	RL
Chloride		223	mg/Kg	2.00

District I  
1625 N French Dr, Hobbs, NM 88240  
District II  
1301 W Grand Avenue, Artesia, NM 88210  
District III  
1000 Rio Brazos Road, Aztec, NM 87410  
District IV  
1220 S St Francis Dr, Santa Fe, NM 87505

State of New Mexico  
Energy Minerals and Natural Resources



Oil Conservation Division  
1220 South St. Francis Dr.  
Santa Fe, NM 87505

Form C-144  
June 1, 2004

For drilling and production facilities, submit to appropriate NMOCD District Office.  
For downstream facilities, submit to Santa Fe office

**Pit or Below-Grade Tank Registration or Closure**

OCT 05 2007

Is pit or below-grade tank covered by a "general plan"? Yes  No

Type of action Registration of a pit or below-grade tank  Closure of a pit or below-grade tank

OCD-ARTESIA

Operator	COG Operating LLC		Telephone:	432-685-4332		e-mail address:	kcarrillo@conchoresources.com	
Address:	550 W. Texas, Suite 1300		Midland, TX 79701					
Facility or well name:	G J West Coop Unit #164		API #:	30-015-35654		U/L or Qtr/Qtr	L	Sec 21 T 17S R 29E
County:	EDDY		Latitude	32.819039° N		Longitude	104.084654° W	
Surface Owner	Federal <input type="checkbox"/> State <input type="checkbox"/> Private <input checked="" type="checkbox"/> Indian <input type="checkbox"/>		NAD 1927 <input checked="" type="checkbox"/> 1983 <input type="checkbox"/>					
<b>Pit</b>	<b>Below-grade tank</b>							
Type: Drilling <input checked="" type="checkbox"/> Production <input type="checkbox"/> Disposal <input type="checkbox"/> Workover <input type="checkbox"/> Emergency <input type="checkbox"/>	Volume: _____ bbl Type of fluid _____							
Lined <input checked="" type="checkbox"/> Unlined <input type="checkbox"/>	Construction material _____							
Liner type Synthetic <input checked="" type="checkbox"/> Thickness 12 mil Clay <input type="checkbox"/>	Double-walled, with leak detection? Yes <input type="checkbox"/> If not, explain why not _____							
Pit Volume 3000 bbl								
Depth to ground water (vertical distance from bottom of pit to seasonal high water elevation of ground water) 110'	Less than 50 feet						(20 points)	
	50 feet or more, but less than 100 feet						(10 points)	
	100 feet or more						(0 points)	
Wellhead protection area (Less than 200 feet from a private domestic water source, or less than 1000 feet from all other water sources.)	Yes						(20 points)	
	No						(0 points)	
Distance to surface water. (horizontal distance to all wetlands, playas, irrigation canals, ditches, and perennial and ephemeral watercourses)	Less than 200 feet						(20 points)	
	200 feet or more, but less than 1000 feet						(10 points)	
	1000 feet or more						(0 points)	
Ranking Score (Total Points)						0 points		

If this is a pit closure: (1) Attach a diagram of the facility showing the pit's relationship to other equipment and tanks (2) Indicate disposal location (check the onsite box if you are burying in place) onsite  offsite  If offsite, name of facility \_\_\_\_\_ (3) Attach a general description of remedial action taken including remediation start date and end date (4) Groundwater encountered No  Yes  If yes, show depth below ground surface \_\_\_\_\_ ft and attach sample results. (5) Attach soil sample results and a diagram of sample locations and excavations

Additional Comments:	COG Operating LLC proposes to close the drilling pit as follows:	
1.	Remove fluids from pit.	
2.	A deep trench pit will be constructed next to the existing reserve pit and lined with a 12 mil liner. The contents will be encapsulated in this pit and the liner will be folded over the mud & cuttings.	
3.	Cover liner w/20 mil liner w/ excess of 3' on all sides as per option IV B 3 (b) of Pit and Below-Grade Tank Guidelines	
4.	Cover w/ a minimum of 3' of native soil.	
5.	Contour pit to prevent erosion & ponding of rainwater.	

I hereby certify that the information above is true and complete to the best of my knowledge and belief I further certify that the above-described pit or below-grade tank has been/will be constructed or closed according to NMOCD guidelines , a general permit , or an (attached) alternative OCD-approved plan .

Date 10-04-07

Printed Name/Title Kanicia Carrillo, Regulatory Analyst

Signature

Your certification and NMOCD approval of this application/closure does not relieve the operator of liability should the contents of the pit or tank contaminate ground water or otherwise endanger public health or the environment Nor does it relieve the operator of its responsibility for compliance with any other federal, state, or local laws and/or regulations

Samples are to be obtained from Pit area and analysis submitted to NMOCD prior to back-filling NOTIFY NMOCD 24 HOURS PRIOR TO OBTAINING SAMPLES.

Signature

Signed By

Date

OCT 12 2007

If burial trench is to be constructed in pit area, samples are to be obtained and analyses submitted to OCD PRIOR to lining trench.