

District I
1625 N French Dr, Hobbs, NM 88240
District II
1301 W Grand Avenue, Artesia, NM 88210
District III
1000 Rio Brazos Road, Aztec, NM 87410
District IV
1220 S St Francis Dr, Santa Fe, NM 87505

State of New Mexico
Energy Minerals and Natural Resources

Form C-101
May 27, 2004

Oil Conservation Division
1220 South St. Francis Dr.



Submit to appropriate District Office

☐ AMENDED REPORT

JAN 28 2008

OCD-ARTESIA

Santa Fe, NM 87505

APPLICATION FOR PERMIT TO DRILL, RE-ENTER, DEEPEN, PLUGBACK, OR ADD A ZONE

¹ Operator Name and Address Devon Energy Production Co, L P 20 North Broadway OKC, OK 73102-8260		² OGRID Number 6137	
³ Property Code		³ API Number 30-015-31236	
³ Property Name Springs 2 Federal		⁶ Well No 1	
⁹ Proposed Pool 1 Springs; Upper Penn		¹⁰ Proposed Pool 2	

⁷ Surface Location

UL or lot no	Section	Township	Range	Lot Idn	Feet from the	North/South line	Feet from the	East/West line	County
10	2	21S	25E		2375	North	2300	East	Eddy

⁸ Proposed Bottom Hole Location If Different From Surface

UL or lot no	Section	Township	Range	Lot Idn	Feet from the	North/South line	Feet from the	East/West line	County
10	2	21S	25E		3200	North	1900	East	Eddy

Additional Well Information

¹¹ Work Type Code P	¹² Well Type Code G	¹³ Cable/Rotary R	¹⁴ Lease Type Code S	¹⁵ Ground Level Elevation 3225' GL
¹⁶ Multiple No	¹⁷ Proposed Depth 10,850'	¹⁸ Formation Catchlaw Draw, Morrow	¹⁹ Contractor	²⁰ Spud Date
Depth to Groundwater		Distance from nearest fresh water well		Distance from nearest surface water
Pit Liner Synthetic <input type="checkbox"/> _____ mils thick Clay <input type="checkbox"/> Pit Volume _____ bbls Drilling Method				
Closed-Loop System <input checked="" type="checkbox"/> Fresh Water <input type="checkbox"/> Brine <input type="checkbox"/> Diesel/Oil-based <input type="checkbox"/> Gas/Air <input type="checkbox"/>				

²¹ Proposed Casing and Cement Program

Hole Size	Casing Size	Casing weight/foot	Setting Depth	Sacks of Cement	Estimated TOC
17 1/2"	13 3/8" H-40	48#	453'	500 sx CLC	surface
12 1/2"	8 5/8" K-55	32#	2170'	910 sx CLC	surface
7 7/8"	5 1/2" L-55	17#	10850'	1200 sx CLH	TOC @ 1190'

²² Describe the proposed program If this application is to DEEPEN or PLUG BACK, give the data on the present productive zone and proposed new productive zone Describe the blowout prevention program, if any Use additional sheets if necessary

Devon Energy Production Company, LP requests approval to plugback to the Cisco Canyon from the existing Catchlaw Draw; Morrow:
See attached procedures

Note: No H2S is expected to be encountered BOP to be used

Completion papers to be filed if successful plugback

²³ I hereby certify that the information given above is true and complete to the best of my knowledge and belief I further certify that the drilling pit will be constructed according to NMOCD guidelines <input checked="" type="checkbox"/> a general permit <input type="checkbox"/> , or an (attached) alternative OCD-approved plan <input checked="" type="checkbox"/> .		OIL CONSERVATION DIVISION	
Printed name Stephanie A Ysasaga		Approved by BRYAN G. ARANT	
Title Sr Staff Engineering Technician		Title DISTRICT II GEOLOGIST	
E-mail Address Stephanie.Ysasaga@dev.com		Approval Date FEB 11 2008 Expiration Date FEB 11 2010	
Date 01/24/2008	Phone (405)-552-7802	Conditions of Approval Attached <input type="checkbox"/>	

Devon Energy Corporation
Springs 2 Fed 1
2375' FNL & 2300' FEL - SEC 2 – T21S – R25E
Eddy County, NM
 AFE #139626 API # 30-015-31236 WI=100%

Objective: **Recomplete well to Cisco-Canyon.**

Well Data:

Surface Casing: 13-3/8" 48# H-40, STC @ 453' (TOC surface)
 Intermed Casing: 8-5/8" 32# K-55 STC @ 2179' (TOC surface)
 Production Casing: 5-1/2" 17# P-110/N-80 LTC @ 10,850' (TOC 1190' and DV tool @ 7787')
 KB elev: 32xx' GL elev: 3225'
 PBTD: 11,750' (float collar) TD: 10,850'
 Tubing: 259 jts - 2-7/8" 6.5#, N-80 EUE 8rd (EOT 8076')
 TAC: Set at 7766'
 Existing Perfs: 10,347'-53', 10,386'-92' 10,534'-587' (Morrow)
 Proposed Perfs: 8108'-26' and 8266'-82' (Cisco-Canyon)

Procedure:

1. RUPU. ND wellhead. NU BOP. Release TAC. POOH. LD TAC.
2. RU wireline truck. RU full lubricator and p-test. Set CIBP at 10,325' and cap with 35' cement after perforating. Perforate Cisco-Canyon with a 3 1/8" gun loaded 3 spf with 120° phasing from 8266'-82' (20') Total 60 holes. RD wireline truck.
3. RIH w/ packer on tubing and set at ~8230' (need to pickup ~155' tubing). ND BOP. NU wellhead. RU swab and swab test.
4. If necessary, stimulate interval with acid frac down tubing as per BJ Services procedure. Take 5, 10, and 15 minutes pressures. RD BJ.
5. RU swab and swab test.
6. If this section of Cisco-Canyon tests wet, RU wireline truck. RU full lubricator and p-test. Set CIBP at ~8230' and cap with 35' cement after perforating. Perforate Cisco-Canyon with 3 1/8" gun loaded 3 spf with 120° phasing from 8108'-26' (18') Total 54 holes. RD wireline truck.
7. RIH w/ packer on tubing and set at ~8070'. ND BOP. NU wellhead. RU swab and swab test.
8. If necessary, stimulate interval with acid frac down tubing as per BJ Services procedure. Take 5, 10, and 15 minutes pressures. RD BJ.
9. RU swab. Swab well on production. RDMO.

District I
1625 N. French Dr., Hobbs, NM 88240
District II
1301 W. Grand Avenue, Artesia, NM 88210
District III
1000 Rio Brazos Rd., Aztec, NM 87410
District IV
1220 S. St. Francis Dr., Santa Fe, NM 87505

State of New Mexico
Energy, Minerals & Natural Resources Department
OIL CONSERVATION DIVISION
1220 South St. Francis Dr.
Santa Fe, NM 87505

Form C-102
Revised October 12, 2005
Submit to Appropriate District Office
State Lease - 4 Copies
Fee Lease - 3 Copies

☐ AMENDED REPORT

WELL LOCATION AND ACREAGE DEDICATION PLAT

¹ API Number 30-015-31236	² Pool Code 85640	³ Pool Name Springs, Upper Penn
⁴ Property Code	⁵ Property Name Springs 2 Federal	⁶ Well Number 1
⁷ OGRID No. 6137	⁸ Operator Name Devon Energy Production Co., L.P.	⁹ Elevation 3225'

¹⁰ Surface Location

UL or lot no.	Section	Township	Range	Lot Idn	Feet from the	North/South line	Feet from the	East/West line	County
LOT 10	2	21S	25E		2375	North	2300	East	Eddy

¹¹ Bottom Hole Location If Different From Surface

UL or lot no.	Section	Township	Range	Lot Idn	Feet from the	North/South line	Feet from the	East/West line	County
LOT 10	2	21S	25E		3200	North	1900	East	Eddy

¹² Dedicated Acres 592	¹³ Joint or Infill	¹⁴ Consolidation Code	¹⁵ Order No.
--------------------------------------	-------------------------------	----------------------------------	-------------------------

No allowable will be assigned to this completion until all interests have been consolidated or a non-standard unit has been approved by the division.

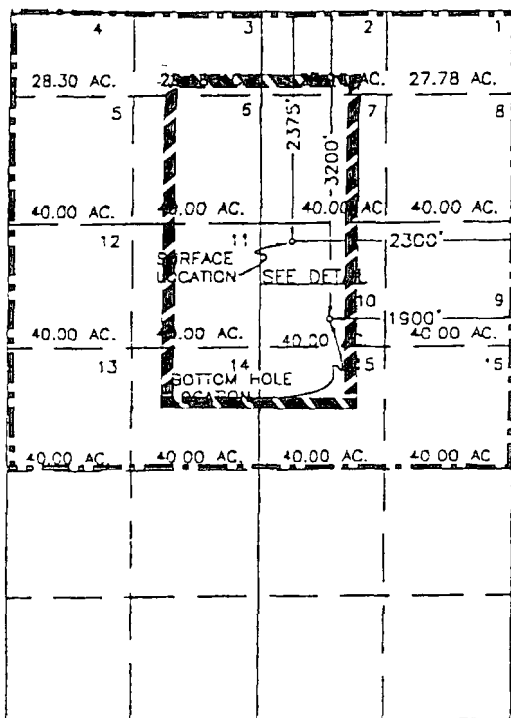

¹⁷ OPERATOR CERTIFICATION

I hereby certify that the information contained herein is true and complete to the best of my knowledge and belief, and that this organization either owns a working interest or unleased mineral interest in the land including the proposed bottom hole location or has a right to drill this well at this location pursuant to a contract with an owner of such a mineral or working interest, or to a voluntary pooling agreement or a compulsory pooling order heretofore entered by the division.

Signature: [Signature] Date: 1/23/03
Printed Name: Stephanie A Ysasaga

¹⁸ SURVEYOR CERTIFICATION

I hereby certify that the well location shown on this plat was plotted from field notes of actual surveys made by me or under my supervision, and that the same is true and correct to the best of my belief.

Date of Survey
Signature and Seal of Professional Surveyor

See Original Plat for Surveyor Certification

Certificate Number

DISTRICT II

P.O. Drawer 88, Artesia, NM 88211-0718

DISTRICT III

1000 Rio Brazos Rd., Artesia, NM 87410

DISTRICT IV

P.O. Box 2088, Santa Fe, N.M. 87504-2088

OIL CONSERVATION DIVISION

P.O. Box 2088

Santa Fe, New Mexico 87504-2088

☐ AMENDED REPORT

WELL LOCATION AND ACREAGE DEDICATION PLAT

API Number	Pool Code 74320	Pool Name CATCLAW DRAW - MORROW
Property Code	Property Name SPRINGS 2 FEDERAL	Well Number 1
GRID No. 166111	Operator Name CONCHO RESOURCES INC.	Elevation 3225

Surface Location

UL or lot No.	Section	Township	Range	Lot Idn	Feet from the	North/South line	Feet from the	East/West line	County
LOT 10	2	21 S	25 E		2375	NORTH	2300	EAST	EDDY

Bottom Hole Location If Different From Surface

UL or lot No.	Section	Township	Range	Lot Idn	Feet from the	North/South line	Feet from the	East/West line	County
LOT 10	2	21 S	25 E		3200	NORTH	1900	EAST	EDDY

Dedicated Acres	Joint or Infill	Consolidation Code	Order No.
592			

NO ALLOWABLE WILL BE ASSIGNED TO THIS COMPLETION UNTIL ALL INTERESTS HAVE BEEN CONSOLIDATED
OR A NON-STANDARD UNIT HAS BEEN APPROVED BY THE DIVISION

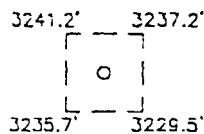
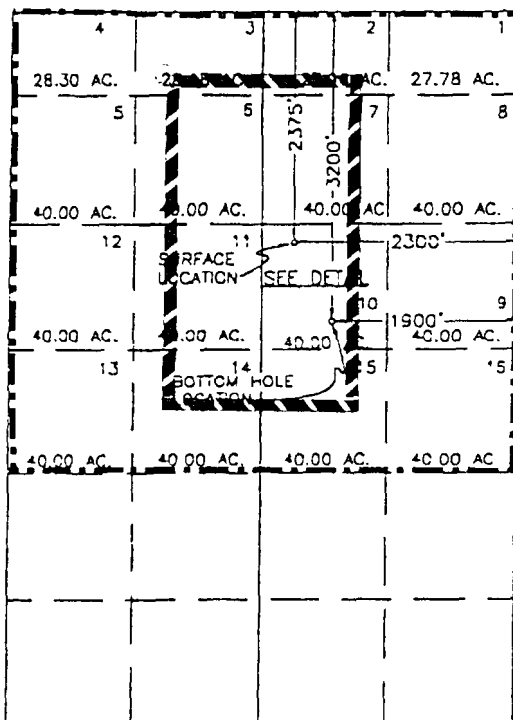

DETAIL

6-29-00
Do not see a well log

OPERATOR CERTIFICATION

I hereby certify the information contained herein is true and complete to the best of my knowledge and belief.

Signature

Joe T. Janica

Printed Name

Agent

Title

03/16/00

Date

SURVEYOR CERTIFICATION

I hereby certify that the well location shown on this plat was plotted from field notes of actual surveys made by me or under my supervision and that the same is true and correct to the best of my belief.

FEBRUARY 18, 2000

Date Surveyed

DC

Signature & Seal of Professional Surveyor

Ronald E. Edson
02285

Certificate No. RONALD E. EDSON
GARY EDSON
PROFESSIONAL SURVEYOR

3139
12641
12185