

Submit 3 Copies To Appropriate District
Office
District I
1625 N. French Dr., Hobbs, NM 87240
District II
1301 W. Grand Ave., Artesia, NM 88210
District III
1000 Rio Brazos Rd., Aztec, NM 87410
District IV
1220 S. St. Francis Dr., Santa Fe, NM 87505

State of New Mexico
Energy, Minerals and Natural Resources

OIL CONSERVATION DIVISION
1220 South St. Francis Dr.
Santa Fe, NM 87505

Form C-103
May 27, 2004

SUNDRY NOTICES AND REPORTS ON WELLS (DO NOT USE THIS FORM FOR PROPOSALS TO DRILL OR TO DEEPEN OR PLUG BACK TO A DIFFERENT RESERVOIR. USE "APPLICATION FOR PERMIT" (FORM C-101) FOR SUCH PROPOSALS.)		WELL API NO. 30-015-35884
1. Type of Well: Oil Well <input type="checkbox"/> Gas Well <input checked="" type="checkbox"/> Other		5. Indicate Type of Lease STATE <input checked="" type="checkbox"/> FEE <input type="checkbox"/>
2. Name of Operator EOG Resources Inc.		6. State Oil & Gas Lease No.
3. Address of Operator P.O. Box 2267 Midland, Texas 79702		7. Lease Name or Unit Agreement Name: Yellowstone 23 State Com
4. Well Location Unit Letter I : 1880 feet from the South line and 660 feet from the East line Section 23 Township 18S Range 21E NMPM County Eddy		8. Well Number 2H
11. Elevation (Show whether DR, RKB, RT, GR, etc.) 4131 GR		9. OGRID Number 7377
Pit or Below-grade Tank Application <input type="checkbox"/> or Closure <input type="checkbox"/> Pit type _____ Depth to Groundwater _____ Distance from nearest fresh water well _____ Distance from nearest surface water _____ Pit Liner Thickness: _____ mil Below-Grade Tank: Volume _____ bbls; Construction Material _____		10. Pool name or Wildcat Four Mile Draw; Wolfcamp

12. Check Appropriate Box to Indicate Nature of Notice, Report, or Other Data

NOTICE OF INTENTION TO:

PERFORM REMEDIAL WORK ☐ PLUG AND ABANDON ☐
TEMPORARILY ABANDON ☐ CHANGE PLANS ☐
PULL OR ALTER CASING ☐ MULTIPLE COMPLETION ☐
OTHER: ☐

SUBSEQUENT REPORT OF:

REMEDIAL WORK ☐ ALTERING CASING ☐
COMMENCE DRILLING OPNS. ☐ PLUG AND ABANDONMENT ☐
CASING TEST AND CEMENT JOB ☐
OTHER: ☐

13. Describe proposed or completed operations. (Clearly state all pertinent details, and give pertinent dates, including estimated date of starting any proposed work). SEE RULE 1103. For Multiple Completions: Attach wellbore diagram of proposed completion or recompletion.

2/05/08 Perforated from 6900' to 7500', 0.42", 32 holes.
Frac with 142 bbls 15% HCL acid, 805 bbls XL gel, 77500 lbs 100 mesh sand, 68300 lbs 30/70 sand, 34161 lbs 20/40 sand, 6828 bbls load water.
Perforated from 6100' to 6700', 0.42", 32 holes.
Frac with 142 bbls 15% HCL acid, 750 bbls XL gel, 81000 lbs 100 mesh sand, 59000 lbs 30/70 sand, 29945 lbs 20/40 sand, 6500 bbls load water.
Perforated from 5300' - 5850', 0.42", 32 holes.

I hereby certify that the information above is true and complete to the best of my knowledge and belief. I further certify that any pit or below-grade tank has been/will be constructed or closed according to NMOCD guidelines ☐, a general permit ☐ or an (attached) alternative OCD-approved plan ☐

SIGNATURE Stan Wagner TITLE Regulatory Analyst DATE 2/7/08

Type or print name Stan Wagner

E-mail address:

Telephone No. 432-686-3689

For State Use Only

FOR RECORDS ONLY

APPROVED BY _____ TITLE _____ DATE _____

Conditions of Approval, if any:

District I
1625 N. French Dr., Hobbs, NM 88240
District II
1301 W. Grand Avenue, Artesia, NM 88210
District III
1000 Rio Brazos Rd., Aztec, NM 87410
District IV
1220 S. St. Francis Dr., Santa Fe, NM 87505

State of New Mexico
Energy, Minerals & Natural Resources Department
OIL CONSERVATION DIVISION
1220 South St. Francis Dr.
Santa Fe, NM 87505

Form C-102
Revised October 12, 2005
Submit to Appropriate District Office
State Lease- 4 Copies
Fee Lease- 3 Copies

☐ AMENDED REPORT

WELL LOCATION AND ACREAGE DEDICATION PLAT

API Number 30-015-35884	Pool Code 97553	Pool Name Four Mile Draw; Wolfcamp, SW (Gas)
Property Code 36802	Property Name YELLOWSTONE 23 STATE COM	Well Number 2H
OCRD No. 7377	Operator Name EOG RESOURCES, INC.	Elevation 4131'

Surface Location

UL or lot no.	Section	Township	Range	Lot Idn	Feet from the	North/South line	Feet from the	East/West line	County
I	23	18 SOUTH	21 EAST, N.M.P.M.		1880'	SOUTH	660'	EAST	EDDY

Bottom Hole Location if Different From Surface

UL or lot no.	Section	Township	Range	Lot Idn	Feet from the	North/South line	Feet from the	East/West line	County
L	23	18 SOUTH	21 EAST, N.M.P.M.		1830	SOUTH	1012	WEST	EDDY

Dedicated Acres 320	Joint or Infill	Consolidation Code	Order No.
------------------------	-----------------	--------------------	-----------

No allowable will be assigned to this completion until all interests have been consolidated or a non-standard unit has been approved by the division.

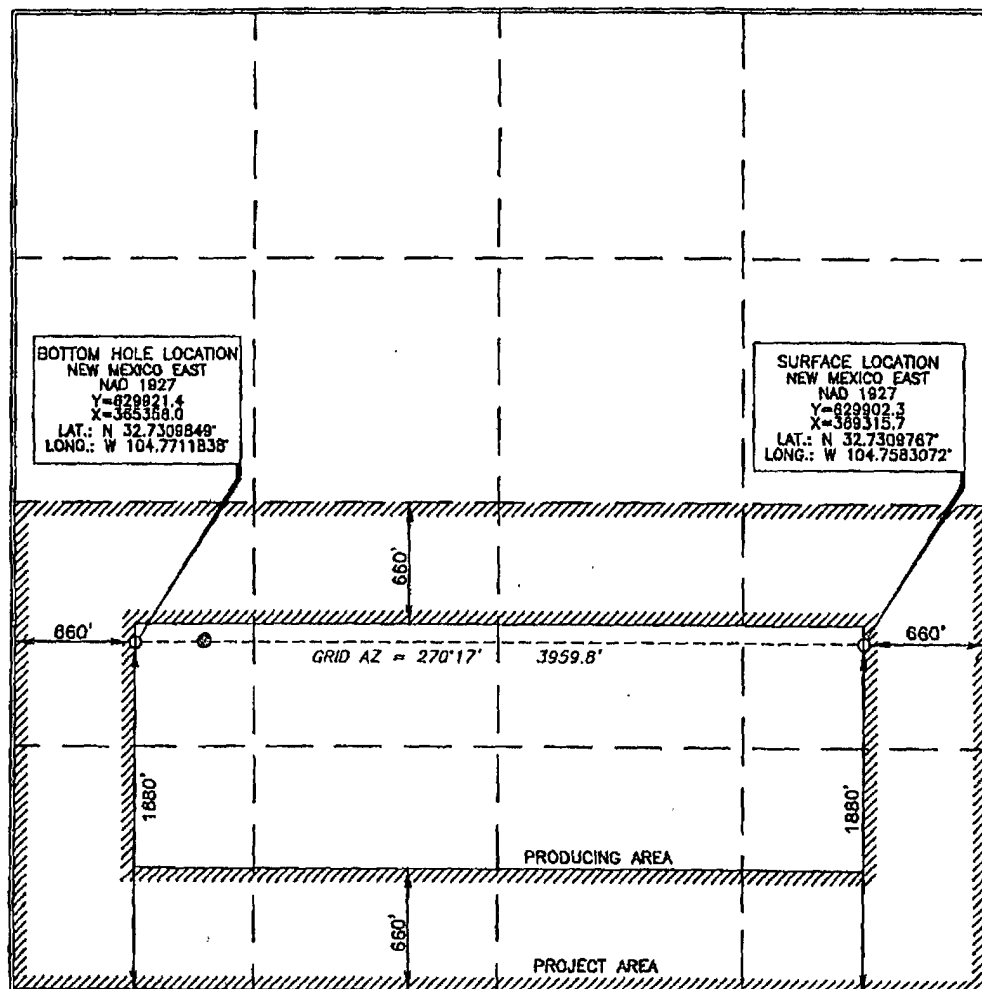

OPERATOR CERTIFICATION

I hereby certify that the information contained herein is true and complete to the best of my knowledge and belief, and that this organization either owns a working interest or unleased mineral interest in the land including the proposed bottom hole location or has a right to drill this well at this location pursuant to a contract with an owner of such a mineral or working interest, or to a voluntary pooling agreement or a compulsory pooling order heretofore entered by the division.

Stan Wagner 2/21/08
Signature Date

Stan Wagner
Printed Name

SURVEYOR CERTIFICATION

I hereby certify that the well location shown on this plat was plotted from field notes or actual surveys made by me or under my supervision, and that the same is true and correct to the best of my belief.

15079
OCTOBER 2, 2007
Date of Survey

Signature and Seal of
Professional Land Surveyor

Terry J. Hall 10-15-2007
Certificate Number 15079

WOF 071002WL-b (N)