

UNITED STATES
DEPARTMENT OF THE INTERIOR
BUREAU OF LAND MANAGEMENT

OCD-ARTESIA

FORM APPROVED
OMB No. 1004-0137
Expires: March 31, 2007

SUNDRY NOTICES AND REPORTS ON WELLS

Do not use this form for proposals to drill or to re-enter an abandoned well. Use Form 3160-3 (APD) for such proposals.

SUBMIT IN TRIPLICATE - Other instructions on reverse side.

1 Type of Well
☒ Oil Well ☐ Gas Well ☐ Other

MAY 19 2008

2 Name of Operator
BEPCO, L.P.

OCD-ARTESIA

3a Address
P.O. BOX 2760 MIDLAND TX 79702-27603b Phone No. (include area code)
(432)683-22774 Location of Well (Footage, Sec., T., R., M., or Survey Description)
SEC 7, T22S, R29E, UL F. 1980 FWL, 1980' FNL

5 Lease Serial No.

NM-03302

6 If Indian, Allottee or Tribe Name

7 If Unit or CA/Agreement, Name and/or No
NMNM725838 Well Name and No
BIG EDDY #719 API Well No.
30-015-2300410 Field and Pool, or Exploratory Area
Quahada Ridge, SW (Atoka)11 County or Parish, State
EDDY
NM

12. CHECK APPROPRIATE BOX(ES) TO INDICATE NATURE OF NOTICE, REPORT, OR OTHER DATA

TYPE OF SUBMISSION	TYPE OF ACTION			
<input checked="" type="checkbox"/> Notice of Intent	<input type="checkbox"/> Acidize	<input type="checkbox"/> Deepen	<input type="checkbox"/> Production (Start/Resume)	<input type="checkbox"/> Water Shut-Off
<input type="checkbox"/> Subsequent Report	<input type="checkbox"/> Alter Casing	<input type="checkbox"/> Fracture/Treat	<input type="checkbox"/> Reclamation	<input type="checkbox"/> Well Integrity
<input type="checkbox"/> Final Abandonment Notice	<input type="checkbox"/> Casing Repair	<input type="checkbox"/> New Construction	<input type="checkbox"/> Recomplete	<input type="checkbox"/> Other
	<input type="checkbox"/> Change Plans	<input checked="" type="checkbox"/> Plug and Abandon	<input type="checkbox"/> Temporarily Abandon	
	<input type="checkbox"/> Convert to Injection	<input type="checkbox"/> Plug Back	<input type="checkbox"/> Water Disposal	

13 Describe Proposed or Completed Operation (clearly state all pertinent details, including estimated starting date of any proposed work and approximate duration thereof. If the proposal is to deepen directionally or recompleat horizontally, give subsurface locations and measured and true vertical depths of all pertinent markers and zones. Attach the Bond under which the work will be performed or provide the Bond No. on file with BLM/BIA. Required subsequent reports shall be filed within 30 days following completion of the involved operations. If the operation results in a multiple completion or recompleat in a new interval, a Form 3160-4 shall be filed once testing has been completed. Final Abandonment Notices shall be filed only after all requirements, including reclamation, have been completed, and the operator has determined that the site is ready for final inspection.)

BEPCO, L. P. respectfully requests permission to P & A the subject wellbore as follows:

- MIRU plugging equipment and PU. PU 3 jts tubing & tag CIBP @ 11, 514" & circ hole w/ 9.6 ppg mud.
- Spot 30 sxs Class H at 11,364-11,514'. PUH to 9789'
 - Spot 30 sxs Class H at 9639-9789'. PUH. *Perf & Squeeze*
Freepoint & cut 5-1/2" csg @ 2961'. Circulate out w/ 9.5 ppg mud. Pull & recover 5-1/2" csg. TIH w/ tubing.
 - Spot 90 sxs Class C @ 2811' - 3011'. PUH, WOC, & TAG. PUH to 405'.
 - Spot 90 sxs Class C @ 205'-405'. PUH, WOC & TAG. PUH to 60'.
 - Spot 30 sxs Class C @ 0-60'.
Set P & A marker and remediate location.
Use steel tank and haul all fluids.

*See attached
changes*SEE ATTACHED FOR
CONDITIONS OF APPROVAL14. I hereby certify that the foregoing is true and correct
Name (Printed/Typed)

ANN MOORE

Title PRODUCTION CLERK

Signature

Ann Moore

Date 04/30/2008

THIS SPACE FOR FEDERAL OR STATE OFFICE USE

Approved by

Conditions of approval, if any, are attached. Approval of this notice does not warrant or certify that the applicant holds legal or equitable title to those rights in the subject lease which would entitle the applicant to conduct operations thereon.

Title

Office

APPROVED

MAY 17 2008
DateJAMES A. AMOS
SUPERVISOR-EPS

Title 18 U.S.C. Section 1001 and Title 43 U.S.C. Section 1212, make it a crime for any person knowingly and willfully to make to any department or agency of the United States any false, fictitious or fraudulent statements or representations as to any matter within its jurisdiction.

(Instructions on page 2)

Accepted for record
NMOCD

Lease: **BIG EDDY**Well No.: **71**Field: **QUAHADA RIDGE SW Atoka**

T/A

Location: **1980 FWL & 1980 FNL Sec. 7, T22S, R29E**County: **Eddy** St: **NM**API: **30-015-23004****Surface Csg.**

Size: 11 3/4
 Wt: 42
 Grd: H-40
 Set @: 305
 Sxs cmt: 250
 Circ: Y
 TOC: Surf
 Hole Size: 15

5. SPOT 30 SX C

0 - 60 (SURFACE)

KB: 3308

GL: 3290

Spud Date: 10/18/1979

Compl. Date: 1/14/1980

Intermediate Csg.

Size: 8 5/8
 Wt: 28
 Grd: S-80
 Set @: 2911
 Sxs Cmt: 975
 Circ: Y
 TOC: Surf
 Hole Size: 11 to 2932

305

11 3/4

4. SPOT 90 SX CLASS C 205 - 405 (TAG)

Production Csg.

Size: 5 1/2
 Wt: 17
 Grd: K55/N80/S95
 Set @: 13060
 Sxs Cmt: 925
 Circ: N
 TOC: 8900 est
 Hole Size: 7 7/8

2911

2932

8 5/8

3. SPOT 90 SX CLASS C 2811 - 3011 (TAG)

CUT AND PULL 5-1/2" @ 2961'

TOC est

Tubing

368 jts 2 3/8" 4.7# N-80 w/ SN @ 11425

11425

2. SPOT 30 SX CLASS H 9639 - 9789 WOLFCAMP
SN

11514

1. SPOT 30 SX CLASS H 11,364 - 11,514
CIBP

Atoka

Perf: 11542-11638 (7 shots)

13060

5 1/2

**Accepted for record
NMOCD**PBTD: 11514TD: 13060Updated: 4/29/2008Author: SFJEngr: SFJ

CURRENT WELLBORE DIAGRAM

Lease: **BIG EDDY**

Well No.: **71**

Field: **QUAHADA RIDGE SW Atoka**

T/A

Location: **1980 FWL & 1980 FNL Sec. 7, T22S, R29E**

County: **Eddy** St: **NM**

API: **30-015-23004**

Surface Csg.

Size: 11 3/4
 Wt: 42
 Grd: H-40
 Set @: 305
 Sxs cmt: 250
 Circ: Y
 TOC: Surf
 Hole Size: 15

KB: 3308
 GL: 3290
 Spud Date: 10/18/1979
 Compl. Date: 1/14/1980

Intermediate Csg.

Size: 8 5/8
 Wt: 28
 Grd: S-80
 Set @: 2911
 Sxs Cmt: 975
 Circ: Y
 TOC: Surf
 Hole Size: 11 to 2932

Production Csg.

Size: 5 1/2
 Wt: 17
 Grd: K55/N80/S95
 Set @: 13060
 Sxs Cmt: 925
 Circ: N
 TOC: 8900 est
 Hole Size: 7 7/8

Tubing

368 jts 2 3/8" 4.7# N-80 w/ SN @ 11425

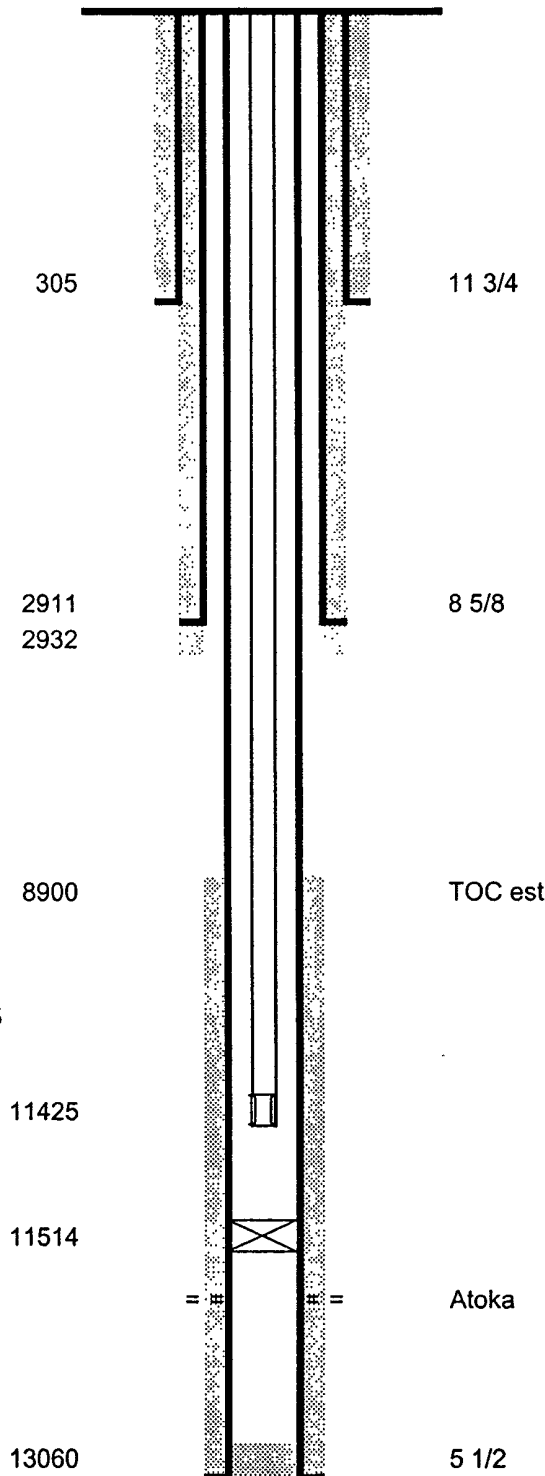

SN **Accepted for record**
NMOCD

CIBP

Atoka

Perf: 11542-11638 (7 shots)

PBTD: 11514

TD: 13060

Updated: 7/16/2003

Author: ELE

Engr: MWD

WELL HISTORY

WELL NAME: BIG EDDY # 71

API: 30-015-23004

FIELD NAME: QUAHADA RIDGE SW Atoka

LOCATION: 1980 FWL & 1980 FNL Sec. 7, T22S, R29E
Eddy County, NM

TD: 13060

3308' KB

PBTD: 11514

3290' GL

SPUD DATE: 10/18/1979

COMP DATE: 01/14/1980

CASING:	Size	Wt	Grd	Set Depth	Sxs	Class	TOC	Hole	Hole Depth
	11 3/4	42	H-40	305	250	C	Surf	15	305
	8 5/8	28	S-80	2911	775 200	Lite C	Surf	11	2932
	5 1/2	17	S-95 N-80 K-55	13060	200 725	Lite C	8900 est	7 7/8	13060
LINER:									
OPEN HOLE:									
TUBING:	368 jts 2 3/8" 4.7# N-80 w/ SN @ 11425								

DST: 11/19/1979: 11525-11586 Strawn

CORES & LOGS:

DATE	LOG	COMPANY	TOP	BOTTOM
10/18/1979	STRIP MUD LOG			
	SAMPLE LOG			
10/22/1979	CALIPER SURVEY			
12/10/1979	SIMULT COMP NEUTRON FORM DENSITY			
12/10/1979	CYBERLOOK			
12/10/1979	SIMULT DUAL LATEROLOG MSFL			

FORMATION TOPS:

Delaware	2950
Bone Spring	6623
Wolfcamp	9880
Strawn	11175
Atoka	11480
Morrow	12200
M Morrow	12478
L Morrow	12778

**Accepted for record
NMOCD**

Big Eddy # 71
Well History

PRESSURE SURVEY:

01/18/1980: Four-Point test & 72hr BHP.
04/21/1995: ARC: 3hr BHP & Gradient Survey

DRILLING:

Cmt 11 3/4" csg w/ 250 sxs Cls "C". CIRC.
Cmt 8 5/8" csg w/ 775 sxs Halliburton Lite, tailed w/ 200 sxs Cls "C". CIRC.
Cmt 5 1/2" csg w/ 200 sxs Halliburton Lite, Tailed w/ 725 sxs Cls "H". TOC
8900 est.

INITIAL COMPLETION:

01/11/1980 Spot 150 gals 10% acetic acid @ 11540-11640. Pump 900gal 7.5% HCL.
Set Otis MH-2 Pkr @ 11461.
PERF: 11542, 11550, 11555, 11562, 11568, 11635.5, 11638. (7 shots
Strawn). Swab.

01/13/1980 **Acidize:** w/ 2000 gals 15% HCL + 850 SCF/bbl N2. ISIP 5600psi, 5min
5500psi, 10min 5500psi, 15min 5450psi.

01/18/1980 Run Four-Point Test. SI for 72 hr build-up.
CAOF = 544 MCFPD.
SI after 4hr flow at 147 MCFOD for BHPBU, 88hr BHP = 6123psi @ 11441',
SITP = 4631psi.

09/05/1980 Put well on line w/ 10/64" ck. @ 600 MCFPD. SITP = 4000psi.

WORKOVERS:

09/13/1980 **FRAC:** Pump 1000 gal 15% NE-HCL + additives. Pump 782 bbl YF-30 SD
+ additives. Used 35000# 100 mesh sand & 11100# 20/40 sand. Screened
out.

02/17/1981 Swab.
08/07/1981 Swab.
10/15/1981 Swab.
02/06/1982 Swab.
03/09/1982 Swab.
03/03/1983 Swab.
04/19/1983 Swab.
06/30/1984 Swab.

02/08/1995 Casing Integrity Test. Failed.

04/21/1995 ARC Pressure Data: 1 quartz & 1 Amerada gauge set @ 11400. Remain
on bottom for 3 hrs. Make gradient stops @ 10000, 8000, 6000. Surface
psi @ 2436 by dead weight & BHP of 3707psi.

01/22/1996 Release **PKR** @ 11517'.
Set **CIBP** @ 11514. RIH w/ SN on 2 3/8" tbg. Casing Integrity Test – OK.
Well T/A'd.

Accepted for record
NMOCD

Big Eddy # 71
Well History

12/08/2000	MIT = OK.
06/19/2002	MIT = OK.
02/17/2005	MIT = OK

Accepted for record
NMOCD

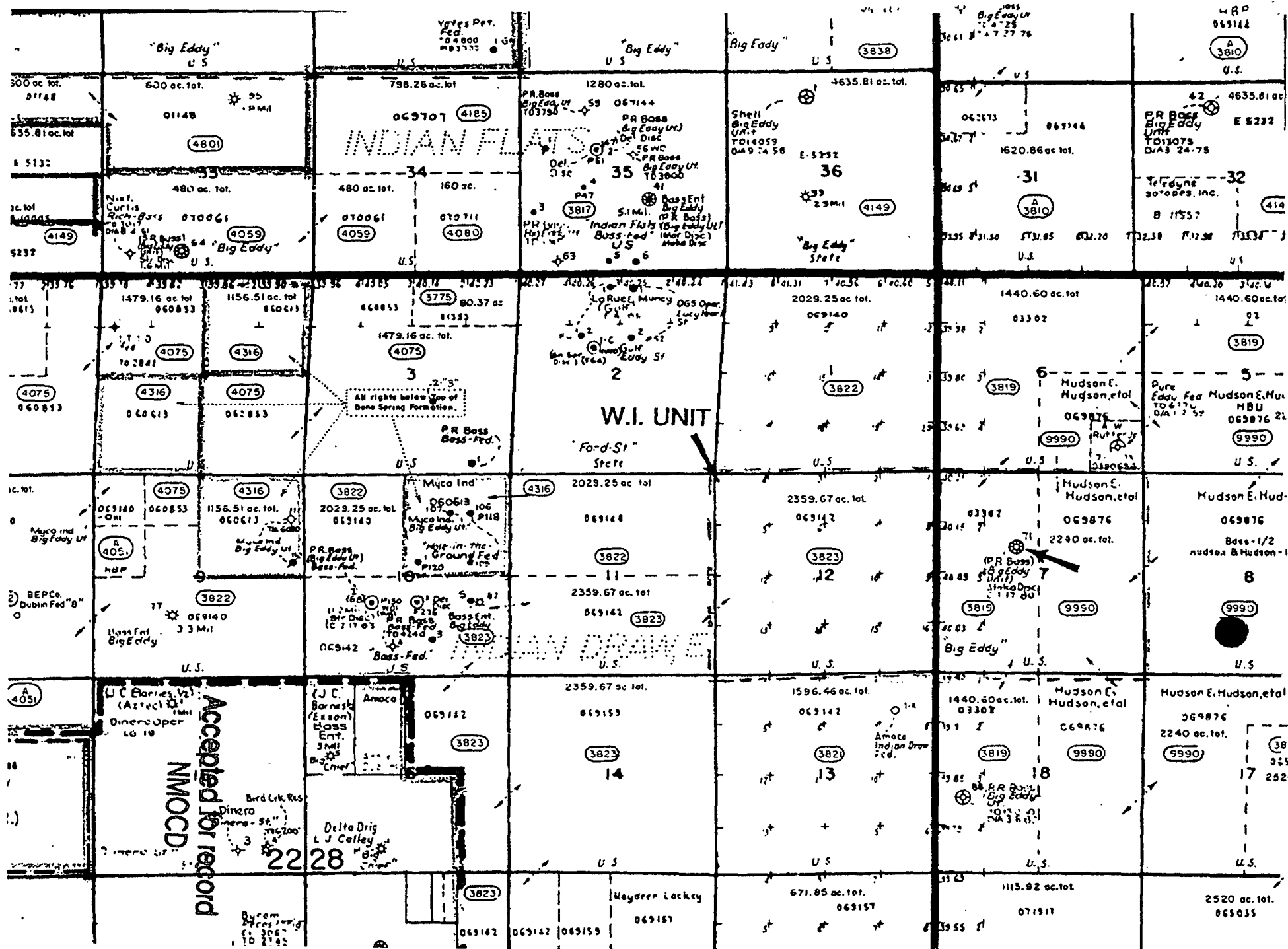

BEPCO, L. P.

NMNM03302; Big Eddy #71
1980' FNL & 1980' FWL
Sec. 7, T22S-R29E
Eddy County, New Mexico

RE: Plugging & Abandonment, Conditions of Approval

2. Plug to be a minimum of 200' (100' plus 10% per 1000').
- 2.a. Add plug, PUH to 6673', perforate & squeeze cmt from 6673'-6513'. WOC and tag. (covers top of Bone Springs). Cut/pull.
3. Spot cmt from 2650'-3011' (includes the Base of Salt)

No other changes

If any questions, call Jim Amos at 505-234-5909.

James A. Amos
SEPS

5/17/08

**Accepted for record
NMOCD**

**BUREAU OF LAND MANAGEMENT
Carlsbad Field Office
620 East Greene Street
Carlsbad, New Mexico 88220
575-234-5972**

**Permanent Abandonment of Federal Wells
Conditions of Approval**

Failure to comply with the following Conditions of Approval may result in a Notice of Incidents of Noncompliance (INC) in accordance with 43 CFR 3163.1.

1. Plugging operations shall commence within ninety (90) days from the approval date of this Notice of Intent to Abandon.

If you are unable to plug the well by the 90th day provide this office, prior to the 90th day, with the reason for not meeting the deadline and a date when we can expect the well to be plugged. Failure to do so will result in enforcement action.

2. **Notification:** Contact the appropriate BLM office at least 24 hours prior to the commencing of any plugging operations. For wells in Chaves and Roosevelt County, call 575-627-0272; Eddy County, call 575-361-2822; Lea County, call 575-393-3612.

3. **Blowout Preventers:** A blowout preventer (BOP), as appropriate, shall be installed before commencing any plugging operation. The minimum BOP requirement is a 2M system for a well not deeper than 9,090 feet; a 3M system for a well not deeper than 13,636 feet; and a 5M system for a well not deeper than 22,727 feet.

4. **Mud Requirement:** Mud shall be placed between all plugs. Minimum consistency of plugging mud shall be obtained by mixing at the rate of 25 sacks (50 pounds each) of gel per 100 barrels of water. Minimum nine (9) pounds per gallon.

5. **Cement Requirement:** Sufficient cement shall be used to bring any required plug to the specified depth and length. Any given cement volumes on the proposed plugging procedure are merely estimates and are not final. Unless specific approval is received, no plug except the surface plug shall be less than 25 sacks of cement. In lieu of a cement plug in a cased hole, a bridge plug set within 50 feet to 100 feet above the perforations shall be capped with 25 sacks of cement. If a bailer is used to cap this plug, 35 feet of cement shall be sufficient.

Unless otherwise specified in the approved procedure, the cement plug shall consist of either Neat Class "C", for up to 7,500 feet of depth or Neat Class "H", for deeper than 7,500 feet plugs.

6. **Dry Hole Marker:** All casing shall be cut-off at the base of the cellar or 3 feet below final restored ground level (whichever is deeper). The well bore shall then be capped with a 4-inch pipe, 10-feet in length, 4 feet above ground and embedded in cement. The following information shall be permanently inscribed on the dry hole marker: well name and number, name of the operator, lease serial number, surveyed location (quarter-quarter section, section, township and range or other authorized survey designation acceptable to the authorized officer such as metes and bounds).

7. **Subsequent Plugging Reporting:** Within 30 days after plugging work is completed, file one original and five copies of the Subsequent Report of Abandonment, Form 3160-5 to BLM. The report should give in detail the manner in which the plugging work was carried out, the extent (by depths) of cement plugs placed, and the size and location (by depths) of casing left in the well. **Show date well was plugged.**

8. **Trash:** All trash, junk and other waste material shall be contained in trash cages or bins to prevent scattering and will be removed and deposited in an approved sanitary landfill. Burial on site is not permitted.

Following the submission and approval of the Subsequent Report of Abandonment, surface restoration conditions of approval will be developed and furnished to you.

**Accepted for record
NMOCD**

BEPCO, L. P.

NMNM03302; Big Eddy #71
1980' FNL & 1980' FWL
Sec. 7, T22S-R29E
Eddy County, New Mexico

RE: Plugging & Abandonment, Conditions of Approval

2. Plug to be a minimum of 200' (100' plus 10% per 1000').
- 2.a. Add plug, PUH to 6673', perforate & squeeze cmt from 6673'-6513'. WOC and tag. (covers top of Bone Springs). Cut/pull.
3. Spot cmt from 2650'-3011' (includes the Base of Salt)

No other changes

If any questions, call Jim Amos at 505-234-5909.

James A. Amos
SEPS

5/17/08

**Accepted for record
NMOCD**

**BUREAU OF LAND MANAGEMENT
Carlsbad Field Office
620 East Greene Street
Carlsbad, New Mexico 88220
575-234-5972**

**Permanent Abandonment of Federal Wells
Conditions of Approval**

Failure to comply with the following Conditions of Approval may result in a Notice of Incidents of Noncompliance (INC) in accordance with 43 CFR 3163.1.

1. Plugging operations shall commence within ninety (90) days from the approval date of this Notice of Intent to Abandon.

If you are unable to plug the well by the 90th day provide this office, prior to the 90th day, with the reason for not meeting the deadline and a date when we can expect the well to be plugged. Failure to do so will result in enforcement action.

2. **Notification:** Contact the appropriate BLM office at least 24 hours prior to the commencing of any plugging operations. For wells in Chaves and Roosevelt County, call 575-627-0272; Eddy County, call 575-361-2822; Lea County, call 575-393-3612.

3. **Blowout Preventers:** A blowout preventer (BOP), as appropriate, shall be installed before commencing any plugging operation. The minimum BOP requirement is a 2M system for a well not deeper than 9,090 feet; a 3M system for a well not deeper than 13,636 feet; and a 5M system for a well not deeper than 22,727 feet.

4. **Mud Requirement:** Mud shall be placed between all plugs. Minimum consistency of plugging mud shall be obtained by mixing at the rate of 25 sacks (50 pounds each) of gel per 100 barrels of water. Minimum nine (9) pounds per gallon.

5. **Cement Requirement:** Sufficient cement shall be used to bring any required plug to the specified depth and length. Any given cement volumes on the proposed plugging procedure are merely estimates and are not final. Unless specific approval is received, no plug except the surface plug shall be less than 25 sacks of cement. In lieu of a cement plug in a cased hole, a bridge plug set within 50 feet to 100 feet above the perforations shall be capped with 25 sacks of cement. If a bailer is used to cap this plug, 35 feet of cement shall be sufficient.

Unless otherwise specified in the approved procedure, the cement plug shall consist of either Neat Class "C", for up to 7,500 feet of depth or Neat Class "H", for deeper than 7,500 feet plugs.

6. **Dry Hole Marker:** All casing shall be cut-off at the base of the cellar or 3 feet below final restored ground level (whichever is deeper). The well bore shall then be capped with a 4-inch pipe, 10-feet in length, 4 feet above ground and embedded in cement. The following information shall be permanently inscribed on the dry hole marker: well name and number, name of the operator, lease serial number, surveyed location (quarter-quarter section, section, township and range or other authorized survey designation acceptable to the authorized officer such as metes and bounds).

7. **Subsequent Plugging Reporting:** Within 30 days after plugging work is completed, file one original and five copies of the Subsequent Report of Abandonment, Form 3160-5 to BLM. The report should give in detail the manner in which the plugging work was carried out, the extent (by depths) of cement plugs placed, and the size and location (by depths) of casing left in the well. **Show date well was plugged.**

8. **Trash:** All trash, junk and other waste material shall be contained in trash cages or bins to prevent scattering and will be removed and deposited in an approved sanitary landfill. Burial on site is not permitted.

Following the submission and approval of the Subsequent Report of Abandonment, surface restoration conditions of approval will be developed and furnished to you.

**Accepted for record
NMOCD**