



OCD-ARTESIA

MAY 15 2008

OCD-ARTESIA

FORM APPROVED
OMB No 1004-0137
Expires March 31, 2007UNITED STATES
DEPARTMENT OF THE INTERIOR
BUREAU OF LAND MANAGEMENT

APPLICATION FOR PERMIT TO DRILL OR REENTER

1a. Type of work: <input checked="" type="checkbox"/> DRILL <input type="checkbox"/> REENTER		5. Lease Serial No. NMLC 063418 A
1b. Type of Well: <input type="checkbox"/> Oil Well <input checked="" type="checkbox"/> Gas Well <input type="checkbox"/> Other <input type="checkbox"/> Single Zone <input type="checkbox"/> Multiple Zone		6. If Indian, Allottee or Tribe Name
2. Name of Operator BEPKO, L. P.		7. If Unit or CA Agreement, Name and No
3a. Address P. O. Box 2760 Midland, TX 79702		8. Lease Name and Well No. BIG EDDY UNIT # 220
3b. Phone No. (include area code) 432-683-2277		9. API Well No. 30-015-36339
4. Location of Well (Report location clearly and in accordance with any State requirements *) At surface SWSE, 810' FSL, 1980' FEL, Lat N32.488922, Long W103.987425 At proposed prod. zone Same		10. Field and Pool, or Exploratory Golden Lane (Morrow)
11. Sec., T. R. M. or Blk. and Survey or Area S9-T21S-R29E-NMP, SME BLM		
14. Distance in miles and direction from nearest town or post office* 10 MILES NE OF CARLSBAD, NM		12. County or Parish EDDY COUNTY
15. Distance from proposed* location to nearest property or lease line, ft (Also to nearest drig. unit line, if any) 810		13. State NM
16. No. of acres in lease 640		17. Spacing Unit dedicated to this well 320
18. Distance from proposed location* to nearest well, drilling, completed, applied for, on this lease, ft 3,862.9		20. BLM/BIA Bond No. on file NM-2204
19. Proposed Depth 13,100		
21. Elevations (Show whether DF, KDB, RT, GL, etc.) GL - 3375'		22. Approximate date work will start* 07/10/2008
		23. Estimated duration 46

24. Attachments

The following, completed in accordance with the requirements of Onshore Oil and Gas Order No.1, shall be attached to this form:

- Well plat certified by a registered surveyor.
- A Drilling Plan.
- A Surface Use Plan (if the location is on National Forest System Lands, the SUPO shall be filed with the appropriate Forest Service Office)
- Bond to cover the operations unless covered by an existing bond on file (see Item 20 above).
- Operator certification
- Such other site specific information and/or plans as may be required by the authorized officer.

25. Signature <i>Annette Childers</i>	Name (Printed/Typed) Annette Childers	Date 2-19-2008
Title Administrative Assistant		

Approved by (Signature) <i>/s/ James Stovall</i>	Name (Printed/Typed) <i>/s/ James Stovall</i>	Date MAY 13 2008
Title FIELD MANAGER		Office CARLSBAD FIELD OFFICE

Application approval does not warrant or certify that the applicant holds legal or equitable title to those rights in the subject lease which would entitle the applicant to conduct operations thereon.
Conditions of approval, if any, are attached.

APPROVAL FOR TWO YEARS

Title 18 U.S.C. Section 1001 and Title 43 U.S.C. Sec. 1702
States any false, fictitious or fraudulent statementNOTE: New Pit Rule
NMAC 19-15-17

illegally to make to any department or agency of the United States

CAPTAIN CONTROLLED WATER BASIN

SEE ATTACHED FOR
CONDITIONS OF APPROVALAPPROVAL SUBJECT TO
GENERAL REQUIREMENTS
AND SPECIAL STIPULATIONS
ATTACHED

DISTRICT I
1626 N. French Dr., Hobbs, NM 88240
DISTRICT II
1301 W. Grand Avenue, Artesia, NM 88210
DISTRICT III
1000 Rio Brazos Rd., Aztec, NM 87410
DISTRICT IV
1220 St. Francis Dr., Santa Fe, NM 87505

State of New Mexico
Energy, Minerals and Natural Resources Department

OIL CONSERVATION DIVISION
1220 South St. Francis Dr.
Santa Fe, New Mexico 87505

Form C-102
Revised October 12, 2005

Submit to Appropriate District Office
State Lease - 4 Copies
Fee Lease - 3 Copies

☐ AMENDED REPORT

WELL LOCATION AND ACREAGE DEDICATION PLAT

API Number	Pool Code 77560	Pool Name Golden Horn (Morrow) Field
Property Code 1776	Property Name BIG EDDY UNIT	Well Number 220
OGRID No. 001801	Operator Name BEPCO, L.P.	Elevation 3375'

Surface Location

UL or lot No.	Section	Township	Range	Lot Idn	Feet from the	North/South line	Feet from the	East/West line	County
0	9	21 S	29 E		810	SOUTH	1980	EAST	EDDY

Bottom Hole Location If Different From Surface

UL or lot No.	Section	Township	Range	Lot Idn	Feet from the	North/South line	Feet from the	East/West line	County
Dedicated Acres 320	Joint or Infill N	Consolidation Code	Order No.						

NO ALLOWABLE WILL BE ASSIGNED TO THIS COMPLETION UNTIL ALL INTERESTS HAVE BEEN CONSOLIDATED
OR A NON-STANDARD UNIT HAS BEEN APPROVED BY THE DIVISION

	<p>OPERATOR CERTIFICATION</p> <p>I hereby certify that the information contained herein is true and complete to the best of my knowledge and belief, and that this organization either owns a working interest or unleased mineral interest in the land including the proposed bottom hole location pursuant to a contract with an owner of such a mineral or working interest, or to a voluntary pooling agreement or a compulsory pooling order heretofore entered by the Division.</p> <p>Signature _____ Date 2/15/08</p> <p>Stephen Martinez Printed Name</p> <p>SURVEYOR CERTIFICATION</p> <p>I hereby certify that the well location shown on this plat was plotted from field notes of actual surveys made by me or under my supervision, and that the same is true and correct to the best of my belief.</p> <p>FEBRUARY 4, 2008</p> <p>Date Surveyed _____ Signature _____ Professional Surveyor</p> <p>Certificate No. Gary L. Jones 7977</p> <p>BASIN SURVEYS</p>
--	---

Form 3160-5
(April 2004)

UNITED STATES
DEPARTMENT OF THE INTERIOR
BUREAU OF LAND MANAGEMENT



OCD-ARTESIA

FORM APPROVED
OMB No 1004-0137
Expires March 31, 2007

SUNDRY NOTICES AND REPORTS ON WELLS

Do not use this form for proposals to drill or to re-enter an abandoned well. Use Form 3160-3 (APD) for such proposals.

SUBMIT IN TRIPLICATE- Other instructions on reverse side.

1 Type of Well ☐ Oil Well ☒ Gas Well ☐ Other

MAY 15 2008

2. Name of Operator **BEPCO, L. P.**

OCD-ARTESIA

3a Address
P. O. Box 2760 Midland, TX 79702

3b Phone No (include area code)
432-683-2277

4 Location of Well (Footage, Sec., T., R., M., or Survey Description)
810' FSL & 1980' FEL of Section 9, T21S, R29E, MER NMP, SME BLM

5 Lease Serial No.

NMLC 063418

6 If Indian, Allottee or Tribe Name

7 If Unit or CA/Agreement, Name and/or No

8 Well Name and No.

Big Eddy Unit #220

9 API Well No

10 Field and Pool, or Exploratory Area
Quahada Ridge (Morrow)

11 County or Parish, State

Eddy County, New Mexico

12. CHECK APPROPRIATE BOX(ES) TO INDICATE NATURE OF NOTICE, REPORT, OR OTHER DATA

TYPE OF SUBMISSION	TYPE OF ACTION			
<input checked="" type="checkbox"/> Notice of Intent	<input type="checkbox"/> Acidize	<input type="checkbox"/> Deepen	<input type="checkbox"/> Production (Start/Resume)	<input type="checkbox"/> Water Shut-Off
<input type="checkbox"/> Subsequent Report	<input type="checkbox"/> Alter Casing	<input type="checkbox"/> Fracture Treat	<input type="checkbox"/> Reclamation	<input type="checkbox"/> Well Integrity
<input type="checkbox"/> Final Abandonment Notice	<input type="checkbox"/> Casing Repair	<input type="checkbox"/> New Construction	<input type="checkbox"/> Recomplete	<input type="checkbox"/> Other
	<input checked="" type="checkbox"/> Change Plans	<input type="checkbox"/> Plug and Abandon	<input type="checkbox"/> Temporarily Abandon	
	<input type="checkbox"/> Convert to Injection	<input type="checkbox"/> Plug Back	<input type="checkbox"/> Water Disposal	

13 Describe Proposed or Completed Operation (clearly state all pertinent details, including estimated starting date of any proposed work and approximate duration thereof. If the proposal is to deepen directionally or recompleat horizontally, give subsurface locations and measured and true vertical depths of all pertinent markers and zones. Attach the Bond under which the work will be performed or provide the Bond No on file with BLM/BIA. Required subsequent reports shall be filed within 30 days following completion of the involved operations. If the operation results in a multiple completion or recompleat in a new interval, a Form 3160-4 shall be filed once testing has been completed. Final Abandonment Notices shall be filed only after all requirements, including reclamation, have been completed, and the operator has determined that the site is ready for final inspection.)

With consideration given to the request of the surface leasee, Justin Magby, BEPCO L.P. respectfully requests to alter the proposed access road to the Big Eddy Unit #220 located in Section 9, T21S, R29E. After meeting with Justin Magby and Cody Layton (BLM Natural Resource Specialist) on 3/31/08 a new access route was agreed upon by all parties present. The proposed access route was changed to avoid a potential fencing problem for the leasee.

OK C.L. 04/22/08

SM 4/17/08

14 I hereby certify that the foregoing is true and correct
Name (Printed/Typed)

Annette Childers

Title **Administrative Assistant**

Signature

Annette Childers

Date

4-17-2008

THIS SPACE FOR FEDERAL OR STATE OFFICE USE

Approved by

/s/ James Stovall

FIELD MANAGER

Date

MAY 13 2008

Conditions of approval, if any, are attached. Approval of this notice does not warrant or certify that the applicant holds legal or equitable title to those rights in the subject lease which would entitle the applicant to conduct operations thereon.

Office

CARLSBAD FIELD OFFICE

Title 18 USC Section 1001 and Title 43 USC Section 1212, make it a crime for any person knowingly and willfully to make to any department or agency of the United States any false, fictitious or fraudulent statements or representations as to any matter within its jurisdiction.

(Instructions on page 2)

<p style="text-align: center;">-----160.03 ACRES-----</p>	<p style="text-align: center;">-----159.99 ACRES-----</p>
<p style="text-align: center;">-----160.03 ACRES-----</p>	<p style="text-align: center;">-----159.99 ACRES-----</p>

LAT - N32°29'20.12"
 LONG - W103°59'14.73"
 SPC- N.: 541774.056
 E.: 647992.371
 (NAD-83)

SECTION 9, TOWNSHIP 21 SOUTH, RANGE 29 EAST, N.M.P.M.,
EDDY COUNTY, NEW MEXICO.

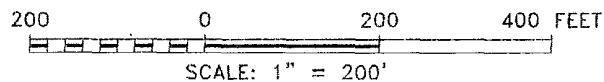
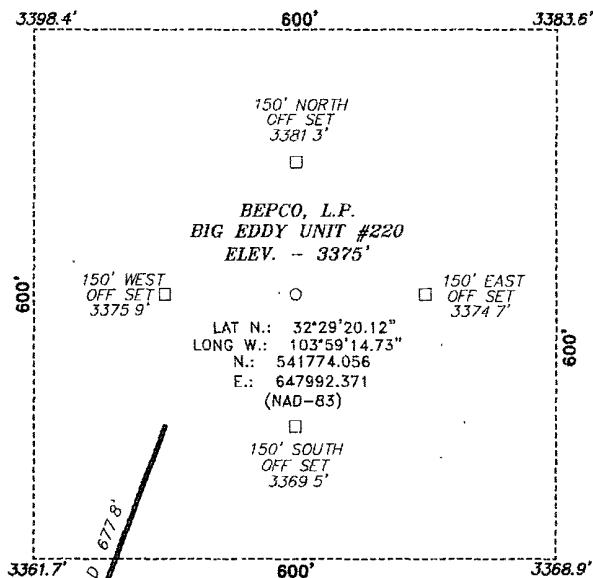

DIRECTIONS TO LOCATION:

FROM MILE MARKER 53 ON US HWY 62/180, GO WEST FOR 0.7 MILE TO A ROAD, THENCE SOUTHERLY FOR 3.1 MILES TO A "Y", TAKE LEFT FORK AND CONTINUE EAST FOR 0.8 MILE TO A FORK AND TAKE THE LEFT MOST ROAD AND CONTINUE 0.1 MILE TO THE CHI-CHI 16 STATE #1, GO THROUGH PAD AND CONTINUE FOR 0.2 MILE TO A PROPOSED LEASE ROAD

BASIN SURVEYS P.O. BOX 1786 - HOBBS, NEW MEXICO

W.O. Number: 19080

Drawn By: K. GOAD

Date: 02-05-2008

Disk: KJG - 19080W.DWG

BEPCO, L.P.	
REF: BIG EDDY UNIT #220 / WELL PAD AND TOPO	
THE BIG EDDY UNIT #220 LOCATED 810' FROM	
THE SOUTH LINE AND 1980' FROM THE EAST LINE OF	
SECTION 9, TOWNSHIP 21 SOUTH, RANGE 29 EAST,	
N.M.P.M., EDDY COUNTY, NEW MEXICO.	
Survey Date: 02-04-2008	Sheet 1 of 1 Sheets

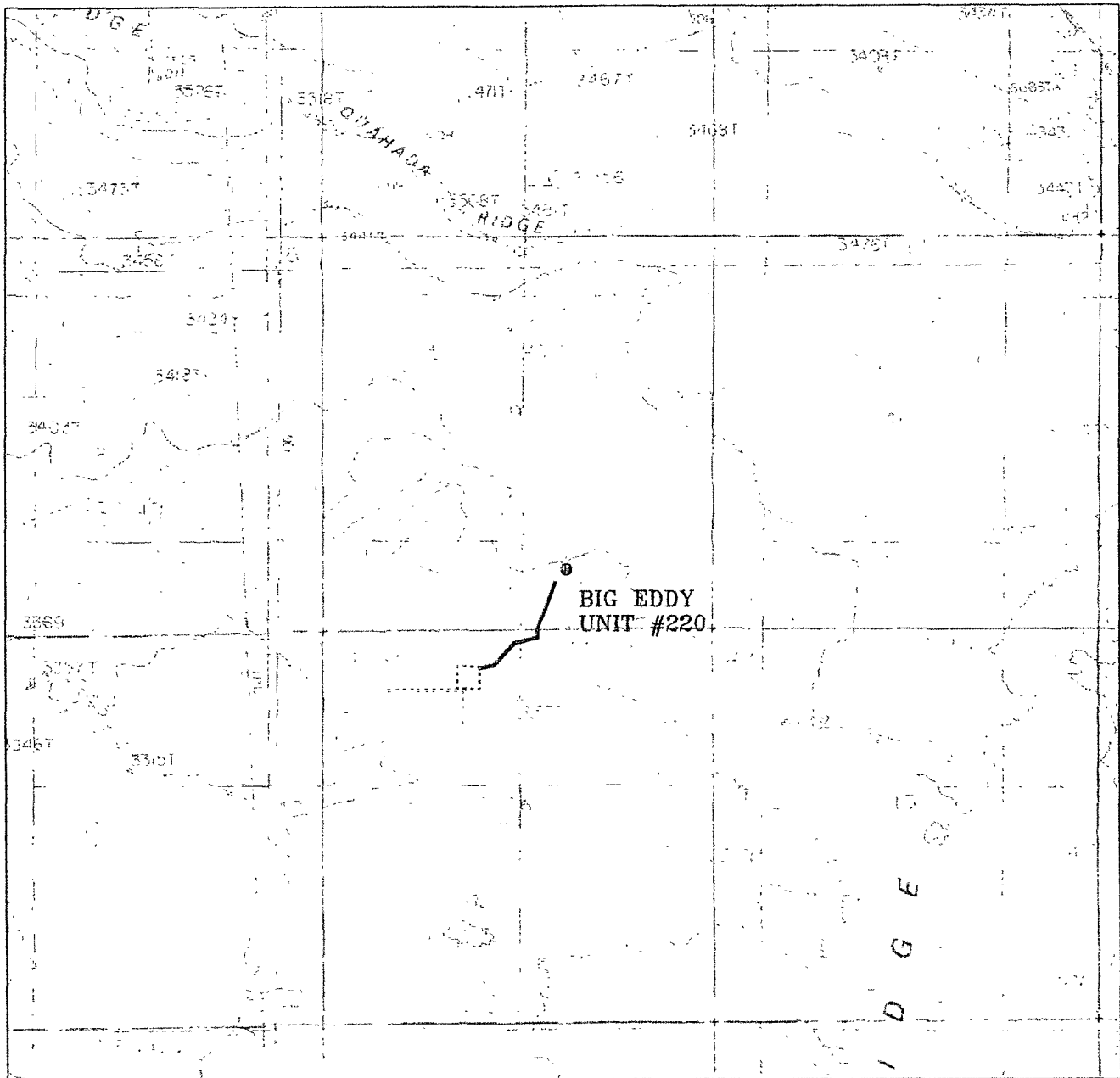

BIG EDDY UNIT #220

surveys

BEPCO, L.P.

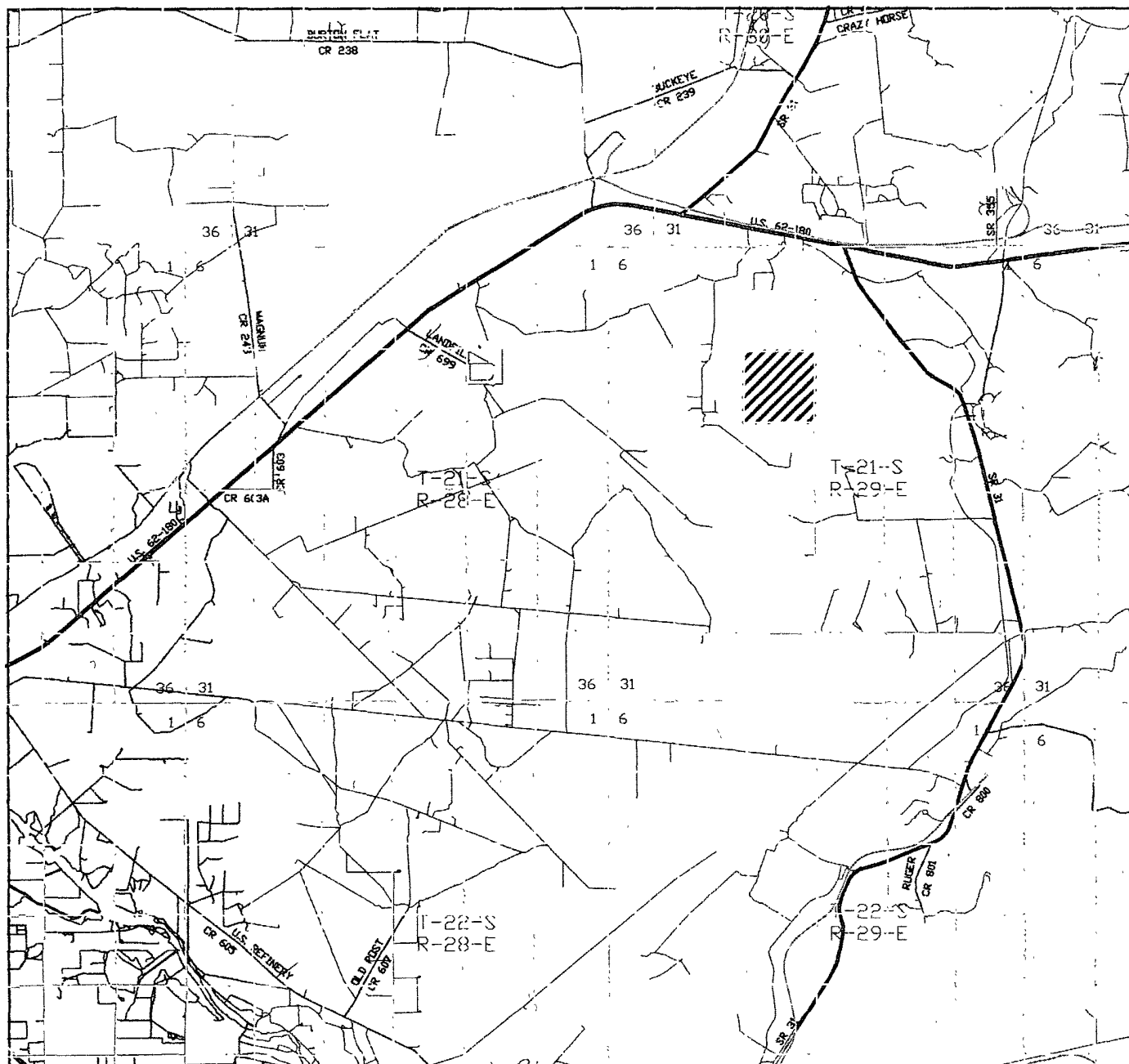

BIG EDDY UNIT #220
 810' FSL and 1980' FEL
 Section 9, Township 21 South, Range 29 East,
 N.M.P.M., Eddy County, New Mexico.

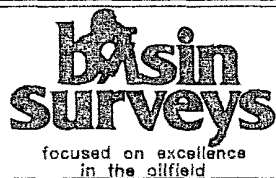

P.O. Box 1786
 1120 N. West County Rd.
 Hobbs, New Mexico 88241
 (505) 393-7316 - Office
 (505) 392-3074 - Fax
 basinsurveys.com

W.O. Number: KJG - 19080TR.DWG

Survey Date: 02-04-2008

Scale: 1" = 2 MILES

Date: 02-05-2008

BEPCO, L.P.

Surface casing to be set into the Rustler below all fresh water sands.

Production casing will be cemented using Halliburton Premium Plus w/ TOC 500' inside the intermediate casing set at 3,083'. Drilling procedure, BOP diagram, anticipated tops and surface plans attached.

This well is located outside the Secretary's Potash area and outside the R-111 Potash area. There are no potash leases within 1 mile of the location.

BEPCO, L.P., at P. O. Box 2760, Midland, TX, 79702 is a division office of BEPCO, L.P., 201 Main Street, Ft. Worth, TX 76102, Bond No. NM 2204 (Nationwide).

**EIGHT POINT DRILLING PROGRAM
BASS ENTERPRISES PRODUCTION CO.**

NAME OF WELL: BIG EDDY UNIT #220

LEGAL DESCRIPTION - SURFACE: 810' FSL & 1980' FEL, Section 9, T21S, R29E, Eddy County, New Mexico.

POINT 1: ESTIMATED FORMATION TOPS

(See No. 2 Below)

POINT 2: WATER, OIL, GAS AND/OR MINERAL BEARING FORMATIONS

Anticipated Formation Tops: KB 3393' (est.)
GL 3375'

<u>FORMATION</u>	<u>ESTIMATED TOP FROM KB</u>	<u>ESTIMATED SUBSEA TOP</u>	<u>BEARING</u>
T/Rustler	443'	2,950'	Barren
T/Salt	833'	2,560'	Barren
B/Salt	2,618'	775'	Barren
T/Delaware Lime	3,023'	370'	Barren
T/Delaware Sands	3,143'	250'	Barren
T/Old Indian Draw	4,088'	-695'	Oil/Gas
T/Bone Spring Lime	6,793'	-3,400'	Oil/Gas
T/Wolfcamp	9,983'	-6,590'	Oil/Gas
T/Strawn	11,145'	-7,752'	Oil/Gas
T/Atoka	11,565'	-8,172'	Oil/Gas
T/Upper Morrow	12,125'	-8,732'	Oil/Gas
T/Middle Morrow	12,363'	-8,970'	Oil/Gas
T/Lower Morrow	12,663'	-9,270'	Oil/Gas
TD	13,100'	-9,707'	

see COA [Note: Per confirmation from Mr. John Simitz (NMBLM Geologist) on 2/14/08, based on corollary log data from the Golden D federal #2 located in Section 8, T21S R29E the Capitan Reef formation is not expected to be encountered.

POINT 3: CASING PROGRAM

<u>TYPE</u>	<u>HOLE SIZE</u>	<u>INTERVALS</u>	<u>PURPOSE</u>	<u>CONDITION</u>
20", 94#, H-40, STC	26"	0' - 61'	Conductor	Contractor Discretion
13-3/8", 48#, H-40, STC	17-1/2"	0' - 823'	Surface	New
9-5/8", 36#, J-55, LTC	12-1/4"	0' - 3,083'	Intermediate	New
5-1/2", 17#, HCP-110, LTC	8-3/4"	0' - 10,900'	Production Casing	New
5-1/2", 20#, P-110, LTC	8-3/4"	10,900' - 13,100'	Production Casing	New

CASING DESIGN SAFETY FACTORS:

<u>TYPE</u>	<u>TENSION</u>	<u>COLLAPSE</u>	<u>BURST</u>
13-3/8", 48#, H-40, STC	15.93	1.88	3.77
9-5/8", 36#, J-55, LTC	6.02	1.23	2.05
5-1/2", 17#, HCP-110, LTC	2.85	1.14	2.07
5-1/2", 20#, P-110, LTC	17.40	1.49	2.45

DESIGN CRITERIA AND CASING LOADING ASSUMPTIONS:**SURFACE CASING**

Tension	A 1.6 design factor utilizing the effects of buoyancy (9.2 ppg).
Collapse	A 1.0 design factor with full internal evacuation and a collapse force equal to the mud gradient in which the casing will be run (0.48 psi/ft). The effects of axial load on collapse will be considered.
Burst	A 1.3 design factor with a surface pressure equal to the fracture gradient at setting depth less a gas gradient to the surface. Internal burst force at the shoe will be fracture pressure at that depth. Backup pressure will be formation pore pressure. In all cases a conservative fracture pressure will be used such that it represents the upper limit of potential fracture resistance up to a 1.0 psi/ft gradient. The effects of tension on burst will not be utilized.

PROTECTIVE CASING

Tension	A 1.6 design factor utilizing the effects of buoyancy (10.2 ppg).
Collapse	<p>A 1.0 design factor with full internal evacuation and a collapse force equal to the mud gradient in which the casing will be run (0.53 psi/ft). The effects of axial load on collapse will be considered.</p> <p>In the case of development drilling, collapse design should be analyzed using internal evacuation equal to 1/3 the proposed total depth of the well. This criterion will be used when there is absolutely no potential of the protective string being used as a production casing string.</p>
Burst	A 1.0 surface design factor and a 1.3 downhole design factor with a surface pressure equivalent to the fracture gradient at setting depth less a gas gradient to the surface. Internal burst force at the shoe will be fracture pressure at that depth. Backup pressure will be formation pore pressure. In all cases a conservative fracture pressure will be used such that it represents the upper limit of potential fracture resistance up to a 1.0 psi/ft gradient.

PRODUCTION CASING

Tension	A 1.6 design factor utilizing the effects of buoyancy (10.7 ppg).
Collapse	A 1.0 design factor with full internal evacuation and a collapse force equal to the mud gradient in which the casing will be run (0.56 psi/ft). The effects of axial load on collapse will be considered.
Burst	A 1.25 design factor with anticipated maximum tubing pressure (5045 psig) on top of the maximum anticipated packer fluid gradient. Backup on production strings will be formation pore pressure (0.43 psi/ft). The effects of tension on burst will not be utilized.

POINT 4: PRESSURE CONTROL EQUIPMENT (SEE ATTACHED DIAGRAM)

A rotating head will be nipped up on the intermediate casing. The rotating head will not be hydro-tested.

A BOP equivalent to Diagram 1 will be nipped up on the surface casing head and the intermediate casing. The BOP stack, choke, etc. when rigged up on surface casing, will be tested to 70% of interval yield of casing or 1000 psig whichever is less. On the intermediate casing, the BOP stack, choke, kill lines, kelly cocks, inside BOP, etc. will be hydro-tested to 5,000 psi on the intermediate casing. The annular will be tested to 2500 psi. In addition to the rated working pressure test, a low pressure (250 psi) test will be required. These tests will be performed:

- a) Upon installation
- b) After any component changes
- c) Twenty-one days after a previous test or before drilling into the Wolfcamp
- d) As required by well conditions

A function test to insure that the preventers are operating correctly will be performed on each trip. See the attached Diagram 1 for the minimum criteria for the choke manifold.

POINT 5: MUD PROGRAM

DEPTH	MUD TYPE	WEIGHT	FV	PV	YP	FL	Ph
0' – 823'	FW	8.6 - 9.2	55-60	NC	NC	NC	9.5
823' – 3,083'	BW	10.0 – 10.2	28-30	NC	NC	NC	9.5 – 10.0
3,083' – 9,700'	FW	8.6 – 8.9	28-30	NC	NC	NC	9.5 – 10.0
9,700' – 11,000'	CBW	9.0 – 10.2	28-30	NC	NC	NC	9.5
11,000' – 11,500'	CBW/Polymer	9.0 – 10.7	34-38	6-10	8-12	<20	9.5-10
11,500' – TD'	CBW/Polymer	9.0 – 10.7	34-55	6-10	8-12	<10	9.5-10

POINT 6: TECHNICAL STAGES OF OPERATION

A) TESTING

Drill stem tests may be performed on significant shows in zones of interest, but none are planned at this time.

B) LOGGING

Run #1:

PEX (GR-CNL/LDT-HRLA) run from TD to intermediate casing point (\pm 3,083'), GR-CNL to surface. Possible PEX (GR-CNL/LDT-AIT) over Delaware.

C) CORING

No cores are anticipated.

D) CEMENT

INTERVAL	AMOUNT SX	FT OF FILL	TYPE	GALS/SX	PPG	FT ³ /SX
SURFACE						
Lead						
0' – 523'						
(100% excess)	400	523	Haliburton Light + Premium Plus + 2.7 pps salt	10.14	12.80	1.87
Tail						
523' – 823'						
(100% excess)	365	300	Premium Plus + 2% CaCl ₂	6.37	14.80	1.35
INTERMEDIATE						
Lead						
0 – 2,583'						
(100% Excess)	685	2583	Premium Interfill H + 8 pps Gilsonite	16.43	11.50	2.76
Tail						
2,583' - 3,083'						
(100% Excess)	225	500	Super H + 5 pps Gilsonite + 3 pps Salt + 0.5% LAP-1 + 0.4% CFR-3 + 0.25 pps Defoamer + 0.25 pps Pol-E-Flake	4.72	13.2	1.60
PRODUCTION						
1 st Stage	(Two stage w/DV tool @ 6500' and circulate cement to 6000')					
Lead						
6500-10645'						
(50% excess)	645	4145	Interfill H + 5 pps Gilsonite + 0.125 pps Pol-E-Flake + 0.5% Halad 9 + 0.3% HR-601	13.61	11.90	2.46
Tail						
10645-13100'						
(50% excess)	575	2455	Super H + 0.5% Halad 344 + 0.4% CFR3 + 5 pps Gilsonite + 1 pps Salt + 0.3% HR-601	7.73	13.20	1.60
2 nd Stage						
Lead						
2583-6000'						
(50% excess)	160	1147	Premium Interfill H + 0.125 pps Pol-E-Flake	14.10	11.90	2.46
Tail						
6000-6500'						
(50% excess)	165	500	Premium H Cement + 0.5% Halad 9	5.20	15.6	1.18

2583' as per
STEVEN MARTINEZ
w/ Beeco

see COA

E) DIRECTIONAL DRILLING

No directional services anticipated. A straight hole will be drilled to 13,100' TD.

POINT 7: ANTICIPATED RESERVOIR CONDITIONS

Normal pressures are anticipated throughout the Delaware and Bone Spring. The Wolfcamp and Strawn sections will have pressures in the 5200 – 5800 psi range (10.0 ppg). Due to the tight nature of the Atoka reservoir rock (high pressure, low volume), the well may be drilled under balanced utilizing a rotating head. The maximum BHP could be as high as 7300 psi (10.7 ppg). The Morrow will be normally pressured. The expected BHT at TD is 200°F. No H₂S is anticipated.

POINT 8: OTHER PERTINENT INFORMATION

A) Auxiliary Equipment

Upper and lower kelly cocks. Full opening stab in valve on the rig floor.

B) Anticipated Starting Date

Spud date is 7/10/2008.

46 days drilling operations

20 days completion operations

SMM/mac

Rig Layout Schematic Exhibit 'D'

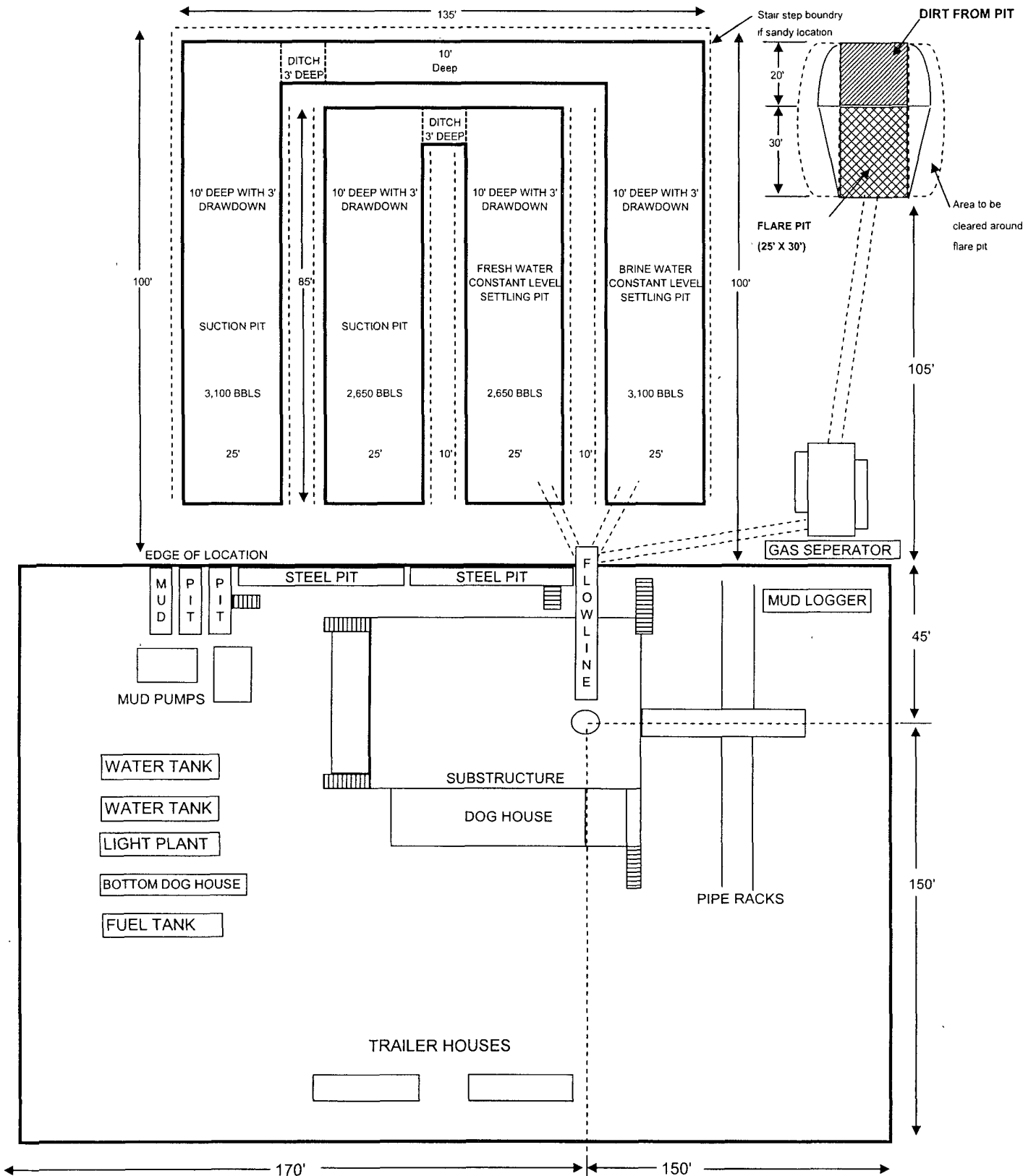

BEPCO, L. P.

10-M WP BOPE WITH 5-M WP ANNULAR

10 M CHOKE MANIFOLD EQUIPMENT-CONFIGURATION MAY VARY

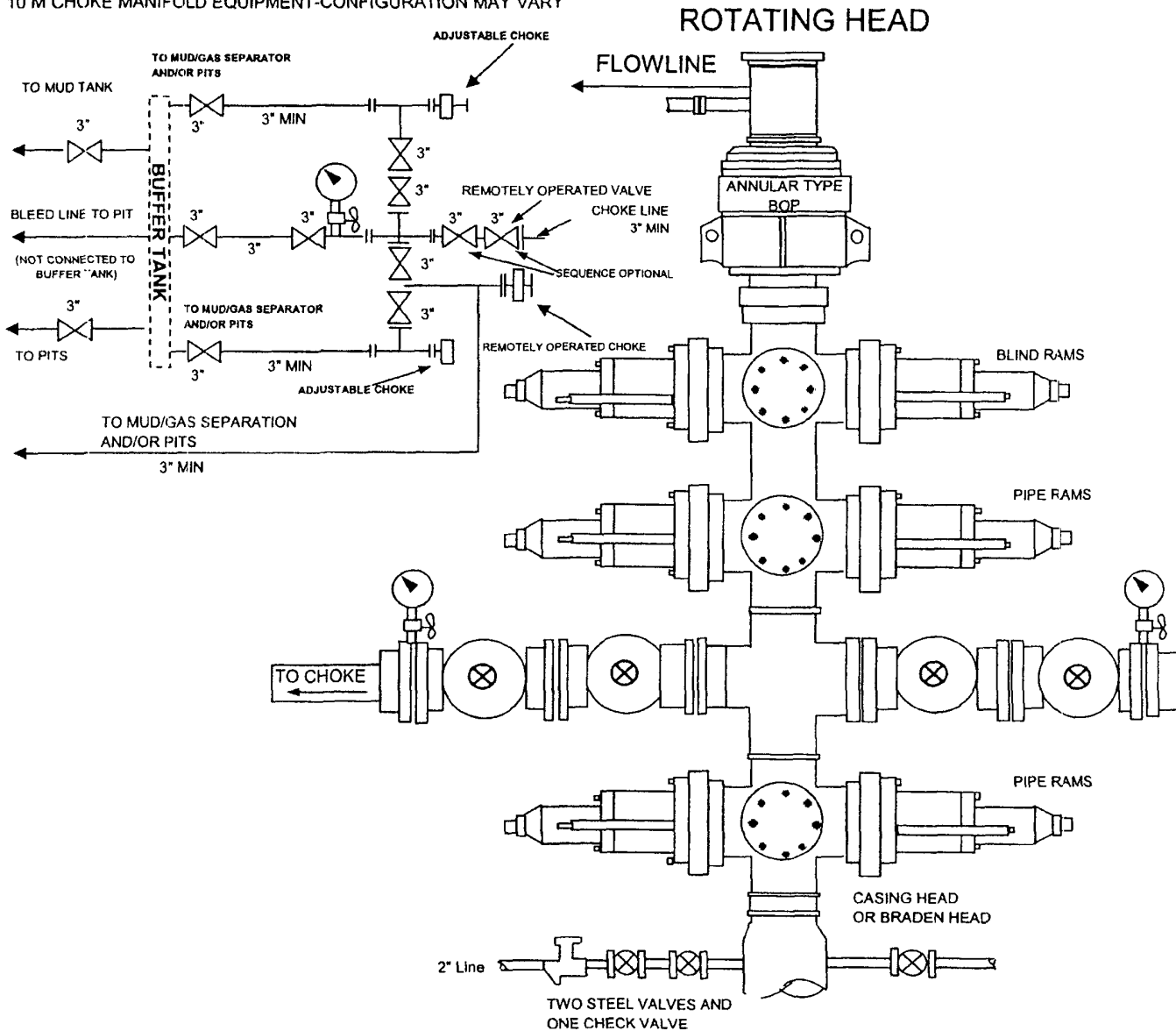

DIAGRAM 1

MULTI-POINT SURFACE USE PLAN

NAME OF WELL: BIG EDDY UNIT #220

LEGAL DESCRIPTION – SURFACE: 810' FSL & 1980' FEL, Section 9, T21S-R29E, Eddy County, NM

POINT 1: EXISTING ROADS

A) Proposed Well Site Location

See Exhibit "A".

B) Existing Roads:

From mile marker 53 on US Hwy 62/180, go west for 0.7 mile to a road; thence southerly for 3.1 miles to a 'Y', take left fork and continue east for 0.8 mile to a fork and take the left most road and continue 0.1 mile to the Chi-Chi 15 State #1; go through pad and continue for 0.2 mile to a proposed lease road.

C) Existing Road Maintenance or Improve Plan:

See Exhibit "B"

POINT 2: NEW PLANNED ACCESS ROUTE

A) Route Location:

See Exhibit "B". The new road will be 12' wide and approximately ^{1759'}~~2236.1'~~ long from existing lease road. The road will be constructed of watered and 6" of compacted caliche. *C.L. 4/22/08*

B) Width

12' Wide.

C) Maximum Grade

Not Applicable.

D) Turnouts

As required by BLM stipulations

E) Culverts, Cattle Guards, and Surfacing Equipment

None

POINT 3: LOCATION OF EXISTING WELLS

Exhibit "C" indicates existing wells within the surrounding area.

POINT 4: LOCATION OF EXSITING OR PROPOSED FACILITIES

A) Existing facilities within one mile owned or controlled by lessee/operator.

There are no existing facilities within one mile of this location.

POINT 4: LOCATION OF EXSITING OR PROPOSED FACILITIES

B) New Facilities in the Event of Production:

New production facilities will be installed at the new location.

C) Rehabilitation of Disturbed Areas Unnecessary for Production:

Following the construction of production facilities, those access areas required for continued production will be graded to provide drainage and minimize erosion. The areas necessary for use will be graded to blend in the surrounding topography – See Point 10.

POINT 5: LOCATION AND TYPE OF WATER SUPPLY

A) Location and Type of Water Supply

Fresh water will be hauled from the City of Carlsbad or piped from the IMC Booster Station water well located 5.2 miles east of Carlsbad. Brine water will be hauled from I & W Brine Water Station 0.75 miles southeast of Carlsbad.

B) Water Transportation System

Water hauled to the location will be over the existing and proposed roads.

POINT 6: SOURCE OF CONSTRUCTION MATERIALS

A) Materials

Onsite Caliche.

B) Land Ownership

Federally Owned.

C) Materials Foreign to the Site

On site caliche will be used, but if necessary caliche will be hauled from the nearest BLM approved caliche pit.

D) Access Roads

2,236.1' of new access road will be required. See Exhibit "B".

POINT 7: METHODS FOR HANDLING WASTE MATERIAL

A) Cuttings

Cuttings will be contained in the reserve pit.

B) Drilling Fluids

Drilling fluids will be contained in the reserve pit.

C) Produced Fluids

Water Production will be contained in the reserve pit.

Hydrocarbon fluid or other fluids that may be produced during testing will be retained in the test tanks. Prior to cleanup operations, any hydrocarbon material in the reserve pit will be removed by skimming or burning as the situation would dictate.

D) Sewage

Current laws and regulations pertaining to the disposal of human waste will be complied with.

E) Garbage

Portable containers will be utilized for garbage disposal during the drilling of this well.

F) Cleanup of Well Site

Upon release of the drilling rig, the surface of the drilling pad will be graded to accommodate a completion rig if testing indicates potential productive zones. In any case, the "mouse" hole and the "rat" hole will be covered. The reserve pit will be fenced and the fence maintained until the pit is backfilled. Reasonable cleanup will be performed prior to the final restoration of the site.

POINT 8: ANCILLARY FACILITIES

We will be constructing a new gathering line to the north or east to tie into existing pipelines.

POINT 9: WELL SITE LAYOUT

A) Rig Orientation and Layout

Exhibit "D" show the dimensions of the well pad and reserve pits and the location of major rig components. Only minor leveling of the well site will be required. No significant cuts or fills will be necessary.

B) Locations of Pits and Access Road

See Exhibits "B" and "D"

C) Lining of the Pits

The reserve pit will be lined with >20 mil plastic.

POINT 10: PLANS FOR RESTORATION OF THE SERVICE

A) Reserve Pit Cleanup

A pit will be fenced at the time of rig release and shall be maintained until the pit is backfilled. Previous to backfill operations, any hydrocarbon material on the pit surface shall be removed. The fluids and solids contained in the pit shall be backfilled with soil excavated from the site and soil adjacent to the reserve pit. The restored surface of the pit shall be contoured to prevent impoundment of surface water flow. Water – bars will be constructed as needed to prevent excessive erosion. Topsoil, as available, shall be placed over the restored surface in a uniform layer. The area will be seeded according to the BLM stipulations during the appropriate season following restoration.

B) Restoration Plans – Production Developed

The reserve pit will be backfilled and restored as described above under Item A. In addition, those areas not required for production will be graded to blend with the surrounding topography. Topsoil, as available, will be placed upon those areas and seeded. The portion of the site required for production will be graded to minimize erosion and provide access during inclement conditions. Following depletion and abandonment of the site, restoration procedures will be those that follow under Item C.

C) Restoration Plans – No Production Developed

The reserve pit will be restored as described above. With no production developed, the entire surface disturbed by construction of the well site will be restored. The site will be contoured to blend with the surrounding topography and provide drainage of surface water. The topsoil, as available, shall be replaced in a uniform layer and seeded according to the BLM stipulations.

D) Rehabilitation Timetable

Upon completion of drilling operations, the initial cleanup of the site will be performed as soon as weather and site conditions allow economic execution of the work.

POINT 11: OTHER INFORMATION

A) Terrain

Relatively Flat

B) Soil

Caliche and sand.

C) Vegetation

Sparse, primarily grasses and mesquite with very little grass.

D) Surface Use

Primarily grazing.

E) Surface Water

There are no ponds, lakes, streams, or rivers within several miles of the wellsite.

F) Water Wells

There are no water wells within 1 mile of location.

G) Residences and Buildings

None in the immediate vicinity.

H) Historical Sites

None observed.

I) Archeological Resources

An archeological survey will be obtained for this area. The survey area will be a 600' x 600' square with its center on the wellhead stake. Before any construction begins, a full and complete archeological survey will be submitted to the BLM. Any location or construction conflicts will be resolved before construction begins.

J) Surface Ownership

The well site and access road are both on federally owned land.

K) Well signs will be posted at the drilling site.

L) Open Pits

All pits containing liquid or mud will be fenced and bird-netted.

POINT 12: OPERATOR'S FIELD REPRESENTATIVE

(Field personnel responsible for compliance with development plan for surface use).

DRILLING
Stephen M. Martinez
Box 2760
Midland, Texas 79702
(432) 683-2277

PRODUCTION
Mike Waygood
3104 East Green Street
Carlsbad, New Mexico 88220
(505) 887-7329

Steve Johnson
Box 2760
Midland, Texas 79702
(432) 683-2277

POINT 13: CERTIFICATION

I hereby certify that I, or persons under my direct supervision have inspected the proposed drill site and access route; that I am familiar with the conditions which currently exist; that the statements made in the plan are, to the best of my knowledge, true and correct; and that the work associated with operations proposed herein will be performed by BEPCO, L.P. and it's contractors and subcontractors in conformity with this plan and the terms and conditions under which it is approved. This statement is subject to the provisions of 18 U.S.C. 1001 for the filing of a false statement.

2/15/2000
Date



Stephen M. Martinez

SMM:bmt

BEPCO, L.P.



Exhibit 'C' Location of Existing Wells

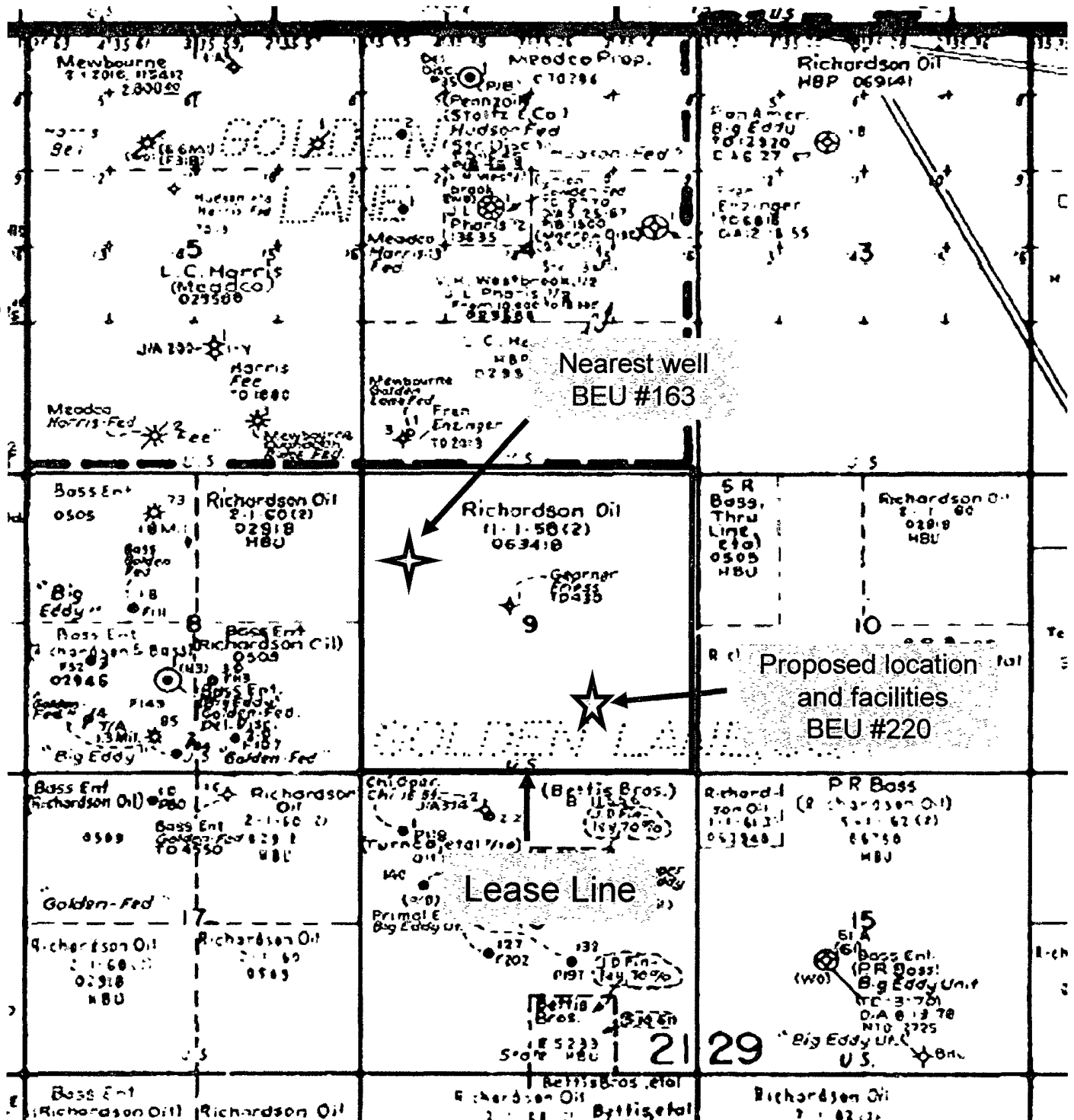

PECOS DISTRICT CONDITIONS OF APPROVAL

OPERATOR'S NAME:	BEPCO, L. P.
LEASE NO.:	NMLC063418A
WELL NAME & NO.:	Big Eddy Unit No 220
SURFACE HOLE FOOTAGE:	810' FSL & 1980' FEL
BOTTOM HOLE FOOTAGE	Same
LOCATION:	Section 9, T. 21 S., R 29 E., NMPM
COUNTY:	Eddy County, New Mexico

TABLE OF CONTENTS

Standard Conditions of Approval (COA) apply to this APD. If any deviations to these standards exist or special COAs are required, the section with the deviation or requirement will be checked below.

- ☐ **General Provisions**
- ☐ **Permit Expiration**
- ☐ **Archaeology, Paleontology, and Historical Sites**
- ☐ **Noxious Weeds**
- ☒ **Special Requirements**
 - Lesser Prairie Chicken
- ☒ **Construction**
 - Notification
 - Topsoil
 - Reserve Pit
 - Federal Mineral Material Pits
 - Well Pads
 - Roads
- ☒ **Road Section Diagram**
- ☒ **Drilling**
- ☐ **Production (Post Drilling)**
 - Well Structures & Facilities
 - Pipelines
 - Electric Lines
- ☐ **Reserve Pit Closure/Interim Reclamation**
- ☐ **Final Abandonment/Reclamation**

I. GENERAL PROVISIONS

The approval of the Application For Permit To Drill (APD) is in compliance with all applicable laws and regulations: 43 Code of Federal Regulations 3160, the lease terms, Onshore Oil and Gas Orders, Notices To Lessees, New Mexico Oil Conservation Division (NMOCD) Rules, National Historical Preservation Act As Amended, and instructions and orders of the Authorized Officer. Any request for a variance shall be submitted to the Authorized Officer on Form 3160-5, Sundry Notices and Report on Wells.

II. PERMIT EXPIRATION

If the permit terminates prior to drilling and drilling cannot be commenced within 60 days after expiration, an operator is required to submit Form 3160-5, Sundry Notices and Reports on Wells, requesting surface reclamation requirements for any surface disturbance. However, if the operator will be able to initiate drilling within 60 days after the expiration of the permit, the operator must have set the conductor pipe in order to allow for an extension of 60 days beyond the expiration date of the APD. (Filing of a Sundry Notice is required for this 60 day extension.)

III. ARCHAEOLOGICAL, PALEONTOLOGY & HISTORICAL SITES

Any cultural and/or paleontological resource discovered by the operator or by any person working on the operator's behalf shall immediately report such findings to the Authorized Officer. The operator is fully accountable for the actions of their contractors and subcontractors. The operator shall suspend all operations in the immediate area of such discovery until written authorization to proceed is issued by the Authorized Officer. An evaluation of the discovery shall be made by the Authorized Officer to determine the appropriate actions that shall be required to prevent the loss of significant cultural or scientific values of the discovery. The operator shall be held responsible for the cost of the proper mitigation measures that the Authorized Officer assesses after consultation with the operator on the evaluation and decisions of the discovery. Any unauthorized collection or disturbance of cultural or paleontological resources may result in a shutdown order by the Authorized Officer.

IV. NOXIOUS WEEDS

The operator shall be held responsible if noxious weeds become established within the areas of operations. Weed control shall be required on the disturbed land where noxious weeds exist, which includes the roads, pads, associated pipeline corridor, and adjacent land affected by the establishment of weeds due to this action. The operator shall consult with the Authorized Officer for acceptable weed control methods, which include following EPA and BLM requirements and policies.

V. SPECIAL REQUIREMENT(S)

Mitigation Measures: The mitigation measures include the Pecos District Conditions of Approval, the standard stipulations for the Lesser Prairie Chicken, and the standard stipulations for permanent resource roads.

Timing Limitation Stipulation/Condition of Approval for Lesser Prairie-Chicken: Oil and gas activities including 3-D geophysical exploration, and drilling will not be allowed in lesser prairie-chicken habitat during the period from March 15 through June 15 annually. During that period, other activities that produce noise or involve human activity, such as the maintenance of oil and gas facilities, geophysical exploration other than 3-D operations, and pipeline, road, and well pad construction, will be allowed except between 3:00 am and 9:00 am. The 3:00 am to 9:00 am restriction will not apply to normal, around-the-clock operations, such as venting, flaring, or pumping, which do not require a human presence during this period. Additionally, no new drilling will be allowed within up to 200 meters of leks known at the time of permitting. Normal vehicle use on existing roads will not be restricted. Exhaust noise from pump jack engines must be muffled or otherwise controlled so as not to exceed 75 db measured at 30 ft. from the source of the noise.

Big Eddy Unit # 220: Pit North V-Door East

VI. CONSTRUCTION

A. NOTIFICATION

The BLM shall administer compliance and monitor construction of the access road and well pad. Notify the Carlsbad Field Office at (505) 234-5972 at least 3 working days prior to commencing construction of the access road and/or well pad.

When construction operations are being conducted on this well, the operator shall have the approved APD and Conditions of Approval (COA) on the well site and they shall be made available upon request by the Authorized Officer.

B. TOPSOIL

The operator shall stockpile the topsoil of the well pad. The topsoil shall not be used to backfill the reserve pit and will be used for interim and final reclamation.

C. RESERVE PITS

The reserve pit shall be constructed and closed in accordance with the NMOCD rules.

The reserve pit shall be constructed 135' X 100' on the North side of the well pad V-Door East.

The reserve pit shall be constructed, so that upon completion of drilling operations, the dried pit contents shall be buried a minimum depth of three feet below ground level. Should the pit content level not meet the three foot minimum depth requirement, the excess contents shall be removed until the required minimum depth of three feet below ground level has been met. The operator shall properly dispose of the excess contents at an authorized disposal site.

The reserve pit shall be constructed and maintained so that runoff water from outside the location is not allowed to enter the pit. The berms surrounding the entire perimeter of the pit shall extend a minimum of two (2) feet above ground level. At no time will standing fluids in the pit be allowed to rise above ground level.

The reserve pit shall be fenced on three (3) sides during drilling operations. The fourth side shall be fenced immediately upon rig release.

D. FEDERAL MINERAL MATERIALS PIT

If the operator elects to surface the access road and/or well pad, mineral materials extracted during construction of the reserve pit may be used for surfacing the well pad and access road and other facilities on the lease.

Payment shall be made to the BLM prior to removal of any additional federal mineral materials from any site other than the reserve pit. Call the Carlsbad Field Office at (505) 234-5972.

E. WELL PAD SURFACING

Surfacing of the well pad is not required.

If the operator elects to surface the well pad, the surfacing material may be required to be removed at the time of reclamation.

The well pad shall be constructed in a manner which creates the smallest possible surface disturbance, consistent with safety and operational needs.

F. ON LEASE ACCESS ROADS

Road Width

The access road shall have a driving surface that creates the smallest possible surface disturbance and does not exceed fourteen (14) feet in width. The maximum width of surface disturbance, when constructing the access road, shall not exceed thirty (30) feet.

Surfacing

Surfacing material is not required on the new access road driving surface. If the operator elects to surface the new access road or pad, the surfacing material may be required to be removed at the time of reclamation.

Where possible, no improvements should be made on the unsurfaced access road other than to remove vegetation as necessary, road irregularities, safety issues, or to fill low areas that may sustain standing water.

The Authorized Officer reserves the right to require surfacing of any portion of the access road at any time deemed necessary. Surfacing may be required in the event the road deteriorates, erodes, road traffic increases, or it is determined to be beneficial for future field development. The surfacing depth and type of material will be determined at the time of notification.

Crowning

Crowning shall be done on the access road driving surface. The road crown shall have a grade of approximately 2% (i.e., a 1" crown on a 14' wide road). The road shall conform to Figure 1; cross section and plans for typical road construction.

Ditching

Ditching shall be required on both sides of the road.

Turnouts

Vehicle turnouts shall be constructed on the road. Turnouts shall be intervisible with interval spacing distance less than 1000 feet. Turnouts shall be constructed on all blind curves. Turnouts shall conform to the following diagram:

Standard Turnout – Plan View

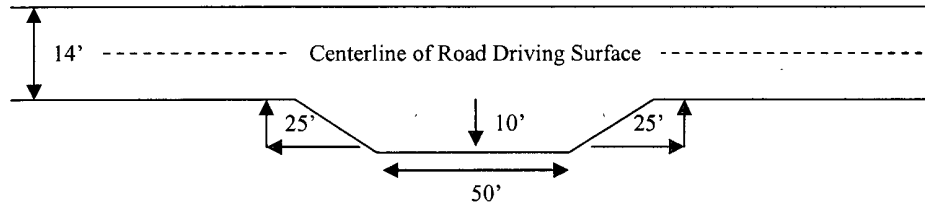

Drainage

Drainage control systems shall be constructed on the entire length of road (e.g. ditches, sidehill outsloping and insloping, lead-off ditches, culvert installation, and low water crossings).

A typical lead-off ditch has a minimum depth of 1 foot below and a berm of 6 inches above natural ground level. The berm shall be on the down-slope side of the lead-off ditch.

Cross Section of a Typical Lead-off Ditch

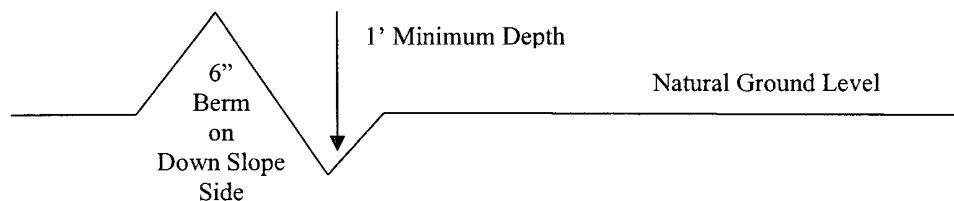

All lead-off ditches shall be graded to drain water with a 1 percent minimum to 3 percent maximum ditch slope. The spacing interval are variable for lead-off ditches and shall be determined according to the formula for spacing intervals of lead-off ditches, but may be amended depending upon existing soil types and centerline road slope (in %);

Formula for Spacing Interval of Lead-off Ditches

Example - On a 4% road slope that is 400 feet long, the water flow shall drain water into a lead-off ditch. Spacing interval shall be determined by the following formula:

$$400 \text{ foot road with } 4\% \text{ road slope: } \frac{400'}{4\%} + 100' = 200' \text{ lead-off ditch interval}$$

Culvert Installations

Appropriately sized culvert(s) shall be installed at the deep waterway channel flow crossing.

Cattleguards

An appropriately sized cattleguard(s) sufficient to carry out the project shall be installed and maintained at fence crossing(s).

Any existing cattleguard(s) on the access road shall be repaired or replaced if they are damaged or have deteriorated beyond practical use. The operator shall be responsible for the condition of the existing cattleguard(s) that are in place and are utilized during lease operations.

A gate shall be constructed and fastened securely to H-braces.

Fence Requirement

Where entry is required across a fence line, the fence shall be braced and tied off on both sides of the passageway prior to cutting.

The operator shall notify the private surface landowner or the grazing allotment holder prior to crossing any fence(s).

Public Access

Public access on this road shall not be restricted by the operator without specific written approval granted by the Authorized Officer.

Figure 1 – Cross Sections and Plans For Typical Road Sections

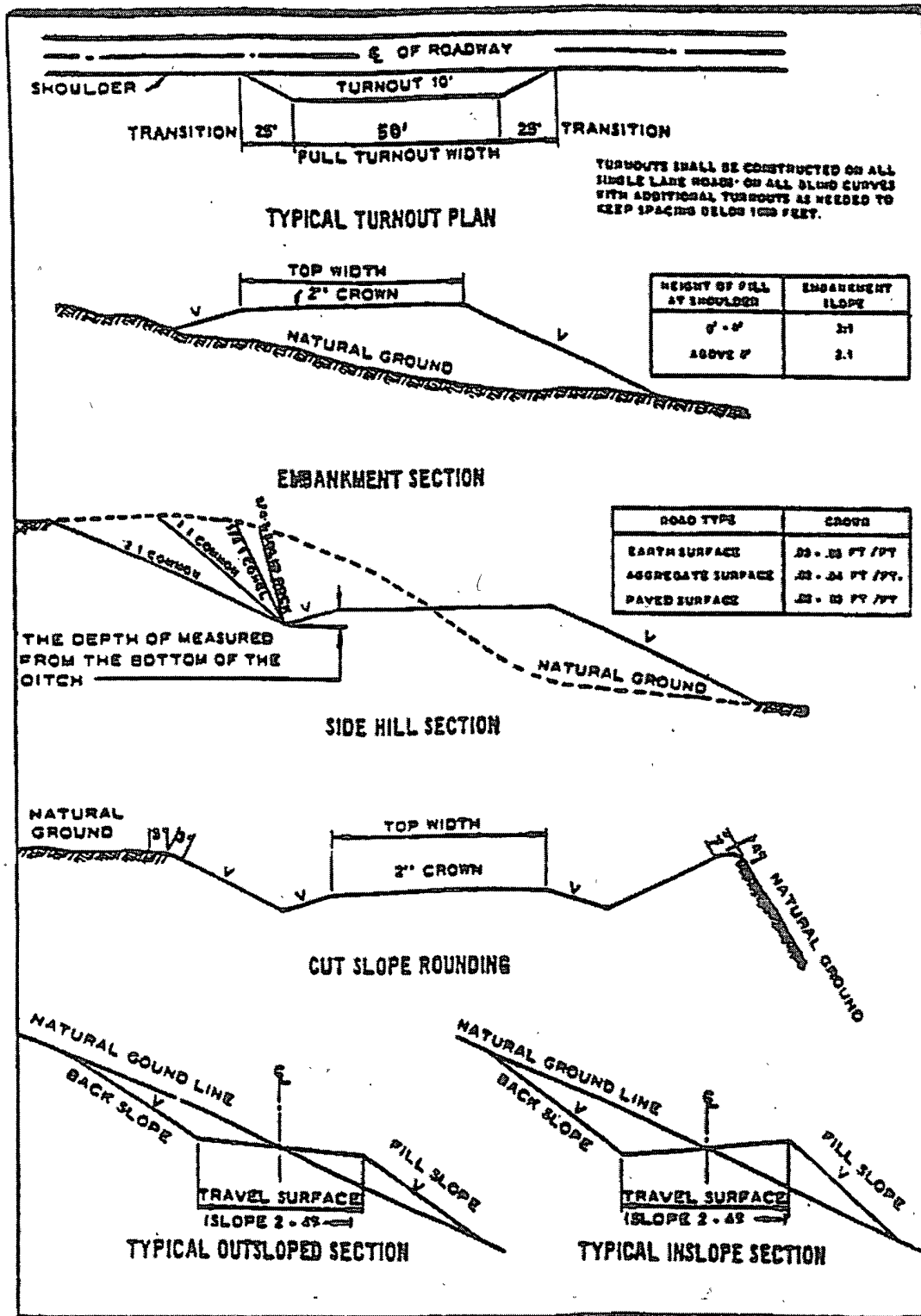

VII. DRILLING

A. DRILLING OPERATIONS REQUIREMENTS

The BLM is to be notified a minimum of **4 hours** in advance for a representative to witness:

- a. Spudding well
- b. Setting and/or Cementing of all casing strings
- c. BOPE tests

☒ **Eddy County**

Call the Carlsbad Field Office, 620 East Greene St., Carlsbad, NM 88220,
(575) 361-2822

1. **Although Hydrogen Sulfide has not been reported in this section, it is always a possible hazard. It has been reported in section 8 approximately 1.5 miles from this location. It is recommended that monitoring equipment be onsite. If Hydrogen Sulfide is encountered, please report measured amounts and formations to the BLM.**
2. Unless the production casing has been run and cemented or the well has been properly plugged, the drilling rig shall not be removed from over the hole without prior approval.
3. Floor controls are required, (3M or Greater) controls will be on the rig floor, unobstructed, readily accessible to the driller and will be operational at all times during drilling and/or completion activities. Rig floor is defined as the area immediately around the rotary table; the area immediately above the substructure on which the draw works are located, this does not include the dog house or stairway area.

B. CASING

Note: All casing shall meet or exceed API standards for new casing. Onshore Order 2.III.B.1.a (Any casing substitutions must have prior approval)

Centralizers required on surface casing as per Onshore Order 2.III.B.1.f

Medium cave/karst.

Possible lost circulation in the Delaware, Bone Spring formations and if present, the Capitan Reef. Reef may be encountered, see mud requirement.

Possibility of high pressure gas bursts within the Wolfcamp formation and over pressure in the Pennsylvanian section.

1. The **13 3/8 inch** surface casing shall be set **at approximately 823 feet (a minimum of 25 feet into the Rustler Anhydrite and above the salt)** and cemented to the surface. **If salt is penetrated surface casing shall be set 25 feet above the salt.**

Provide compressive strengths including hours to reach required 500 pounds compressive strength prior to cementing each casing string.

- a. If cement does not circulate to the surface, the appropriate BLM office shall be notified and a temperature survey utilizing an electronic type temperature survey with surface log readout will be used or a cement bond log shall be run to verify the top of the cement.
- b. Wait on cement (WOC) time for a primary cement job will be a minimum 18 hours for a water basin, 24 hours in the potash area, or 500 pounds compressive strength, whichever is greater. (This is to include the lead cement).
- c. Wait on cement (WOC) time for a remedial job will be a minimum of 4 hours after bringing cement to surface or 500 pounds compressive strength, whichever is greater.
- d. If cement falls back, remedial action will be done prior to drilling out that string.

If the Capitan Reef is encountered while drilling the intermediate hole, switch to Fresh Water for the remainder of the intermediate hole.

2. The minimum required fill of cement behind the **9-5/8 inch** intermediate casing (to be set in the top of the Delaware Lamar Lime at approximately 3000') is:

☒ Cement to surface. If cement does not circulate see B.1.a-d above.

Provide compressive strengths including hours to reach required 500 pounds compressive strength prior to cementing each casing string.

Formation below the 9-5/8" shoe to be tested according to Onshore Order 2.III.B.1.i.

3. The minimum required fill of cement behind the **5-1/2 inch** production casing is:

- a. **First stage to DV tool, cement shall:**

☒ Cement to circulate. If cement does not circulate, contact the appropriate BLM office, before proceeding with second stage cement job.

b. **Second stage above DV tool, cement shall:**

- ☒ Cement should tie-back at least 200 feet into previous casing string. **Operator shall provide method of verification.**

Additional cement will be required to reach height of 2319'.

4. If hardband drill pipe is rotated inside casing, returns will be monitored for metal. If metal is found in samples, drill pipe will be pulled and rubber protectors which have a larger diameter than the tool joints of the drill pipe will be installed prior to continuing drilling operations.

C. PRESSURE CONTROL

1. All blowout preventer (BOP) and related equipment (BOPE) shall comply with well control requirements as described in Onshore Oil and Gas Order No. 2 and API RP 53 Sec. 17.
2. Minimum working pressure of the blowout preventer (BOP) and related equipment (BOPE) required for drilling below the surface casing shoe shall be **5000 (5M)** psi.
3. The appropriate BLM office shall be notified a minimum of **4 hours** in advance for a representative to witness the tests.
 - a. The tests shall be done by an independent service company.
 - b. The results of the test shall be reported to the appropriate BLM office.
 - c. All tests are required to be recorded on a calibrated test chart. A copy of the BOP/BOPE test chart and a copy of independent service company test will be submitted to the appropriate BLM office.
 - d. The BOP/BOPE test shall include a low pressure test from 250 to 300 psi. The test will be held for a minimum of 10 minutes if test is done with a test plug and 30 minutes without a test plug.
 - e. BOP/BOPE must be tested by an independent service company within 500 feet of the top of the **Wolfcamp formation**. This test does not exclude the test prior to drilling out the casing shoe as per Onshore Order No. 2.
 - f. A variance to test the surface casing and BOP/BOPE to the reduced pressure of **1000 psi** with the rig pumps is approved.

D. DRILLING MUD

If the **Capitan Reef** is encountered while drilling the intermediate hole, switch to **Fresh Water** for the remainder of the intermediate hole.

Mud system monitoring equipment, with derrick floor indicators and visual and audio alarms, shall be operating before drilling into the **Wolfcamp** formation, and shall be used until production casing is run and cemented.

E. DRILL STEM TEST

If drill stem tests are performed, Onshore Order 2.III.D shall be followed.

WWI/JDW 040708

VIII. PRODUCTION (POST DRILLING)

A. WELL STRUCTURES & FACILITIES

Placement of Production Facilities

Production facilities should be placed on the well pad to allow for maximum interim recontouring and revegetation of the well location.

Containment Structures

The containment structure shall be constructed to hold the capacity of the entire contents of the largest tank, plus 24 hour production, unless more stringent protective requirements are deemed necessary by the Authorized Officer.

Painting Requirement

All above-ground structures including meter housing that are not subject to safety requirements shall be painted a flat non-reflective paint color
Shale Green, Munsell Soil Color Chart # 5Y 4/2

B. PIPELINES

C. ELECTRIC LINES

IX. INTERIM RECLAMATION & RESERVE PIT CLOSURE

A. INTERIM RECLAMATION

If the well is a producer, interim reclamation shall be conducted on the well site in accordance with the orders of the Authorized Officer. The operator shall submit a Sundry Notices and Reports on Wells (Notice of Intent), Form 3160-5, prior to conducting interim reclamation.

During the life of the development, all disturbed areas not needed for active support of production operations should undergo interim reclamation in order to minimize the environmental impacts of development on other resources and uses.

At the time reserve pits are to be reclaimed, operators should work with BLM surface management specialists to devise the best strategies to reduce the size of the location. Any reductions should allow for remedial well operations, as well as safe and efficient removal of oil and gas.

During reclamation, the removal of caliche is important to increasing the success of revegetating the site. Removed caliche may be used for road repairs, fire walls or for building other roads and locations. In order to operate the well or complete workover operations, it may be necessary to drive, park and operate on restored interim vegetation within the previously disturbed area. Disturbing revegetated areas for production or workover operations will be allowed. If there is significant disturbance and loss of vegetation, the area will need to be revegetated. Communicate with the appropriate BLM office for any exceptions/exemptions if needed.

B. RESERVE PIT CLOSURE

The reserve pit, when dried and closed, shall be recontoured, all trash removed, and reseeded as follows:

Seed Mixture 2, for Sandy Sites

The holder shall seed all disturbed areas with the seed mixture listed below. The seed mixture shall be planted in the amounts specified in pounds of pure live seed (PLS)* per acre. There shall be no primary or secondary noxious weeds in the seed mixture. Seed will be tested and the viability testing of seed will be done in accordance with State law (s) and within nine (9) months prior to purchase. Commercial seed will be either certified or registered seed. The seed container will be tagged in accordance with State law(s) and available for inspection by the authorized officer.

Seed will be planted using a drill equipped with a depth regulator to ensure proper depth of planting where drilling is possible. The seed mixture will be evenly and uniformly planted over the disturbed area (smaller/heavier seeds have a tendency to drop the bottom of the drill and are planted first). The holder shall take appropriate measures to ensure this does not occur. Where drilling is not possible, seed will be broadcast and the area shall be raked or chained to cover the seed. When broadcasting the seed, the pounds per acre are to be doubled. The seeding will be repeated until a satisfactory stand is established as determined by the authorized officer. Evaluation of growth will not be made before completion of at least one full growing season after seeding.

Species to be planted in pounds of pure live seed* per acre:

<u>Species</u>	<u>lb/acre</u>
Sand dropseed (<i>Sporobolus cryptandrus</i>)	1.0
Sand love grass (<i>Eragrostis trichodes</i>)	1.0
Plains bristlegrass (<i>Setaria macrostachya</i>)	2.0

*Pounds of pure live seed:

Pounds of seed x percent purity x percent germination = pounds pure live seed
(Insert Seed Mixture Here)

X. FINAL ABANDONMENT & REHABILITATION REQUIREMENTS

Upon abandonment of the well and/or when the access road is no longer in service the Authorized Officer shall issue instructions and/or orders for surface reclamation and restoration of all disturbed areas.

On private surface/federal mineral estate land the reclamation procedures on the road and well pad shall be accomplished in accordance with the private surface land owner agreement.