

UNITED STATES
DEPARTMENT OF THE INTERIOR
BUREAU OF LAND MANAGEMENT

OCD-ARTESIA

FORM APPROVED
OMB NO. 1004-0137
Expires March 31, 2007

WELL COMPLETION OR RECOMPLETION REPORT AND LOG

S

1a Type of Well Oil Well Gas Well Dry Other
 b Type of Completion: New Well Work Over Deepen Plug Back Diff. Resvr.
 Other _____

5 Lease Serial No.
NM 82896

6 If Indian, Allottee or Tribe Name

7 Unit or CA Agreement Name and No

2. Name of Operator

EOG Resources Inc.

8 Lease Name and Well No.

Gila 12 Fed 2H

3 Address

P.O. Box 2267 Midland, Texas 79702

3a Phone No (include area code)

432-686-3689

9. API Well No

30-015-36401

4. Location of Well (Report location clearly and in accordance with Federal requirements)

At surface **630 FSL & 2250 FEL, U/L O**

At top prod interval reported below

At total depth **474 FSL & 371 FWL, U/L M**

10. Field and Pool, or Exploratory

Poker Lake, Delaware, NW

11. Sec., T., R., M., or Block and Survey or Area

Sec 12, T24S, R30E

12 County or Parish

Eddy

13 State

NM

CONFIDENTIAL

DEC - 2 2008

OCD-ARTESIA

14. Date Spudded

8/1/08

15. Date T.D Reached

8/17/08

16. Date Completed

10/3/08

D & A Ready to Prod

17. Elevations (DF, RKB, RT, GL)*

3518 GL

18 Total Depth: MD
TVD

**10375
7950**

19 Plug Back T.D.: MD
TVD

20. Depth Bridge Plug Set: MD
TVD

21. Type Electric & Other Mechanical Logs Run (Submit copy of each)

22. Was well cored? No Yes (Submit analysis)
 Was DST run No Yes (Submit report)
 Directional Survey? No Yes (Submit copy)

23. Casing and Liner Record (Report all strings set in well)

Hole Size	Size/Grade	Wt.(#ft.)	Top (MD)	Bottom (MD)	Stage Cementer Depth	No. of Sks & Type of Cement	Slurry Vol. (BBL)	Cement Top*	Amount Pulled
17-1/2	13-3/8	48		604		550 C		surface	
12-1/4	9-5/8	40		4230		1108 C		surface	
7-7/8	5-1/2	17		10366		290 C, 655 H		4000 CBL	

24. Tubing Record

Size	Depth Set (MD)	Packer Depth (MD)	Size	Depth Set (MD)	Packer Depth (MD)	Size	Depth Set (MD)	Packer Depth (MD)
2-7/8	7373							

25. Producing Intervals

Formation	Top	Bottom	Perforated Interval	Size	No. Holes	Perf. Status
A) Delaware	7786		8300 - 10300	0.42"	88	Producing
B)						
C)						
D)						

26. Perforation Record

27. Acid, Fracture, Treatment, Cement Squeeze, Etc.

Depth Interval	Amount and Type of Material
8300 - 10300	Frac w/ 196 bbls 7.5% HCL acid, 95 bbls 25 # Linear gel, 264260 lbs 16/30 sand, 203380 lbs 16/30 Super LC, 4084 bbls water.

ACCEPTED FOR RECORD
NOV 30 2008
[Signature]

28. Production - Interval A

Date First Produced	Test Date	Hours Tested	Test Production	Oil BBL	Gas MCF	Water BBL	Oil Gravity Corr API	Gas Gravity	Production Method
10/3/08	10/21/08	24	→	114	144	283	44.0		Pumping
Choke Size	Tbg. Press. Flwg SI	Csg. Press.	24 Hr. →	Oil BBL	Gas MCF	Water BBL	Gas: Oil Ratio	Well Status	
							1263	POW	

MANAGEMENT
CARLSBAD FIELD OFFICE

28a. Production-Interval B

Date First Produced	Test Date	Hours Tested	Test Production	Oil BBL	Gas MCF	Water BBL	Oil Gravity Corr API	Gas Gravity	Production Method
			→						
Choke Size	Tbg. Press. Flwg. SI	Csg. Press.	24 Hr. →	Oil BBL	Gas MCF	Water BBL	Gas: Oil Ratio	Well Status	

Accepted for record - NMOCD

UNITED STATES
DEPARTMENT OF THE INTERIOR
BUREAU OF LAND MANAGEMENT

FORM APPROVED
OMB NO. 1004-0137
Expires March 31, 2007

SUNDRY NOTICES AND REPORTS ON WELLS

Do not use this form for proposals to drill or to re-enter an abandoned well. Use Form 3160-3 (APD) for such proposals.

SUBMIT IN TRIPLICATE - Other instructions on reverse side

1. Type of Well <input checked="" type="checkbox"/> Oil Well <input type="checkbox"/> Gas Well <input type="checkbox"/> Other		5. Lease Serial No. NM 82896
2. Name of Operator EOG Resources Inc.		6. If Indian, Allottee or Tribe Name
3a. Address P.O. Box 2267 Midland, Texas 79702	3b. Phone No. (include area code) 432-686-3689	7. If Unit or CA/Agreement, Name and/or No
4. Location of Well (Footage, Sec., T., R., M., or Survey Description) 630' FSL & 2250' FEL, U/L O Sec 12, T24S, R30E		8. Well Name and No Gila 12 Fed 2H
		9. API Well No. 30-015-36401
		10. Field and Pool, or Exploratory Area Poker Lake; Delaware, NW
		11. County or Parish, State Eddy NM

12. CHECK APPROPRIATE BOX(ES) TO INDICATE NATURE OF NOTICE, REPORT, OR OTHER DATA

TYPE OF SUBMISSION	TYPE OF ACTION			
<input type="checkbox"/> Notice of Intent	<input type="checkbox"/> Acidize	<input type="checkbox"/> Deepen	<input type="checkbox"/> Production (Start/Resume)	<input type="checkbox"/> Water Shut-Off
<input checked="" type="checkbox"/> Subsequent Report	<input type="checkbox"/> Alter Casing	<input type="checkbox"/> Fracture Treat	<input type="checkbox"/> Reclamation	<input type="checkbox"/> Well Integrity
<input type="checkbox"/> Final Abandonment Notice	<input type="checkbox"/> Casing Repair	<input type="checkbox"/> New Construction	<input type="checkbox"/> Recomplete	<input checked="" type="checkbox"/> Other <u>9-5/8" casing</u>
	<input type="checkbox"/> Change Plans	<input type="checkbox"/> Plug and Abandon	<input type="checkbox"/> Temporarily Abandon	
	<input type="checkbox"/> Convert to Injection	<input type="checkbox"/> Plug Back	<input type="checkbox"/> Water Disposal	

13. Describe Proposed or Completed Operation (clearly state all pertinent details, including estimated starting date of any proposed work and approximate duration thereof. If the proposal is to deepen directionally or recomplete horizontally, give subsurface locations and measured and true vertical depths of all pertinent markers and zones. Attach the Bond under which the work will be performed or provide the Bond No. on file with BLM/BIA. Required subsequent reports shall be filed within 30 days following completion of the involved operations. If the operation results in a multiple completion or recompletion in a new interval, a Form 3160-4 shall be filed once testing has been completed. Final Abandonment Notices shall be filed only after all requirements, including reclamation, have been completed, and the operator has determined that the final site is ready for final inspection.)

8/6/08 Ran in 12-1/4" hole 100 jts 9-5/8", 40 #, HCK, J-55 LTC casing set at 4230'.

Cemented as follows, NMCD Option 2 Rule 107 G:

- 908 sx 50/60/10 Class C, 11.8 ppg, 2.45 yield; 200 sx Class C, 14.8 ppg, 1.34 yield. Circulated 320 sx to surface.
- Approximate temperature of cement when mixed - 75 deg F
- Estimated minimum formation temperature in zone of interest - 117.30 deg F
- Estimated cement strength at time of casing test - 810 psi
- Actual time cement in place prior to starting test - 13.5 hrs.

8/7/08 Tested casing to 2500 psi for 30 minutes. Test good.

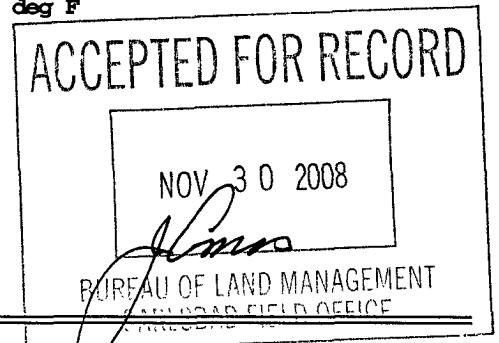

14. I hereby certify that the foregoing is true and correct Name (Printed/Typed) Stan Wagner	Title Regulatory Analyst
Signature <i>Stan Wagner</i>	Date 10/29/08

THIS SPACE FOR FEDERAL OR STATE OFFICE USE

Approved by	Title	Date
Conditions of approval, if any, are attached. Approval of this notice does not warrant or certify that the applicant holds legal or equitable title to those rights in the subject lease which would entitle the applicant to conduct operations thereon.	Office	

UNITED STATES
DEPARTMENT OF THE INTERIOR
BUREAU OF LAND MANAGEMENT

FORM APPROVED
OMB NO. 1004-0137
Expires March 31, 2007

SUNDRY NOTICES AND REPORTS ON WELLS

Do not use this form for proposals to drill or to re-enter an abandoned well. Use Form 3160-3 (APD) for such proposals.

SUBMIT IN TRIPLICATE - Other instructions on reverse side

1. Type of Well <input checked="" type="checkbox"/> Oil Well <input type="checkbox"/> Gas Well <input type="checkbox"/> Other		5. Lease Serial No. NM 82896
2. Name of Operator EOG Resources Inc.		6. If Indian, Allottee or Tribe Name
3a. Address P.O. Box 2267 Midland, Texas 79702	3b. Phone No. (include area code) 432-686-3689	7. If Unit or CA/Agreement, Name and/or No.
4. Location of Well (Footage, Sec., T., R., M., or Survey Description) 630' FSL & 2250' FEL, U/L O Sec 12, T24S, R30E		8. Well Name and No. Gila 12 Fed 2H
		9. API Well No. 30-015-36401
		10. Field and Pool, or Exploratory Area Poker Lake; Delaware, NW
		11. County or Parish, State Eddy NM

12. CHECK APPROPRIATE BOX(ES) TO INDICATE NATURE OF NOTICE, REPORT, OR OTHER DATA

TYPE OF SUBMISSION	TYPE OF ACTION			
<input type="checkbox"/> Notice of Intent	<input type="checkbox"/> Acidize	<input type="checkbox"/> Deepen	<input type="checkbox"/> Production (Start/Resume)	<input type="checkbox"/> Water Shut-Off
<input checked="" type="checkbox"/> Subsequent Report	<input type="checkbox"/> Alter Casing	<input type="checkbox"/> Fracture Treat	<input type="checkbox"/> Reclamation	<input type="checkbox"/> Well Integrity
<input type="checkbox"/> Final Abandonment Notice	<input type="checkbox"/> Casing Repair	<input type="checkbox"/> New Construction	<input type="checkbox"/> Recomplete	<input checked="" type="checkbox"/> Other <u>completion</u>
	<input type="checkbox"/> Change Plans	<input type="checkbox"/> Plug and Abandon	<input type="checkbox"/> Temporarily Abandon	
	<input type="checkbox"/> Convert to Injection	<input type="checkbox"/> Plug Back	<input type="checkbox"/> Water Disposal	

13. Describe Proposed or Completed Operation (clearly state all pertinent details, including estimated starting date of any proposed work and approximate duration thereof. If the proposal is to deepen directionally or recomplete horizontally, give subsurface locations and measured and true vertical depths of all pertinent markers and zones. Attach the Bond under which the work will be performed or provide the Bond No. on file with BLM/BIA. Required subsequent reports shall be filed within 30 days following completion of the involved operations. If the operation results in a multiple completion or recompletion in a new interval, a Form 3160-4 shall be filed once testing has been completed. Final Abandonment Notices shall be filed only after all requirements, including reclamation, have been completed, and the operator has determined that the final site is ready for final inspection.)

8/17/08 TD at 10375' MD.

8/18/08 Ran 232 jts 5-1/2", 17 #, N-80 LTC casing set at 10366'.

Cemented w/ 290 sx 50/50/10 Class C, 11.8 ppg, 2.29 yield; 655 sx 50/50/2 Class H, 14.2 ppg, 1.30 yield; Open DV tool at 5996' and circulated 98 sx to surface.

2nd stage: 340 sx 50/50/10 Class C, 11.8 ppg, 2.29 yield; 100 sx Class C, 14.8 ppg, 1.33 yield. Released rig.

* Cement plan changed from original plan on APD. Verbal permission received from Wesley Ingram - BLM.*

9/10/08 MIRU for completion.

RIH w/ bit to clean out hole and drill out DV tool.

9/12/08 Ran Cement Bond Log from 3000' to 8210'. Found TOC at 4000'. Prep to perforate.

9/13/08 Perforated from 9414 - 10300', 0.42", 44 holes.

9/16/08 Frac w/ 95 bbls 7.5% HCL acid, 95 bbls 25 # Linear gel, 104260 lbs 16/30 sand, 50000 lbs 16/30 Super LC, 2050 bbls load water.

9/17/08 Perforated from 8300 - 9190', 0.42", 44 holes.

ACCEPTED FOR RECORD

14. I hereby certify that the foregoing is true and correct Name (Printed/Typed) Stan Wagner	Title Regulatory Analyst	NOV 30 2008
Signature <i>Stan Wagner</i>	Date 9/29/08	<i>[Signature]</i>

THIS SPACE FOR FEDERAL OR STATE OFFICE USE

BUREAU OF LAND MANAGEMENT
ADRIAN FIELD OFFICE

Approved by	Title	Date
-------------	-------	------

Conditions of approval, if any, are attached. Approval of this notice does not warrant or certify that the applicant holds legal or equitable title to those rights in the subject lease which would entitle the applicant to conduct operations thereon.

Office

UNITED STATES
DEPARTMENT OF THE INTERIOR
BUREAU OF LAND MANAGEMENT

FORM APPROVED
OMB NO. 1004-0137
Expires March 31, 2007

SUNDRY NOTICES AND REPORTS ON WELLS

Do not use this form for proposals to drill or to re-enter an abandoned well. Use Form 3160-3 (APD) for such proposals.

SUBMIT IN TRIPLICATE - Other instructions on reverse side

1. Type of Well <input checked="" type="checkbox"/> Oil Well <input type="checkbox"/> Gas Well <input type="checkbox"/> Other		5. Lease Serial No. NM 82896
2. Name of Operator EOG Resources Inc.		6. If Indian, Allottee or Tribe Name
3a. Address P.O. Box 2267 Midland, Texas 79702	3b. Phone No. (include area code) 432-686-3689	7. If Unit or CA/Agreement, Name and/or No.
4. Location of Well (Footage, Sec., T., R., M., or Survey Description) 630' FSL & 2250' FEL, U/L O Sec 12, T24S, R30E		8. Well Name and No. Gila 12 Fed 2H
		9. API Well No. 30-015-36401
		10. Field and Pool, or Exploratory Area Poker Lake; Delaware, NW
		11. County or Parish, State Eddy NM

12. CHECK APPROPRIATE BOX(ES) TO INDICATE NATURE OF NOTICE, REPORT, OR OTHER DATA

TYPE OF SUBMISSION	TYPE OF ACTION			
<input type="checkbox"/> Notice of Intent	<input type="checkbox"/> Acidize	<input type="checkbox"/> Deepen	<input type="checkbox"/> Production (Start/Resume)	<input type="checkbox"/> Water Shut-Off
<input checked="" type="checkbox"/> Subsequent Report	<input type="checkbox"/> Alter Casing	<input type="checkbox"/> Fracture Treat	<input type="checkbox"/> Reclamation	<input type="checkbox"/> Well Integrity
<input type="checkbox"/> Final Abandonment Notice	<input type="checkbox"/> Casing Repair	<input type="checkbox"/> New Construction	<input type="checkbox"/> Recomplete	<input checked="" type="checkbox"/> Other <u>completion</u>
	<input type="checkbox"/> Change Plans	<input type="checkbox"/> Plug and Abandon	<input type="checkbox"/> Temporarily Abandon	
	<input type="checkbox"/> Convert to Injection	<input type="checkbox"/> Plug Back	<input type="checkbox"/> Water Disposal	

13. Describe Proposed or Completed Operation (clearly state all pertinent details, including estimated starting date of any proposed work and approximate duration thereof. If the proposal is to deepen directionally or recomplete horizontally, give subsurface locations and measured and true vertical depths of all pertinent markers and zones. Attach the Bond under which the work will be performed or provide the Bond No. on file with BLM/BIA. Required subsequent reports shall be filed within 30 days following completion of the involved operations. If the operation results in a multiple completion or recompletion in a new interval, a Form 3160-4 shall be filed once testing has been completed. Final Abandonment Notices shall be filed only after all requirements, including reclamation, have been completed, and the operator has determined that the final site is ready for final inspection.)

- 09/18/08 Frac w/ 101 bbls 7.5% HCL acid, 160000 lbs 16/30 sand, 153380 lbs 16/30 Super LC sand, 2034 bbls load water.
- 09/19/08 RIH to clean out.
- 09/23/08 Finished clean out. RIH w/ 2-7/8" production tubing set at 7373'. Shut in waiting on pumping unit installation.
- 09/26/08 Placed well on pump.
- 10/03/08 Turned to sales.

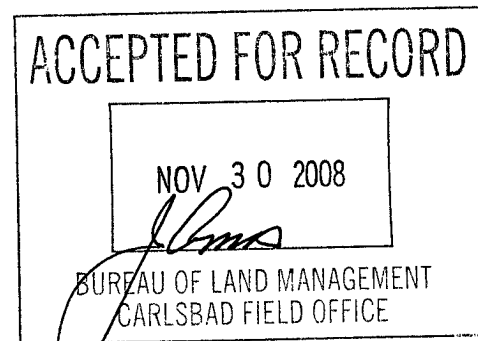

14. I hereby certify that the foregoing is true and correct Name (Printed/Typed) Stan Wagner	Title Regulatory Analyst
Signature <i>Stan Wagner</i>	Date 9/29/08

THIS SPACE FOR FEDERAL OR STATE OFFICE USE

Approved by	Title	Date
Conditions of approval, if any, are attached. Approval of this notice does not warrant or certify that the applicant holds legal or equitable title to those rights in the subject lease which would entitle the applicant to conduct operations thereon.	Office	

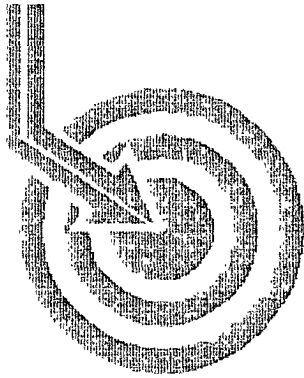

Scientific Drilling

EOG

Field: Poker Lake, NW
Site: Eddy County, NM
Well: Gila 12 Federal #2
Wellpath: VH - Job #32K0808616
Survey: 08/09/08

This survey is correct to the best of my knowledge
and is supported by actual field data.

.....*L. Houston*..... Company Representative

Notorized this date 9th of September, 2008.

Carrie Reed
Notary Signature
County of Midland
State of Texas

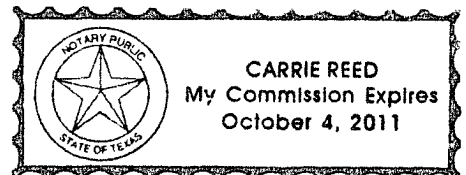



Scientific Drilling International Survey Report

Company: EOG	Date: 09/08/2008	Time: 08:52:19	Page: 1
Field: Poker Lake, NW	Co-ordinate(N/E) Reference:	Site: Eddy County, NM, Grid North	
Site: Eddy County, NM	Vertical (TVD) Reference:	SITE 0.0	
Well: Gila 12 Federal #2	Section (VS) Reference:	Well (0.00N,0 00E,265.73Azi)	
Wellpath: VH - Job #32K0808616	Survey Calculation Method:	Minimum Curvature	Db: Sybase

Survey: 08/09/08 KSRG 0'-7262'	Start Date: 08/09/2008	
Company: Scientific Drilling Internatio	Engineer: Madrid w/GeoGyro	
Tool: Keeper;Keeper Surface Readout Gyro	Tied-to: From Surface	

Survey

MD ft	Incl deg	Azim deg	TVD ft	VS ft	N/S ft	E/W ft	DLS deg/100ft	ClsD ft	ClsA deg
0.00	0.00	359.73	0.00	0.00	0.00	0.00	0.00	0.00	0.00
100.00	0.29	265.93	100.00	0.25	-0.02	-0.25	0.29	0.25	265.93
200.00	0.13	27.01	200.00	0.45	0.07	-0.45	0.37	0.46	278.18
300.00	0.07	303.26	300.00	0.44	0.20	-0.45	0.14	0.49	293.80
400.00	0.67	13.21	400.00	0.31	0.80	-0.37	0.65	0.88	335.22
500.00	0.93	20.95	499.99	-0.21	2.13	0.05	0.28	2.13	1 44
600.00	0 88	4.48	599.97	-0.67	3.65	0.40	0.26	3.68	6.30
700.00	0 70	25.50	699.97	-1.09	4.97	0.73	0.34	5.02	8.32
800.00	0.38	26.71	799.96	-1.57	5.82	1.14	0.32	5.93	11.07
900.00	0.35	1.11	899.96	-1 77	6.42	1.29	0.16	6.55	11 39
1000.00	0.41	26.02	999.96	-1.98	7.05	1.46	0.17	7.19	11.68
1100.00	0 28	359.36	1099.95	-2.17	7.61	1.61	0.20	7.78	11.95
1200.00	0.35	349.78	1199.95	-2.16	8.16	1.55	0.09	8.30	10.78
1300.00	0.40	351.57	1299.95	-2.10	8 80	1.45	0 05	8.92	9.34
1400.00	0.34	353.48	1399.95	-2.06	9.44	1.36	0.06	9.54	8.22
1500.00	0.63	351.81	1499.95	-2.01	10.28	1.25	0.29	10 36	6 94
1600.00	0.81	358 56	1599.94	-2.01	11.53	1.16	0.20	11.59	5 72
1700.00	1.01	3.04	1699.92	-2.16	13.12	1.18	0.21	13.17	5.16
1800.00	1.24	5.38	1799.91	-2.45	15.08	1.33	0.23	15.14	5.05
1900.00	1.26	13.99	1899.88	-2.98	17 22	1.70	0.19	17.30	5.64
2000.00	1.43	11.07	1999.85	-3.65	19 51	2.21	0.18	19.64	6.45
2100.00	1.23	8.34	2099.83	-4.22	21.80	2.60	0.21	21.95	6.80
2200.00	1.20	6.64	2199.80	-4.65	23.90	2.88	0.05	24 07	6 86
2300.00	0.99	346.56	2299.79	-4.71	25.78	2.80	0.43	25 93	6.19
2400.00	1.19	334.99	2399.77	-4.20	27.56	2.16	0.30	27.65	4.48
2500.00	1.16	341.98	2499.75	-3.60	29.47	1.41	0.15	29.50	2.73
2600.00	1.54	343.26	2599.72	-3.06	31.72	0.71	0.38	31.72	1 27
2700.00	1.79	352.65	2699.68	-2.69	34.55	0.12	0.37	34.55	0.20
2800.00	1.63	350.21	2799.63	-2.47	37.50	-0.32	0.18	37.50	359.51
2900.00	1.47	359.06	2899.60	-2.41	40.19	-0.59	0.29	40.19	359.16
3000.00	1.42	339.54	2999.57	-2.14	42.63	-1.04	0.49	42.64	358.60
3100 00	1.47	322.28	3099.53	-1.08	44.80	-2.26	0.44	44.86	357 11
3200.00	1 39	324.23	3199.50	0.26	46.80	-3.75	0 09	46.95	355 42
3300.00	1 57	319.36	3299.47	1.70	48.83	-5.35	0.22	49.12	353.74
3400.00	2.09	299.09	3399.42	4.04	50.75	-7.84	0.82	51.35	351.22
3500.00	2 57	296.69	3499.34	7.48	52 65	-11.44	0 49	53.87	347.75
3600.00	1.33	302.39	3599.28	10.34	54.28	-14.42	1.25	56.16	345.12
3700.00	0.82	277.71	3699.26	11.97	54.99	-16.11	0.68	57.30	343.67
3800.00	0.69	257.22	3799.25	13.26	54.96	-17.40	0.30	57.65	342.43
3900.00	1.60	191.55	3899.23	14.24	53.45	-18.27	1.46	56 49	341.13
4000.00	1.92	166.23	3999.19	14.34	50.46	-18.15	0.83	53.63	340.22
4100.00	1 76	174.77	4099.14	14.04	47.30	-17.61	0.32	50.48	339.58
4200.00	1.44	204.16	4199.10	14 61	44.63	-17.99	0.87	48.12	338.05
4300.00	1.05	226.17	4299.07	15.92	42.85	-19.16	0.61	46.94	335.90
4400.00	1.05	229.47	4399.06	17.36	41 62	-20.52	0 06	46 40	333.75
4500.00	1.22	237.18	4499.04	19.04	40.44	-22.11	0.23	46.09	331.33
4600.00	0.71	230.38	4599.02	20 48	39.47	-23.48	0 52	45.93	329.25
4700.00	0.63	226.55	4699.02	21.41	38.70	-24 36	0 09	45.73	327 81
4800.00	0.61	222.67	4799.01	22.23	37 93	-25.12	0.05	45.49	326 49



Scientific Drilling International Survey Report

Company: EOG	Date: 09/08/2008	Time: 08:52:19	Page: 2
Field: Poker Lake, NW	Co-ordinate(NE) Reference:	Site: Eddy County, NM, Grid North	
Site: Eddy County, NM	Vertical (TVD) Reference:	SITE 0.0	
Well: Gila 12 Federal #2	Section (VS) Reference:	Well (0.00N,0.00E,265.73Azi)	
Wellpath: VH - Job #32K0808616	Survey Calculation Method:	Minimum Curvature	Db: Sybase

Survey

MD ft	Incl deg	Azim deg	TVD ft	VS ft	N/S ft	E/W ft	DLS deg/100ft	ClsD ft	ClsA deg
4900.00	0.60	221.63	4899.01	22.99	37.15	-25.83	0.01	45.24	325.19
5000.00	0.59	229.70	4999.00	23.78	36.42	-26.57	0.08	45.08	323.89
5100.00	0.64	235.76	5098.99	24.68	35.78	-27.42	0.08	45.08	322.53
5200.00	0.69	234.18	5198.99	25.68	35.11	-28.37	0.05	45.14	321.06
5300.00	0.37	239.82	5298.98	26.48	34.59	-29.14	0.32	45.23	319.89
5400.00	0.22	280.73	5398.98	26.96	34.47	-29.61	0.25	45.44	319.34
5500.00	0.04	329.88	5498.98	27.16	34.53	-29.81	0.20	45.62	319.19
5600.00	0.13	275.37	5598.98	27.29	34.57	-29.94	0.11	45.74	319.10
5700.00	0.31	217.81	5698.98	27.58	34.37	-30.22	0.26	45.77	318.67
5800.00	0.12	229.96	5798.98	27.85	34.09	-30.47	0.19	45.72	318.21
5900.00	0.43	227.99	5898.98	28.23	33.77	-30.83	0.31	45.73	317.61
6000.00	0.48	228.55	5998.98	28.86	33.24	-31.42	0.05	45.74	316.61
6100.00	0.52	233.09	6098.97	29.57	32.69	-32.10	0.06	45.82	315.53
6200.00	0.59	227.23	6198.97	30.36	32.07	-32.84	0.09	45.90	314.32
6300.00	0.61	234.09	6298.96	31.22	31.41	-33.65	0.07	46.03	313.03
6400.00	1.06	218.38	6398.95	32.30	30.37	-34.65	0.50	46.08	311.23
6500.00	1.04	211.10	6498.93	33.45	28.87	-35.70	0.13	45.91	308.96
6600.00	0.94	201.58	6598.92	34.33	27.33	-36.47	0.19	45.57	306.85
6700.00	1.13	197.47	6698.90	35.05	25.63	-37.06	0.20	45.06	304.66
6800.00	1.25	204.96	6798.88	35.95	23.70	-37.82	0.20	44.63	302.07
6900.00	1.26	202.98	6898.86	36.99	21.70	-38.71	0.04	44.38	299.27
7000.00	1.53	205.96	6998.83	38.16	19.48	-39.72	0.28	44.24	296.13
7100.00	1.49	197.97	7098.79	39.33	17.05	-40.71	0.21	44.13	292.72
7200.00	1.90	195.61	7198.75	40.38	14.21	-41.56	0.42	43.92	288.88
7262.00	1.89	189.71	7260.72	40.98	12.22	-42.01	0.31	43.75	286.21



**Scientific
Drilling**

Field: Poker Lake, NW
Site: Eddy County, NM
Well: Gila 12 Federal #2
Wellpath: VH - Job #32K0808616
Survey: 08/09/08

G/T/M
↑
Azimuths to Grid North
True North: 0.00°
Magnetic North: 0.00°
Magnetic Field
Strength: 0nT
Dip Angle: 0.00°
Date: 09/08/2008
Model: igrf2000

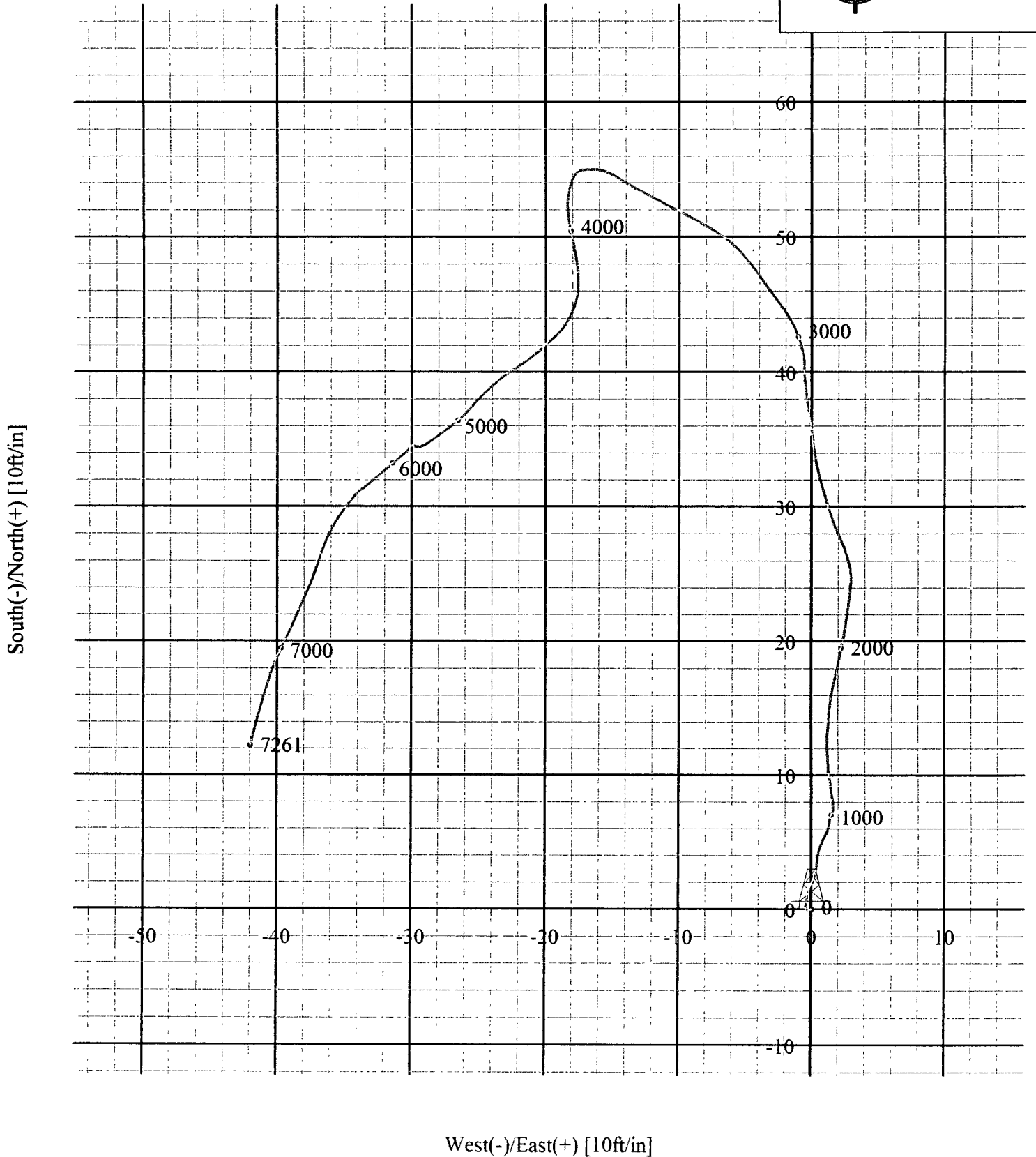

Actual Path

TMD	DEG	AZI	TVD	N/S	E/W	VS	DLS
7458	2.29	199.3	7456.59	5.34	-43.85	43.33	0.27
7489	3.78	225.55	7487.55	4.04	-44.78	44.36	6.45
7520	6.86	241.61	7518.41	2.44	-47.14	46.83	10.94
7551	10.9	248.25	7549.03	0.47	-51.5	51.32	13.42
7583	15.12	249.4	7580.21	-2.12	-58.22	58.21	13.21
7614	19.61	249.46	7609.78	-5.37	-66.88	67.09	14.48
7645	23.65	251.39	7638.6	-9.18	-77.64	78.11	13.23
7677	26.56	252.68	7667.57	-13.36	-90.56	91.3	9.25
7708	28.75	254.62	7695.03	-17.4	-104.37	105.37	7.64
7739	31.3	256.25	7721.87	-21.29	-119.38	120.63	8.64
7770	33.94	259.08	7747.98	-24.84	-135.7	137.17	9.83
7801	37.2	260.82	7773.19	-27.98	-153.46	155.11	11.01
7832	41.06	261.81	7797.23	-30.93	-172.79	174.61	12.61
7863	45.46	262.26	7819.8	-33.86	-193.83	195.81	14.23
7894	49.51	263.43	7840.75	-36.7	-216.49	218.62	13.36
7925	52.5	265.95	7860.25	-38.92	-240.48	242.71	11.53
7957	55.57	268.66	7879.05	-40.13	-266.34	268.59	11.79
7987	57.68	269.67	7895.55	-40.49	-291.39	293.59	7.57
8019	59.97	267.17	7912.12	-41.25	-318.76	320.94	9.79
8050	62.61	265.87	7927.01	-42.9	-345.89	348.12	9.28
8082	65.25	264.54	7941.07	-45.31	-374.53	376.86	9.05
8113	70.26	264.53	7952.8	-48.04	-403.08	405.54	16.16
8144	75.18	264.26	7962.01	-50.93	-432.53	435.12	15.89
8238	89.25	268.16	7974.71	-57.02	-525.22	528	15.52
8332	89.87	269.57	7975.43	-58.88	-619.19	621.85	1.64
8425	89.34	269.85	7976.08	-59.35	-712.19	714.63	0.64
8519	88.46	270.04	7977.88	-59.44	-806.17	808.36	0.96
8612	89.96	268.98	7979.16	-60.24	-899.15	901.14	1.98
8706	91.8	270.01	7977.72	-61.07	-993.13	994.93	2.24
8799	89.87	267.16	7976.36	-63.36	-1086.08	1087.79	3.7
8893	90.13	266.84	7976.36	-68.28	-1179.95	1181.76	0.44
8986	90.22	266.22	7976.08	-73.91	-1272.78	1274.75	0.67
9079	88.9	264.99	7976.79	-81.04	-1365.5	1367.75	1.94
9172	90.31	265.98	7977.43	-88.36	-1458.21	1460.74	1.85
9266	89.52	265.29	7977.57	-95.51	-1551.93	1554.74	1.12
9360	89.52	264.96	7978.36	-103.5	-1645.59	1648.73	0.35
9452	92.86	269.11	7976.45	-108.26	-1737.41	1740.65	5.79
9546	91.28	267.63	7973.05	-110.93	-1831.31	1834.49	2.3
9640	91.45	267.21	7970.81	-115.16	-1925.19	1928.42	0.48
9736	92.24	266.95	7967.72	-120.05	-2021.01	2024.34	0.87
9831	91.71	267.69	7964.45	-124.49	-2115.85	2119.25	0.96
9927	91.63	269.23	7961.65	-127.07	-2211.77	2215.1	1.6
10022	91.71	268.75	7958.88	-128.74	-2306.72	2309.91	0.51
10149	91.54	267.21	7955.28	-133.22	-2433.58	2436.75	1.22
10303	91.1	262.69	7951.73	-146.76	-2586.9	2590.66	2.95
10375	91.1	262.69	7950.35	-155.92	-2658.3	2662.54	0

District I
1625 N. French Dr., Hobbs, NM 88240
District II
1301 W. Grand Avenue, Artesia, NM 88210
District III
1000 Rio Brazos Rd., Aztec, NM 87410
District IV
1220 S St. Francis Dr., Santa Fe, NM 87505

State of New Mexico
Energy, Minerals & Natural Resources Department
OIL CONSERVATION DIVISION
1220 South St. Francis Dr.
Santa Fe, NM 87505

Form C-102
Revised October 12, 2005
Submit to Appropriate District Office
State Lease- 4 Copies
Fee Lease- 3 Copies

AMENDED REPORT

WELL LOCATION AND ACREAGE DEDICATION PLAT

API Number 30-015-36401	Pool Code 9604b	Pool Name Northwest Poker Lake Delaware
Property Code 27026	Property Name GILA 12 FED.	Well Number 2H
OGRID No. 7377	Operator Name EOG RESOURCES, INC.	Elevation 3518.3'

Surface Location

UL or lot no.	Section	Township	Range	Lot Idn	Feet from the	North/South line	Feet from the	East/West line	County
0	12	24 SOUTH	30 EAST, N.M.P.M.		630'	SOUTH	2250'	EAST	EDDY

Bottom Hole Location If Different From Surface

UL or lot no.	Section	Township	Range	Lot Idn	Feet from the	North/South line	Feet from the	East/West line	County
M	12	24 SOUTH	30 EAST, N.M.P.M.		474	SOUTH	371	WEST	EDDY

Dedicated Acres 120	Joint or Infill	Consolidation Code	Order No.
------------------------	-----------------	--------------------	-----------

No allowable will be assigned to this completion until all interests have been consolidated or a non-standard unit has been approved by the division.

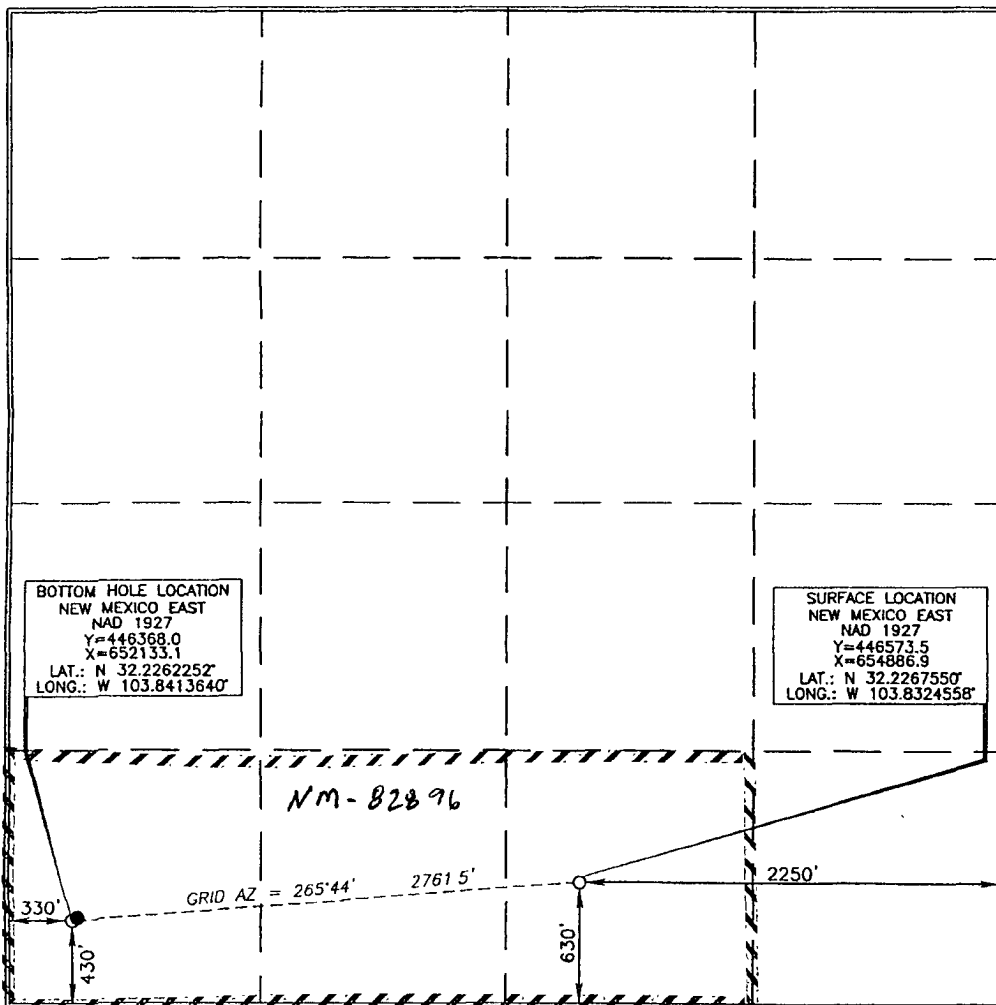

OPERATOR CERTIFICATION

I hereby certify that the information contained herein is true and complete to the best of my knowledge and belief, and that this organization either owns a working interest or unleased mineral interest in the land including the proposed bottom hole location or has a right to drill this well at this location pursuant to a contract with an owner of such a mineral or working interest, or to a voluntary pooling agreement or a compulsory pooling order heretofore entered by the division.

Don J. Motz 4/15/08
Signature Date

Don J. Motz
Printed Name

SURVEYOR CERTIFICATION

I hereby certify that the well location shown on this plat was plotted from field notes of actual surveys made by me or under my supervision and that the same is true and correct to the best of my belief.

15079
APRIL 8 2008
Date of Survey
Termy J. Neal 4/10/2008
Signature and Seal of Professional Surveyor
Certificate Number 15079



OCT 31 2008
OCD-ARTESIA

EOG Resources, Inc.
4000 North Big Spring, Suite 500
Midland, TX 79705
(915) 686-3600

October 29, 2008

State of New Mexico
Oil Conservation Division
1301 W. Grand Avenue
Artesia, New Mexico 88210

Re: Confidentiality Request
Gila 12 Fed 2H

Enclosed please find logs and completion papers for our Gila 12 Fed 2H.
EOG Resources, Inc. respectfully requests confidentiality for the logs and completion papers on this well.

Thank you for your consideration of this request.

Sincerely,

EOG Resources, Inc.

A handwritten signature in black ink that reads "Stan Wagner". The signature is written in a cursive style and is positioned above the printed name.

Stan Wagner
Regulatory Analyst
432.686.3689

1/53 : / 08