

DISTRICT I

1625 N. French Dr., Hobbs, NM 88240

DISTRICT II

1301 W. Grand Avenue, Artesia, NM 88210

DISTRICT III

1000 Rio Brazos Rd., Aztec, NM 87410

DISTRICT IV

1220 S. St. Francis Dr., Santa Fe, NM 87505

State of New Mexico
Energy, Minerals and Natural Resources Department

OIL CONSERVATION DIVISION

1220 South St. Francis Dr.
Santa Fe, New Mexico 87505

Form C-102

Revised October 12, 2005

RECEIVED	
Submit to Appropriate District Office	State Lease - 4 Copies
	Free Lease - 3 Copies
MAR 10 2010	
NMOCD ARTESIA	
AMENDED REPORT	

WELL LOCATION AND ACREAGE DEDICATION PLAT

API Number 30-015-37451	Pool Code 60660	Pool Name Turkey Track Boxe Spring
Property Code 37401	Property Name PARKWAY "26" STATE COM	Well Number 2H
OGRID No. 147AA	Operator Name MEWBOURNE OIL COMPANY	Elevation 3341'

Surface Location

UL or lot No.	Section	Township	Range	Lot Idn	Feet from the	North/South line	Feet from the	East/West line	County
D	26	19 S	29 E		660	NORTH	330	WEST	EDDY

Bottom Hole Location If Different From Surface

UL or lot No.	Section	Township	Range	Lot Idn	Feet from the	North/South line	Feet from the	East/West line	County
A	26	19 S	29 E		333	North	409	East	Eddy
Dedicated Acres 160	Joint or Infill	Consolidation Code	Order No.						

NO ALLOWABLE WILL BE ASSIGNED TO THIS COMPLETION UNTIL ALL INTERESTS HAVE BEEN CONSOLIDATED
OR A NON-STANDARD UNIT HAS BEEN APPROVED BY THE DIVISION

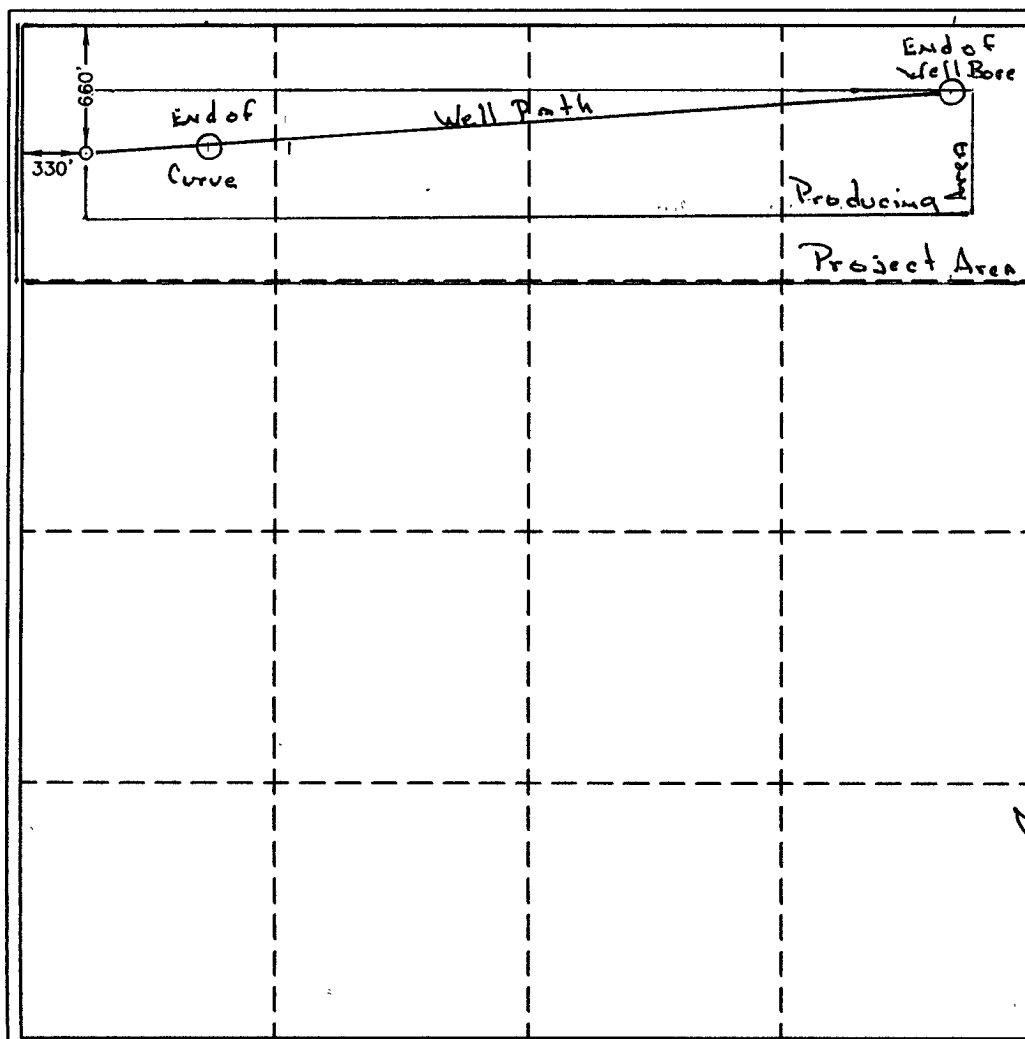

OPERATOR CERTIFICATION

I hereby certify that the information contained herein is true and complete to the best of my knowledge and belief, and that this organization either owns a working interest or unleased mineral interest in the land including the proposed bottom hole location pursuant to a contract with an owner of such a mineral or working interest, or to a voluntary pooling agreement or a compulsory pooling order heretofore entered by the division.

Signature: [Signature] Date: 3-4-2010

Printed Name: N.M. Young

SURVEYOR CERTIFICATION

I hereby certify that the well location shown on this plat was plotted from field notes of actual surveys made by me or under my supervision, and that the same is true and correct to the best of my belief.

Date Surveyed: SEPTEMBER 2009
Signature and Seal of Professional Surveyor: [Signature]
Certificate No. 7977
Certificate No. Gary L. Jones 7977

BASIN SURVEYS

Handwritten initials: MR