

District I  
1625 N. French Dr., Hobbs, NM 88240  
District II  
1301 W. Grand Avenue, Artesia, NM 88210  
District III  
1000 Rio Brazos Road, Aztec, NM 87410  
District IV  
1220 S. St. Francis Dr., Santa Fe, NM 87505

State of New Mexico  
Energy Minerals and Natural Resources

Oil Conservation Division  
1220 South St. Francis Dr.  
Santa Fe, NM 87505

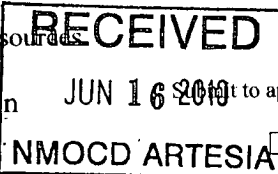

Form C-101  
June 16, 2008

to appropriate District Office  
AMENDED REPORT

**APPLICATION FOR PERMIT TO DRILL, RE-ENTER, DEEPEN, PLUGBACK, OR ADD A ZONE**

<sup>1</sup> Operator Name and Address <b>Judah Oil, L.L.C. PO Box 568 Artesia, NM 88211</b>		<sup>2</sup> OGRID Number <b>245872</b>
		<sup>3</sup> API Number <b>30-015-22893</b>
<sup>4</sup> Property Code	<sup>5</sup> Property Name <b>Red Lake State SWD</b>	<sup>6</sup> Well No. <b>001</b>
<sup>9</sup> Proposed Pool 1 <b>SWD; Wolfcamp, Cisco</b>		<sup>10</sup> Proposed Pool 2

<sup>7</sup> Surface Location

UL or lot no	Section	Township	Range	Lot Idn	Feet from the	North/South line	Feet from the	East/West line	County
G	22	17S	28E		1980	North	1980	East	Eddy

<sup>8</sup> Proposed Bottom Hole Location If Different From Surface

UL or lot no	Section	Township	Range	Lot Idn	Feet from the	North/South line	Feet from the	East/West line	County

Additional Well Information

<sup>11</sup> Work Type Code <b>E</b>	<sup>12</sup> Well Type Code <b>S</b>	<sup>13</sup> Cable/Rotary <b>R</b>	<sup>14</sup> Lease Type Code <b>S</b>	<sup>15</sup> Ground Level Elevation <b>3592 GR</b>
<sup>16</sup> Multiple <b>No</b>	<sup>17</sup> Proposed Depth <b>9355</b>	<sup>18</sup> Formation <b>Cisco</b>	<sup>19</sup> Contractor <b>Unknown</b>	<sup>20</sup> Spud Date <b>ASAP</b>

<sup>21</sup> Proposed Casing and Cement Program

Hole Size	Casing Size	Casing weight/foot	Setting Depth	Sacks of Cement	Estimated TOC
<b>17 1/2"</b>	<b>13 3/8"</b>	<b>48#</b>	<b>412ft</b>	<b>400</b>	<b>Surface-In Place</b>
<b>12 1/4"</b>	<b>8 5/8"</b>	<b>32#</b>	<b>2100ft</b>	<b>1185</b>	<b>Surface-In Place</b>
<b>7 7/8"</b>	<b>5 1/2"</b>	<b>17#</b>	<b>10398ft</b>	<b>938</b>	<b>Surface-In Place</b>

<sup>22</sup> Describe the proposed program. If this application is to DEEPEN or PLUG BACK, give the data on the present productive zone and proposed new productive zone Describe the blowout prevention program, if any. Use additional sheets if necessary.

**Judah Oil, LLC purposes to re-enter the former Lucas Store KT State # 001 plugged and abandoned by Yates Petroleum Corporation 12/29/2009**  
**Cement plugs from surface to PBTD 9355ft will be drilled out using fresh water.**  
**3000 psi double BOP with pipe and blind rams will be used during drill out and completion operations**  
**Attached is well data sheet, before and after well diagrams, C144 CLEZ**  
**This work will be performed only after the approval of NMOC D form C108**

<sup>23</sup> I hereby certify that the information given above is true and complete to the best of my knowledge and belief.

Signature:

*Billy E. Prichard*

Printed name: **Billy E. Prichard**

Title: **Agent for Judah Oil, LLC**

E-mail Address: **billy@pwllc.net**

Date: **6/12/2010**

Phone: **432-934-7680**

OIL CONSERVATION DIVISION

Approved by:

*Agui Prew*  
**Geologist**

Title:

Approval Date: **7/21/2010**

Expiration Date:

Conditions of Approval Attached ☐

**District I**  
1625 N. French Dr., Hobbs, NM 88240

**District II**  
1301 W. Grand Avenue, Artesia, NM 88210

**District III**  
1000 Rio Brazos Rd., Aztec, NM 87410

**District IV**  
1220 S. St. Francis Dr., Santa Fe, NM 87505

State of New Mexico  
Energy, Minerals & Natural Resources Department  
**OIL CONSERVATION DIVISION**  
1220 South St. Francis Dr.  
Santa Fe, NM 87505

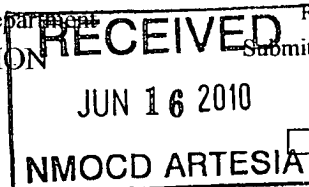

Form C-102  
Revised October 15, 2009  
Submit one copy to appropriate  
District Office  
☐ AMENDED REPORT

**WELL LOCATION AND ACREAGE DEDICATION PLAT**

<sup>1</sup> API Number <b>30-015-22893</b>		<sup>2</sup> Pool Code <b>96136</b>		<sup>3</sup> Pool Name <b>SWD; Wolfcamp, Cisco</b>	
<sup>4</sup> Property Code		<sup>5</sup> Property Name <b>Red Lake State SWD</b>			<sup>6</sup> Well Number <b>001</b>
<sup>7</sup> OGRID No. <b>245872</b>		<sup>8</sup> Operator Name <b>Judah Oil, L.L.C.</b>			<sup>9</sup> Elevation <b>3592 GR</b>

**<sup>10</sup> Surface Location**

UL or lot no.	Section	Township	Range	Lot Idn	Feet from the	North/South line	Feet from the	East/West line	County
<b>G</b>	<b>22</b>	<b>17S</b>	<b>28E</b>		<b>1980</b>	<b>North</b>	<b>1980</b>	<b>East</b>	<b>Eddy</b>

**<sup>11</sup> Bottom Hole Location If Different From Surface**

UL or lot no.	Section	Township	Range	Lot Idn	Feet from the	North/South line	Feet from the	East/West line	County

<sup>12</sup> Dedicated Acres <b>40</b>	<sup>13</sup> Joint or Infill	<sup>14</sup> Consolidation Code	<sup>15</sup> Order No.
--	-------------------------------	----------------------------------	-------------------------

No allowable will be assigned to this completion until all interests have been consolidated or a non-standard unit has been approved by the division.

<sup>16</sup> <div style="border: 1px solid black; padding: 10px; width: fit-content; margin: 10px auto;"> See original C102 Surveyed 3/23/1979 </div>	<sup>17</sup> <b>OPERATOR CERTIFICATION</b> I hereby certify that the information contained herein is true and complete to the best of my knowledge and belief, and that this organization either owns a working interest or unleased mineral interest in the land including the proposed bottom hole location or has a right to drill this well at this location pursuant to a contract with an owner of such a mineral or working interest, or to a voluntary pooling agreement or a compulsory pooling order heretofore entered by the division. Signature <u>Billy E. Prichard</u> Date <u>6/12/10</u> Printed Name <b>Billy E. Prichard</b>			
	<sup>18</sup> <b>SURVEYOR CERTIFICATION</b> I hereby certify that the well location shown on this plat was plotted from field notes of actual surveys made by me or under my supervision, and that the same is true and correct to the best of my belief Date of Survey Signature and Seal of Professional Surveyor.			
	Certificate Number			

NEW MEXICO OIL CONSERVATION COMMISSION  
WELL LOCATION AND ACREAGE DEDICATION PLAT

Form C-102  
Supersedes C-128  
Effective 1-4-65

All distances must be from the outer boundaries of the Section.

Operator <b>Yates Petroleum Corporation</b>			Lease <b>Lucas Store KT State Com</b>		Well No. <b>1</b>
Unit Letter <b>G</b>	Section <b>22</b>	Township <b>17 South</b>	Range <b>28 East</b>	County <b>Eddy</b>	
Actual Portage Location of Well:					
1980 feet from the North line and		1980 feet from the East line			
Ground Level Elev. <b>3592</b>	Producing Formation <b>Morrow</b>	Pool <b>Empire Penn</b>	Dedicated Acreage: <b>320</b> Acres		

1. Outline the acreage dedicated to the subject well by colored pencil or hatchure marks on the plat below.
2. If more than one lease is dedicated to the well, outline each and identify the ownership thereof (both as to working interest and royalty).
3. If more than one lease of different ownership is dedicated to the well, have the interests of all owners been consolidated by communitization, unitization, force-pooling, etc?

☒ Yes ☐ No If answer is "yes," type of consolidation To be communitized

If answer is "no," list the owners and tract descriptions which have actually been consolidated. (Use reverse side of this form if necessary.)

No allowable will be assigned to the well until all interests have been consolidated (by communitization, unitization, forced-pooling, or otherwise) or until a non-standard unit, eliminating such interests, has been approved by the Commission.

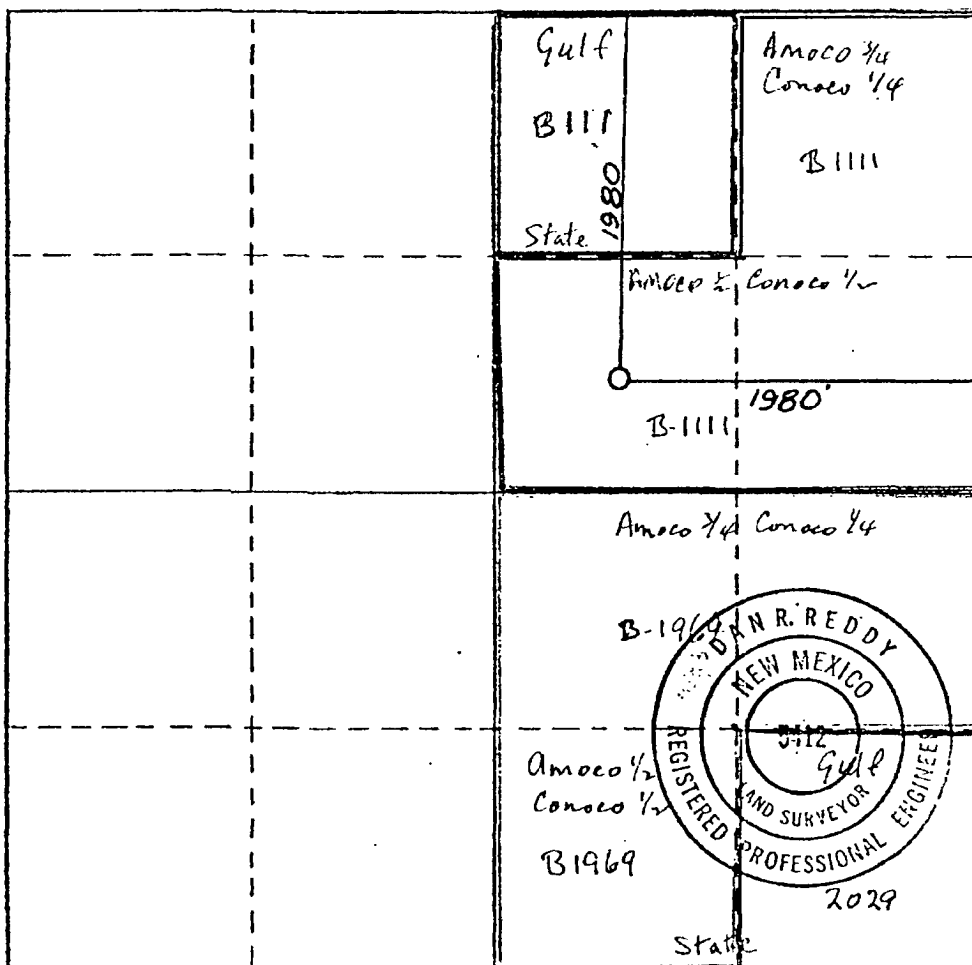

CERTIFICATION

I hereby certify that the information contained herein is true and complete to the best of my knowledge and belief.

*Eddie M. Mahood*  
Name

Eddie M. MAHFOOD

ENGINEER

YATES PETROLEUM CORP

3-26-79

I hereby certify that the well location shown on this plat was plotted from field notes of actual surveys made by me or under my supervision, and that the same is true and correct to the best of my knowledge and belief.

March 23, 1979

Registered Professional Engineer and/or Land Surveyor

*Dan R. Reddy*

5412  
NMPE&LS #5412

