

Scientific Drilling

RECEIVED

JAN 10 2011

HOBBSOCD

3 D-015-3700

XTO ENERGY INC.

Field: Pierce Crossing
Site: Eddy County, NM
Well: Muy Wayno 7 State #1H
Wellpath: Vh - Job #32K0510387
Survey: 05/20/10

This survey is correct to the best of my knowledge and is supported by actual field data.

R. Harton
Company Representative

Notarized this date 21st of June, 2010.

Carrie Reed
Notary Signature
County of Midland
State of Texas

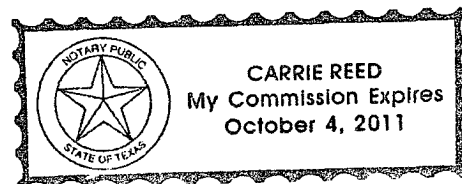



Scientific Drilling International, Inc.

Survey Report

Company: XTO ENERGY INC.	Date: 5/24/2010	Time: 16:37:13	Page: 2
Field: Pierce Crossing	Co-ordinate(NE) Reference:	Site: Eddy County, NM, Grid North	
Site: Eddy County, NM	Vertical (TVD) Reference:	SITE: 0:0	
Well: Muy Wayno 7 State #1H	Section (VS) Reference:	Well (0.00N,0.00E,179.74Azi)	
Wellpath: Vh - Job #32K0510387	Survey Calculation Method:	Minimum Curvature	Db: Sybase

Survey

MD ft	Incl deg	Azim deg	TVD ft	VS ft	N/S ft	E/W ft	DLS deg/100ft	CIsD ft	CIsA deg
4900.0	0.54	219.67	4898.2	-2.9	2.6	-56.9	0.31	57.0	272.64
5000.0	0.65	234.68	4998.2	-2.2	1.9	-57.7	0.19	57.7	271.92
5100.0	0.98	241.04	5098.2	-1.5	1.2	-58.9	0.34	58.9	271.16
5200.0	1.06	251.82	5198.2	-0.8	0.5	-60.5	0.21	60.5	270.47
5300.0	0.95	244.21	5298.2	-0.1	-0.2	-62.1	0.17	62.1	269.86
5400.0	1.06	231.98	5398.2	0.8	-1.1	-63.6	0.24	63.6	269.02
5500.0	1.33	224.10	5498.2	2.2	-2.5	-65.2	0.32	65.2	267.81
5600.0	1.24	218.99	5598.1	3.9	-4.2	-66.6	0.15	66.8	266.42
5700.0	1.16	215.81	5698.1	5.5	-5.8	-67.9	0.10	68.2	265.10
5800.0	1.26	208.11	5798.1	7.3	-7.6	-69.0	0.19	69.4	263.70
5900.0	1.60	200.94	5898.1	9.6	-9.9	-70.0	0.38	70.7	261.96
6000.0	1.71	200.93	5998.0	12.3	-12.6	-71.1	0.11	72.2	259.96
6100.0	1.94	200.39	6098.0	15.2	-15.6	-72.2	0.23	73.9	257.83
6200.0	2.10	200.78	6197.9	18.5	-18.9	-73.4	0.16	75.8	255.59
6300.0	2.46	196.60	6297.8	22.3	-22.6	-74.7	0.40	78.1	253.14
6400.0	2.50	201.28	6397.7	26.4	-26.7	-76.1	0.21	80.7	250.65
6500.0	2.63	199.03	6497.6	30.6	-30.9	-77.6	0.16	83.6	248.28
6600.0	2.72	196.54	6597.5	35.0	-35.4	-79.1	0.15	86.6	245.90
6700.0	2.84	194.28	6697.4	39.7	-40.0	-80.4	0.16	89.8	243.51
6800.0	2.96	195.62	6797.3	44.6	-44.9	-81.7	0.14	93.2	241.18
6900.0	3.38	195.95	6897.1	49.9	-50.3	-83.2	0.42	97.2	238.86
7000.0	3.87	196.54	6996.9	55.9	-56.3	-84.9	0.49	101.9	236.45
7100.0	3.74	199.62	7096.7	62.2	-62.6	-87.0	0.24	107.2	234.25
7200.0	3.56	200.39	7196.5	68.2	-68.6	-89.2	0.19	112.5	232.42
7300.0	3.03	200.61	7296.3	73.6	-74.0	-91.2	0.53	117.4	230.94
7400.0	2.61	204.88	7396.2	78.1	-78.5	-93.1	0.47	121.8	229.84
7456.0	2.22	204.65	7452.2	80.3	-80.7	-94.1	0.70	123.9	229.38



**Scientific
Drilling**

**Field: Pierce Crossing
Site: Eddy County, NM
Well: Muy Wayno 7 State #1H
Survey: 05/20/10**

G/T/M
↑
Azimuths to Grid North
True North: 0.00°
Magnetic North: 0.00°
Magnetic Field
Dip Angle: 0.00°
Date: 5/24/2010
Model: igrf2000

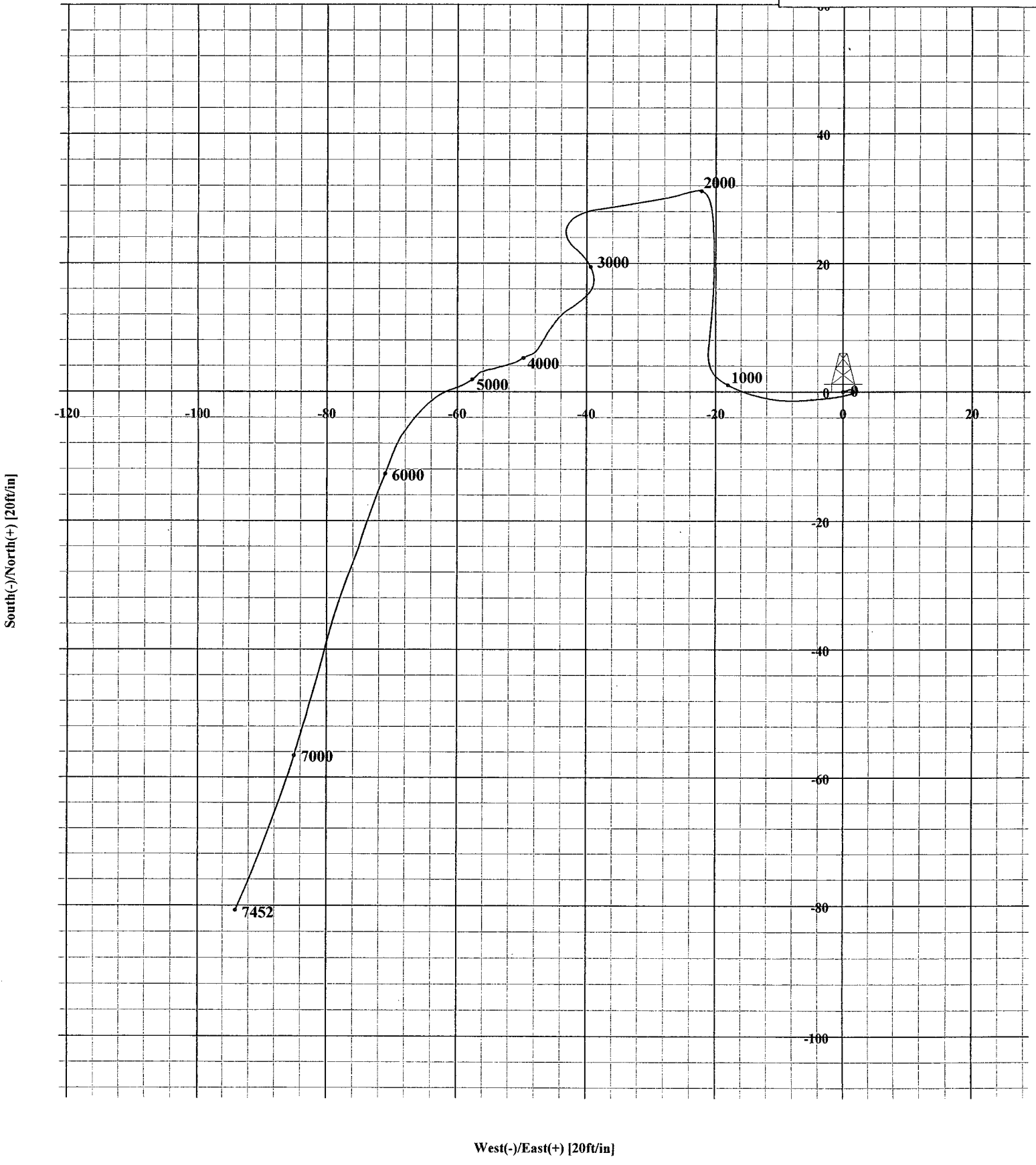



Scientific Drilling

Gyroscopic Survey Report
for
XTO ENERGY

RECEIVED

JAN 10 2011
HOBBSUCD

Well Location	EDDY COUNTY,NM
Well Name	MUY WAYNO 7 ST#1-H
Rig Name	MCVAY #7
Survey Date	5/21/2010
Latitude	32.15 deg
North Reference	Grid North
Grid Correction	-0.22 deg
Depth Reference	18.5' K.B.
Calculation Method	Minimum Curvature
Section (VS) Ref	0.00N (ft), 0.00E (ft), 179.74Azim (deg)
Definitive Survey	FIINAL GYRO SURVEY
Operator	J.SUTHERLAND

Comments



Survey Report

Well Name:		MUY WAYNO 7 ST#1-H						
Survey:		FIINAL GYRO SURVEY						
Survey Date:		5/21/2010						
MD ft	Type	Inc deg	Azim deg	TVD ft	VS ft	Northing ft	Easting ft	DLS deg/100ft
0.00	Tie-in	0.00	0.00	0.00	0.00	0.00	0.00	Invalid
100.00	User gyro	0.35	70.30	100.00	-0.10	0.10	0.29	0.35
200.00	User gyro	0.18	60.66	200.00	-0.28	0.29	0.72	0.17
300.00	User gyro	0.28	89.83	300.00	-0.36	0.37	1.10	0.15
400.00	User gyro	0.47	118.22	400.00	-0.16	0.17	1.70	0.26
500.00	User gyro	1.18	252.17	499.99	0.34	-0.34	1.08	1.55
600.00	User gyro	2.45	262.84	599.94	0.91	-0.92	-2.02	1.30
700.00	User gyro	2.77	266.38	699.83	1.31	-1.34	-6.55	0.36
800.00	User gyro	2.55	279.04	799.73	1.09	-1.14	-11.15	0.62
900.00	User gyro	2.27	288.75	899.64	0.08	-0.15	-15.23	0.49
1000.00	User gyro	1.35	298.56	999.59	-1.13	1.05	-18.15	0.97
1100.00	User gyro	1.07	311.80	1099.57	-2.33	2.24	-19.88	0.40
1200.00	User gyro	1.35	341.36	1199.54	-4.07	3.97	-20.95	0.67
1300.00	User gyro	2.31	5.67	1299.49	-7.18	7.09	-21.13	1.21
1400.00	User gyro	2.92	5.21	1399.39	-11.72	11.62	-20.70	0.61
1500.00	User gyro	3.40	2.45	1499.24	-17.21	17.12	-20.34	0.50
1600.00	User gyro	3.13	358.17	1599.07	-22.90	22.81	-20.30	0.36
1700.00	User gyro	1.58	354.90	1698.99	-27.00	26.91	-20.51	1.55
1800.00	User gyro	1.07	345.14	1798.96	-29.28	29.18	-20.88	0.56
1900.00	User gyro	0.67	325.15	1898.95	-30.66	30.56	-21.45	0.50
2000.00	User gyro	0.54	287.38	1998.94	-31.28	31.18	-22.23	0.41
2100.00	User gyro	1.06	258.36	2098.93	-31.24	31.14	-23.59	0.65
2200.00	User gyro	1.24	252.92	2198.91	-30.75	30.63	-25.53	0.21
2300.00	User gyro	1.42	259.58	2298.89	-30.22	30.09	-27.78	0.24
2400.00	User gyro	1.86	260.67	2398.85	-29.74	29.60	-30.60	0.44
2500.00	User gyro	2.25	260.15	2498.78	-29.16	29.00	-34.14	0.39
2600.00	User gyro	2.43	262.07	2598.70	-28.55	28.38	-38.17	0.19
2700.00	User gyro	1.92	239.32	2698.63	-27.42	27.23	-41.71	0.99
2800.00	User gyro	1.59	184.15	2798.59	-25.19	24.99	-43.25	1.65
2900.00	User gyro	2.39	130.53	2898.53	-22.44	22.25	-41.77	1.93
3000.00	User gyro	1.79	153.26	2998.47	-19.68	19.50	-39.48	1.01
3100.00	User gyro	1.28	187.67	3098.43	-17.18	17.00	-38.92	1.03
3200.00	User gyro	1.82	226.82	3198.40	-14.99	14.81	-40.23	1.15
3300.00	User gyro	1.50	238.35	3298.36	-13.23	13.04	-42.50	0.46
3400.00	User gyro	0.98	221.31	3398.33	-11.91	11.71	-44.18	0.63
3500.00	User gyro	0.99	217.06	3498.32	-10.58	10.37	-45.27	0.07
3600.00	User gyro	0.90	209.51	3598.31	-9.21	9.00	-46.18	0.16
3700.00	User gyro	0.90	211.35	3698.29	-7.86	7.64	-46.97	0.03
3800.00	User gyro	0.76	216.45	3798.28	-6.66	6.44	-47.77	0.16



Survey Report

Well Name: MUY WAYNO 7 ST#1-H
 Survey: FIINAL GYRO SURVEY
 Survey Date: 5/21/2010

MD ft	Type	Inc deg	Azim deg	TVD ft	VS ft	Northing ft	Easting ft	DLS deg/100ft
3900.00	User gyro	0.71	251.78	3898.28	-5.94	5.71	-48.76	0.45
4000.00	User gyro	0.63	239.21	3998.27	-5.46	5.24	-49.82	0.17
4100.00	User gyro	0.53	239.85	4098.26	-4.95	4.72	-50.70	0.10
4200.00	User gyro	0.58	253.77	4198.26	-4.58	4.35	-51.59	0.14
4300.00	User gyro	0.60	255.28	4298.25	-4.31	4.07	-52.58	0.02
4400.00	User gyro	0.41	254.26	4398.25	-4.08	3.84	-53.43	0.19
4500.00	User gyro	0.49	254.17	4498.25	-3.87	3.63	-54.19	0.08
4600.00	User gyro	0.41	260.17	4598.24	-3.70	3.45	-54.95	0.09
4700.00	User gyro	0.38	250.87	4698.24	-3.53	3.28	-55.61	0.07
4800.00	User gyro	0.42	254.01	4798.24	-3.33	3.07	-56.28	0.04
4900.00	User gyro	0.54	219.67	4898.24	-2.86	2.60	-56.94	0.31
5000.00	User gyro	0.65	234.68	4998.23	-2.17	1.91	-57.70	0.19
5100.00	User gyro	0.98	241.04	5098.22	-1.43	1.17	-58.92	0.34
5200.00	User gyro	1.06	251.82	5198.20	-0.74	0.46	-60.54	0.21
5300.00	User gyro	0.95	244.21	5298.19	-0.10	-0.19	-62.17	0.17
5400.00	User gyro	1.06	231.98	5398.17	0.83	-1.12	-63.65	0.24
5500.00	User gyro	1.33	224.10	5498.15	2.23	-2.53	-65.19	0.31
5600.00	User gyro	1.24	218.99	5598.13	3.90	-4.20	-66.68	0.15
5700.00	User gyro	1.16	215.81	5698.10	5.56	-5.87	-67.96	0.10
5800.00	User gyro	1.26	208.11	5798.08	7.34	-7.66	-69.07	0.19
5900.00	User gyro	1.60	200.94	5898.05	9.61	-9.93	-70.08	0.39
6000.00	User gyro	1.71	200.93	5998.01	12.31	-12.64	-71.12	0.11
6100.00	User gyro	1.94	200.39	6097.96	15.30	-15.63	-72.24	0.23
6200.00	User gyro	2.10	200.78	6197.90	18.59	-18.93	-73.48	0.15
6300.00	User gyro	2.46	196.60	6297.82	22.35	-22.69	-74.75	0.39
6400.00	User gyro	2.50	201.28	6397.72	26.43	-26.78	-76.15	0.21
6500.00	User gyro	2.63	199.03	6497.62	30.63	-30.99	-77.69	0.17
6600.00	User gyro	2.72	196.54	6597.51	35.08	-35.43	-79.12	0.15
6700.00	User gyro	2.84	194.28	6697.40	39.75	-40.11	-80.40	0.16
6800.00	User gyro	2.96	195.62	6797.27	44.63	-45.00	-81.71	0.13
6900.00	User gyro	3.38	195.95	6897.11	49.95	-50.33	-83.22	0.42
7000.00	User gyro	3.87	196.54	6996.91	56.01	-56.40	-84.99	0.49
7100.00	User gyro	3.74	199.62	7096.69	62.31	-62.71	-87.04	0.24
7200.00	User gyro	3.56	200.39	7196.49	68.28	-68.69	-89.22	0.18
7300.00	User gyro	3.03	200.61	7296.32	73.65	-74.07	-91.23	0.54
7400.00	User gyro	2.61	204.88	7396.20	78.18	-78.60	-93.12	0.47
7456.00	User gyro	2.22	204.65	7452.15	80.32	-80.75	-94.11	0.69

Gyroscopic Survey Report for:
XTO ENERGY

Well Location: EDDY COUNTY, NM
 Well Name: MUY WAYNO 7 ST#1-H
 Rig Name: MCVAY #7
 Survey Date: 5/21/2010
 Latitude: 32.15 deg
 North Reference: Grid North
 Grid Correction: -0.22 deg
 Depth Reference: 18.5' K.B.
 Calculation Method: Minimum Curvature
 Section (VS) Ref: 0.00N (ft), 0.00E (ft), 179.74Azim (deg)
 Definitive Survey: FINAL GYRO SURVEY
 Operator: J.SUTHERLAND

Measured Depth [ft]	Type [unk]	Inclination [deg]	Azimuth [deg]	True
Vertical Depth [ft]	Vertical Section [ft]	Northing (Latitude) [ft]		
Easting (Departure) [ft]	Dog Leg	Severity [deg/100ft]		
0.00	Tie-in 0.00	0.00	0.00	Invalid
100.00	User gyro	0.35	70.30	100.00 -0.10 0.10 0.29 0.35
200.00	User gyro	0.18	60.66	200.00 -0.28 0.29 0.72 0.17
300.00	User gyro	0.28	89.83	300.00 -0.36 0.37 1.10 0.15
400.00	User gyro	0.47	118.22	400.00 -0.16 0.17 1.70 0.26
500.00	User gyro	1.18	252.17	499.99 0.34 -0.34 1.08 1.55
600.00	User gyro	2.45	262.84	599.94 0.91 -0.92 -2.02 1.30
700.00	User gyro	2.77	266.38	699.83 1.31 -1.34 -6.55 0.36
800.00	User gyro	2.55	279.04	799.73 1.09 -1.14 -11.15 0.62
900.00	User gyro	2.27	288.75	899.64 0.08 -0.15 -15.23 0.49
1000.00	User gyro	1.35	298.56	999.59 -1.13 1.05 -18.15 0.97
1100.00	User gyro	1.07	311.80	1099.57 -2.33 2.24 -19.88 0.40
1200.00	User gyro	1.35	341.36	1199.54 -4.07 3.97 -20.95 0.67
1300.00	User gyro	2.31	5.67	1299.49 -7.18 7.09 -21.13 1.21
1400.00	User gyro	2.92	5.21	1399.39 -11.72 11.62 -20.70 0.61
1500.00	User gyro	3.40	2.45	1499.24 -17.21 17.12 -20.34 0.50
1600.00	User gyro	3.13	358.17	1599.07 -22.90 22.81 -20.30 0.36
1700.00	User gyro	1.58	354.90	1698.99 -27.00 26.91 -20.51 1.55
1800.00	User gyro	1.07	345.14	1798.96 -29.28 29.18 -20.88 0.56
1900.00	User gyro	0.67	325.15	1898.95 -30.66 30.56 -21.45 0.50
2000.00	User gyro	0.54	287.38	1998.94 -31.28 31.18 -22.23 0.41
2100.00	User gyro	1.06	258.36	2098.93 -31.24 31.14 -23.59 0.65
2200.00	User gyro	1.24	252.92	2198.91 -30.75 30.63 -25.53 0.21
2300.00	User gyro	1.42	259.58	2298.89 -30.22 30.09 -27.78 0.24
2400.00	User gyro	1.86	260.67	2398.85 -29.74 29.60 -30.60 0.44
2500.00	User gyro	2.25	260.15	2498.78 -29.16 29.00 -34.14 0.39
2600.00	User gyro	2.43	262.07	2598.70 -28.55 28.38 -38.17 0.19
2700.00	User gyro	1.92	239.32	2698.63 -27.42 27.23 -41.71 0.99
2800.00	User gyro	1.59	184.15	2798.59 -25.19 24.99 -43.25 1.65
2900.00	User gyro	2.39	130.53	2898.53 -22.44 22.25 -41.77 1.93
3000.00	User gyro	1.79	153.26	2998.47 -19.68 19.50 -39.48 1.01
3100.00	User gyro	1.28	187.67	3098.43 -17.18 17.00 -38.92 1.03
3200.00	User gyro	1.82	226.82	3198.40 -14.99 14.81 -40.23 1.15
3300.00	User gyro	1.50	238.35	3298.36 -13.23 13.04 -42.50 0.46
3400.00	User gyro	0.98	221.31	3398.33 -11.91 11.71 -44.18 0.63
3500.00	User gyro	0.99	217.06	3498.32 -10.58 10.37 -45.27 0.07
3600.00	User gyro	0.90	209.51	3598.31 -9.21 9.00 -46.18 0.16
3700.00	User gyro	0.90	211.35	3698.29 -7.86 7.64 -46.97 0.03
3800.00	User gyro	0.76	216.45	3798.28 -6.66 6.44 -47.77 0.16
3900.00	User gyro	0.71	251.78	3898.28 -5.94 5.71 -48.76 0.45
4000.00	User gyro	0.63	239.21	3998.27 -5.46 5.24 -49.82 0.17
4100.00	User gyro	0.53	239.85	4098.26 -4.95 4.72 -50.70 0.10
4200.00	User gyro	0.58	253.77	4198.26 -4.58 4.35 -51.59 0.14
4300.00	User gyro	0.60	255.28	4298.25 -4.31 4.07 -52.58 0.02

gyro MUY WAYNO 7 ST#1-H TEXT FILE (2010-06-09-10-25-44)								
4400.00	User gyro	0.41	254.26	4398.25	-4.08	3.84	-53.43	0.19
4500.00	User gyro	0.49	254.17	4498.25	-3.87	3.63	-54.19	0.08
4600.00	User gyro	0.41	260.17	4598.24	-3.70	3.45	-54.95	0.09
4700.00	User gyro	0.38	250.87	4698.24	-3.53	3.28	-55.61	0.07
4800.00	User gyro	0.42	254.01	4798.24	-3.33	3.07	-56.28	0.04
4900.00	User gyro	0.54	219.67	4898.24	-2.86	2.60	-56.94	0.31
5000.00	User gyro	0.65	234.68	4998.23	-2.17	1.91	-57.70	0.19
5100.00	User gyro	0.98	241.04	5098.22	-1.43	1.17	-58.92	0.34
5200.00	User gyro	1.06	251.82	5198.20	-0.74	0.46	-60.54	0.21
5300.00	User gyro	0.95	244.21	5298.19	-0.10	-0.19	-62.17	0.17
5400.00	User gyro	1.06	231.98	5398.17	0.83	-1.12	-63.65	0.24
5500.00	User gyro	1.33	224.10	5498.15	2.23	-2.53	-65.19	0.31
5600.00	User gyro	1.24	218.99	5598.13	3.90	-4.20	-66.68	0.15
5700.00	User gyro	1.16	215.81	5698.10	5.56	-5.87	-67.96	0.10
5800.00	User gyro	1.26	208.11	5798.08	7.34	-7.66	-69.07	0.19
5900.00	User gyro	1.60	200.94	5898.05	9.61	-9.93	-70.08	0.39
6000.00	User gyro	1.71	200.93	5998.01	12.31	-12.64	-71.12	0.11
6100.00	User gyro	1.94	200.39	6097.96	15.30	-15.63	-72.24	0.23
6200.00	User gyro	2.10	200.78	6197.90	18.59	-18.93	-73.48	0.15
6300.00	User gyro	2.46	196.60	6297.82	22.35	-22.69	-74.75	0.39
6400.00	User gyro	2.50	201.28	6397.72	26.43	-26.78	-76.15	0.21
6500.00	User gyro	2.63	199.03	6497.62	30.63	-30.99	-77.69	0.17
6600.00	User gyro	2.72	196.54	6597.51	35.08	-35.43	-79.12	0.15
6700.00	User gyro	2.84	194.28	6697.40	39.75	-40.11	-80.40	0.16
6800.00	User gyro	2.96	195.62	6797.27	44.63	-45.00	-81.71	0.13
6900.00	User gyro	3.38	195.95	6897.11	49.95	-50.33	-83.22	0.42
7000.00	User gyro	3.87	196.54	6996.91	56.01	-56.40	-84.99	0.49
7100.00	User gyro	3.74	199.62	7096.69	62.31	-62.71	-87.04	0.24
7200.00	User gyro	3.56	200.39	7196.49	68.28	-68.69	-89.22	0.18
7300.00	User gyro	3.03	200.61	7296.32	73.65	-74.07	-91.23	0.54
7400.00	User gyro	2.61	204.88	7396.20	78.18	-78.60	-93.12	0.47
7456.00	User gyro	2.22	204.65	7452.15	80.32	-80.75	-94.11	0.69