

NEW MEXICO OIL CONSERVATION COMMISSION

Santa Fe, New Mexico

30-005-00024

NOTICE OF INTENTION TO ~~RECOMPLETE~~ RECOMPLETE (OWMO)

Notice must be given to the District Office of the Oil Conservation Commission and approval obtained before drilling or recompletion begins. If changes in the proposed plan are considered advisable, a copy of this notice showing such changes will be returned to the sender. Submit this notice in QUINTUPPLICATE. One copy will be returned following approval. See additional instructions in Rules and Regulations of the Commission. If State Land submit 6 Copies

Artesia, New Mexico

(Place)

December 5, 1955

(Date)

OIL CONSERVATION COMMISSION
SANTA FE, NEW MEXICO

Gentlemen:

You are hereby notified that it is our intention to commence the (Drilling) (Recompletion) of a well to be known as

Etz Brothers

(Company or Operator)

Buffalo-Lodewick

(Lease)

Well No. **1**, in **H**

(Unit)

The well is

located **990-1480** feet from the **North** line and **660 740** feet from the

East

line of Section **27**, T. **13-S**, R. **24-E**, NMPM.

(GIVE LOCATION FROM SECTION LINE)

Wildcat

Pool,

Chaves

County

If State Land the Oil and Gas Lease is No.

If patented land the owner is **Stanley Lodewick, et al**

Address **Roswell, New Mexico**

We propose to drill well with drilling equipment as follows:

The status of plugging bond is **Etz Brothers, A Partnership, \$5000 One-Well Bond, NW 1/4 NE 1/4 Section 27, T-13-S, R-24-E, American Employers.**

Drilling Contractor **H. W. Etz, Jr.**

We intend to complete this well in the **Clear Fork**

formation at an approximate depth of **2040'** feet.

CASING PROGRAM

We propose to use the following strings of Casing and to cement them as indicated:

Size of Hole	Size of Casing	Weight per Foot	New or Second Hand	Depth	Sacks Cement
7"	5 1/2"	14#	New	2040'	200

If changes in the above plans become advisable we will notify you immediately.

ADDITIONAL INFORMATION (If recompletion give full details of proposed plan of work.)

This well was plugged by Water Conservation Board in 1931. Attempt to clean out to a depth of 2050 feet and sandfrac.

Approved....., 19.....
Except as follows:

Sincerely yours,

Etz Brothers

(Company or Operator)

By.....

Position.....

Contractor & Part Owner

Send Communications regarding well to

Name.....

H. W. Etz, Jr.

Address.....

Box 992, Roswell, New Mexico

OIL CONSERVATION COMMISSION

By **H. G. Johnson**

NEW MEXICO
OIL CONSERVATION COMMISSION

Form C-128

Well Location and/or Gas Proration Plat

Date March 7th 1956

Operator ETZ BROS. Lease BUFFALO-KODEWICK

Well No. I Section 27 Township 13S Range 24E NMPM

Located 1480' Feet From North Line, 740 Feet From East Line,

Chaves County, New Mexico. G. L. Elevation _____

Name of Producing Formation _____ Pool WILDCAT Dedicated Acreage _____

(Note: All distances must be from outer boundaries of Section)

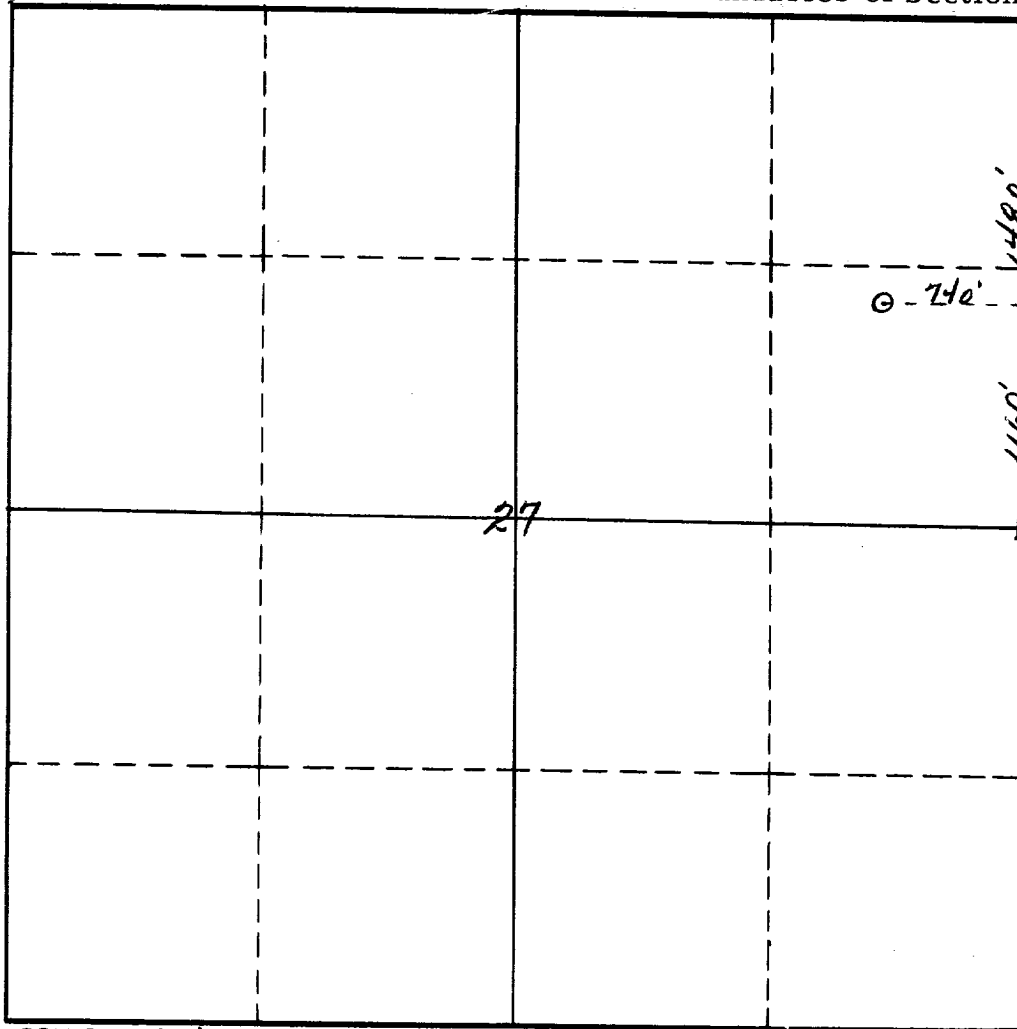

SCALE: 1"=1000'

1. Is this Well a Dual Comp.? Yes ___ No ___.
2. If the answer to Question 1 is yes, are there any other dually completed wells within the dedicated acreage? Yes ___ No ___.

This is to certify that the above plat was prepared from field notes of actual surveys made by me or under my supervision and that the same are true and correct to the best of my knowledge and belief.

Name _____
Position _____
Representing _____
Address _____

Date Surveyed March 7th 1956
James H. Brown N.M.S. #542
Registered Professional Engineer and/or
Land Surveyor