

NEW MEXICO OIL CONSERVATION COMMISSION
Santa Fe, New Mexico

Form C-101
R E D-12A(10)

NOTICE OF INTENTION TO DRILL

SEP 13 1960
20-005-00033

Notice must be given to the District Office of the Oil Conservation Commission and approval obtained before drilling or recompletion begins. If changes in the proposed plan are considered advisable, a copy of this notice showing such changes will be returned to the sender. Submit this notice in QUINTUPPLICATE. One copy will be returned following approval. See additional instructions in Rules and Regulations of the Commission. If State Land submit 6 Copies Attach Form C- 128 in triplicate to first 3 copies of form C-101

734 Petroleum Building, Roswell, New Mexico

September 12, 1960

(Place)

(Date)

OIL CONSERVATION COMMISSION
SANTA FE, NEW MEXICO

Gentlemen:

You are hereby notified that it is our intention to commence the Drilling of a well to be known as
Bill A. Shelton

(Company or Operator)

Wells

(Lease)

Well No. **1**, in **L** (Unit) The well is

located **1650** feet from the **South** line and **990** feet from the **West** line of Section **8**, T. **10 S**, R. **25 E**, NMPM.

(GIVE LOCATION FROM SECTION LINE)

Undesignated Pool, **Chaves** County

If State Land the Oil and Gas Lease is No.

If patented land the owner is **Joe B. Wells**
Address **Amarillo, Texas**

We propose to drill well with drilling equipment as follows:

Rotary to T D

The status of plugging bond is **current and on file**

Drilling Contractor **Waters Drilling Company, Inc.**
Artesia, New Mexico

We intend to complete this well in the **San Andres** formation at an approximate depth of **850** feet.

CASING PROGRAM

We propose to use the following strings of Casing and to cement them as indicated:

Size of Hole	Size of Casing	Weight per Foot	New or Second Hand	Depth	Sacks Cement
11"	7"	17# - J-55	New	700'	Circ. to Surf.
6 1/2"	4 1/2"	9 3/4# - J-55	New	850'	150

If changes in the above plans become advisable we will notify you immediately.

ADDITIONAL INFORMATION (If recompletion give full details of proposed plan of work.)

SEP 13 1960

Approved....., 19.....
Except as follows:

Sincerely yours,

Bill A. Shelton

(Company or Operator)

By **[Signature]**

Position **Agent**

Send Communications regarding well to

Name **Bill A. Shelton**

Address **734 Petro Bldg Roswell N M**

OIL CONSERVATION COMMISSION

By **[Signature]**

RECEIVED

NEW MEXICO OIL CONSERVATION COMMISSION
WELL LOCATION AND ACREAGE DEDICATION PLATFORM C-128
Revised 5/1/57

SEP 13 1960

SEE INSTRUCTIONS FOR COMPLETING THIS FORM ON THE REVERSE SIDE

O. C. C.

SECTION A

ARTESIA, OFFICE

Operator

Bill A. Shelton

Lease

Wells

Well No.

1

Unit Letter

L

Section

8

Township

10-S

Range

25-S

County

CHAVES

Actual Footage Location of Well:

feet from the

SOUTH

line and

990

feet from the

WEST

line

Ground Level Elev.

1650

Producing Formation

San Andres

Pool

~~Undesignated~~ Wildcat

Dedicated Acreage:

40

Acres

1. Is the Operator the only owner in the dedicated acreage outlined on the plat below? YES _____ NO X. ("Owner" means the person who has the right to drill into and to produce from any pool and to appropriate the production either for himself or for himself and another. (65-3-29 (e) NMSA 1935 Comp.)
2. If the answer to question one is "no," have the interests of all the owners been consolidated by communization agreement or otherwise? YES X NO _____. If answer is "yes," Type of Consolidation Operating Agreement
3. If the answer to question two is "no," list all the owners and their respective interests below:

Owner

Land Description

SECTION B

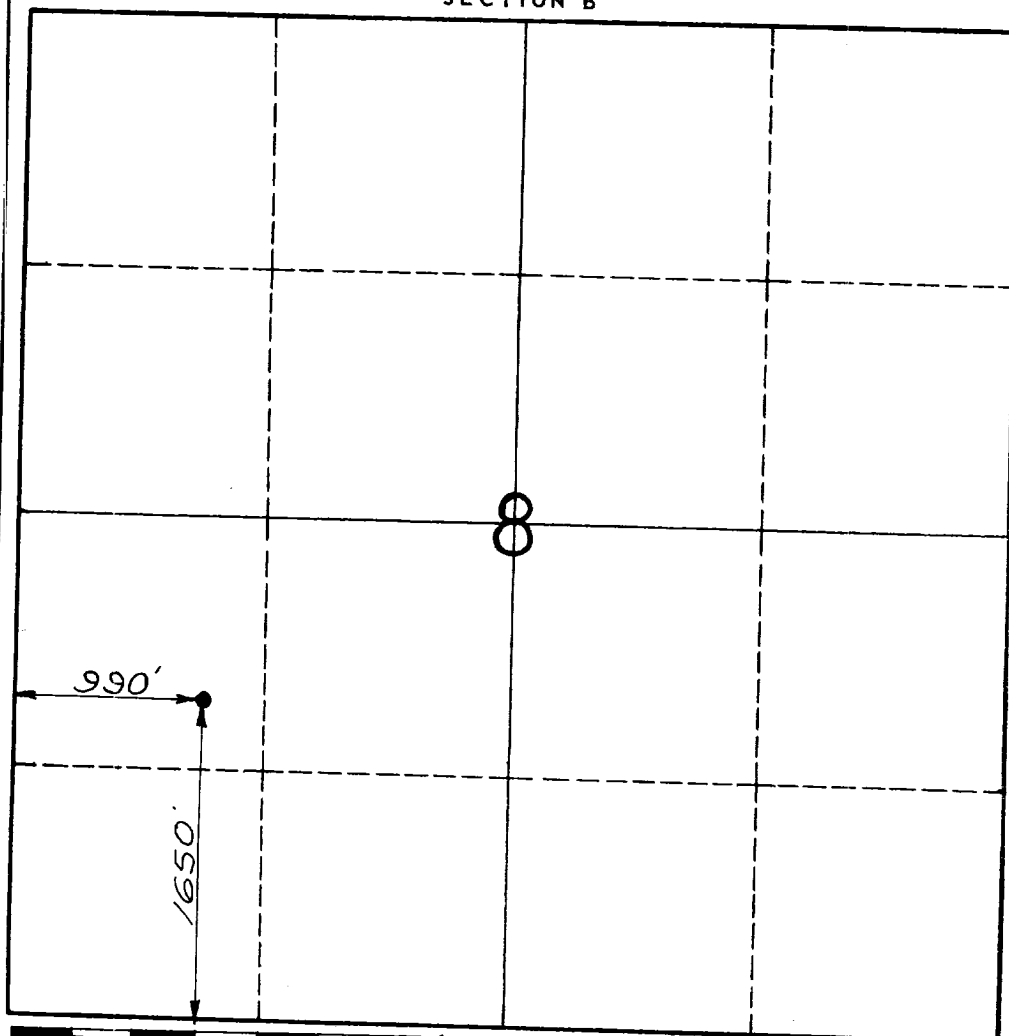

CERTIFICATION

I hereby certify that the information in SECTION A above is true and complete to the best of my knowledge and belief.

Name

Gregory Salinas

Position

Agent

Company

Bill A. Shelton

Date

September 12, 1960

I hereby certify that the well location shown on the plat in SECTION B was plotted from field notes of actual surveys made by me or under my supervision, and that the same is true and correct to the best of my knowledge and belief.

Date Surveyed

September 9, 1960

Registered Professional Engineer
and/or Land Surveyor

Verlon E. Hall

Certificate No.

3241

INSTRUCTIONS FOR COMPLETION OF FORM C-128

1. Operator shall furnish and certify to the information called for in Section A.
2. Operator shall outline the dedicated acreage for *both* oil and gas wells on the plat in Section B.
3. A registered professional engineer or land surveyor registered in the State of New Mexico or approved by the Commission shall show on the plat the location of the well and certify this information in the space provided.
4. All distances shown on the plat must be from the outer boundaries of the Section.
5. If additional space is needed for listing owners and their respective interests as required in question 3 of Section A, please use space below.

OIL CONSERVATION COMMISSION		
ARTESIA DISTRICT OFFICE		
No. Copies Received		5
DISTRIBUTION		
	COPIES FURNISHED	
OPERATOR	1	
SANTA FE	1	
PRODUCTION OFFICE	2	
STATE LAND OFFICE		
U. S. G. S.	2	
TRANSPORTER		
FILE		✓
BUREAU OF MINES	1	