

NEW MEXICO OIL CONSERVATION COMMISSION  
Santa Fe, New Mexico

RECEIVED  
Form G-101  
Revised (12/1/55)  
OCT 31 1960

NOTICE OF INTENTION TO DRILL

Notice must be given to the District Office of the Oil Conservation Commission and approval obtained before drilling or recompletion begins. If changes in the proposed plan are considered advisable, a copy of this notice showing such changes will be returned to the sender. Submit this notice in **QUINTUPLICATE**. One copy will be returned following approval. See additional instructions in Rules and Regulations of the Commission. **If State Land submit 6 Copies Attach Form G-128 in triplicate to first 3 copies of form G-101**

Roswell, New Mexico  
(Place)

Oct. 28, 1960  
(Date)

OIL CONSERVATION COMMISSION  
SANTA FE, NEW MEXICO

Gentlemen:

You are hereby notified that it is our intention to commence the Drilling of a well to be known as

M. G. Peters Drilling Co.  
(Company or Operator)

Childress ET AL  
(Lease)

Well No. 2A, in N. The well is

located 660 feet from the South line and 1980 feet from the

West

line of Section 18, T. 10S, R. 25E, NMPM.

(GIVE LOCATION FROM SECTION LINE) Undesignated Pool, Chaves County

If State Land the Oil and Gas Lease is No.

If patented land the owner is Childress ET AL

Address Roswell, N.M.

We propose to drill well with drilling equipment as follows: Rotary

The status of plugging bond is \$10,000 Blanket

Drilling Contractor M. G. Peters Drilling Co.

We intend to complete this well in the San Andres

formation at an approximate depth of 780 feet.

CASING PROGRAM

We propose to use the following strings of Casing and to cement them as indicated:

Size of Hole	Size of Casing	Weight per Foot	New or Second Hand	Depth	Sacks Cement
11 3/4	11	50	Second hand	150	none
9 3/4	7	24 seamless	new	700	200 circulate to surface

If changes in the above plans become advisable we will notify you immediately.

ADDITIONAL INFORMATION (If recompletion give full details of proposed recompletion)

APPROVAL IS SUBJECT TO STATE  
ENGINEER'S REGULATION AND PERMIT  
DATA  
DRILL LOGS  
BOX 8, ROSWELL, NEW MEXICO

OCT 31 1960

Approved \_\_\_\_\_, 19\_\_\_\_  
Except as follows:

Sincerely yours,

M. G. Peters Drilling Co.  
(Company or Operator)

By \_\_\_\_\_

Position Owner

Send Communications regarding well to

Name Peters Drilling Co.

Address Box 902 Roswell, New Mexico

OIL CONSERVATION COMMISSION

By \_\_\_\_\_

OIL AND GAS INSPECTOR

NEW MEXICO OIL CONSERVATION COMMISSION  
Well Location and Acreage Dedication Plat

Form C-128  
Revised 5/1/57

RECEIVED  
OCT 31 1960

Section A.

Date **October 21, 1960**

Operator M.C. Peters, DRILLING CO Lease O.C.G. Artesia Address at al  
Well No. 2A Unit Letter N Section 18 Township 10 South Range 25 East NMFM  
Located 660 Feet From South Line, 1980 Feet From West Line  
County Chaves G. L. Elevation 3538 foot Dedicated Acreage 40 Acres  
Name of Producing Formation San Andres Pool Wildcat

1. Is the Operator the only owner\* in the dedicated acreage outlined on the plat below?  
Yes X No     .
2. If the answer to question one is "no," have the interests of all the owners been consolidated by communitization agreement or otherwise? Yes      No     . If answer is "yes," Type of Consolidation
3. If the answer to question two is "no," list all the owners and their respective interests below:

Owner

Land Description

Section B

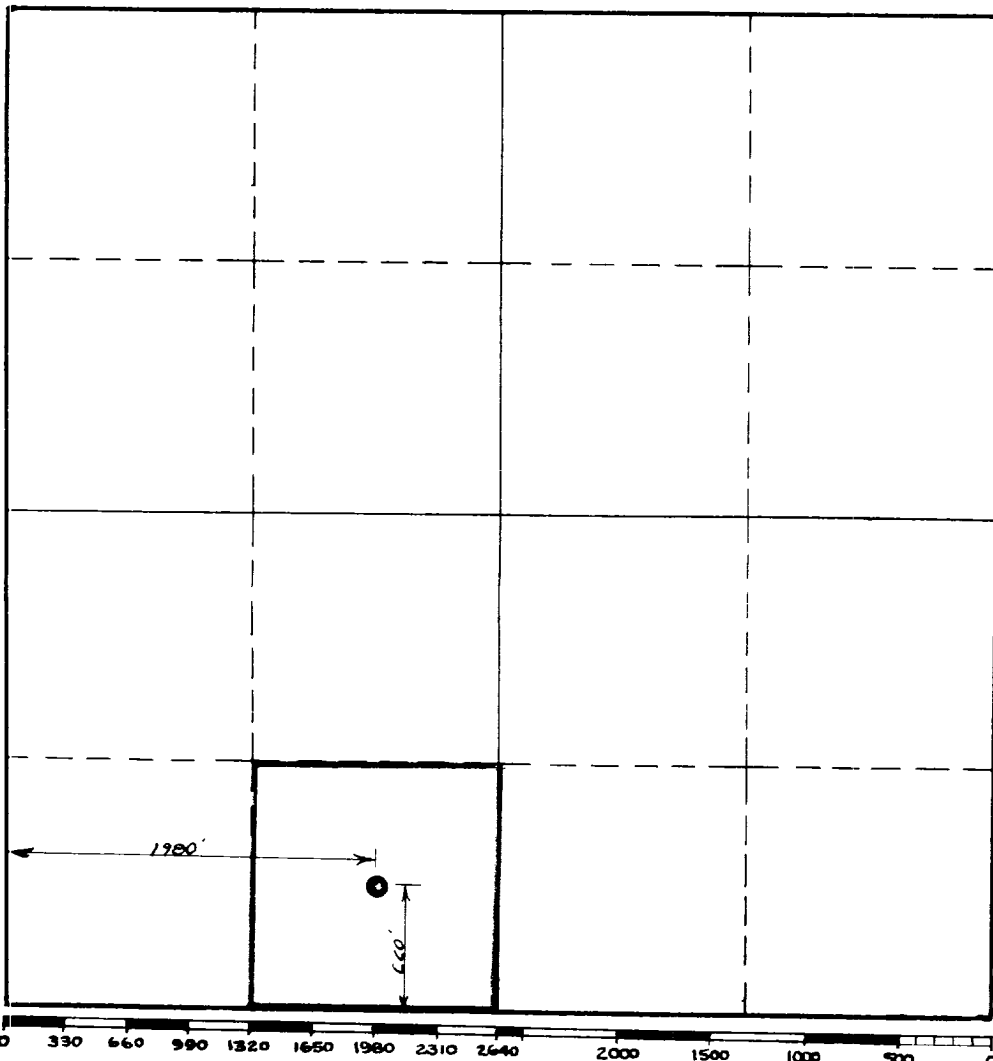

This is to certify that the information in Section A above is true and complete to the best of my knowledge and belief.

M.C. DRILLING CO  
Peters, Esq. & Son

(Operator)

[Signature]  
(Representative)

511 North Lea  
Roswell, New Mexico

Address

This is to certify that the well location shown on the plat in Section B was plotted from field notes of actual surveys made by me or under my supervision and that the same is true and correct to the best of my knowledge and belief.

Date Surveyed 10-21-60

[Signature]  
Registered Professional  
Engineer and/or Land Surveyor.

Certificate No. 2787

(See instructions for completing this form on the back of the plat)

INSTRUCTIONS FOR COMPLETION:

1. Operator shall furnish and certify to the information called for in Section A.
2. Operator shall outline the dedicated acreage for both oil and gas wells on the plat in Section B.
3. A registered professional engineer or land surveyor registered in the State of New Mexico or approved by the Commission shall show on the plat the location of the well and certify this information in the space provided.
4. All distances shown on the plat must be from the outer boundaries of Section.
5. If additional space is needed for listing owners and their respective interests as required in question 3, Section A, please use space below

OIL CONSERVATION COMMISSION	
ALBUQUERQUE DISTRICT OFFICE	
Plat No. <u>6</u>	Received <u>6</u>
DISTRIBUTION	
TO: <u>OWNER</u>	NO. <u>2</u>
TO: <u>STATE LAND OFFICE</u>	NO. <u>2</u>
TO: <u>OTHER</u>	NO. <u>1</u>

\* "Owner" means the person who has the right to drill into and to produce from any pool and to appropriate the production either for himself or for himself and another. (65-3-29 (e) NMSA 1953 Comp.)