

Approved, subject to like
approval by the New Mexico
Water Engineer

March 16, 1960

Dist. Engineer

(SUBMIT IN TRIPLICATE)

UNITED STATES
DEPARTMENT OF THE INTERIOR
GEOLOGICAL SURVEY

Land Office

Lease No.

Unit

NM 05876

RECEIVED

MAR 17 1960

SUNDRY NOTICES AND REPORTS ON WELLS

ARTESIA, OFFICE

NOTICE OF INTENTION TO DRILL.....	<input checked="" type="checkbox"/>	SUBSEQUENT REPORT OF WATER SHUT-OFF.....	
NOTICE OF INTENTION TO CHANGE PLANS.....		SUBSEQUENT REPORT OF SHOOTING OR ACIDIZING.....	
NOTICE OF INTENTION TO TEST WATER SHUT-OFF.....		SUBSEQUENT REPORT OF ALTERING CASING.....	
NOTICE OF INTENTION TO RE-DRILL OR REPAIR WELL.....		SUBSEQUENT REPORT OF RE-DRILLING OR REPAIR.....	
NOTICE OF INTENTION TO SHOOT OR ACIDIZE.....		SUBSEQUENT REPORT OF ABANDONMENT.....	
NOTICE OF INTENTION TO PULL OR ALTER CASING.....		SUPPLEMENTARY WELL HISTORY.....	
NOTICE OF INTENTION TO ABANDON WELL.....			

(INDICATE ABOVE BY CHECK MARK NATURE OF REPORT, NOTICE, OR OTHER DATA)

30-005-00067

March 9, 1960

Well No. 1 is located 1900 ft. from N line and 1900 ft. from W line of sec. 27

N W 1/4-27

(1/4 Sec. and Sec. No.)

Wildcat

(Field)

10-S

(Twp.)

25-E

(Range)

Chaves

(County or Subdivision)

(Meridian)

New Mexico

(State or Territory)

The elevation of the derrick floor above sea level is 3498 ft.

DETAILS OF WORK

(State names of and expected depths to objective sands; show sizes, weights, and lengths of proposed casings; indicate mudding jobs, cementing points, and all other important proposed work)

Test San Andres at 1000', drill 9 5/8" hole to top of San Andres at approximately 700' set 7" - 24 pounds casing, cement to surface, drill 6 3/4" to completion depth, set 4" casing, cement back to 7"

I understand that this plan of work must receive approval in writing by the Geological Survey before operations may be commenced.

Company J. F. McAdams - Etal

Address Box 1716

Hobbs

New Mexico

By

Title

Operator

FORM C-128
Revised 5/1/57

SECTION A

1. Is the Operator the only owner in the dedicated acreage outlined on the plat below? YES _____ NO _____. ("Owner" means the person who has the right to drill into and to produce from any pool and to appropriate the production either for himself or for himself and another. (65-3-29 (e) NMSA 1935 Comp.)
2. If the answer to question one is "no," have the interests of all the owners been consolidated by communitization agreement or otherwise? YES _____ NO _____. If answer is "yes," Type of Consolidation _____
3. If the answer to question two is "no," list all the owners and their respective interests below:

SECTION B



Name

Position

Company

Date _____

I hereby certify that the well location shown on the plat in *SECTION B* was plotted from field notes of actual surveys made by me or under my supervision, and that the same is true and correct to the best of my knowledge and belief.

Date Surveyed

March 9, 1960
Registered Professional Engineer

and/or Land Surveyor
Mann Engineering Co.

By: Raymond L. West
Certificate No. _____

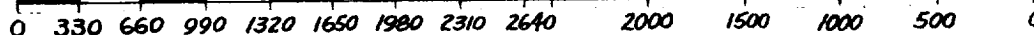

INSTRUCTIONS FOR COMPLETION OF FORM C-128

1. Operator shall furnish and certify to the information called for in Section A.
2. Operator shall outline the dedicated acreage for *both* oil and gas wells on the plat in Section B.
3. A registered professional engineer or land surveyor registered in the State of New Mexico or approved by the Commission shall show on the plat the location of the well and certify this information in the space provided.
4. All distances shown on the plat must be from the outer boundaries of the Section.
5. If additional space is needed for listing owners and their respective interests as required in question 3 of Section A, please use space below.

RECEIVED
MAY 1 1960
NEW MEXICO

NEW MEXICO OIL CONSERVATION COMMISSION
WELL LOCATION AND ACREAGE DEDICATION PLAT

FORM C-128
 Revised 5/1/57

SEE INSTRUCTIONS FOR COMPLETING THIS FORM ON THE REVERSE SIDE

SECTION A

Operator			Lease		Well No.
Unit Letter	Section	Township	Range	County	
Actual Footage Location of Well: feet from the _____ line and _____ feet from the _____ line					
Ground Level Elev.	Producing Formation	Pool	Dedicated Acreage: Acres		

1. Is the Operator the only owner in the dedicated acreage outlined on the plat below? YES _____ NO _____. ("Owner" means the person who has the right to drill into and to produce from any pool and to appropriate the production either for himself or for himself and another. (65-3-29 (e) NMSA 1935 Comp.)
2. If the answer to question one is "no," have the interests of all the owners been consolidated by communitization agreement or otherwise? YES _____ NO _____. If answer is "yes," Type of Consolidation _____
3. If the answer to question two is "no," list all the owners and their respective interests below:

Owner	Land Description

SECTION B

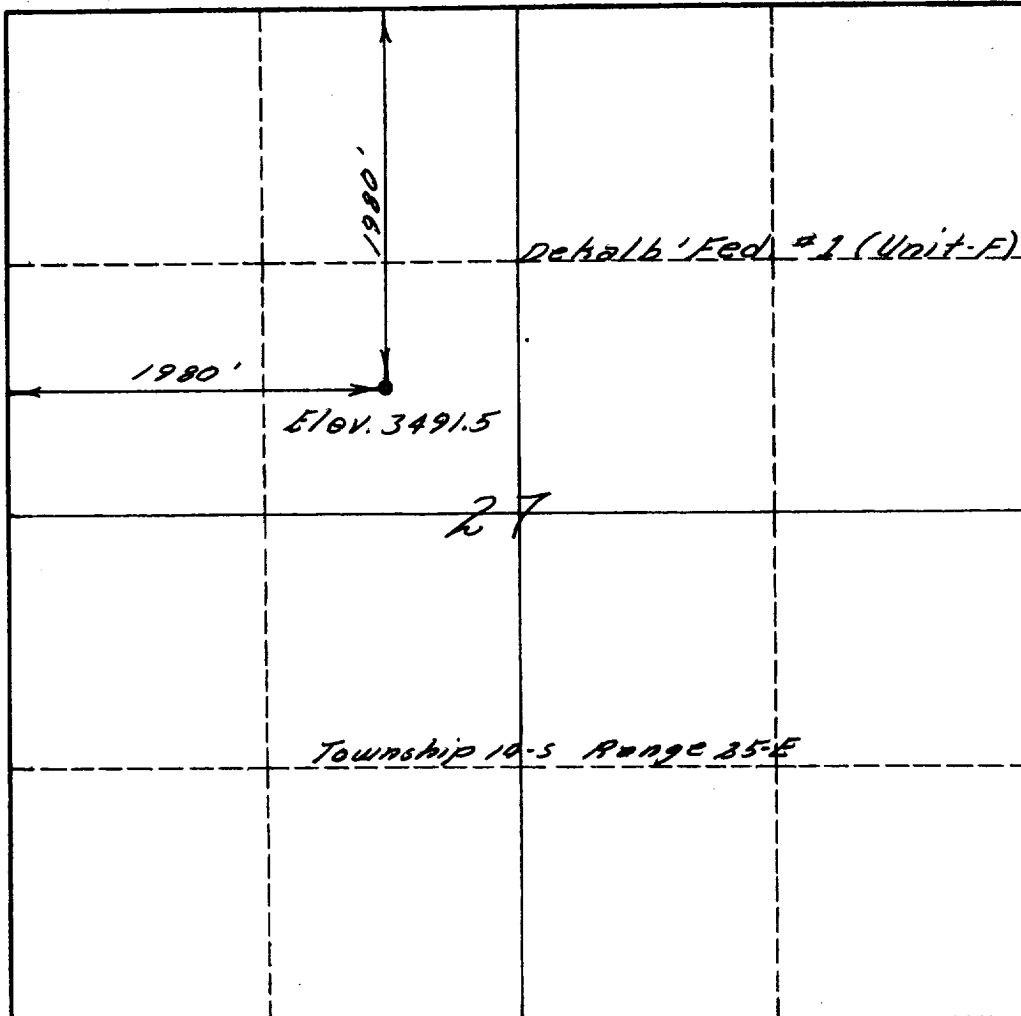

CERTIFICATION

I hereby certify that the information in SECTION A above is true and complete to the best of my knowledge and belief.

Name
Position
Company
Date

I hereby certify that the well location shown on the plat in SECTION B was plotted from field notes of actual surveys made by me or under my supervision, and that the same is true and correct to the best of my knowledge and belief.

Date Surveyed
<u>March 9, 1960</u>
Registered Professional Engineer and/or Land Surveyor
<u>Mann Engineering Co.</u>
By: <u>Layman L. West</u>
Certificate No.
<u>1697</u>

0 330 660 990 1320 1650 1980 2310 2640 2000 1500 1000 500 0

INSTRUCTIONS FOR COMPLETION OF FORM C-128

1. Operator shall furnish and certify to the information called for in Section A.
2. Operator shall outline the dedicated acreage for *both* oil and gas wells on the plat in Section B.
3. A registered professional engineer or land surveyor registered in the State of New Mexico or approved by the Commission shall show on the plat the location of the well and certify this information in the space provided.
4. All distances shown on the plat must be from the outer boundaries of the Section.
5. If additional space is needed for listing owners and their respective interests as required in question 3 of Section A, please use space below.

RECEIVED
MAR 10 1960
U. S. DEPT. OF THE INTERIOR
ROSWELL, NEW MEXICO